

A33c

DONCO CONNECTOR (MALE ON BOARD SMT TYPE)

PITCH: 2.54mm

SPECIFICATIONS

Material

Insulator : Nylon 6T, glass reinforced, rated UL 94V-0

Contact : Phosphor Bronze

Electrical

Current Rating : 1 Amp DC

Contact Resistance : 30 mΩ max.

Insulation Resistance : 3000 MΩ min.

Dielectric Withstanding Voltage : 500V AC for 1minute

Operating Temperature : -40°C to +105°C

♦ Mating Suggestion : A33 series.

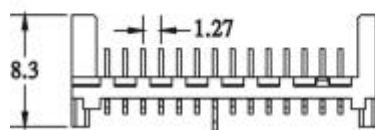
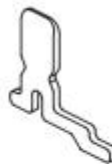
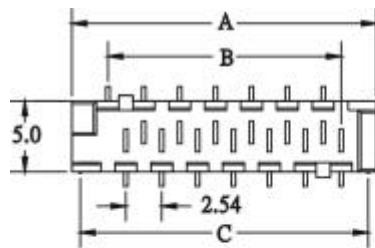
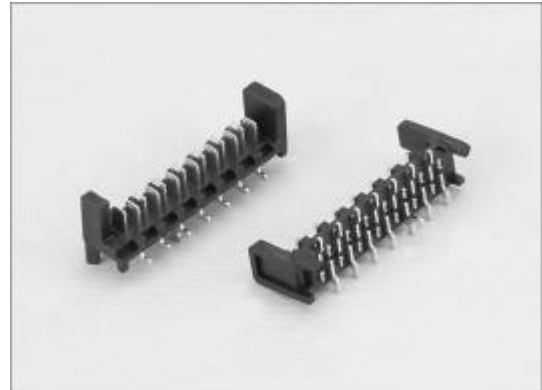

POSITION	A	B	C
4	8.86	3.81	7.66
6	11.40	6.35	10.20
8	13.94	8.89	12.74
10	16.48	11.43	15.28
12	19.02	13.97	17.82
14	21.56	16.51	20.36
16	24.10	19.05	22.90
18	26.64	21.59	25.44
20	29.18	24.13	27.98
26	36.80	31.75	35.60

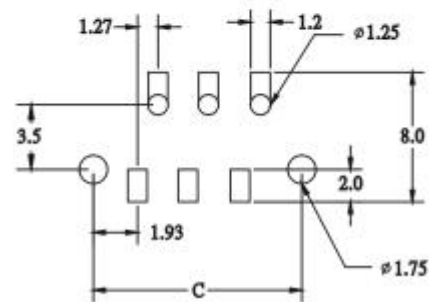

RECOMMENDED P.C.B LAYOUT

HOW TO ORDER:

A33c - 1 - 2 - 3 - 4

1.NO. OF CONTACT	2.CONTACT MATERIAL	3.CONTACT PLATING	4.INSULATOR COLOR
04 06 08 10 12 14 16 18 20 26	B: PHOSPHOR BRONZE	T: TIN PLATED S: SELECTIVE G: GOLD FLASH A: 5u" INCH GOLD B: 10u" INCH GOLD C: 15u" INCH GOLD D: 30u" INCH GOLD	1. BLACK