

**BZX84C2V7...51 Series**

**Description**

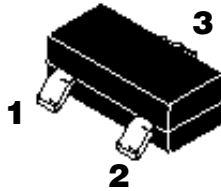

2: NC



**Mechanical Dimensions**

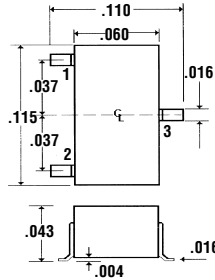

**Features**

■ 5% VOLTAGE TOLERANCE

■ WIDE VOLTAGE RANGE

■ MEETS UL SPECIFICATION 94V-0

Maximum Ratings	BZX84C2V7 . . . 51 Series	Units
DC Power Dissipation ... $P_D$	350	mW
Forward Voltage @ $I_F = 10\text{mA}$ ... $V_F$	0.9	V
Thermal Resistance, Junction to Ambient... $R_{\theta JA}$	420	$^{\circ}\text{C}/\text{W}$
Operating & Storage Temperature Range... $T_J, T_{STRG}$	-65 to 150	$^{\circ}\text{C}$

**NOTES:** 1.  $V_z$  measured @  $I_{zT}$  using pulse test. Pulse width = 5.0ms. Voltage tolerance is 5%.

### Electrical Characteristics @ 25°C.

Part #	Nominal Zener Voltage	Test Current $I_{zT}$ (mA)	Max. Zener Impedance			Max. Reverse Leakage Current @ $V_R$		Typ. Temp. Coefficient TC (%/°C)	Marking Code
			$Z_{zT}$ @ $I_{zT}$ ( $\Omega$ )	$Z_{zK}$ @ $I_{zK}$ ( $\Omega$ )	$I_{zK}$ mA	$I_R$ ( $\mu$ A)	$V_R$ (V)		
BZX84C2V7	2.7	5.0	100	600	1.0	20	1.0	-0.065	Z12
BZX84C3V0	3.0	5.0	100	600	1.0	10	1.0	-0.060	Z13
BZX84C3V3	3.3	5.0	95	600	1.0	5.0	1.0	-0.055	Z14
BZX84C3V6	3.6	5.0	95	600	1.0	5.0	1.0	-0.055	Z15
BZX84C3V9	3.9	5.0	90	600	1.0	3.0	1.0	-0.050	Z16
BZX84C4V3	4.3	5.0	90	600	1.0	3.0	1.0	-0.035	Z17
BZX84C4V7	4.7	5.0	80	500	1.0	4.0	2.0	-0.015	Z1
BZX84C5V1	5.1	5.0	60	480	1.0	2.0	2.0	+0.005	Z2
BZX84C5V6	5.6	5.0	40	400	1.0	1.0	2.0	+0.020	Z3
BZX84C6V2	6.2	5.0	10	150	1.0	3.0	4.0	+0.030	Z4
BZX84C6V8	6.8	5.0	15	80	1.0	2.0	4.0	+0.045	Z5
BZX84C7V5	7.5	5.0	15	80	1.0	1.0	5.0	+0.050	Z6
BZX84C8V2	8.2	5.0	15	80	1.0	0.7	5.0	+0.055	Z7
BZX84C9V1	9.1	5.0	15	100	1.0	0.5	6.0	+0.065	Z8
BZX84C10	10	5.0	20	150	1.0	0.2	7.0	+0.065	Z9
BZX84C11	11	5.0	20	150	1.0	0.1	8.0	+0.070	Y1
BZX84C12	12	5.0	25	150	1.0	0.1	8.0	+0.075	Y2
BZX84C13	13	5.0	30	170	1.0	0.1	8.0	+0.080	Y3
BZX84C15	15	5.0	30	200	1.0	0.05	0.7V <sub>Znom</sub>	+0.080	Y4
BZX84C16	16	5.0	40	200	1.0	0.05	0.7V <sub>Znom</sub>	+0.090	Y5
BZX84C18	18	5.0	45	225	1.0	0.05	0.7V <sub>Znom</sub>	+0.090	Y6
BZX84C20	20	5.0	55	225	1.0	0.05	0.7V <sub>Znom</sub>	+0.090	Y7
BZX84C22	22	5.0	55	250	1.0	0.05	0.7V <sub>Znom</sub>	+0.090	Y8
BZX84C24	24	5.0	70	250	1.0	0.05	0.7V <sub>Znom</sub>	+0.090	Y9
BZX84C27	27	2.0	80	300	0.5	0.05	0.7V <sub>Znom</sub>	+0.090	Y10
BZX84C30	30	2.0	80	300	0.5	0.05	0.7V <sub>Znom</sub>	+0.090	Y11
BZX84C33	33	2.0	80	325	0.5	0.05	0.7V <sub>Znom</sub>	+0.090	Y12
BZX84C36	36	2.0	90	350	0.5	0.05	0.7V <sub>Znom</sub>	+0.090	Y13
BZX84C39	39	2.0	130	350	0.5	0.05	0.7V <sub>Znom</sub>	+0.110	Y14
BZX84C43	43	2.0	150	375	0.5	0.05	0.7V <sub>Znom</sub>	+0.110	Y15
BZX84C47	47	2.0	170	375	0.5	0.05	0.7V <sub>Znom</sub>	+0.110	Y16
BZX84C51	51	2.0	180	400	0.5	0.05	0.7V <sub>Znom</sub>	+0.110	Y17