

## Low Capacitance TVS and Diode Array

This diode array is configured to protect up to two data transmission lines acting as a line terminator, minimizing overshoot and undershoot conditions due to bus impedance as well as protect against over-voltage events as electrostatic discharges. Additionally the TVS Device offers overvoltage transient protection between the operating voltage bus and ground plane.

### SPECIFICATION FEATURES

- Peak Power Dissipation of 500W 8/20 $\mu$ s
- Maximum Capacitance of 5.0pF at 0Vdc 1MHz Line-to-Ground
- Maximum Leakage Current of 1 $\mu$ A @ VRWM
- Industry Standard SMT Package SOT143
- IEC61000-4-2, IEC61000-4-4 and IEC61000-4-5 Full Compliance
- 100% Tin Matte finish (LEAD-FREE PRODUCT)

### APPLICATIONS

- RS422 Interface
- LAN/WLAN Access Point terminals
- Industrial control communication ports
- I<sup>2</sup>C Bus Protection

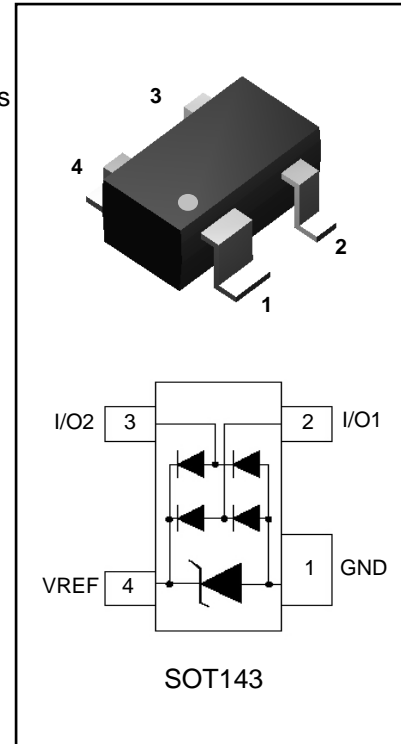

Marking Code:

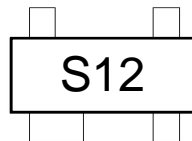

### MAXIMUM RATINGS $T_j = 25^\circ\text{C}$ Unless otherwise noted

Rating	Symbol	Value	Units
Peak Pulse Power (8/20 $\mu$ s Waveform)	$P_{PPM}$	500	W
Peak Pulse Current (8/20 $\mu$ s Waveform)	$I_{PP}$	16	A
Operating Junction Temperature Range	$T_J$	-55 to +125	$^\circ\text{C}$
Storage Temperature Range	$T_{stg}$	-55 to +150	$^\circ\text{C}$
Soldering Temperature, t max = 10s	$T_L$	260	$^\circ\text{C}$

## ELECTRICAL CHARACTERISTICS $T_j = 25^\circ\text{C}$ unless otherwise noted

Parameter	Symbol	Conditions	Min	Typical	Max	Units
Reverse Stand-Off Voltage	$V_{WRM}$				12	V
Reverse Breakdown Voltage	$V_{BR}$	$I_{BR} = 1\text{mA}$	13.3			V
Reverse Leakage Current	$I_R$	$V_R = 12\text{V}$			1	$\mu\text{A}$
Clamping Voltage (8/20 $\mu\text{s}$ )	$V_c$	$I_{pp} = 5\text{A}$			22	V
Clamping Voltage (8/20 $\mu\text{s}$ )	$V_c$	$I_{pp} = 10\text{A}$			27	V
Clamping Voltage (8/20 $\mu\text{s}$ )	$V_c$	$I_{pp} = 16\text{A}$			31	V
Off State Junction Capacitance	$C_j$	0 Vdc Bias $f = 1\text{MHz}$ Between I/O pins and GND		3.8	5	pF
		0 Vdc Bias $f = 1\text{MHz}$ Between I/O pins		1.4	3	pF

## TYPICAL CHARACTERISTIC CURVES

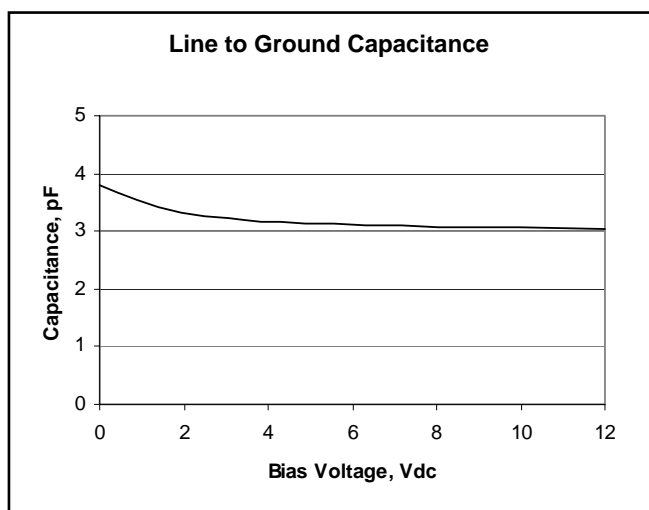
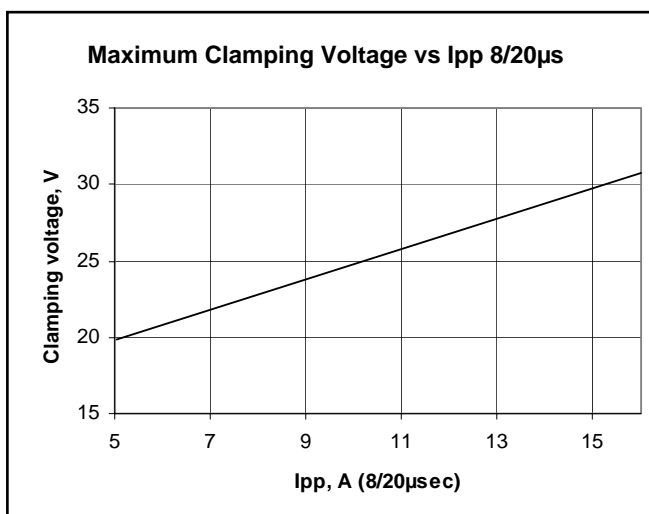
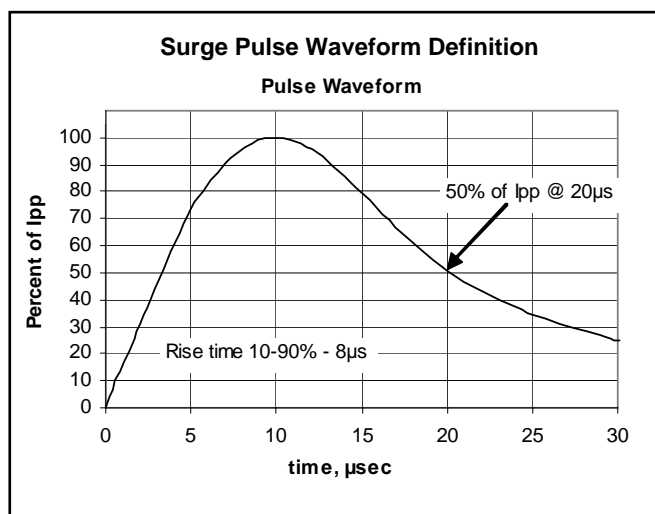

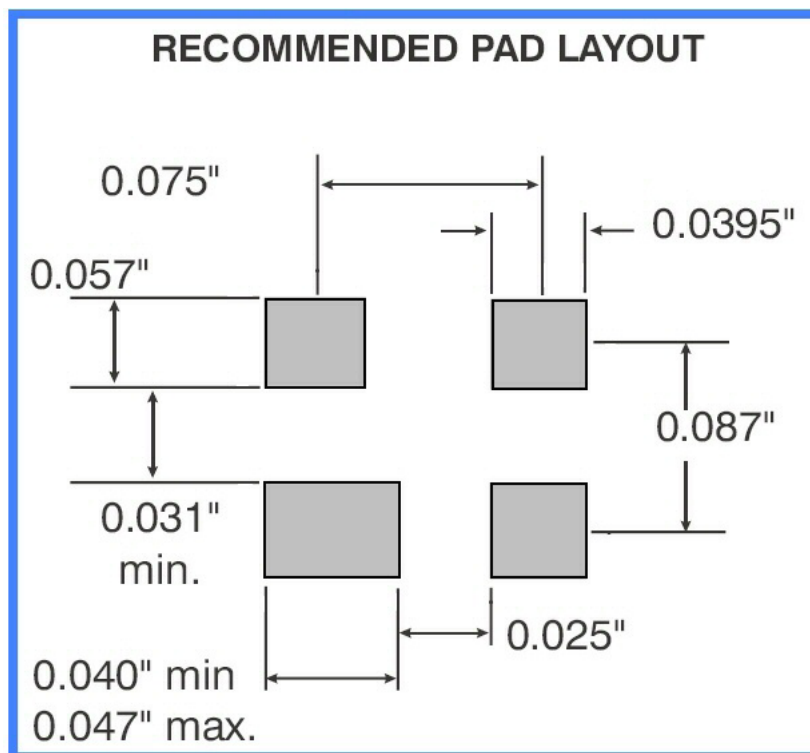
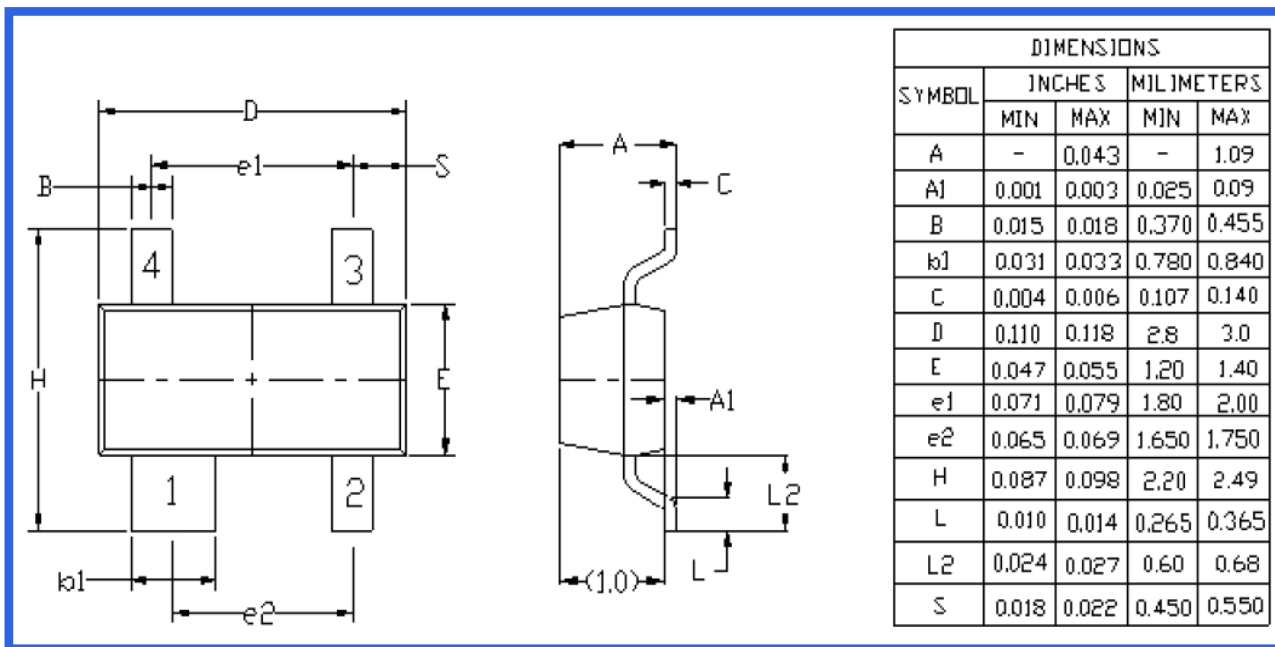
**PACKAGE DIMENSIONS - SOT143****© Copyright PanJit International, Inc 2006**

The information presented in this document is believed to be accurate and reliable. The specifications and information herein are subject to change without notice. Pan Jit makes no warranty, representation or guarantee regarding the suitability of its products for any particular purpose. Pan Jit products are not authorized for use in life support devices or systems. Pan Jit does not convey any license under its patent rights or rights of others.