

## UCR Series

- Small PCB Area
- Low 1.3mm Height Option
- Up to 8 Amp
- Low Cost
- Typical Reel Size 1500pcs



Previously UC-XXXX-C type, surface mount inductors. The **UCR** series comes in three package sizes each with their own individual benefits. The range features some of the smallest footprint sizes available for product of its type, and all are ferrite shielded.

Suitable applications include power supplies for PDA, VTR,OA equipment, LCD display, and DC/DC converters.

### COMPONENT OUTLINE

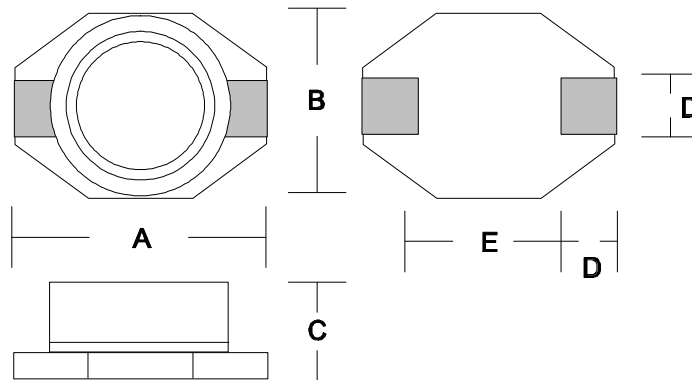

### DIMENSIONS

ECM Type	Inductance Range	A (mm)	B	C	D	E
UCR1608	1.0uH~10mH	6.60	4.45	1.27	1.02	4.32
UCR3316	1.0uH~47uH	12.95	9.40	5.20	2.54	7.62
UCR5022	10uH~1.0mH	18.54	15.24	7.11	2.54	7.62

# ECM Surface Mount Power Inductors

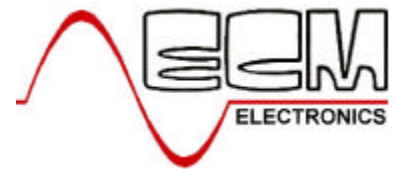

<b>ECM Part</b>	<b>L (mH)</b>	<b>Tol %</b>	<b>R<sub>DC</sub> MAX (W)</b>	<b>I<sub>DC</sub> I<sub>N</sub> (A)</b>
-----------------	---------------	--------------	-------------------------------	---

## UCR1608 Series

UCR1608T-1R0	1.0 @ 100 kHz	M	0.04	3.00
UCR1608T-1R5	1.5 @ 100kHz	M	0.05	2.80
UCR1608T-2R2	2.2 @ 100 kHz	M	0.05	1.80
UCR1608T-3R3	3.3 @ 100 kHz	M	0.06	1.60
UCR1608T-4R7	4.7 @ 100kHz	M	0.06	1.40
UCR1608T-6R8	6.8 @ 100 kHz	M	0.07	1.20
UCR1608T-100	10 @ 100 kHz	M	0.08	1.00
UCR1608T-150	15 @ 100 kHz	M	0.09	0.80
UCR1608T-220	22 @ 100 kHz	M	0.11	0.70
UCR1608T-330	33 @ 100 kHz	M	0.19	0.60
UCR1608T-470	47 @ 100 kHz	M	0.23	0.50
UCR1608T-680	68 @ 100 kHz	M	0.29	0.40
UCR1608T-101	100 @ 100 kHz	M	0.48	0.30
UCR1608T-151	150 @ 100 kHz	M	0.59	0.26
UCR1608T-221	220 @ 100 kHz	M	0.77	0.22
UCR1608T-331	330 @ 100 kHz	M	1.40	0.20
UCR1608T-471	470 @ 100 kHz	M	1.80	0.19
UCR1608T-681	680 @ 100 kHz	M	2.20	0.18
UCR1608T-102	1000 @ 100 kHz	M	3.40	0.15
UCR1608T-152	1500 @ 100 kHz	M	4.20	0.12
UCR1608T-222	2200 @ 100 kHz	M	8.50	0.10
UCR1608T-332	3300 @ 100 kHz	M	11.00	0.08
UCR1608T-472	4700 @ 100 kHz	M	13.90	0.06
UCR1608T-682	6800 @ 100 kHz	M	25.00	0.04
UCR1608T-103	10000 @ 100 kHz	M	32.80	0.02

## UCR3316 Series

UCR3316T-1R0	1.0 @ 100 kHz	M	0.02	5.60
UCR3316T-1R5	1.5 @ 100 kHz	M	0.02	5.20
UCR3316T-2R2	2.2 @ 100 kHz	M	0.03	5.00
UCR3316T-3R3	3.3 @ 100 kHz	M	0.04	3.90
UCR3316T-4R7	4.7 @ 100 kHz	M	0.05	3.20
UCR3316T-6R8	6.8 @ 100 kHz	M	0.08	2.80
UCR3316T-100	10 @ 100 kHz	M	0.10	2.40
UCR3316T-150	15 @ 100 kHz	M	0.15	2.00
UCR3316T-220	22 @ 100 kHz	M	0.21	1.60
UCR3316T-330	33 @ 100 kHz	M	0.33	1.40
UCR3316T-470	47 @ 100 kHz	M	0.47	1.00

**TOLERANCE; M=20%.**

ECM Electronics Limited, Penmaen House, Ashington, West Sussex, RH20 3JR, UK  
Tel: +44(0)1903 892810: Fax: +44(0)1903 892738. Email: [ecm@ecmelectronics.co.uk](mailto:ecm@ecmelectronics.co.uk)

Although we have attempted to accurately reflect the products we market. ECM reserve the right without prior notice to discontinue any product or make design changes we believe necessary.

# ECM Surface Mount Power Inductors

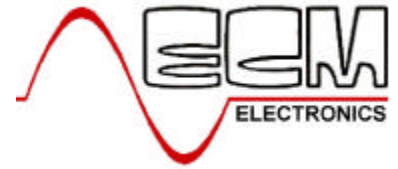

<b>ECM Part</b>	<b>L (mH)</b>	<b>Tol %</b>	<b>R<sub>DC</sub> MAX (W)</b>	<b>I<sub>DC</sub> I<sub>N</sub> (A)</b>
-----------------	---------------	--------------	-------------------------------	---

## UCR5022 Series

UC5022T-100	10 @100 kHz	M	0.04	8.00
UC5022T-150	15 @100 kHz	M	0.05	7.00
UC5022T-220	22 @100 kHz	M	0.06	6.00
UC5022T-330	33 @100 kHz	M	0.08	5.00
UC5022T-470	47 @100 kHz	M	0.10	4.00
UC5022T-680	68 @100 kHz	M	0.14	3.00
UC5022T-101	100 @100 kHz	M	0.21	2.40
UC5022T-151	150 @100 kHz	M	0.29	2.10
UC5022T-221	220 @100 kHz	M	0.47	1.90
UC5022T-331	330 @100 kHz	M	0.78	1.10
UC5022T-471	470 @100 kHz	M	1.08	1.10
UC5022T-681	680 @100 kHz	M	1.40	0.96
UC5022T-102	1000 @100 kHz	M	2.01	0.80

**TOLERANCE; M=20%.**

ECM Electronics Limited, Penmaen House, Ashington, West Sussex, RH20 3JR, UK  
Tel: +44(0)1903 892810: Fax: +44(0)1903 892738. Email: [ecm@ecmelectronics.co.uk](mailto:ecm@ecmelectronics.co.uk)

Although we have attempted to accurately reflect the products we market. ECM reserve the right without prior notice to discontinue any product or make design changes we believe necessary.