

159.1625MHz SAW Filter

Model: TA0395A

Part No: MA06510

REV NO.: 3

A. MAXIMUM RATING:

1. Input Power Level: 20dBm (continuous without damage)
2. DC voltage: 5 V
3. Operating Temperature: -30°C to +70°C
4. Storage Temperature: -40°C to +85°C

B. ELECTRICAL CHARACTERISTICS:

Item		Specification			
		Unit	Min.	Typ.	Max.
Center Frequency	Fc	MHz	-	159.1625	-
Insertion Loss	156.3~162.025MHz IL	dB	-	2.3	3.8
Attenuation (Reference from 0dB)					
Fc-50 ~ Fc-30	MHz	dB	42	57	-
Fc-30 ~ Fc-15	MHz	dB	36	55	-
Fc+30 ~ Fc+50	MHz	dB	42	55	-
Source impedance	Zs	Ω	-	50	-
Load impedance	ZL	Ω	-	50	-

C. MEASUREMENT CIRCUIT:

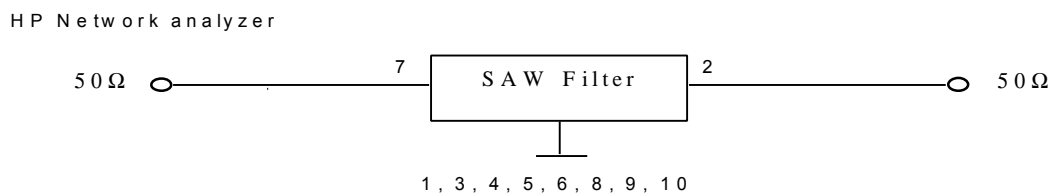

159.16250MHz SAW Filter
Part No: **MA06510**

Model: **TA0395A**
REV NO.: 3

D. FREQUENCY CHARACTERISTICS:

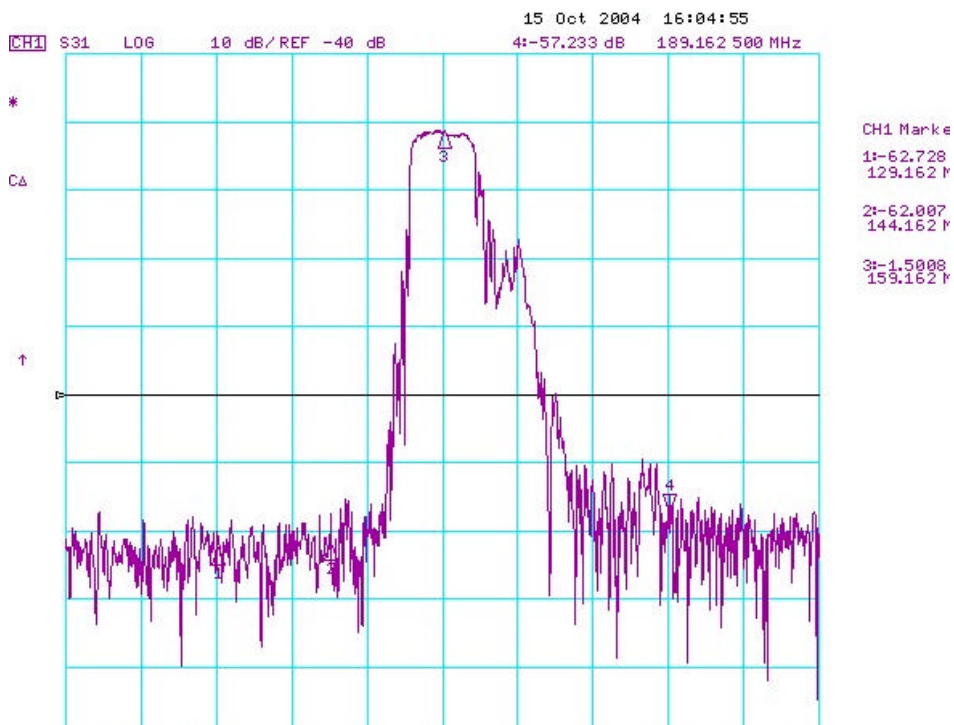
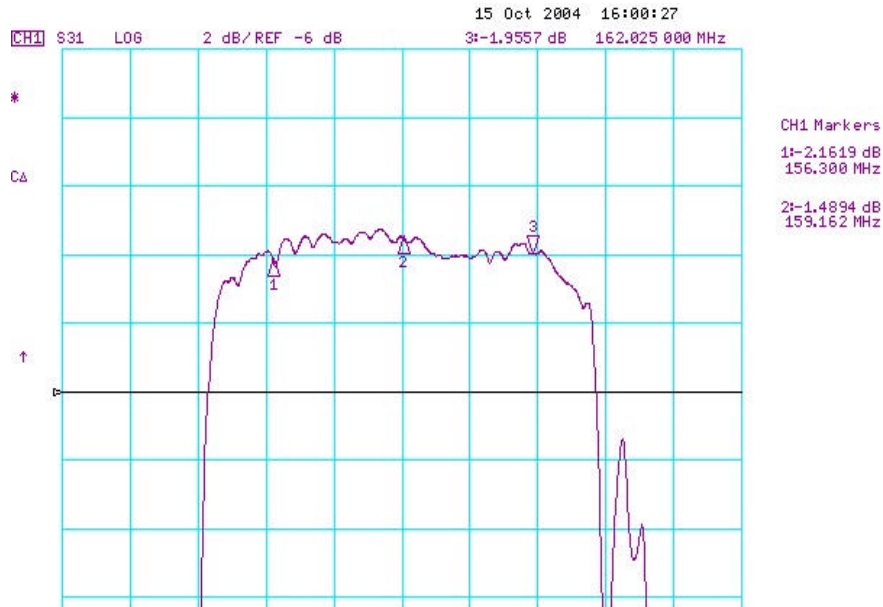

159.16250MHz SAW Filter

Model: TA0395A

Part No: MA06510

REV NO.: 3

E. OUTLINE DRAWING:

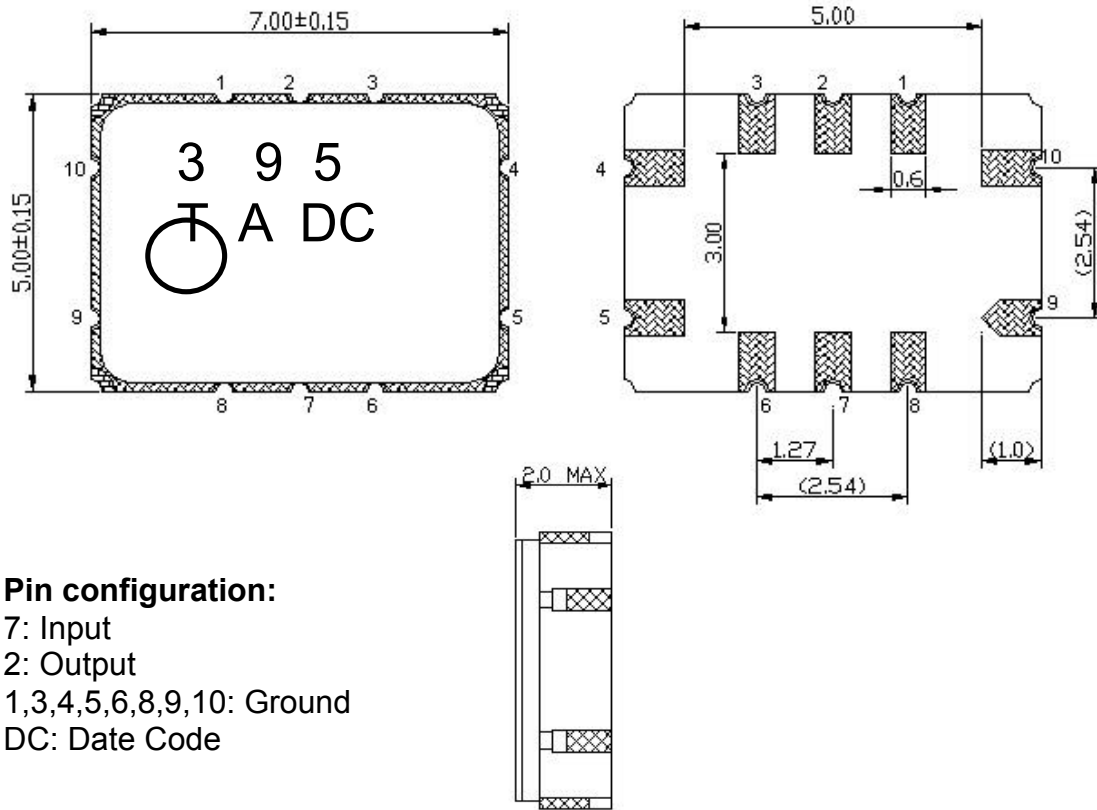

Pin configuration:

- 7: Input
- 2: Output
- 1,3,4,5,6,8,9,10: Ground
- DC: Date Code

F. PCB FOOTPRINT:

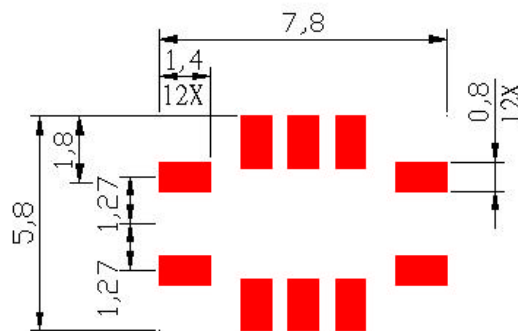

159.16250MHz SAW Filter
Part No: **MA06510**

Model: **TA0395A**
REV NO.: 3

G. PACKING:

1. REEL DIMENSION

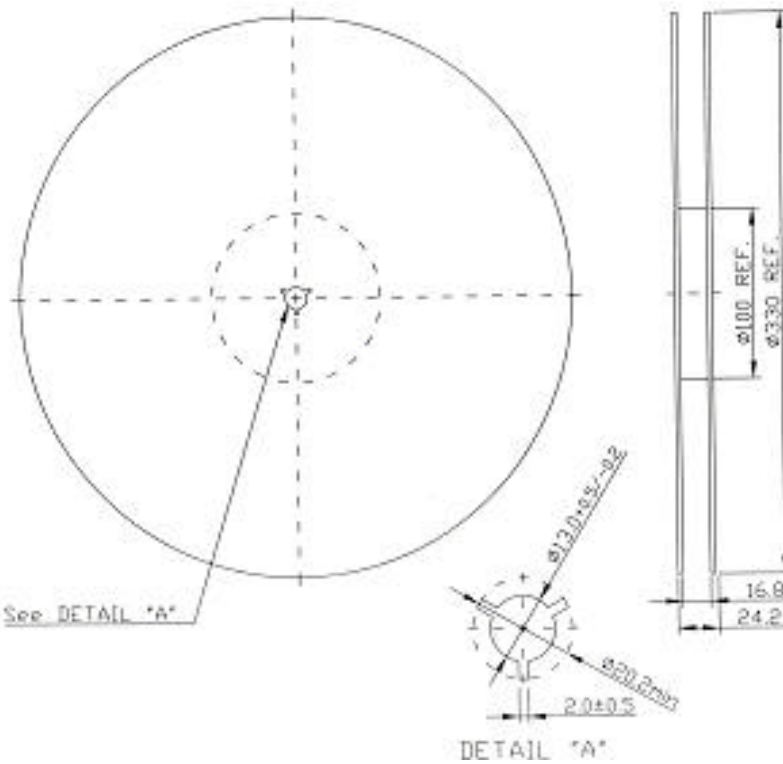

2. TAPE DIMENSION

