

### 1. PART NO. EXPRESSION :

SSC03011R5YZF  
 (a) (b) (c) (d)(e)(f)

- (a) Series code
- (b) Dimension code
- (c) Inductance code : 1R5 = 1.5uH
- (d) Tolerance code : Y = ±30%
- (e) X, Y, Z : Standard part
- (f) F : Lead Free

### 2. CONFIGURATION & DIMENSIONS :

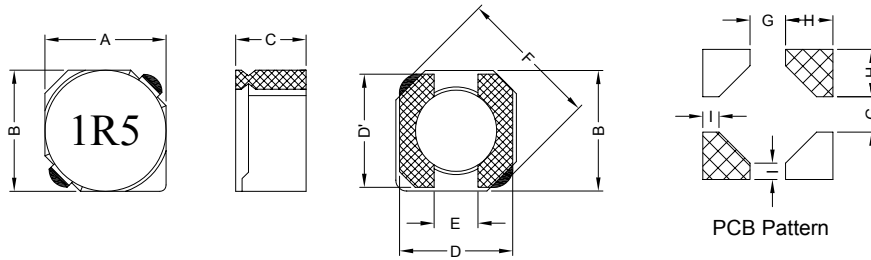

Unit : m/m

A	B	C	D	D'	E	F	G	H	I
4.10 Max.	4.10 Max.	1.80 Max.	3.70 Ref.	3.75 Ref.	1.20 Ref.	5.20 Max.	1.20 Ref.	1.60 Ref.	0.55 Ref.

### 3. SCHEMATIC :

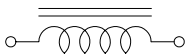

### 4. MATERIALS :

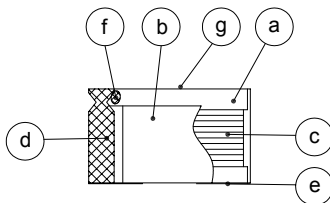

- (a) Core : DR Ferrite Core
- (b) Core : RI Ferrite Core
- (c) Wire : Enamelled Copper Wire
- (d) Terminal : Au+Ni Copper Plate
- (e) Adhesive : Epoxy
- (f) Adhesive : Epoxy
- (g) Ink : Bon Margue

### 5. GENERAL SPECIFICATION :

- a) Temp. rise : 40°C Max. at rated current
- b) Rated current : Base on temp. rise &  $\Delta L/L0A = 35\%$  Max.
- c) Storage temp. : -40°C to +125°C
- d) Operating temp. : -40°C to +85°C
- e) Resistance to solder heat : 260°C.10 secs



**RoHS Compliant**

NOTE : Specifications subject to change without notice. Please check our website for latest information.

05.08.2008



**SUPERWORLD ELECTRONICS (S) PTE LTD**

## 6. ELECTRICAL CHARACTERISTICS :

Part No.	Inductance ( $\mu$ H)	Test Frequency (Hz)	RDC ( $m\Omega$ ) Max.	IDC (A) Max.
SSC03011R5YZF	1.5 $\pm$ 30%	0.1V / 100 K	52	1.55
SSC03012R2YZF	2.2 $\pm$ 30%	0.1V / 100 K	72	1.20
SSC03013R3YZF	3.3 $\pm$ 30%	0.1V / 100 K	85	1.10
SSC03014R7YZF	4.7 $\pm$ 30%	0.1V / 100 K	105	0.90
SSC03016R8YZF	6.8 $\pm$ 30%	0.1V / 100 K	170	0.73
SSC0301100YZF	10.0 $\pm$ 30%	0.1V / 100 K	210	0.55
SSC0301150YZF	15.0 $\pm$ 30%	0.1V / 100 K	295	0.45
SSC0301220YZF	22.0 $\pm$ 30%	0.1V / 100 K	430	0.40
SSC0301330YZF	33.0 $\pm$ 30%	0.1V / 100 K	675	0.32

**RoHS Compliant**

NOTE : Specifications subject to change without notice. Please check our website for latest information.

05.08.2008

**SUPERWORLD ELECTRONICS (S) PTE LTD**

PG. 2

## 7. CHARACTERISTICS CURVES :

@ TEMP. RISE VS. DC SUPERPOSITION RESPONSE CURVE

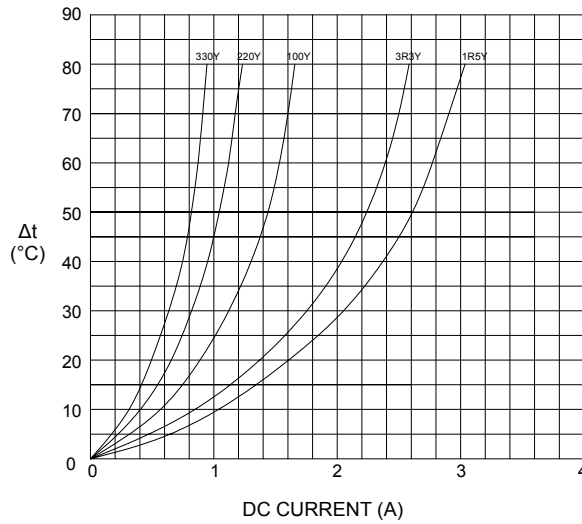

@ INDUCTANCE VS. FREQUENCY RESPONSE CURVE

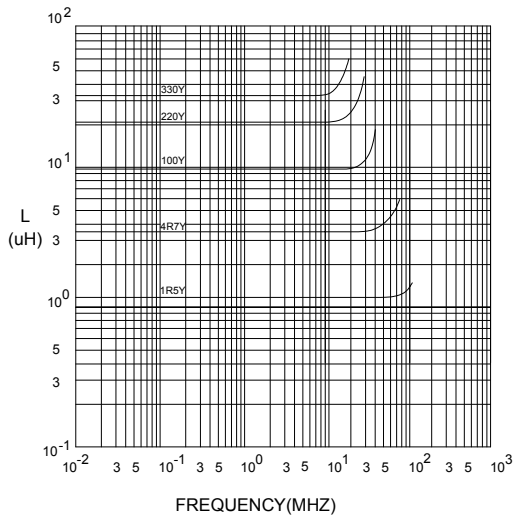

@ INDUCTANCE VS. DC SUPERPOSITION RESPONSE CURVE

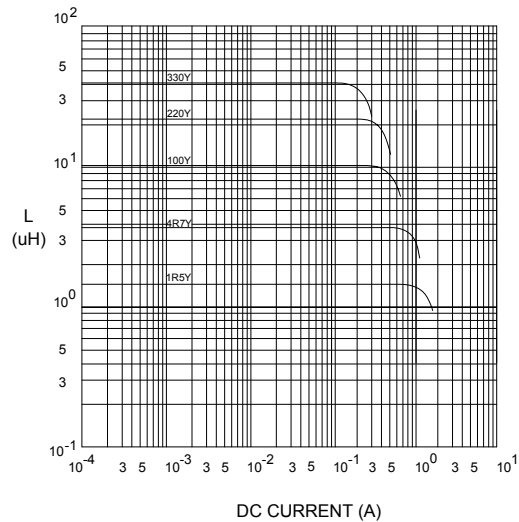

NOTE : Specifications subject to change without notice. Please check our website for latest information.



**RoHS Compliant**

05.08.2008



**SUPERWORLD ELECTRONICS (S) PTE LTD**

### RECOMMENDED SOLDERING CONDITIONS REFLOW SOLDERINGS

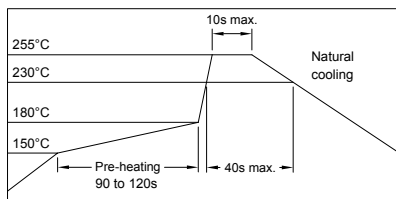

### 8. PACKAGING INFORMATION :

#### ( 1 ) CONFIGURATION

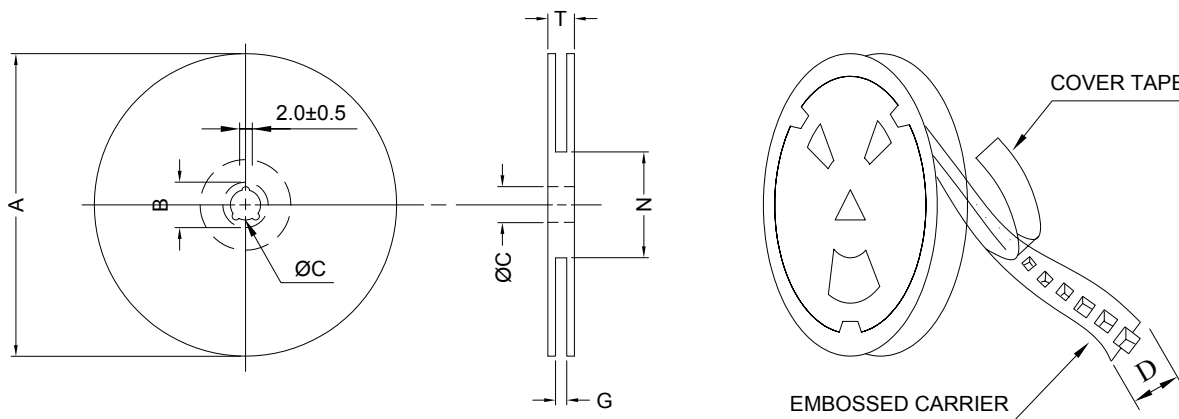

\* CARRIER TAPE WIDTH : D

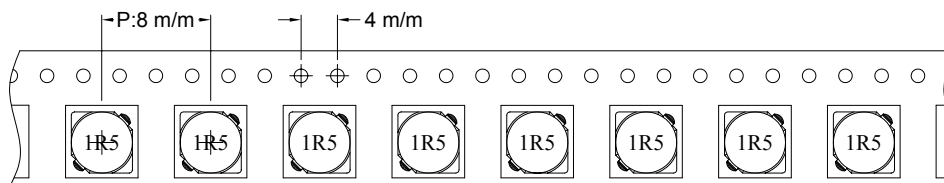

#### ( 2 ) DIMENSIONS

Unit:m/m

STYLE	A	B	C	D	G	N	T
13-16	330	21±0.8	13	16	18 <sup>+0</sup>	50 <sup>-0</sup>	22.4

#### ( 3 ) Q'TY & G.W. PER PACKAGE

SERIES	INNER : REEL			OUTER : CARTON		
	Q'TY (PCS)	G.W. (gw)	STYLE	Q'TY (PCS)	G.W. (Kg)	SIZE (cm)
SSC0301	3000	2100	13-16	18000	16.1	40 x 40 x 24



**RoHS Compliant**

NOTE : Specifications subject to change without notice. Please check our website for latest information.

05.08.2008

### 9. RELIABILITY AND TEST CONDITION :

TEST ITEM	SPECIFICATION	TEST CONDITION
SOLDERABILITY	MORE THAN 90% OF THE TERMINAL ELECTRODE SHALL BE COVERED WITH FRESH SOLDER.	PREHEAT : 125±25°C FOR 60 SECONDS SOLDER : 99%Sn/0.3%Ag/0.7%Cu OR EQUIVALENT SOLDER TEMP. : 245±5°C FLUX : ROSIN DIP TIME : 4±1 SECONDS
THERMAL SHOCK TEST  ( TEMP. CYCLE )	INDUCTANCE SHALL NOT CHANGE MORE THAN ±20%	ROOM TEMP. → -25±2°C 15 MINUTES → 30 MINUTES  ROOM TEMP. → 85±2°C 15 MINUTES → 30 MINUTES  TOTAL : 50 CYCLES
HUMIDITY RESISTANCE TEST		TEMPERATURE : 40±2°C HUMIDITY : 90 ~ 95% APPLIED CURRENT : PER SPEC. TIME : 500 HOURS
HIGH TEMP. RESISTANCE TEST		TEMPERATURE : 85±2°C APPLIED CURRENT : PER SPEC. TIME : 500 HOURS

### 10. UL CARD :

<b>OBMW2</b>		<b>November 30, 2000</b>		
<b>Magnet Wire - Component</b>				
PACIFIC ELECTRIC WIRE & CABLE (SHENZHEN) CO LTD 607 BAOLONG INDUSTRIAL ESTATE LONGGANG, SHENZHEN GUANGDONG CHINA				E201757
Mtl Dsg	BC	Coating Type	TC	ANSI Type
UEW/U		Polyurethane	—	TI 130
PEW/U		Polyester	—	MW5-C 155°C
PEWH/U		Modified Polyester	—	MW30-C 180
PEW-NY/U		Polyester	Polyamide	MW24-C 155
HAI/U		Polyester(Amide)(Imide)	Polyamideimide	MW35,73 200
UEW-NY/U		Polyurethane	Polyamide	MW80-C 155 MW28-C 130
<p><b>Marking: Company name and material designation or marked designation on package or reel, and Recognized Component Mark.</b></p> <p><b>See General Information Preceding These Recognitions</b></p>				
1/3/2001	Underwriters Laboratories Inc.		Card 1 of 2	



**RoHS Compliant**

NOTE : Specifications subject to change without notice. Please check our website for latest information.

05.08.2008



**SUPERWORLD ELECTRONICS (S) PTE LTD**