

DRO

P/N: JXWBDRO-T-1030-10

Center Frequency(MHz)	1030
Temperature Stability(ppm /°C)	±5
Phase Noise(dBc)	-100 @ 10KHz
	-120 @ 100KHz
DC Supply(V)	+5
Harmonics(dBc)	-25 Typ.
Power Output(dBm)	10
Flatness(dBm)	±1.5
Operating Temperature(°C)	-20~+60
Storage Temperature(°C)	-30~+70
Net Weight(Kg)	0.05Around

Outline Drawing (Size: mm)

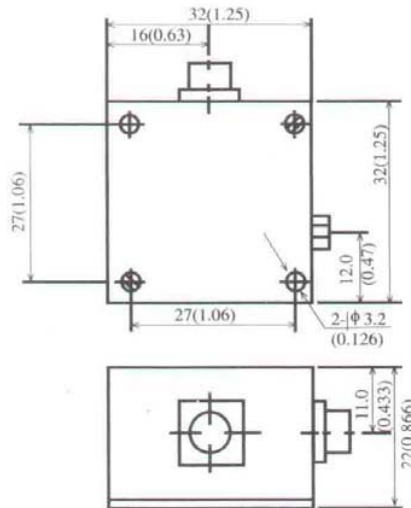

Data subject to change without notice. For current data sheets, please contact: sales@aacix.com