

LED TUBE

1500mm / T9 / G13 LED TUBE

DESCRIPTION

- Solution for energy saving, CO₂ reduction and environment protection
- BV LED tube is made of high brightness LED with driver build in
- Long lifetime (about to 50000Hrs)
- Recyclable
- Easy installation, direct replacement



FEATURES

- End cap meets standard G13 specification
- Meets T9 (9/8 inches diameter) tube size
- Full range voltage (AC 90- 264V)
- Low power consumption and high optical intensity
- High power efficiency (>0.8)
- Lead (Pb) free, and RoHS compliant

APPLICATIONS

- General Lighting
- Tube Light Source
- Architectural Lighting
- Backlighting

PART NUMBER LIST

P/N	Power(110Vac)	CCT	Lens	Cap base	LED quantity	Flux
BVM-TG50NAD1	26	5600K	Diffused	G13	150	1600
BVM-TG50NAC1	26	5600K	Clear	G13	150	2100

DIMENSIONS

Unit : mm

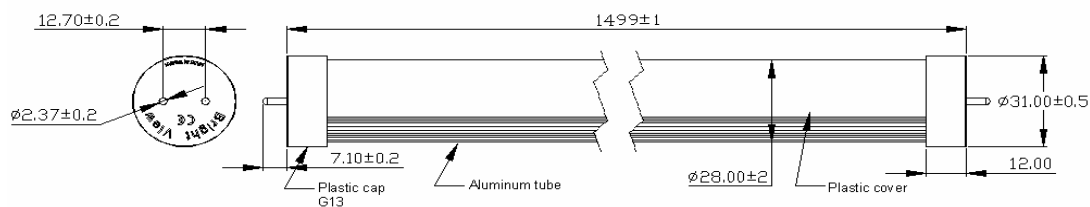

■ TYPICAL ELECTRICAL / OPTICAL CHARACTERISTICS AT Ta = 25 °C
BVM-TG50NAD1

PARAMETER	SYMBOL	110VAC / 60Hz	220V / 60Hz	UNIT
Power dissipation	Pd	26(Typ.)	28(Typ.)	W
Power Factor	PF	≥0.7	≥0.7	-
Power Efficiency	PE	0.8(Typ.)	0.8(Typ.)	-
Luminous flux	ΦU	1600(Typ.)	1650(Typ.)	lm
Illuminance (@100cm)	E	330(Typ.)	360(Typ.)	lx
Luminous Efficacy	η	61(Typ.)	58(Typ.)	lm/W
Color Temperature	CCT	5600+/- 500		°K
Input Voltage, Frequency	Vi	90~264; 50/60Hz		Vac
Operating Temperature Range	Top	-30 ~ +50		°C
Storage Temperature Range	Ts	-30 ~ +65		°C
Weight	-	563(Typ.)		g

BVM-TG50NAC1

PARAMETER	SYMBOL	110VAC / 60Hz	220V / 60Hz	UNIT
Power dissipation	Pd	26(Typ.)	28(Typ.)	W
Power Factor	PF	≥0.7	≥0.7	-
Power Efficiency	PE	0.8(Typ.)	0.8(Typ.)	-
Luminous flux	ΦU	2100(Typ.)	2200(Typ.)	lm
Illuminance (@100cm)	E	390(Typ.)	430(Typ.)	lx
Luminous Efficacy	η	80(Typ.)	78(Typ.)	lm/W
Color Temperature	CCT	5600+/- 500		°K
Input Voltage, Frequency	Vi	90~264; 50/60Hz		Vac
Operating Temperature Range	Top	-30 ~ +50		°C
Storage Temperature Range	Ts	-30 ~ +65		°C
Weight	-	563(Typ.)		g

LED TUBE**1500mm / T9 / G13 LED TUBE****■ Packaging**

Each carton has 20 tubes.

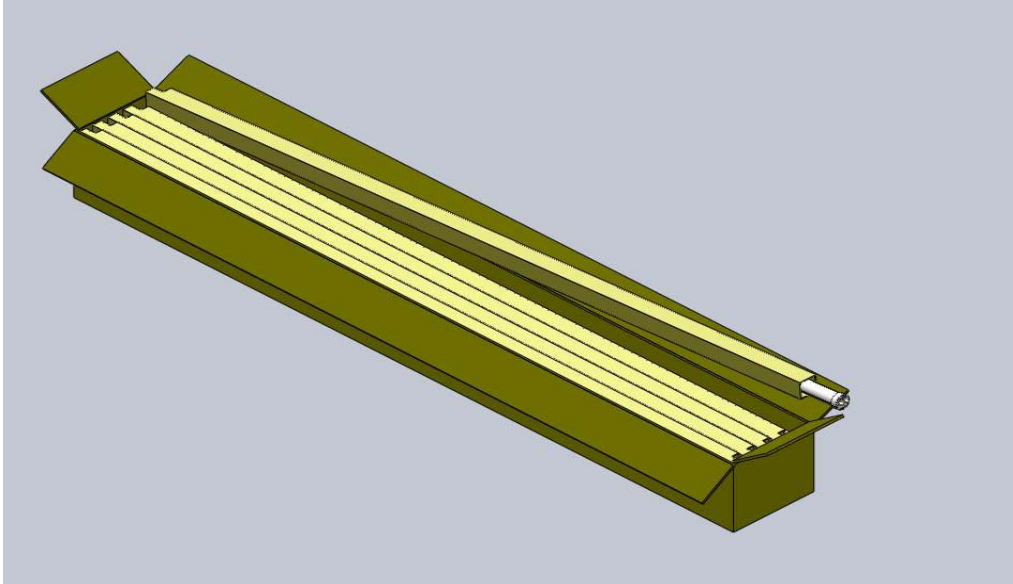
**■ CAUTIONS****1. Voltage**

- A. Driver the product over the specified voltage rating (264VAC) will damage the product.
- B. Lower than 90VAC the product will not work normally.
- C. Use DC source the product may not work normally.

2. Installation

- A. For your safety please turn off the power before install the product.
- B. Remove the starter from the luminaires. Starter may cause the tube work abnormally.
- C. Remover the capacitor from the ballast.
- D. This tube is not designed for rapid and instant type ballast. Do not apply the lamp in these luminaires.

3. Storage & Handling

- A. The product should be storage in an environment with the relative humidity less than 90% RH (@30 degree C or less).
- B. Warranty will be VOID if disassemble the lamp.
- C. The prduct is not waterproof. Excess moisture may also damage the product.