

KBPC10005 THRU KBPC1010



SINGLE PHASE SILICON BRIDGE RECTIFIER

VOLTAGE:50 TO 1000V CURRENT:10.0A

FEATURE

Surge overload rating:200A peak
High case dielectric strength

MECHANICAL DATA

Terminal: Plated leads solderable per
MIL-STD 202E, method 208C
Case: UL-94 Class V-0 recognized Flame
Retardant Epoxy
Polarity: Polarity symbol marked on body
Mounting: Hole thru for # 6 screw

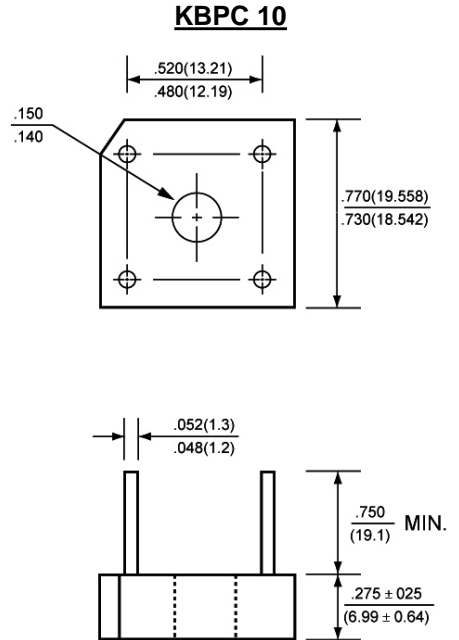

Dimensions in inches and (millimeters)

MAXIMUM RATINGS AND ELECTRICAL CHARACTERISTICS

(single-phase, half -wave, 60HZ, resistive or inductive load rating at 25°C, unless otherwise stated, for capacitive load, derate current by 20%)

	SYMBOL	KBPC10 005	KBPC10 01	KBPC10 02	KBPC10 04	KBPC10 06	KBPC10 08	KBPC10 10	units
Maximum Recurrent Peak Reverse Voltage	V _{rrm}	50	100	200	400	600	800	1000	V
Maximum RMS Voltage	V _{rms}	35	70	140	280	420	560	700	V
Maximum DC blocking Voltage	V _{dc}	50	100	200	400	600	800	1000	V
Maximum Average Forward Rectified Current at Ta = 50°C Ta = 100°C	I _{f(av)}	10.0							A
		6.0							A
Peak Forward Surge Current 8.3ms single Half sine-wave superimposed on rated load	I _{fsm}	200.0							A
Maximum Instantaneous Forward Voltage at forward current 5.0A DC	V _f	1.1							V
Maximum DC Reverse Current at rated DC blocking voltage Ta = 25°C Ta = 100°C	I _r	10.0							μA
		200.0							μA
Operating Temperature Range	T _j	-55 to +125							°C
Storage and Operation Junction Temperature	T _{stg}	-55 to +150							°C

RATINGS AND CHARACTERISTIC CURVES KBPC10005 THRU KBPC1010

1

FIG. 1 - MAXIMUM NON-REPETITIVE FORWARD SURGE CURRENT

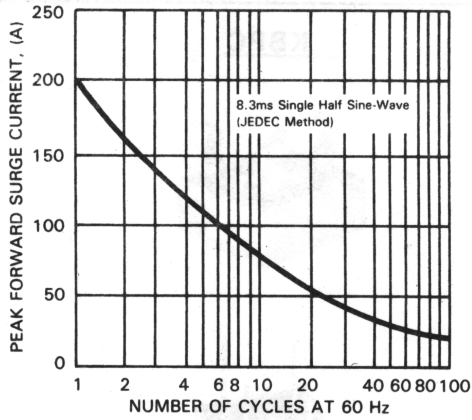

FIG. 2 - TYPICAL FORWARD CURRENT DERATING CURVE

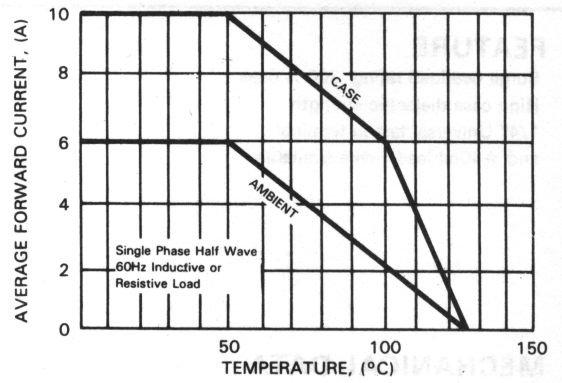

FIG. 3 - TYPICAL INSTANTANEOUS FORWARD CHARACTERISTICS

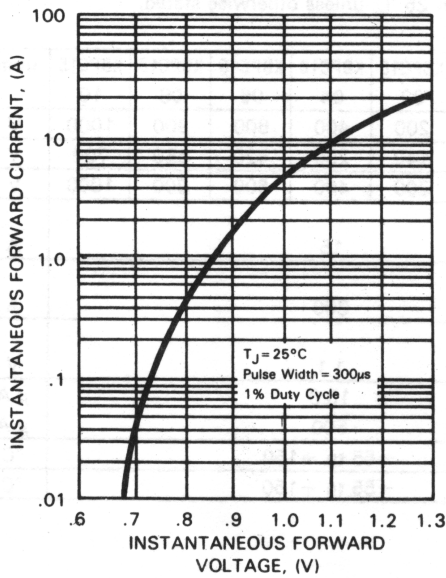

FIG. 4 - TYPICAL REVERSE CHARACTERISTICS

