

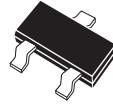

CMPS5061
 CMPS5062
 CMPS5063
 CMPS5064

**SURFACE MOUNT
 SILICON CONTROLLED RECTIFIER**



SOT-23 CASE

CentralTM Semiconductor Corp.

DESCRIPTION:

The CENTRAL SEMICONDUCTOR CMPS5061 Series types are epoxy molded PNP Silicon Controlled Rectifiers manufactured in an SOT-23 case, designed for control systems and sensing circuit applications.

MARKING CODES: CMPS5061: P2A
 CMPS5062: P2B
 CMPS5063: P2C
 CMPS5064: P2D

MAXIMUM RATINGS: (T_A=25°C)

Peak Repetitive Off-State Voltage
 Peak Repetitive Reverse Voltage
 RMS On-State Current
 Average On-State Current (T_C=67°C)
 Power Dissipation
 Operating Junction Temperature
 Storage Temperature
 Thermal Resistance

SYMBOL	CMPS 5061	CMPS 5062	CMPS 5063	CMPS 5064	UNITS
V _{DRM}	100	200	300	400	V
V _{RPM}	100	200	300	400	V
I _{T(RMS)}		0.80			A
I _{T(AV)}		0.51			A
P _D		350			mW
T _J		-65 to +125			°C
T _{stg}		-65 to +150			°C
θ _{JA}		286			°C/W

ELECTRICAL CHARACTERISTICS: (T_A=25°C)

SYMBOL TEST CONDITIONS

I_{DRM} V_D=Rated V_{DRM}, R_{GK}=1.0KΩ
 I_{RPM} V_D=Rated V_{DRM}, R_{GK}=1.0KΩ
 I_{DRM} V_D=Rated V_{DRM}, R_{GK}=1.0KΩ, T_C=125°C
 I_{RPM} V_D=Rated V_{DRM}, R_{GK}=1.0KΩ, T_C=125°C
 V_{TM} I_T=1.2A
 I_{GT} V_D=7.0V, R_L=100Ω
 V_{GT} V_D=7.0V, R_L=100Ω
 V_{GD} V_D= Rated V_{DRM}, R_L=100Ω, T_C=125°C
 I_H R_{GK}=1.0KΩ
 t_{ON} V_D= Rated V_{DRM}, I_{GT}=1.0mA,
 R_{GK}=1.0KΩ, di/dt=6.0A/μs

	CMPS5061		CMPS5062		CMPS5063		CMPS5064		
	MIN	MAX	MIN	MAX	MIN	MAX	MIN	MAX	UNITS
I _{DRM}	-	1.0	-	1.0	-	1.0	-	1.0	μA
I _{RPM}	-	1.0	-	1.0	-	1.0	-	1.0	μA
I _{DRM}	-	50	-	50	-	50	-	50	μA
I _{RPM}	-	50	-	50	-	50	-	50	μA
V _{TM}	-	1.7	-	1.7	-	1.7	-	1.7	V
I _{GT}	-	200	-	200	-	200	-	200	μA
V _{GT}	-	0.8	-	0.8	-	0.8	-	0.8	V
V _{GD}	0.1	-	0.1	-	0.1	-	0.1	-	V
I _H	-	5.0	-	5.0	-	5.0	-	5.0	mA
t _{ON}		2.8 TYP		2.8 TYP		2.8 TYP		2.8 TYP	μs

**SURFACE MOUNT
SILICON CONTROLLED RECTIFIER**

SOT-23 CASE - MECHANICAL OUTLINE

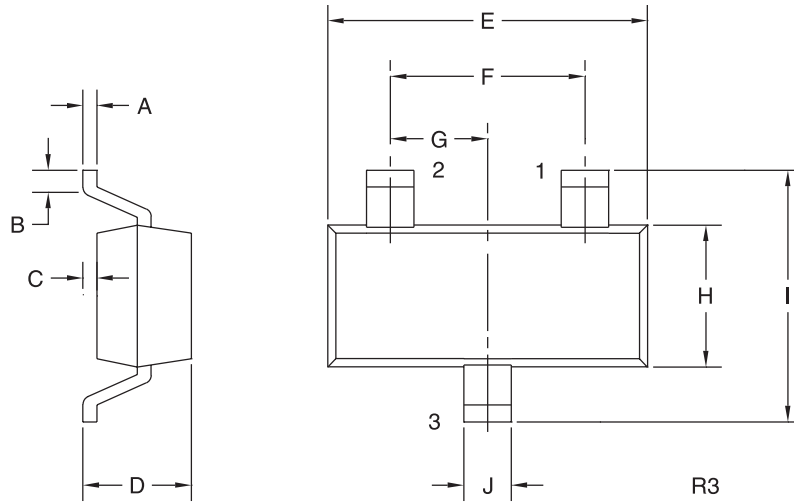

LEAD CODE:

- 1) CATHODE
- 2) GATE
- 3) ANODE

MARKING CODES:

- CMPS5061: P2A
- CMPS5062: P2B
- CMPS5063: P2C
- CMPS5064: P2D

DIMENSIONS				
SYMBOL	INCHES		MILLIMETERS	
	MIN	MAX	MIN	MAX
A	0.003	0.007	0.08	0.18
B	0.006	-	0.15	-
C	-	0.005	-	0.13
D	0.035	0.043	0.89	1.09
E	0.110	0.120	2.80	3.05
F	0.075		1.90	
G	0.037		0.95	
H	0.047	0.055	1.19	1.40
I	0.083	0.098	2.10	2.49
J	0.014	0.020	0.35	0.50

SOT-23 (REV: R3)