

D-Sub Right Angle DIP Termination

17LE Series



17LE-13150-2 □ -FA



17LE-23250-2 □ -FA



17LE-13370-2 □ -FA

FEATURES

- 17LE series are connected to a circuit by through hole DIP solder termination style mounting on PCB and fastened on the bracket by stud or jack socket.
- Number of contact : 9, 15, 25 and 37
- Studs and hex nuts are available to fasten with mating half. This connection with PCB and metal shell is grounding and improving the resistance against EMI.
- The metal shell is in Nickel plating. The pin connectors of metal shell are beat-finished.
- 4 types of ground tabs are mountable on the bracket for protection against EMI.

SPECIFICATIONS

Rated Voltage	300V AC (r.m.s.)
Rated Current	5A / Contact
Dielectric Withstanding Voltage	1000V AC (r.m.s.) / 1 minute
Insulation Resistance	1000M Ω (min.) at 500V DC
Contact Resistance	15m Ω (max.)
Operating Temperature	-25°C~ 85°C

MATERIAL / FINISH



Item	Material / Finish
Insulator	Polyamide Resin (UL94V-0) / Black
Shell	Steel / Ni Plating
Contact	Copper Alloy / Contact Area: Au(0.4 μ m) over Ni Plating Tail Area: Sn-Ag Plating over Ni Plating
Eyelet	Brass / Ni Plating

© Specifications and/or dimensions in this catalogue are subject to change without notice.
Your catalogue checking the latest specifications with our drawings would be highly appreciated.

▶ Right Angle Socket Connectors

17LE-13250-27(D3AB)-FA

- Mating Style
1 : Socket Connector
- Shell Plating
3 : Ni Plating
- Number of Contact
9, 15, 25, 37
- Key Position
0: No Key
- Contact Tail Style
2: Right Angle DIP Termination
- Contact Plating
6: Contact Area: Au(0.8 μ m) over Ni Plating
Tail Area: Sn-Ag over Ni Plating
7: Contact Area: Au(0.4 μ m) over Ni Plating
Tail Area: Sn-Ag over Ni Plating
8: Contact Area: Au(Flash) over Ni Plating
Tail Area: Sn-Ag over Ni Plating

FA: Lead Free

Deviation
 No Digit: Connector Only
 (D3AB)

 Grounding Tab (Please refer to page 4.)
 No Digit: Less Grounding Tab
 B : with Ground Tab 17L-004B
 C : with Board Lock 17L-004C-FA
 D : with Ground Tab 17L-004D
 ※ Ground tab B and D can not be combined with stud.

 Thread Size
 A : M2.6×0.45
 B : M3×0.5
 C : # 4-40UNC

- 2: with Stud Type1 (17L-002 □)
- 3: with Jack Socket Type 2 (17L-003 □ 1)
- 4: with Jack Socket Type 3 (17L-003 □ 3)
- : Thread Type A, B, C
- Regarding the combinations of grounding tab, stud and jack socket, please refer to the list on page 6.

17LE-13xx0-27(D3xx)-FA

Socket Connector

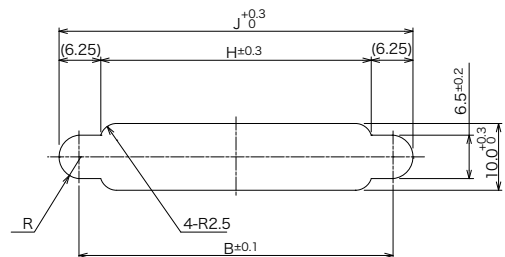
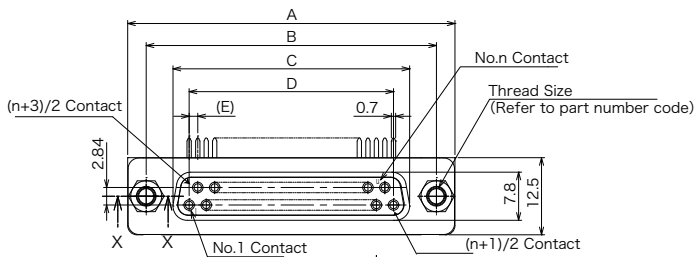

Panel Mounting Dimensions(Rear Mounting)

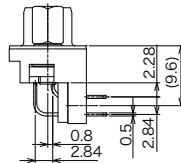
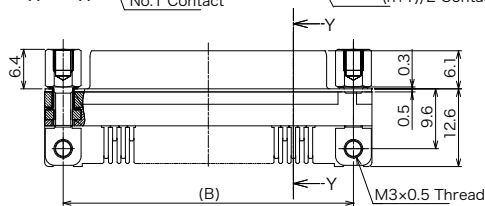

Section Y-Y

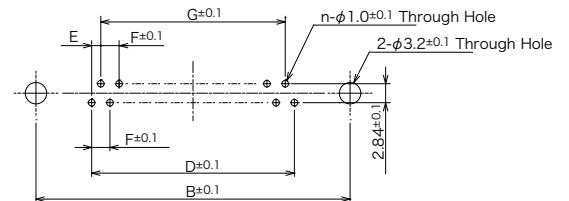
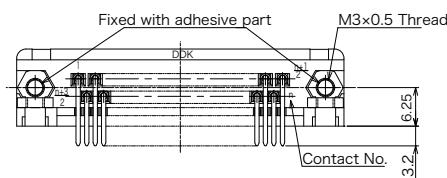
 PCB Mounting Dimensions
 (Applicable PCB Thickness: t = 1.6±0.19)
 (View from mounting pattern side)

Number of Contact	A	B	C	D	E	F	G	H	J
9	30.80	24.99	16.80	10.98	1.37	2.74	8.22	18.50	31.00
15	39.10	33.32	25.12	19.20	1.37	2.74	16.44	26.80	39.30
25	53.04	47.04	38.84	33.12	1.38	2.76	30.36	40.70	53.20
37	69.32	63.50	55.30	49.68	1.38	2.76	46.92	57.00	69.50

© Specifications and/or dimensions in this catalogue are subject to change without notice.
 Your catalogue checking the latest specifications with our drawings would be highly appreciated.

▶ Right Angle Plug Connectors

17LE-23250-27(D3AB)-FA

Connector Type
2: Plug Connector

Shell Plating
3: Ni Plating

Number of Contact
9, 15, 25, 37

Key Position
0: No Key

Contact Tail Style
2: Right Angle DIP Termination

Contact Plating
6: Contact Area: Au(0.8 μm) over Ni Plating
Tail Area: Sn-Ag over Ni Plating
7: Contact Area: Au(0.4 μm) over Ni Plating
Tail Area: Sn-Ag over Ni Plating
8: Contact Area: Au(Flash) over Ni Plating
Tail Area: Sn-Ag over Ni Plating

FA: Lead Free

Deviation
No Digit: Connector Only
(D3AB)

Grounding Tab (Please refer to page 4.)
No Digit: Less Grounding Tab
B : with Ground Tab 17L-004B
C : with Board Lock 17L-004C-FA
D : with Ground Tab 17L-004D
※ Ground tab B and D can not be combined with stud.

Thread Size
A : M2.6×0.45
B : M3×0.5
C : # 4-40UNC

2: with Stud Type1 (17L-002 □)
3: with Jack Socket Type 2 (17L-003 □ 1)
4: with Jack Socket Type 3 (17L-003 □ 3)
□ : Thread Type A, B, C
• Regarding the combinations of grounding tab, stud and jack socket, please refer to the list on page 6.

17LE-23xx0-27(D3xx)-FA

Plug Connector

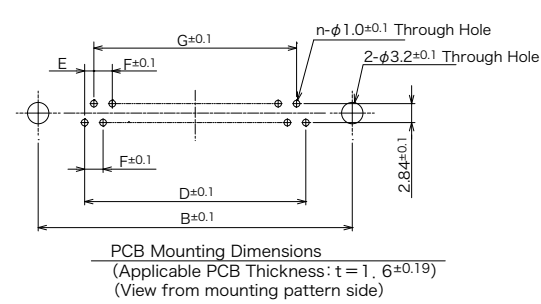
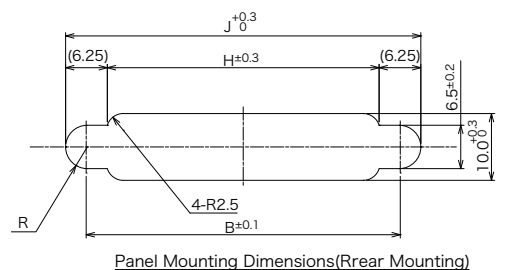
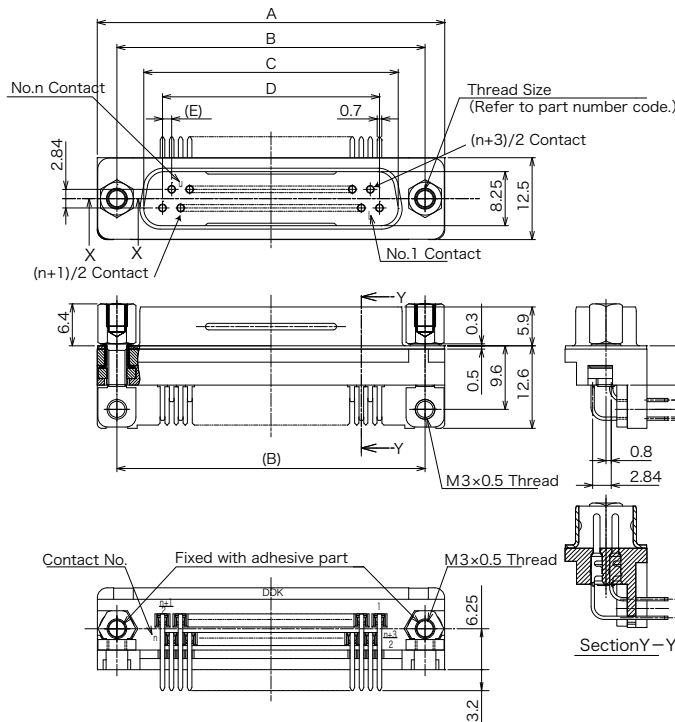

Number of Contact	A	B	C	D	E	F	G	H	J
9	30.80	24.99	16.80	10.98	1.37	2.74	8.22	18.50	31.00
15	39.10	33.32	25.12	19.20	1.37	2.74	16.44	26.80	39.30
25	53.00	47.04	38.84	33.12	1.38	2.76	30.36	40.70	53.20
37	69.30	63.50	55.30	49.68	1.38	2.76	46.92	57.00	69.50

© Specifications and/or dimensions in this catalogue are subject to change without notice.
Your catalogue checking the latest specifications with our drawings would be highly appreciated.

▶ Ground Tab

Ground Tab for 17LE

Ground tab enables 17LE series to ground to PCB easily.

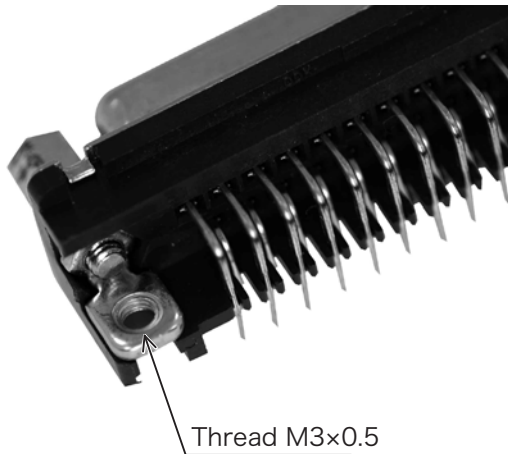

Ground Tab with Tapping Hole

Part Number : 17L-004B

Material / Finish: Steel / Ni Plating

※ Combination of stud 17L-002 □ is not available.

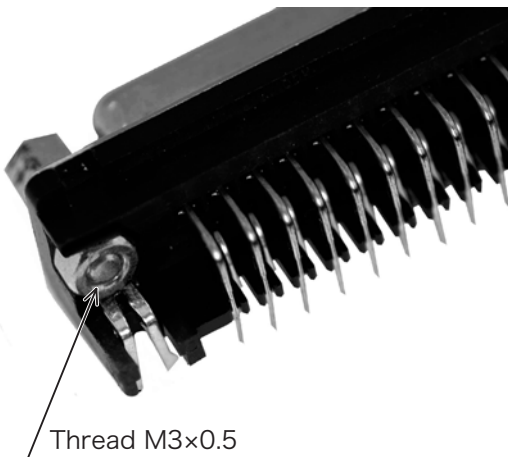

Ground Tab with Board Lock

Part Number : 17L-004C-FA

Material / Finish: Copper Alloy / Sn-Ag Plating



Ground Tab with Through Hole

Part Number : 17L-004D

Material / Finish: Steel / Ni Plating

※ Combination of stud 17L-002 □ is not available.

▶ Mounting on Panel and PCB

(□ : Thread Size)

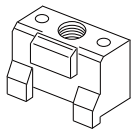

Stud (17L-002 □)

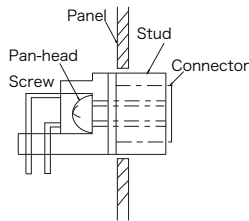

Type 1

Panel Mounting Dimensions

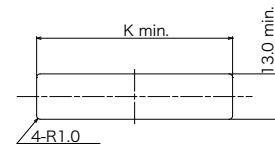

※ Connector can not be fastened on the panel.

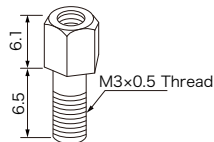

Jack Socket (17L-003 □ 1)

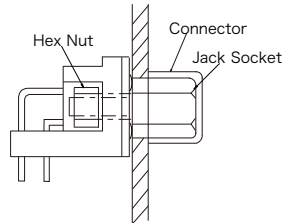

Type 2

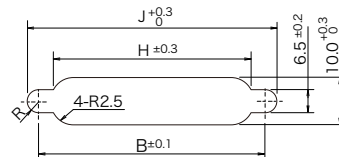

※ Connector can not be fastened on the panel.

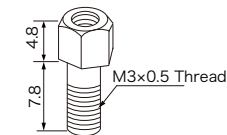

Jack Socket (17L-003 □ 3)

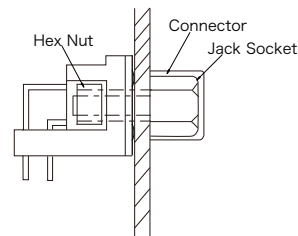

Type 3

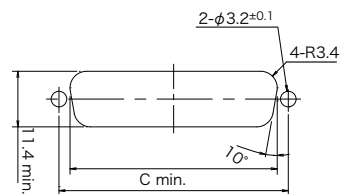

※ Connector can be fastened on the panel.
(Panel Thickness : 0.8 ~ 1.3)

- : Thread Size
- A : M2.6x0.45
- B : M3x0.5
- C : #4-40UNC

Number of Contact	B	C	H	J	K
9	24.99	16.30	18.50	31.0	34.09
15	33.32	24.64	26.80	39.3	42.42
25	47.04	38.35	40.70	53.2	56.14
37	63.50	54.80	57.00	69.5	72.60

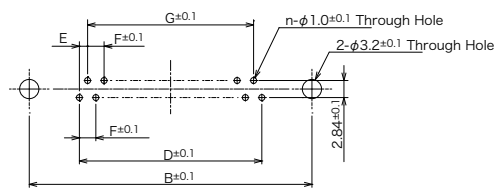
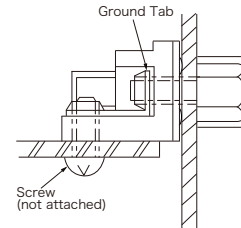
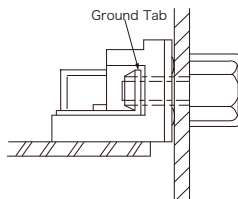
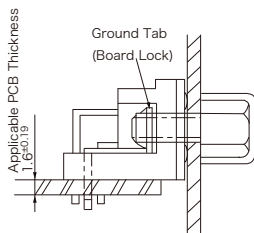

PCB Mounting Dimensions
(Applicable PCB Thickness: t = 1.6 ± 0.19)
(View from mounting pattern side)

Number of Contact	B	D	E	F	G
9	24.99	10.98	1.37	2.74	8.22
15	33.32	19.20	1.37	2.74	16.44
25	47.04	33.12	1.38	2.76	30.36
37	63.50	49.68	1.38	2.76	46.92

© Specifications and/or dimensions in this catalogue are subject to change without notice.
Your catalogue checking the latest specifications with our drawings would be highly appreciated.

▶ 17LE Series Mounting Accessories Deviation

※ ASSEMBLED: The mounting accessories are assembled with connector.

ATTACHED: The mounting accessories are attached separately.

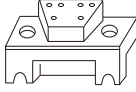
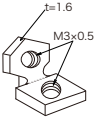
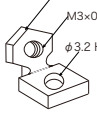
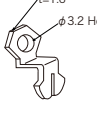
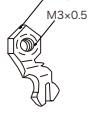
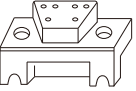
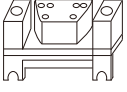
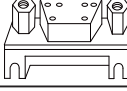
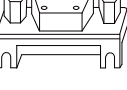
		17LE-13 □ □ 0-27-FA 17LE-23 □ □ 0-27-FA				
Panel Mounting Operation	Ground Tab Part Number	None	17L-004B	17L-004D	17L-004C-FA	17L-004E-FA
	Stud Jack Socket Part Number					
	None					Press in ground tab 17L-004E-FA 17LE- □ 3 □ □ 0-27(D41)-FA
Type 1 Connector can not be fastened on the panel. 	17L-002 □	Stud 17L-002 □ and pan-head screw(L=6) are ASSEMBLED. 17LE- □ 3 □ □ 0-27(D2 □)-FA			Ground tab 17L-004C-FA is fastened by stud 17L-002 □ and pan-head screw (L=7). 17LE- □ 3 □ □ 0-27(D2 □ C)-FA	
Type 2 Connector can not be fastened on the panel. To prevent loosening, screws are locked by adhesive. 	17L-003 □ 1	Jack socket 17L-003 □ 1 and hex nut(M3) are ASSEMBLED. 17LE- □ 3 □ □ 0-27(D3 □ B)-FA	Press in ground tab 17L-004B and jack socket 17L-003 □ 1 is ASSEMBLED. 17LE- □ 3 □ □ 0-27(D3 □ B)-FA	Press in ground tab 17L-004D and jack socket 17L-003 □ 1 is ASSEMBLED. 17LE- □ 3 □ □ 0-27(D3 □ D)-FA	Ground tab 17L-004C-FA is fastened by jack socket 17L-003 □ 1 and hex nut(M3). 17LE- □ 3 □ □ 0-27(D3 □ C)-FA	Press in ground tab 17L-004E-FA and jack socket 17L-003 □ 1 is ASSEMBLED. 17LE- □ 3 □ □ 0-27(D3 □ H)-FA Press in ground tab 17L-004E-FA and 17L-003 □ 1 is ATTACHED. 17LE- □ 3 □ □ 0-27(D3 □ K)-FA
Type 3 Connector can be fastened on the panel. Panel thickness: 1.3 max. 	17L-003 □ 3	Jack socket 17L-003 □ 3 and hex nut(M3) are ASSEMBLED. 17LE- □ 3 □ □ 0-27(D4 □)-FA	Press in ground tab 17L-004B and jack socket 17L-003 □ 3 is ASSEMBLED. 17LE- □ 3 □ □ 0-27(D4 □ B)-FA	Press in ground tab 17L-004D and jack socket 17L-003 □ 3 is ASSEMBLED. 17LE- □ 3 □ □ 0-27(D4 □ D)-FA	Ground tab 17L-004C-FA is fastened by jack socket 17L-003 □ 3 and hex nut(M3). 17LE- □ 3 □ □ 0-27(D4 □ C)-FA	Press in ground tab 17L-004E-FA and jack socket 17L-003 □ 3 is ASSEMBLED. 17LE- □ 3 □ □ 0-27(D4 □ H)-FA Press in ground tab 17L-004E-FA and 17L-003 □ 3 is ATTACHED. 17LE- □ 3 □ □ 0-27(D4 □ K)-FA

Recommended
 Not available

□ : Thread Size (Stud)
 A : M2.6×0.45
 B : M3×0.5
 C : # 4-40UNC

※ Above list shows combinations of ground tab, stud and jack socket. The deviation is given in parenthesis in each sections. Regarding the detail, please contact our sales.