

# LVDS Oscillator

## CARDINAL COMPONENTS

Platinum Series CHL

- \* LVDS Output
- \* Fast Delivery
- \* Industry Standard Packaging

- Applications**
- \* Serial Communications
  - \* Routers
  - \* Switches
  - \* WAN Interfaces
  - \* Test Equipment

### Part Numbering Example: CHL Z - A5 BP - 222.5792 TS

| CHL    | Z                                 | A5  | BP                               | 222.5792  | TS             |
|--------|-----------------------------------|---|----------------------------------|-----------|----------------|
| SERIES | PACKAGING OPTIONS                 | OPERATING TEMP.   | STABILITY                        | FREQUENCY | TRI-STATE      |
| CHL    | Blank = Bulk<br>Z = Tape and Reel | Blank = 0°C ~ +70°C<br>A5 = -20°C ~ +70°C<br>A7 = -40°C ~ +85°C | Blank = ±100 ppm<br>BP = ±50 ppm |           | TS = Tri-State |

| Specifications:                           | Min                             | Typ  | Max        | Unit   |
|---|---------------------------------|------|------------|--------|
| Frequency Range:                          | 200                             |      | 800        | MHz    |
| Stability:                                | -50                             |      | + 50       | ppm    |
| Supply Voltage:                           | 3.135                           | 3.3  | 3.465      | V      |
| Vdd Rise Time:                            | 100                             |      |            | µS     |
| Operating Temperature:                    | -20                             |      | + 70       | °C     |
| Storage Temperature:                      | -55                             |      | + 125      | °C     |
| Duty Cycle:                               | 45                              |      | 55         | %      |
| Start-Up Time:                            |                                 | 3    | 10         | mS     |
| Aging: (ppm/1st Year)<br>Ta=25C, Vdd=3.3V |                                 |      | 5          | ppm    |
| Supply Current:                           |                                 |      | 140        | mA     |
| Short Circuit Current:                    |                                 | ± 50 |            | mA     |
| RMS Period Jitter:                        |                                 | 15   |            | pS     |
| RMS Integrated Jitter:<br>12kHz to 20MHz  |                                 | 20   |            | pS     |
| Phase Noise @ 10kHz:                      |                                 |      | -90        | dBc/Hz |
| Output Voltage:<br>Voh<br>Vol             |                                 |      | 1.6<br>0.9 | V<br>V |
| Output Differential Voltage:              | 240                             | 350  | 460        | mV     |
| Rise/Fall Time:                           |                                 | 0.4  | 0.8        | nS     |
| Output Level:                             | LVDS                            |      |            |        |
| Packaging:                                | Tape and Reel 1000 pcs per Reel |      |            |        |

### CHL

Dimensions are in mm

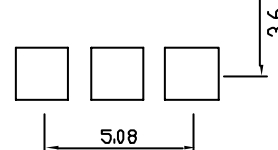
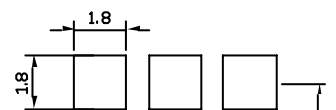
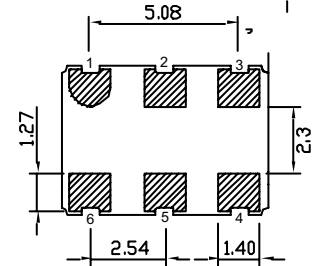
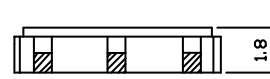
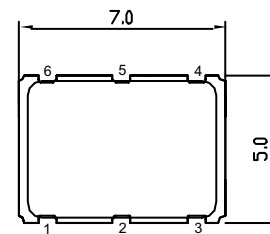

Solder Pad Layout

- PIN Function**
- 1 OE (CMOS)
  - 2 Do Not Connect
  - 3 Ground
  - 4 LVDS +
  - 5 LVDS -
  - 6 Vdd

### LVDS Levels Test Circuit

