

PLEASE CHECK WWW.MOLEX.COM FOR LATEST PART INFORMATION

Part Number: **0436500518**
Status: **Active**
Overview: [microfit_30](#)
Description: 3.00mm (.118") Pitch Micro-Fit 3.0™ Header, Surface Mount Compatible, Single Row, Vertical, with Press-fit Metal Retention Clip, 5 Circuits, Tin (Sn) Plating, Glow Wire Compatible

Documents:

| | |
|---|--|
| 3D Model | Product Specification PS-43650 (PDF) |
| Drawing (PDF) | RoHS Certificate of Compliance (PDF) |
| Packaging Specification (PDF) | |

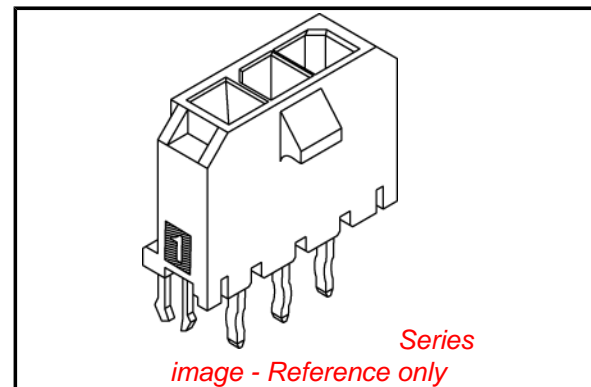

Agency Certification

| | |
|-----|-----------|
| CSA | LR19980 |
| TUV | R72081037 |
| UL | E29179 |

General

| | |
|-----------------------------|--|
| Product Family | PCB Headers |
| Series | 43650 |
| Application | Wire-to-Board |
| Comments | High Temperature Square Pin Offset Through Hole Mounting Solder Type |
| Overview | microfit_30 |
| Product Literature Order No | USA-106 |
| Product Name | Micro-Fit 3.0™ |

Physical

| | |
|--------------------------------|--------------------------------|
| Breakaway | No |
| Circuits (Loaded) | 5 |
| Circuits (maximum) | 5 |
| Color - Resin | Black |
| Durability (mating cycles max) | 30 |
| Flammability | 94V-0 |
| Glow-Wire Compliant | Yes |
| Mated Height (in) | 0.680 In |
| Mated Height (mm) | 17.27 mm |
| Material - Metal | Brass |
| Material - Plating Mating | Tin |
| Material - Plating Termination | Tin |
| Material - Resin | High Temperature Thermoplastic |
| Number of Rows | 1 |
| Orientation | Vertical |
| PCB Locator | Yes |
| PCB Retention | Yes |
| PCB Thickness Recommended (in) | 0.062 In |
| PCB Thickness Recommended (mm) | 1.60 mm |
| Packaging Type | Tray |
| Pitch - Mating Interface (in) | 0.118 In |
| Pitch - Mating Interface (mm) | 3.00 mm |
| Plating min: Mating (µin) | 100 |
| Plating min: Mating (µm) | 2.5 |
| Plating min: Termination (µin) | 100 |
| Plating min: Termination (µm) | 2.5 |
| Polarized to PCB | Yes |
| Shrouded | Fully |

EU RoHS

ELV and RoHS Compliant
REACH SVHC
Contains SVHC: No
Halogen-Free Status

China RoHS



Halogen-Free

Need more information on product environmental compliance?

Email productcompliance@molex.com
 For a multiple part number RoHS Certificate of Compliance, [click here](#)

Please visit the [Contact Us](#) section for any non-product compliance questions.

Search Parts in this Series

[43650Series](#)

Mates With

[43645 Micro-Fit 3.0™ Receptacle Housing](#)

| | |
|--------------------------------|---------------------------|
| Stackable | No |
| Surface Mount Compatible (SMC) | Yes |
| Temperature Range - Operating | -40°C to +105°C |
| Termination Interface: Style | Through Hole - Kinked Pin |

Electrical

| | |
|-------------------------------|------|
| Current - Maximum per Contact | 5A |
| Voltage - Maximum | 250V |

Solder Process Data

| | |
|--|------------------------------|
| Duration at Max. Process Temperature (seconds) | 30 |
| Lead-free Process Capability | SMC & Wave Capable (TH only) |
| Max. Cycles at Max. Process Temperature | 3 |
| Process Temperature max. C | 260 |

Material Info

Reference - Drawing Numbers

| | |
|-------------------------|---------------|
| Packaging Specification | PK-70873-0811 |
| Product Specification | PS-43650 |
| Sales Drawing | SD-43650-007 |

This document was generated on 05/26/2010

PLEASE CHECK WWW.MOLEX.COM FOR LATEST PART INFORMATION

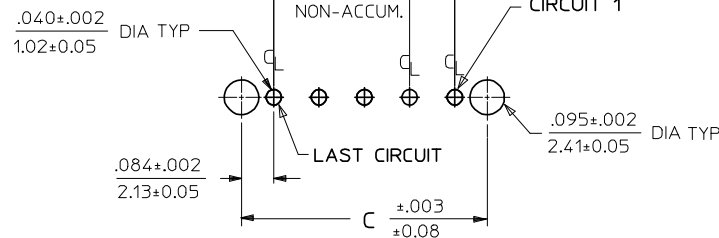
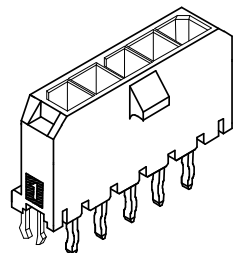
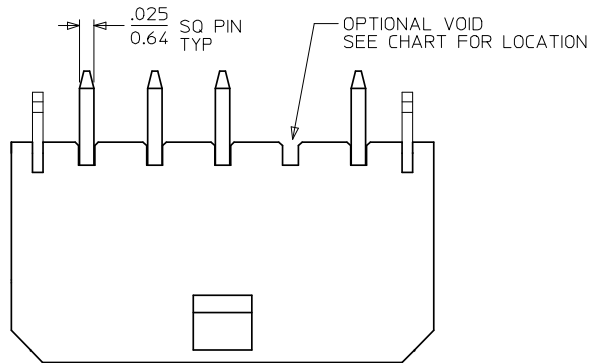

PCB LAYOUT: COMPONENT SIDE
RECOMMENDED PCB THICKNESS: .062/157

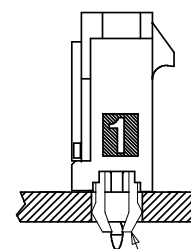
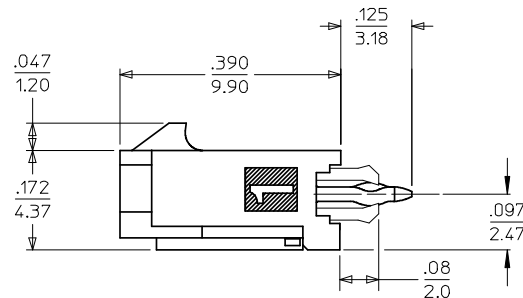
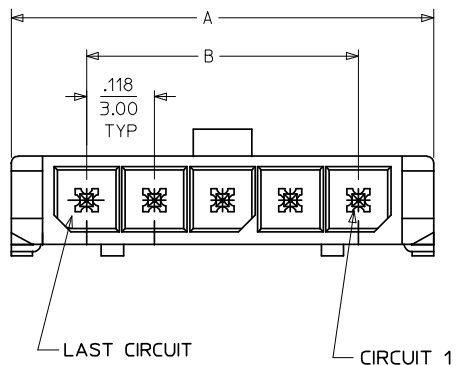

| CKTS | DIM A | DIM B | DIM C |
|------|----------------|----------------|----------------|
| 2 | .380 9.65 | .118 3.00 | .287 7.30 |
| 3 | .498 12.65 | .236 6.00 | .405 10.30 |
| 4 | .616 15.65 | .354 9.00 | .524 13.30 |
| 5 | .734 18.64 | .472 12.00 | .642 16.30 |
| 6 | .852 21.64 | .591 15.00 | .760 19.30 |
| 7 | .970 24.64 | .709 18.00 | .878 22.30 |
| 8 | 1.088 27.64 | .827 21.00 | .996 25.30 |
| 9 | 1.206 30.63 | .945 24.00 | 1.114 28.30 |
| 10 | 1.325 33.66 | 1.063 27.00 | 1.232 31.30 |
| 11 | 1.443 36.65 | 1.181 30.00 | 1.350 34.30 |
| 12 | 1.561 39.65 | 1.299 33.00 | 1.469 37.30 |

NOTES:

- HOUSING MATERIAL: LIQUID CRYSTAL POLYMER, GLASS FILLED, UL94V-0, COLOR: BLACK
TERMINAL MATERIAL: BRASS ALLOY
- FINISH:
A = .000100/(0.00254) MIN. BRIGHT TIN OVER
.000050/(0.00127) MIN. NICKEL
B = .000015/(0.00038) MIN. SELECT GOLD IN CONTACT AREA
.000100/(0.00254) MIN. SELECT MATTE TIN ON SOLDER TAILS
BOTH OVER .000050/(0.00127) NICKEL OVERALL
C = .000030/(0.00076) MIN. SELECT GOLD IN CONTACT AREA
.000100/(0.00254) MIN. SELECT MATTE TIN ON SOLDER TAILS
BOTH OVER .000050/(0.00127) NICKEL OVERALL
* THE PRIMARY SHIPPING CARTON WILL BE LABELED "COMPLIANT TO ROHS DIRECTIVE 2002/95/EC AND ELV ANNEX II OF DIRECTIVE 2000/53/EC." CARTONS WITHOUT THIS LABEL MAY CONTAIN PRODUCT WITH TIN/LEAD IN THE PC TAIL AREA.
- PRODUCT SPECIFICATION: PS-43650
- TRAY PACKAGED : SEE MOLEX DRAWING PK-70873-0811
- MATES WITH MICRO FIT (3.0) RECEPTACLE SERIES 43645
- PARTS CONFORM TO CLASS 'B' REQUIREMENTS OF COSMETIC SPECIFICATION PS-45499-002.

| CKTS | FINISH A | | FINISH B | | FINISH C | |
|------|--------------|----------|--------------|----------|--------------|----------|
| | MATERIAL NO: | VOID CKT | MATERIAL NO: | VOID CKT | MATERIAL NO: | VOID CKT |
| 02 | 43650-0218 | | 43650-0219 | | 43650-0220 | |
| 03 | 43650-0318 | | 43650-0319 | | 43650-0320 | |
| 04 | 43650-0418 | | 43650-0419 | | 43650-0420 | |
| 05 | 43650-0518 | | 43650-0519 | | 43650-0520 | |
| 06 | 43650-0618 | | 43650-0619 | | 43650-0620 | |
| 07 | 43650-0718 | | 43650-0719 | | 43650-0720 | |
| 08 | 43650-0818 | | 43650-0819 | | 43650-0820 | |
| 09 | 43650-0918 | | 43650-0919 | | 43650-0920 | |
| 10 | 43650-1018 | | 43650-1019 | | 43650-1020 | |
| 11 | 43650-1118 | | 43650-1119 | | 43650-1120 | |
| 12 | 43650-1218 | | 43650-1219 | | 43650-1220 | |
| 03 | 43650-0331 | 02 | | | | |
| 04 | 43650-1431 | 2,3 | 43650-0436 | 2,3 | | |
| 05 | 43650-1531 | 2,3,4 | | | | |
| 06 | | | 43650-0636 | 2,3,4,5 | | |

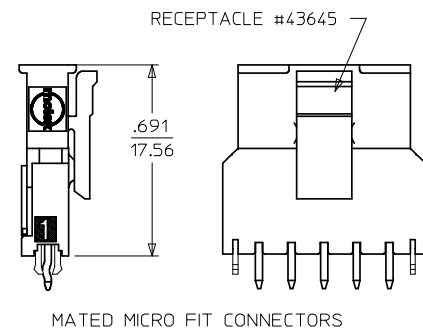

| CORRECT VIEWS EC NO: UCP2009-0450 DRAWINGVERILL 2008/08/20 CHKDKH/KIPPER 2008/08/22 APPR:FSM/LTH 2008/08/22 | QUALITY SYMBOLS ▽=0 ▽=0 | GENERAL TOLERANCES (UNLESS SPECIFIED) <table border="1"> <tr><th></th><th>mm</th><th>INCH</th></tr> <tr><td>4 PLACES ±</td><td>---</td><td>---</td></tr> <tr><td>3 PLACES ±</td><td>---</td><td>±.010</td></tr> <tr><td>2 PLACES ±</td><td>0.25</td><td>±.014</td></tr> <tr><td>1 PLACE ±</td><td>0.36</td><td>±---</td></tr> </table> | | mm | INCH | 4 PLACES ± | --- | --- | 3 PLACES ± | --- | ±.010 | 2 PLACES ± | 0.25 | ±.014 | 1 PLACE ± | 0.36 | ±--- | DIMENSION STYLE IN/MM DRAWN BY: SAMIEC DATE: 2000/07/07 CHECKED BY: MUELLER DATE: 2000/07/07 APPROVED BY: EDGLEY DATE: 2000/07/07 | SCALE --- DESIGN UNITS METRIC THIRD ANGLE PROJECTION | TITLE MICRO-FIT (3.0) SINGLE ROW / VERTICAL THRU HOLE / CLIPS / TRAY MOLEX INCORPORATED | DOCUMENT NO. SD-43650-007 SHEET NO. 1 OF 1 |
|--|--------------------------------------|--|------------|-----|------|------------|-----|-----|------------|-----|-------|------------|------|-------|-----------|------|------|---|---|---|---|
| | | | | mm | INCH | | | | | | | | | | | | | | | | |
| | | | 4 PLACES ± | --- | --- | | | | | | | | | | | | | | | | |
| 3 PLACES ± | --- | ±.010 | | | | | | | | | | | | | | | | | | | |
| 2 PLACES ± | 0.25 | ±.014 | | | | | | | | | | | | | | | | | | | |
| 1 PLACE ± | 0.36 | ±--- | | | | | | | | | | | | | | | | | | | |
| DRAFT WHERE APPLICABLE MUST REMAIN WITHIN DIMENSIONS | SEE CHART | | | | | | | | | | | | | | | | | | | | |
| THIS DRAWING CONTAINS INFORMATION THAT IS PROPRIETARY TO MOLEX INCORPORATED AND SHOULD NOT BE USED WITHOUT WRITTEN PERMISSION | | | | | | | | | | | | | | | | | | | | | |