

PLEASE CHECK WWW.MOLEX.COM FOR LATEST PART INFORMATION

Part Number: [0988211069](#)
Status: **Active**
Overview: [nsc](#)
Description: 3.33mm (.131") Pitch SCC Pin Housing for 1.5mm (.059") Tab, Non Sealed, 3 Circuits, Brown

Documents:

[Drawing \(PDF\)](#) [RoHS Certificate of Compliance \(PDF\)](#)

General

Product Family	Crimp Housings
Series	98821
Overview	nsc
Product Name	NSCC

Physical

Circuits (maximum)	6
Color - Resin	Brown
Gender	Receptacle
Glow-Wire Compliant	No
Keying to Mating Part	None
Lock to Mating Part	Yes
Number of Rows	1
Packaging Type	Bag
Panel Mount	No
Pitch - Mating Interface (in)	0.131 In, 0.165 In, 0.196 In
Pitch - Mating Interface (mm)	3.33 mm, 4.20 mm, 5.00 mm
Pitch - Term. Interface (in)	0.131 In, 0.165 In, 0.196 In
Pitch - Term. Interface (mm)	3.33 mm, 4.20 mm, 5.00 mm
Polarized to Mating Part	Yes
Ports	1
Stackable	No
Temperature Range - Operating	-40°C to +85°C

Material Info

Old Part Number	0104413211
-----------------	------------

Reference - Drawing Numbers

Sales Drawing	SD-98821-002
---------------	--------------



EU RoHS

**ELV and RoHS
Compliant**
**REACH SVHC
Not Reviewed**
**Halogen-Free
Status
Not Reviewed**

China RoHS



**Need more information on product
environmental compliance?**

Email productcompliance@molex.com
 For a multiple part number RoHS Certificate of Compliance, [click here](#)

Please visit the [Contact Us](#) section for any non-product compliance questions.

Search Parts in this Series

[98821Series](#)

Mates With

[98825106x](#) , [98770201x](#)

MOLEX P/N	0988211060
COLOR	WHITE

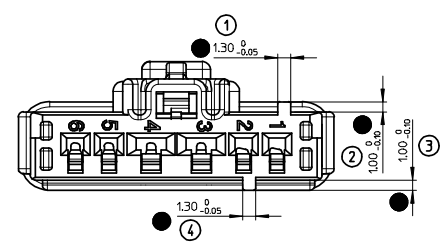

MOLEX P/N	0988211061
COLOR	BLACK

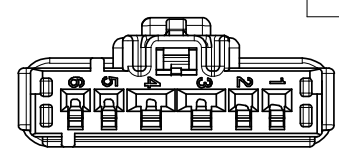

MOLEX P/N	0988211065
COLOR	GREEN

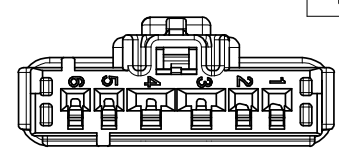

MOLEX P/N	0988211068
COLOR	GREY

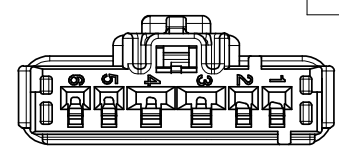

MOLEX P/N	0988211069
COLOR	BROWN

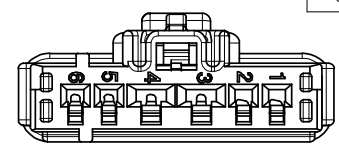

FEMALE CONTACT POSITION IN THE CAVITY AND CAVITIES POSITION
5:1

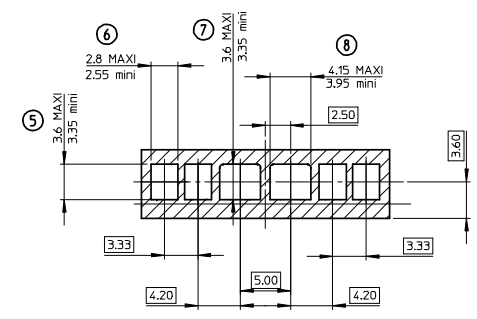

HOLDING IN FIXTURE DIMENSION PRIOR TO LOCKING
2:1

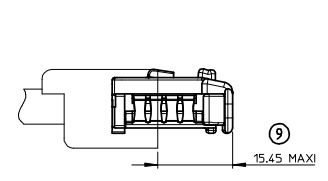

DIMENSION WHEN CONNECTOR MATE
2:1

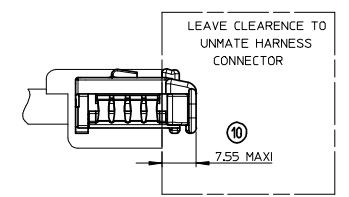

CLEARANCE FOR CONNECTOR MATE AND UNMATE
2:1

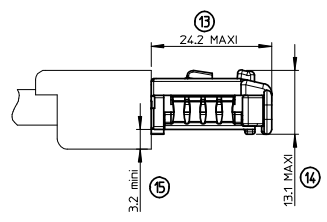
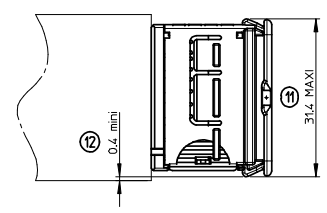

HOLDING IN FIXTURE
2:1

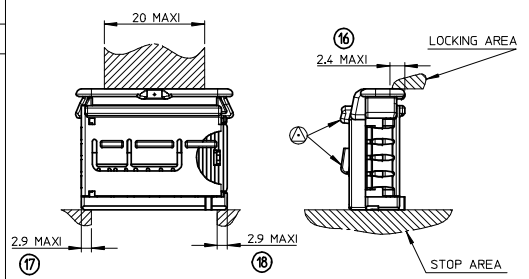

- Female connector will mate with male connector P/N 098825106x or header P/N 098770201x
- The using conditions of the hinge are showed in the MOLEX specification n° AS-98821-001.
- Holding force onto fixture :
20 to 35 Newton with push test.
10 to 35 Newton without push test.
- Do not lock the fixture with the area identified by ⚠
- Do not damage the part on the area identified by ⚠
- Female terminal used : see chart below.

MOLEX P/N			
SCC RCPT TERM 1.5 mm	Range 1	0988971109	
	Range 2	0988971119	
	Range 3	0988971129	
TERM RCPT 2.8 mm UCC2	Range 1		0988981029
	Range 2		0988981039
	Range 3		0988981049

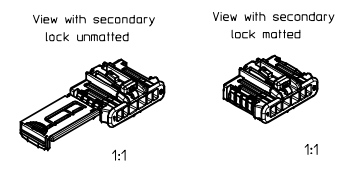

- ⊠ INDICATION DIMENSIONS S.P.C DENOTES S.P.C DIMENSIONS
- ⊗ INDICATION DIMENSIONS CRITIQUE DENOTES CRITICAL DIMENSIONS
- INDICATION DIMENSIONS FONCTIONNELLES DENOTES FUNCTIONAL DIMENSIONS
- QUANTITE PAR FEUILLE INDIVIDUELLE QUANTITY PER INDIVIDUAL SHEET
- ⊠ 0 ⊗ 0 ● 4

ENTER DESCRIPTION EC NO: GZ008-0Z40 DRAWN BY: LPOUCHAUD 2008/01/09 CHKD BY: YIGEL 2008/01/09 APPROVALS: LESTICKEIR 2008/01/10	QUALITY SYMBOLS	GENERAL TOLERANCES (UNLESS SPECIFIED)		DIMENSION STYLE MM ONLY		SCALE 4:1	DESIGN UNITS METRIC	THIRD ANGLE PROJECTION	
		4 PLACES ± --- ±.0002	mm	INCH	DRAWN BY LPOUCHAUD	DATE 2007/12/05	TITLE UCC RCPT CONN HYBRID UNSEALD 6CKT		
		3 PLACES ± --- ±.005	2 PLACES ± 0.05 ±.01	1 PLACE ± 0.10 ±---	CHECKED BY YIGEL	DATE 2007/12/12	MOLEX INCORPORATED		
		ANGULAR ± 1°		APPROVED BY LSTICKEIR		DATE 2007/12/17	DOCUMENT NO. SD-98821-002		
DRAFT WHERE APPLICABLE MUST REMAIN WITHIN DIMENSIONS		SEE CHART		MATERIAL NO.		SHEET NO. 1 OF 2			
THIS DRAWING CONTAINS INFORMATION THAT IS PROPRIETARY TO MOLEX INCORPORATED AND SHOULD NOT BE USED WITHOUT WRITTEN PERMISSION									

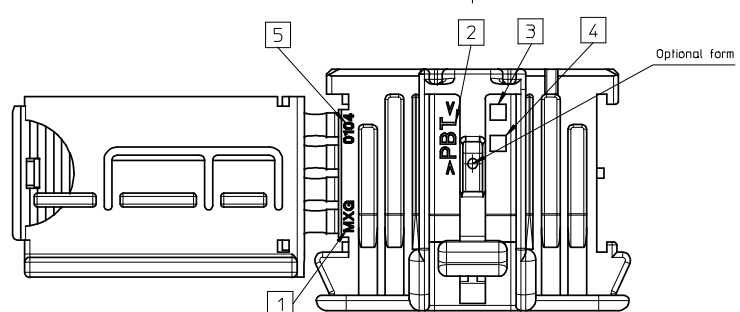
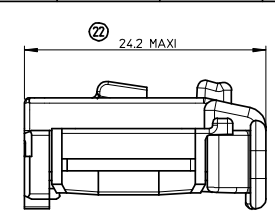
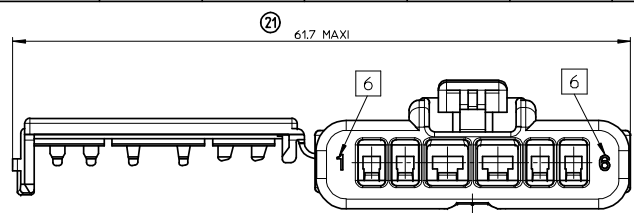
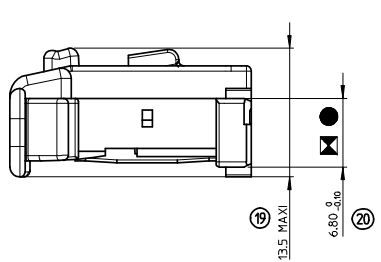

X-X

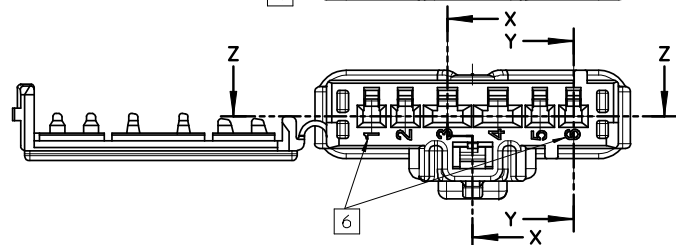
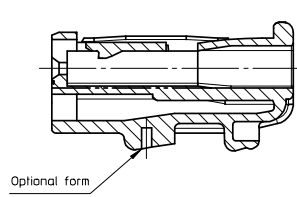

Y-Y

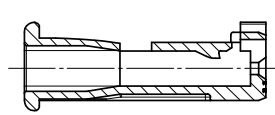

Z-Z

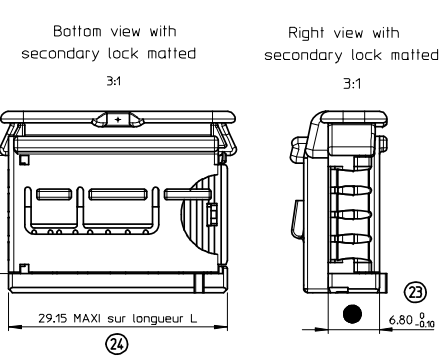
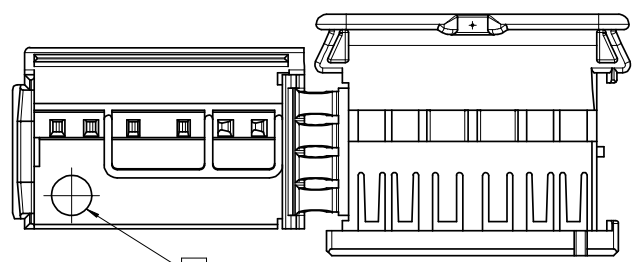
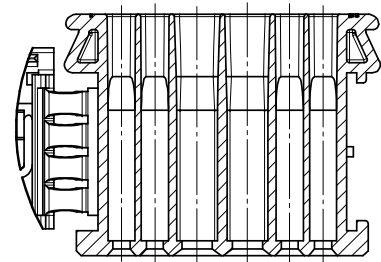

- FEMALE CONTACTS AND CAVITIES LOCATION.
HOLDING IN FIXTURE, OVERALL DIMENSIONS,
KEY ACCORDING SHEET 1/2 OF SAME PART NUMBER.

MARKS

- 1 - Supplier Engineering control ID
- 2 - Raw material
- 3 - Print number
- 4 - Supplier modification level
- 5 - Supplier part number
- 6 - Cavity number
- 7 - Datum month/year

INDICATION DIMENSIONS S.P.C DENOTES S.P.C DIMENSIONS
 INDICATION DIMENSIONS CRITIQUES DENOTES CRITICAL DIMENSIONS
 INDICATION DIMENSIONS FONCTIONNELLES DENOTES FUNCTIONAL DIMENSIONS
 QUANTITE PAR FEUILLE INDIVIDUELLE QUANTITY PER INDIVIDUAL SHEET
 1 0 2

UCC RCPT CONN Hybrid Unsealed 6CKT	0988211069	Brown	PBT UF NATURAL	3.37 g
	0988211068	Grey	UL94 HB	
	0988211065	Green	+ Masterbatch	
	0988211060	White		
	0988211061	Black		
Description	Part Number	Color	Raw material	Weight Effective

ENTER DESCRIPTION EC NO: GZ2008-0740 DRAWN BY: LPOUCHAUD 2008/01/09 CHKD BY: YIGEL 2008/01/09 APPR/STLKER: 2008/01/10	QUALITY SYMBOLS 	GENERAL TOLERANCES (UNLESS SPECIFIED)		DIMENSION STYLE MM ONLY		SCALE 4:1	DESIGN UNITS METRIC	THIRD ANGLE PROJECTION	
		4 PLACES ± --- ±.0002	mm	INCH	DRAWN BY	DATE	TITLE		
		3 PLACES ± --- ±.005			LPOUCHAUD	2007/12/05	UCC RCPT CONN HYBRID UNSEALED 6CKT		
		2 PLACES ± 0.05 ±.01			CHECKED BY	DATE			
1 PLACE ± 0.10 ±---			YIGEL	2007/12/12					
ANGULAR ± 1°		DRAFT WHERE APPLICABLE MUST REMAIN WITHIN DIMENSIONS		APPROVED BY LSTICKEIR	DATE 2007/12/17	MOLEX INCORPORATED DOCUMENT NO. SD-98821-002			
SEE CHART		THIS DRAWING CONTAINS INFORMATION THAT IS PROPRIETARY TO MOLEX INCORPORATED AND SHOULD NOT BE USED WITHOUT WRITTEN PERMISSION		MATERIAL NO.		SHEET NO. 2 OF 2			