

PLEASE CHECK WWW.MOLEX.COM FOR LATEST PART INFORMATION

Part Number: [0872036044](#)
Status: **Active**
Description: D-Subminiature Shielded I/O PCB Male Plug, Right Angle, Through Hole, 9 Circuits, M2.6 Inner Thread Screws Assembled, Gold (Au) 0.76µm (30µ")

Documents:

[Drawing \(PDF\)](#) [RoHS Certificate of Compliance \(PDF\)](#)

Agency Certification

CSA LR19980
 UL E29179

General

Product Family I/O Connectors
 Series [87203](#)
 Application Wire-to-Board
 Comments Shell: Steel
 Component Type Plug
 Product Name D-Sub, DB9
 Type N/A

Physical

Circuits (Loaded) 9
 Circuits (maximum) 9
 Flammability 94V-0
 Lock to Mating Part Yes
 Material - Plating Mating Gold
 Orientation Right Angle
 PC Tail Length (in) 0.125 In
 PC Tail Length (mm) 3.18 mm
 PCB Retention Yes
 PCB Thickness Recommended (in) 0.062 In
 PCB Thickness Recommended (mm) 1.60 mm
 Packaging Type Tray
 Panel Mount Yes
 Pitch - Mating Interface (in) 0.109 In
 Pitch - Mating Interface (mm) 2.77 mm
 Plating min: Mating (µin) 30
 Plating min: Mating (µm) 0.76
 Polarized to Mating Part Yes
 Polarized to PCB Yes
 Temperature Range - Operating -55°C to +85°C
 Termination Interface: Style Through Hole
 Wire Size AWG N/A

Electrical

Current - Maximum per Contact 1A
 Shielded Yes
 Voltage - Maximum 300V

Material Info

EU RoHS

Not RoHS Compliant

REACH SVHC

Not Reviewed

Halogen-Free

Status

Not Reviewed

China RoHS



Need more information on product environmental compliance?

Email productcompliance@molex.com
 For a multiple part number RoHS Certificate of Compliance, [click here](#)

Please visit the [Contact Us](#) section for any non-product compliance questions.

Search Parts in this Series

[87203Series](#)

Mates With

[87204](#)

ENG. NO SDA-87203-6***

EDP NO.

SIMILAR ITEM

CAD FILE : S872036

DO NOT SCALE DRAWING

PART NUMBER LEGEND

87203-6

CKT SIZE PLATING SCREW OPTION

*
0 : 9
1 : 15
2 :
3 : 25
4 : 37

*
1
2 :
3 : 25
4 : 37

*
1
2 :
3 : 25
4 : 37

1 2 pcs #4-40 round inner thread screw rivetted
2: Flush insert only
3: 2 pcs #4-40 hex inner thread screw assembled
4: 2 pcs M2.6 inner thread screw assembled
5: 2 pcs M3 inner thread screw assembled
6: 2 pcs #4-40 hex inner thread screw attached
7: 2 pcs M2.6 inner thread screw attached
8: 2 pcs M3 inner thread screw attached

4 : 30 MICRO INCH MINIMUM GOLD IN CONTACT AREA
50 MICRO INCH MINIMUM NICKEL ALL OVER
AND 100 MICRO INCH TIN/LEAD ON TAILS
5 : 15 MICRO INCH MINIMUM GOLD IN CONTACT AREA
50 MICRO INCH MINIMUM NICKEL ALL OVER
AND 100 MICRO INCH TIN/LEAD ON TAILS
6 : GOLD FLASH IN CONTACT AREA
AND 100 MICRO INCH TIN/LEAD ON TAILS

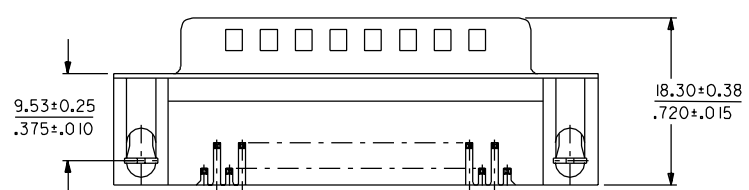
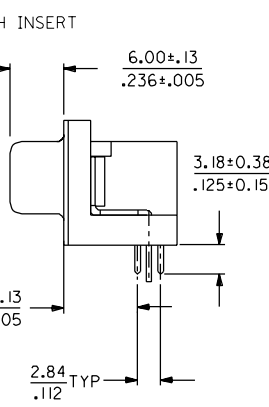
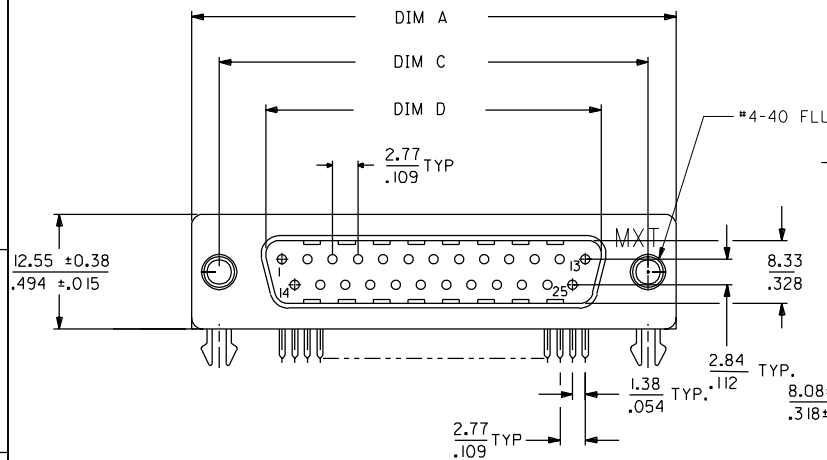

NOTES:

I. MATERIALS:

INSULATOR - POLYESTER GLASS FILLED, UL-94V-0
COLOR: BLACK, CONTACT - BRASS

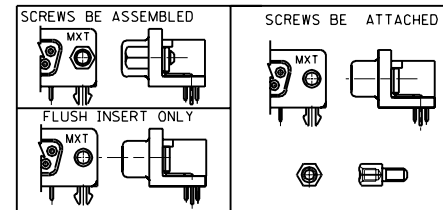

RECOMMENDED PCB LAYOUT

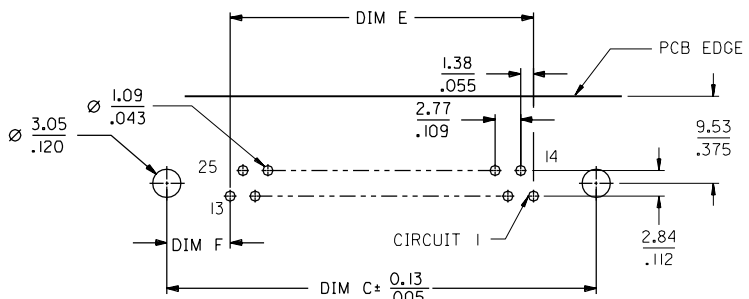

PCB LAYOUT: COMPONENT SIDE
RECOMMENDED PCB THICKNESS: 1.60 mm

CKT SIZE	DIM A	DIM C	DIM D	DIM E	DIM F
9	30.81	24.99	16.92	11.07	6.96
	1.213	.984	.666	.436	.274
15	39.14	33.32	25.25	19.38	6.97
	1.541	1.312	.994	.763	.274
25	53.04	47.04	38.96	33.22	6.91
	2.088	1.852	1.534	1.308	.272
37	69.32	63.50	55.45	49.83	6.84
	2.729	2.500	2.183	1.962	.269

P	CHANGE TERM. PLATING	T99-055	G.Wang	980828	MATERIAL :	SEE NOTE	<p>MOLEX TAIWAN LTD. SHEET 1 OF 1</p>
O	UPDATE THE OPTION	T98-276	NEIL	980224	FINISH :	---	
N	RELEASE TO MANUFACTURING	T97-379	NEIL	970506	WIRE RANGE :	---	GENERAL TOLERANCES ANGLE : ± 3° DIM : ± .25/.010
M	ERROR CORRECTION	196-158	NEIL	95/10/26	INS. RANGE :	---	ENG. NO. : SDA-87203-6***
L	PER ECN TA94-162		RICHARD	94/09/06	DRAWN BY C K	89/6/9	REV P
K	PER ECN TA94-012		WILSON	94/01/21	APPR'D BY	SCALE 1:1	TITLE : STANDARD D-SUB, MALE TYPE (FORK BOARD LOCK)
J	PER ECN TA93-025		WILSON	93/07/06			
I	PER ECN TA93-037		LYC	93/03/11			
LTR	REVISION RECORD	ECN	DR	DATE			

REVISE ONLY ON CAD SYSTEM