

PLEASE CHECK WWW.MOLEX.COM FOR LATEST PART INFORMATION

Part Number: [0351592000](#)
Status: **Active**
Description: 1.02/1.78mm (.040/.070") Tab Hybrid Housing for Audio, 20 Circuits

Documents:

[Drawing \(PDF\)](#) [RoHS Certificate of Compliance \(PDF\)](#)
[Product Specification PS-35316-001 \(PDF\)](#)

General

Product Family	Crimp Housings
Series	35159
Product Name	N/A

Physical

Circuits (maximum)	20
Color - Resin	Natural
Gender	Female
Glow-Wire Compliant	No
Material - Resin	Nylon
Number of Rows	2
Packaging Type	Bag
Panel Mount	No
Pitch - Mating Interface (in)	0.118 In
Pitch - Mating Interface (mm)	3.00 mm
Stackable	No
Temperature Range - Operating	-40°C to +105°C

Material Info

Reference - Drawing Numbers

Product Specification	PS-35316-001
Sales Drawing	SD-35159-001

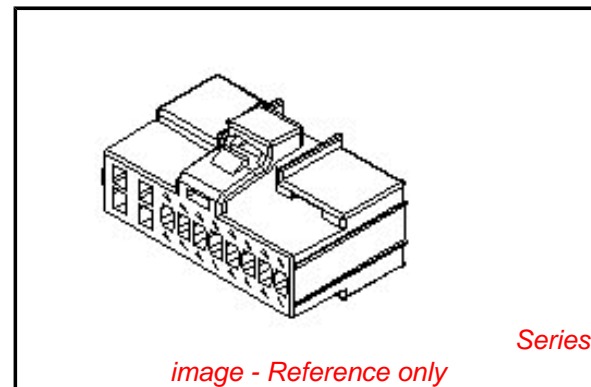

EU RoHS

**ELV and RoHS
Compliant**
**REACH SVHC
Contains SVHC: No**
**Halogen-Free
Status
Not Reviewed**

China RoHS



**Need more information on product
environmental compliance?**

Email productcompliance@molex.com
 For a multiple part number RoHS Certificate of Compliance, [click here](#)

Please visit the [Contact Us](#) section for any non-product compliance questions.

Search Parts in this Series

[35159Series](#)

Mates With

Audio

Use With

[35028](#) , [50350](#)

DO NOT SCALE DRAWING
DIMENSION IN METRIC

B

C

PROJECT NO.

SIMILAR ITEM

DWG. NO.

SD-35159-001

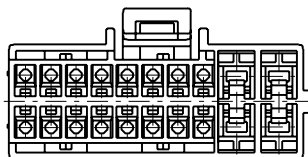
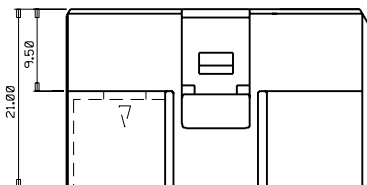
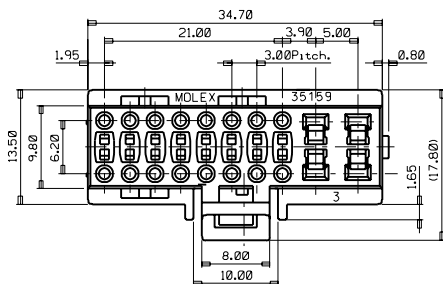

NOTE

- MATERIAL : POLYAMIDE (PA66) UL94 V-0.
COLOR: NATURAL
- MATED TERMINAL : 35028-***11
: 50350-*****
- MATED T.P.A : 35159-0892
- ENG. No. : 35159-2000

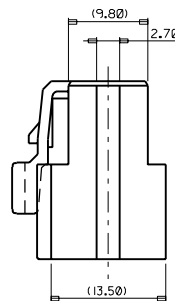

REVISED	QUALITY SYMBOLS
EC NO. KOR 999-0022	MAJOR $\nabla = 0$
DRWING: H.J.KIM 1999.03.12	CRITICAL $\nabla = 0$
CHK: B.K.CHOI 1999.04.14	
APPR: C.W.LEE 1999.04.14	
DESCRIPTION	
REV	

GENERAL TOLERANCES (UNLESS SPECIFIED)	
	M/M INCH
4 PLACES	± 0.1
3 PLACES	± 0.2
2 PLACES	± 0.20
1 PLACE	± 0.3
ANGULAR: $\pm 1.0^\circ$	
DRAFT WHERE APPLICABLE MUST REMAIN WITHIN DIMENSIONS	

SCALE	DESIGN UNITS
2.5/1	<input checked="" type="checkbox"/> mm <input type="checkbox"/> INCH
DRAWN BY & DATE	
C.Y. CHO 1995.07.10	
CHECKED BY & DATE	
B.K. CHOI 1999.04.14	
APPROVED BY & DATE	
C.W. LEE 1999.04.14	
CAD FILENAME	
SD35159.DGN	

DIMENSIONS:	
<input type="checkbox"/> mm	<input type="checkbox"/> INCH
<input type="checkbox"/> mm	<input type="checkbox"/> INCH
<input checked="" type="checkbox"/> mm	<input type="checkbox"/> INCH
THIRD ANGLE PROJECTION	

SHT	REV
	REVISE ON CAD ONLY
TITLE:	
HOUSING FOR 20P HYBRID CONN.	
MOLEX INCORPORATED KOREA	
CAD FILENAME	MATERIAL NO.
SD35159.DGN	351592000
DRAWING NO.	SHEET NO.
SD-35159-001	1/1
SIZE	B

8

7

6

5

4

3

2

MX-A3