

CHOKE

Power Chokes

8626-XXX



The 8626 series of SMD chokes is designed to cover an inductance range from 10µH to 1000µH with rated saturation currents from 0.18A to 1.84A. These are ideally suited for applications where shielding is required.

- DC/DC converters
- LCD displays
- PDA Palm Tops
- Telecommunication equipment etc.



Mechanical (All dimensions in millimeters)

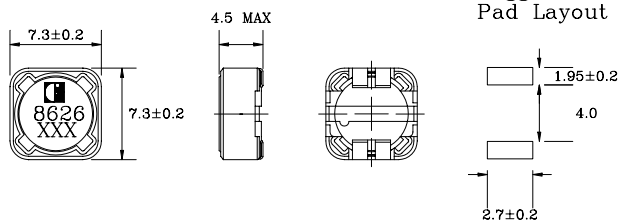

ELECTRICAL SPECIFICATION @ 25°C

Part Number	Inductance (µH)	DCR (Ω MAX)	Rated DC Current (A)	Part Number	Inductance (µH)	DCR (Ω MAX)	Rated DC Current (A)
8626-10B	10	49m	1.84	8626-10C	100	0.61	0.60
8626-12B	12	58m	1.71	8626-12C	120	0.66	0.52
8626-15B	15	81m	1.47	8626-15C	150	0.88	0.46
8626-18B	18	91m	1.31	8626-18C	180	0.98	0.42
8626-22B	22	0.11	1.23	8626-22C	220	1.17	0.36
8626-27B	27	0.15	1.12	8626-27C	270	1.64	0.34
8626-33B	33	0.17	0.96	8626-33C	330	1.86	0.32
8626-39B	39	0.23	0.91	8626-39C	390	2.85	0.29
8626-47B	47	0.26	0.88	8626-47C	470	3.01	0.26
8626-56B	56	0.35	0.75	8626-56C	560	3.62	0.23
8626-68B	68	0.38	0.69	8626-68C	680	4.63	0.22
8626-82B	82	0.43	0.61	8626-82C	820	5.20	0.20
				8626-10D	1000	6.00	0.18