



TAI-SAW TECHNOLOGY CO., LTD.

No. 3, Industrial 2nd Rd., Ping-Chen Industrial District,
Taoyuan, 324, Taiwan, R.O.C.

TEL: 886-3-4690038 FAX: 886-3-4697532

E-mail: tstsales@mail.taisaw.com Web: www.taisaw.com

Approval Sheet For Product Specification

Issued Date: Apr, 7, 2007

Product Name: SAW Filter 300 MHz SMD 5.0X7.0 mm

TST Parts No.: TB0633A

Customer Parts No.: _____

Company: _____
Division: _____
Approved by : _____
Date: _____

Checked by: _____ Bob Chau

Approval by: _____ Francis Chen

Date: _____ 4, 7, 2008



TAI-SAW TECHNOLOGY CO., LTD.

No. 3, Industrial 2nd Rd., Ping-Chen Industrial District,
Taoyuan, 324, Taiwan, R.O.C.

TEL: 886-3-4690038 FAX: 886-3-4697532

E-mail: tstsales@mail.taisaw.com Web: www.taisaw.com

SAW Filter 300 MHz

MODEL NO.:TB0633A

REV. NO.:1

A. MAXIMUM RATING:

1. Input Power Level: 20 dBm
2. DC Voltage : 5V
3. Operating Temperature: 0°C to +80°C
4. Storage Temperature: -40°C to +85°C

RoHS Compliant
Lead free
Lead-free soldering

B. ELECTRICAL CHARACTERISTICS:

Item	Unit	Min.	Type.	Max.	Note
Center frequency Fc	MHz	-	300	-	-
Min. Insertion loss, (Fc ±50KHz) ILc	dB	-	3.7	7.0	-
Passband Ripple (Fc ±50KHz)	dB	-	0.4	2	-
Return Loss (Fc ±50KHz) RL	dB	9.4	13.5	-	-
Attenuation (relative to ILc)					
Fc -25 to Fc -1.6 MHz	dB	50	62	-	-
Fc -1.6 to Fc -0.6 MHz	dB	28	62	-	-
Fc +0.6 to Fc +1.6 MHz	dB	28	53	-	-
Fc +1.6 to Fc +25 MHz	dB	50	57	-	-
Temperature coefficient of frequency TCf		-0.033 ppm/C ²			

C.OUTLINE DRAWING:

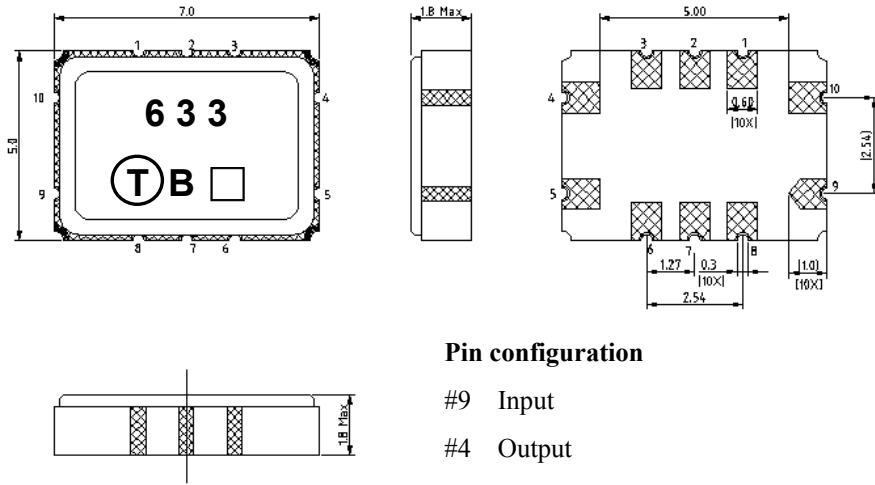

Pin configuration

- #9 Input
- #4 Output
- #10 Balance input or input ground
- #5 Balance output or output ground
- #1,2,3,6,7,8 To be grounded

□ Date code

Unit mm

Product Year Code

Year	2001 2005	2002 2006	2003 2007	2004 2008
Product Code	B	b	<u>B</u>	<u>b</u>

D. MEASUREMENT CIRCUIT:

50 Ohm Test circuit (single-ended / single-ended)

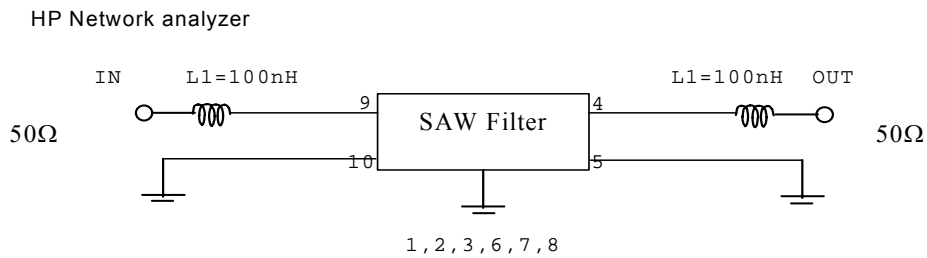

E. PCB Footprint:

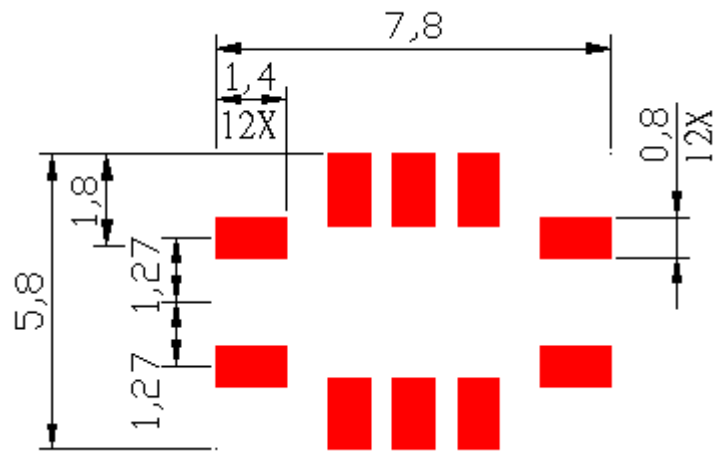

F. Frequency Characteristics :

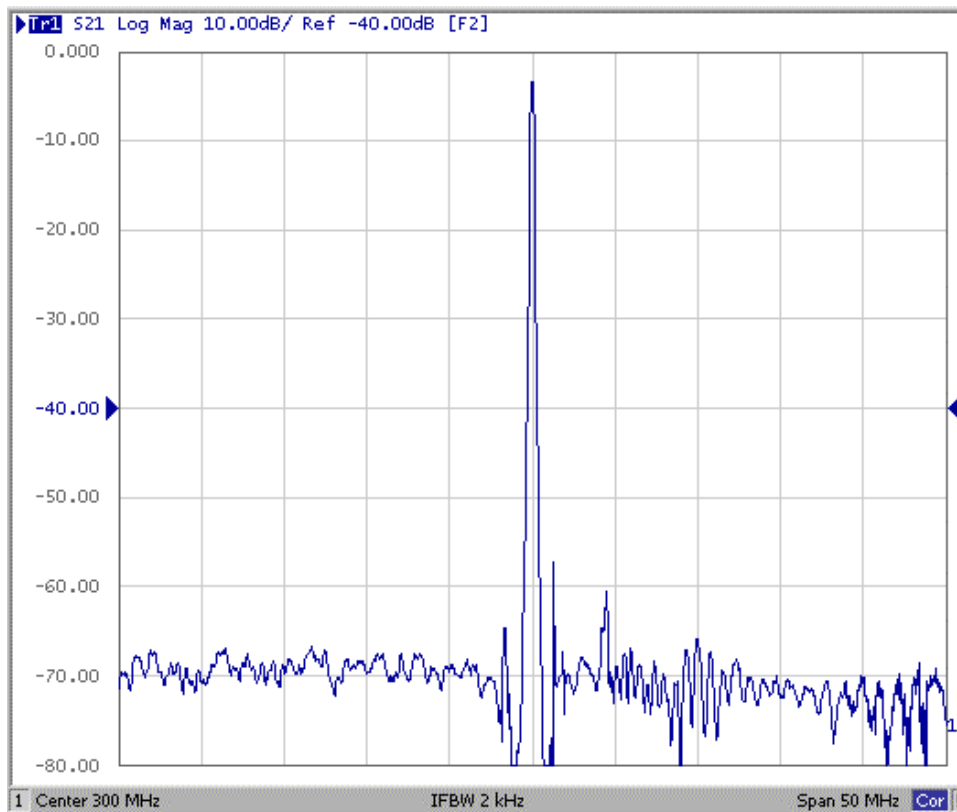
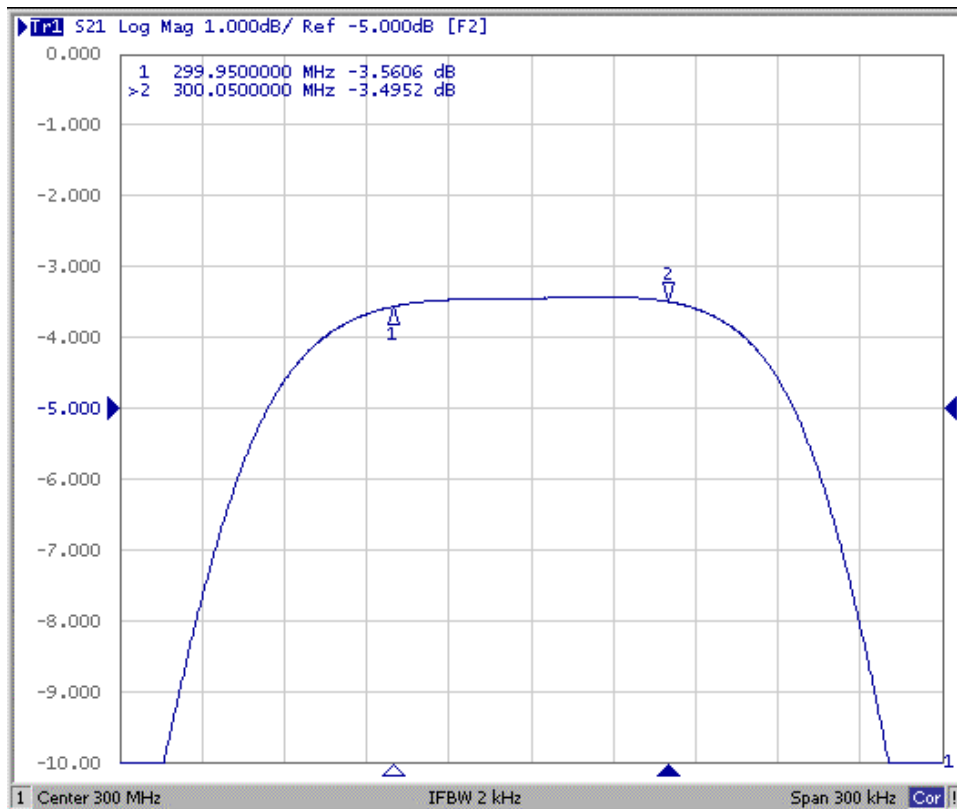

Reflection Functions :

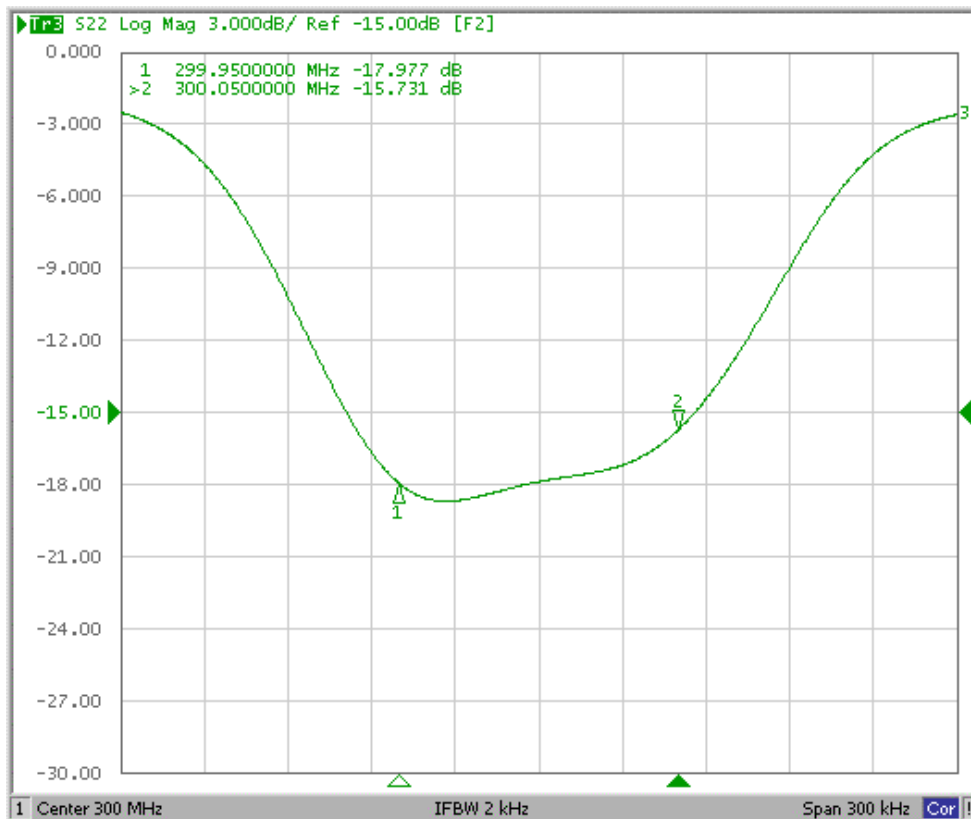
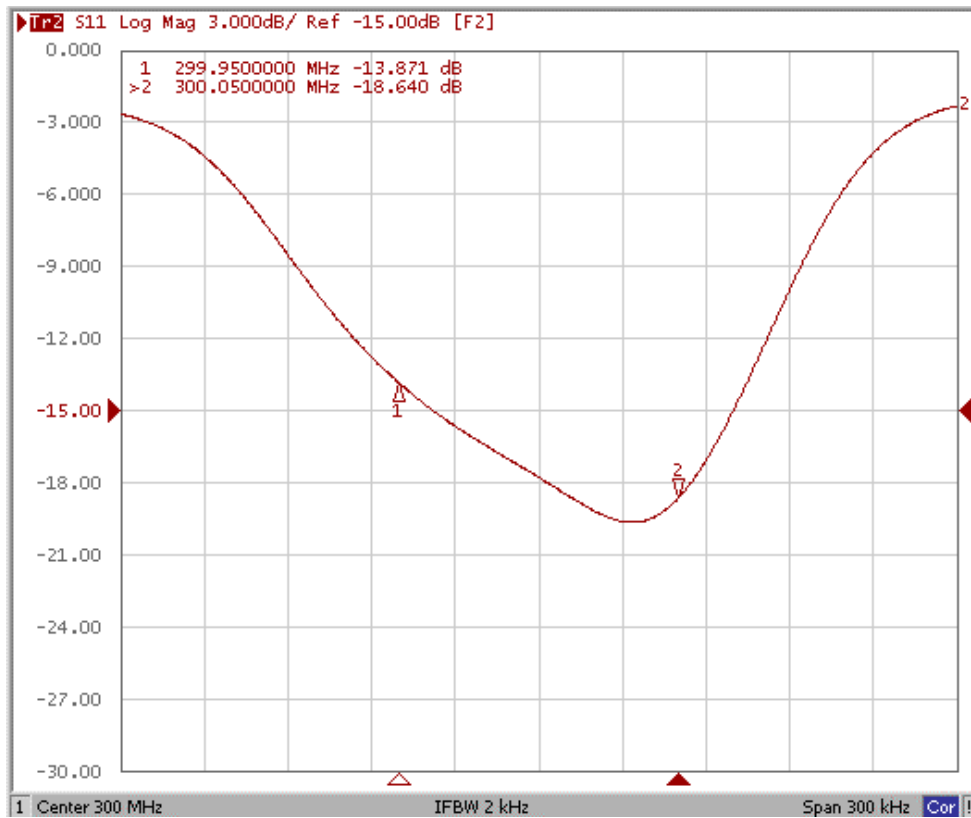

G. PACKING:
1. REEL DIMENSION

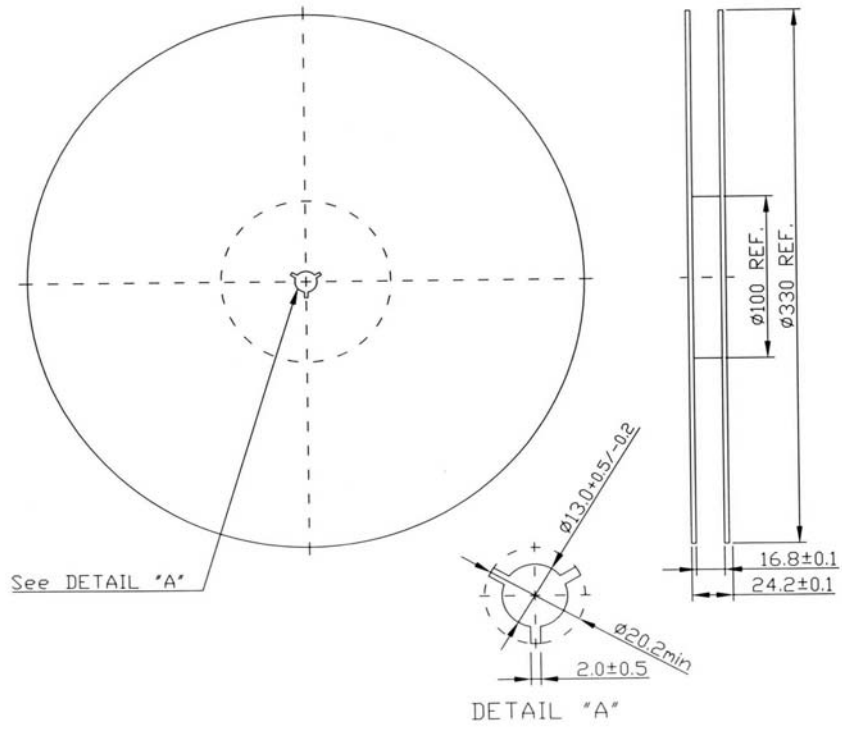

2. TAPE DIMENSION

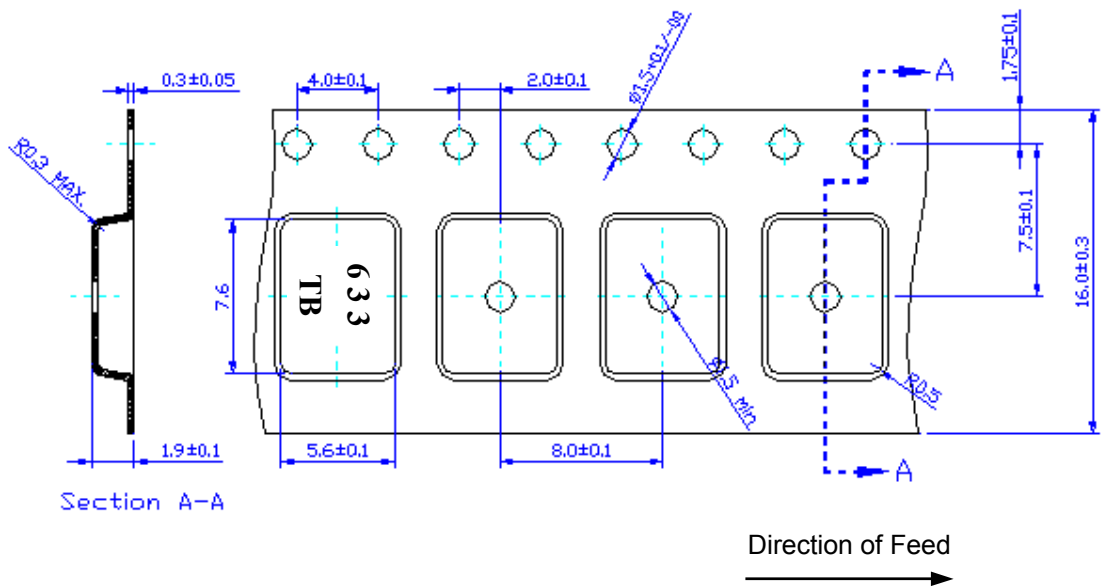

H. RECOMMENDED REFLOW PROFILE :

