

Ø 9,43" x 4,29" Ø 239,5 x 109 mm

61BE

ETRI®

400 Hz Fans

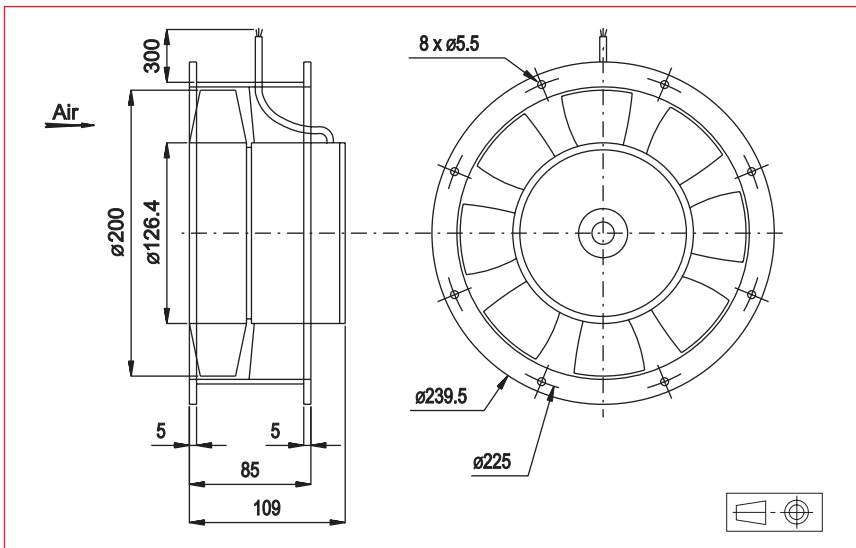

Approvals

NATO codification

Life expectancy

L-10 LIFE AT 40°C:
25 000 hours

400 Hz Motor

Housing material: aluminium
Impeller material: aluminium
Weight: 4,7 kg
Bearing system: ball bearings

Connection: flying leads

Available with:
- Safety switch

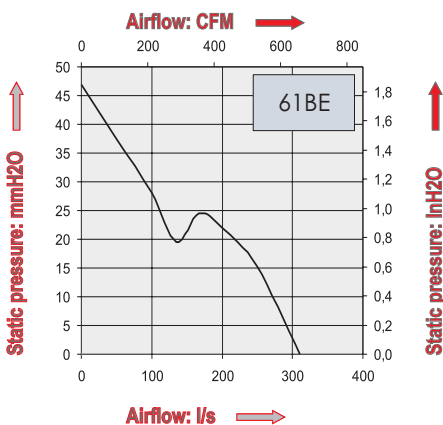

Part Number	Nominal voltage	Airflow	Noise level	Nominal speed	Phases	Capacitor (not included)	Input power	Nominal Current	Starting Current	Operating temperature	
	V	l/s	dB(A)	RPM		µF	W	mA	mA	Min.°C	Max.°C
61BE0162C13	115	310	68	3500	3		126	1800	3650	-10	70
	115	310	68	3500	1	5,7	134	1450	2800	-10	70
61BE0160C13	200	310	68	3500	3		126	1030	2100	-10	70
	200	310	68	3500	1	2	134	840	1600	-10	70

Additional versions:
Salt spray protected - Shock and vibration protected - Marine specifications
Wide temperature range

Accessories:
Refer to Accessories leaflet