



SPX5205

150mA, Low-Noise LDO Voltage Regulator

FEATURES

- Low Noise Output LDO: $40\mu V_{RMS}$ Possible
- 1% Initial Accuracy
- Very Low Quiescent Current: $70\mu A$
- Low Dropout Voltage (210mV at 150mA)
- Current and Thermal Limiting
- Reverse-Battery Protection
- Wide Range of Fix Output Voltages: 1.2V, 1.5V, 1.8V, 2.0V, 2.5V, 2.8V, 3.0V, 3.3V and 5.0V
- Zero Off-Mode Current
- Small 5-Pin SOT-23
- Pin Compatible to MIC5205/MAX8877 (fixed Options Only) and AS3815

APPLICATIONS

- PDA
- Battery Powered Systems
- Cellular Phone
- Cordless Telephones
- Radio Control Systems
- Laptop, Palmtop, and Notebook Computers
- Portable Consumer Equipment
- Portable Instrumentation
- Bar Code Scanners
- SMPS Post-Regulator

Fixed Output Voltage

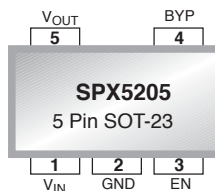

Adjustable Output Voltage

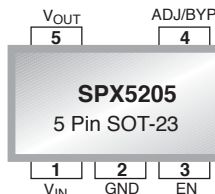

Now Available in Lead Free Packaging

DESCRIPTION

The SPX5205 is a positive voltage regulator with very low dropout voltage, output noise and ground current ($750\mu A$ at 100mA). V_{OUT} has a tolerance of less than 1% and is temperature compensated. Fixed output voltages 1.2V, 1.5V, 1.8V, 2.0V, 2.5V, 2.8V, 3.0V, 3.3V, and 5.0V and an adjustable version are available in a small 5-pin SOT-23 package. Other key features include zero off-mode current, reverse battery protection, thermal shutdown and current limit. The SPX5205 is an excellent choice for use in battery-powered applications, and where power conservation is desired such as: cellular/ cordless telephones, radio control systems, and portable computers.

TYPICAL APPLICATION CIRCUIT

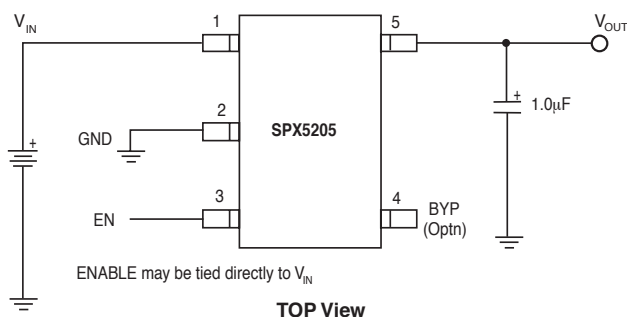

ABSOLUTE MAXIMUM RATINGS

| | | | |
|---|--------------------|----------------------------|--------------|
| Thermal Shutdown | Internally Limited | Input Supply Voltage | -20V to +20V |
| Lead Temperature (Soldering, 5 seconds) | 260°C | Enable Input Voltage | -20V to +20V |
| Operating Junction Temperature Range | -40°C to +125°C | | |

RECOMMENDED OPERATING CONDITIONS

| | |
|--|-----------------|
| Input voltage | +2.5V to 16V |
| Operating Junction Temperature Range | -40°C to +125°C |
| Enable Input Voltage | 0V to V_{IN} |
| SOT-23-5 (θ_{JA}) | See Note 1 |

ELECTRICAL CHARACTERISTICS

$T_J=25^\circ\text{C}$, $V_{IN} = V_{OUT} + 1\text{V}$, $I_L = 100\mu\text{A}$, $C_L = 1\mu\text{F}$, and $V_{ENABLE} \geq 2.4\text{V}$. The \blacklozenge denotes the specifications which apply over full temperature range -40°C to $+85^\circ\text{C}$, unless otherwise specified.

| PARAMETER | MIN | TYP | MAX | UNITS | CONDITIONS |
|--|----------|-----------|--------------|-----------------------|---|
| Output Voltage Tolerance (V_{OUT}) | -1 -2 | | +1 +2 | % V_{NOM} | \blacklozenge |
| Output Voltage Temperature Coefficient | | 57 | | ppm/ $^\circ\text{C}$ | \blacklozenge |
| Line Regulation | | 0.03 | 0.1 0.2 | %/V | \blacklozenge $V_{IN} = V_{OUT} + 1\text{V}$ to 16V |
| Load Regulation | | 0.1 | 0.2 0.5 | % | \blacklozenge $I_L = 0.1\text{mA}$ to 150mA |
| Dropout Voltage (See Note 2) ($V_{IN} - V_O$) | | 30 | 50 70 | mV | \blacklozenge $I_L = 100\mu\text{A}$ |
| | | 140 | 190 230 | mV | \blacklozenge $I_L = 50\text{mA}$ |
| | | 180 | 250 300 | mV | \blacklozenge $I_L = 100\text{mA}$ |
| | | 210 | 275 350 | mV | \blacklozenge $I_L = 150\text{mA}$ |
| Quiescent Current (I_{GND}) | | 0.05 | 1 5 | μA | \blacklozenge $V_{ENABLE} \leq 0.4\text{V}$ $V_{ENABLE} \leq 0.25\text{V}$ |
| Ground Pin Current (I_{GND}) | | 70 | 125 150 | μA | \blacklozenge $I_L = 100\mu\text{A}$ |
| | | 350 | 600 800 | | \blacklozenge $I_L = 50\text{mA}$ |
| | | 750 | 1000 1500 | | \blacklozenge $I_L = 100\text{mA}$ |
| | | 1300 | 1900 2500 | | \blacklozenge $I_L = 150\text{mA}$ |
| Ripple Rejection (PSRR) | | 70 | | dB | |
| Current Limit (I_{LIMIT}) | | 360 | 500 | mA | $V_{OUT} = 0\text{V}$ |
| Output Noise (e_{NO}) | | 300 | | μV_{RMS} | \blacklozenge $I_L = 10\text{mA}$, $C_L = 1\mu\text{F}$, $C_{IN} = 1\mu\text{F}$ (10Hz - 100kHz.) |
| | | 40 | | μV_{RMS} | \blacklozenge $I_L = 10\text{mA}$, $C_L = 10\mu\text{F}$, $C_{BYP} = 1\mu\text{F}$, $C_{IN} = 1\mu\text{F}$, (10Hz - 100kHz) |
| Input Voltage Level Logic Low (V_{IL}) | | | 0.4 | V | OFF |
| Input Voltage Level Logic High (V_{IH}) | 2.0 | | | | ON |
| ENABLE Input Current | | 0.01 3 | 2 20 | μA | \blacklozenge $V_{IL} \leq 0.4\text{V}$ $V_{IH} \geq 2.0\text{V}$ |

Note 1: The maximum allowable power dissipation is a function of maximum operating junction temperature, T_J (max), the junction to ambient thermal resistance, and the ambient, θ_{JA} , and the ambient temperature T_A . The maximum allowable power dissipation at any ambient temperature is given: $P_{D(max)} = (T_J(max) - T_A)/\theta_{JA}$, exceeding the maximum allowable power limit will result in excessive die temperature; thus, the regulator will go into thermal shutdown. The θ_{JA} of the SPX5205 is 220°C/W mounted on a PC board.

Note 2: Not applicable to output voltages of less than 2V.

TYPICAL PERFORMANCE CHARACTERISTICS

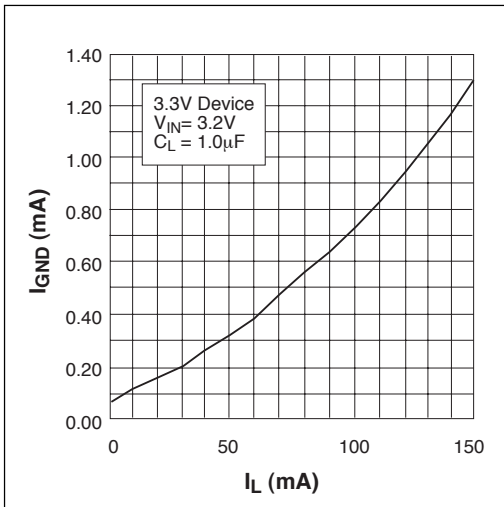

Ground Current vs Load Current

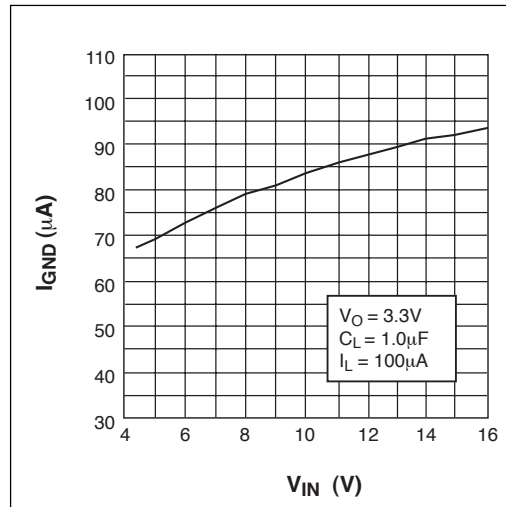

Ground Current vs Input Voltage

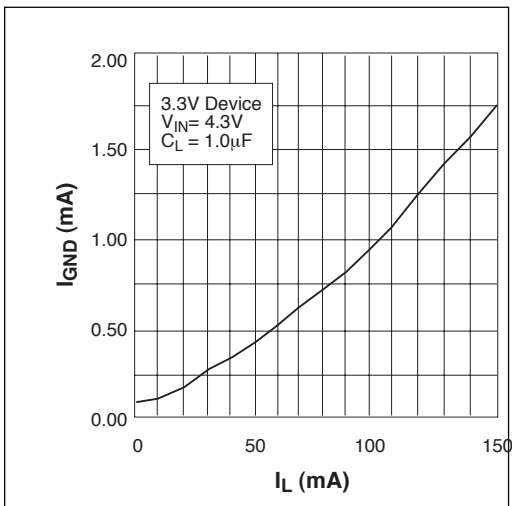

Ground Current vs Load Current in Dropout

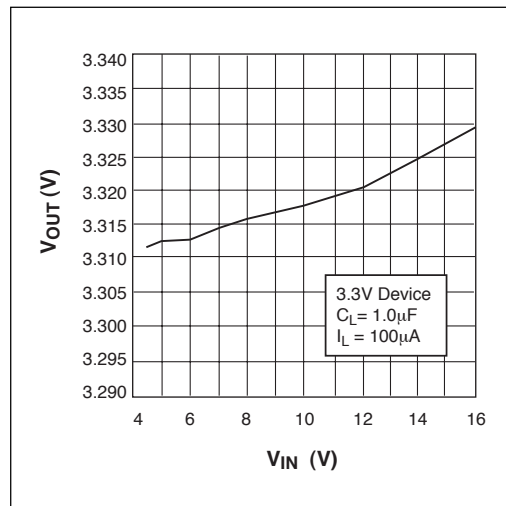

Output Voltage vs Input Voltage

TYPICAL PERFORMANCE CHARACTERISTICS

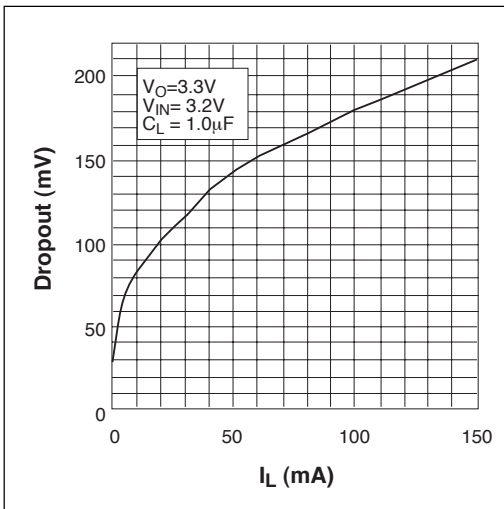

Dropout Voltage vs Load Current

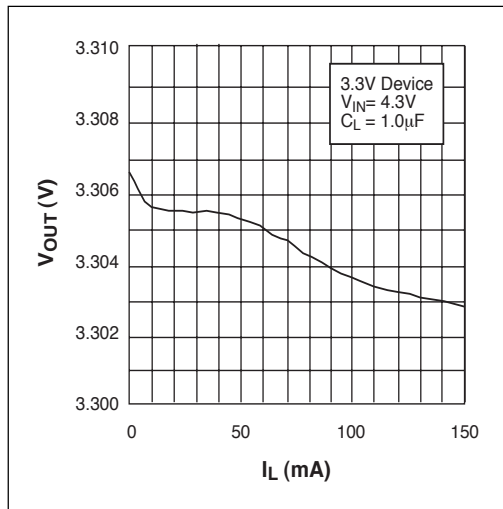

Output Voltage vs Load Current

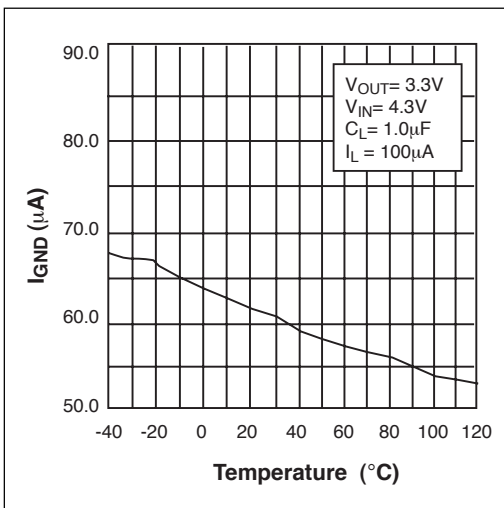

Ground Current vs Temperature at $I_{LOAD}=100\mu A$

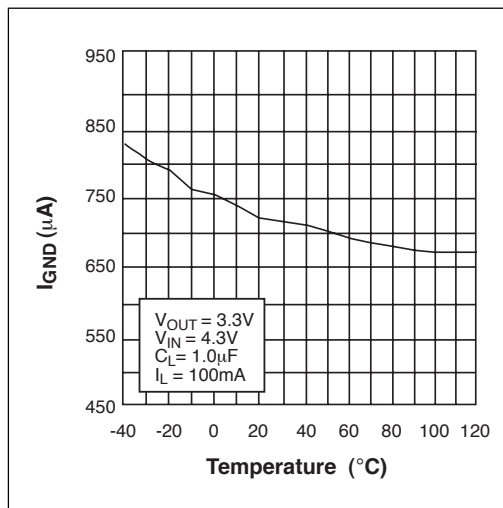

Ground Current vs Temperature at $I_{LOAD}=100mA$

TYPICAL PERFORMANCE CHARACTERISTICS

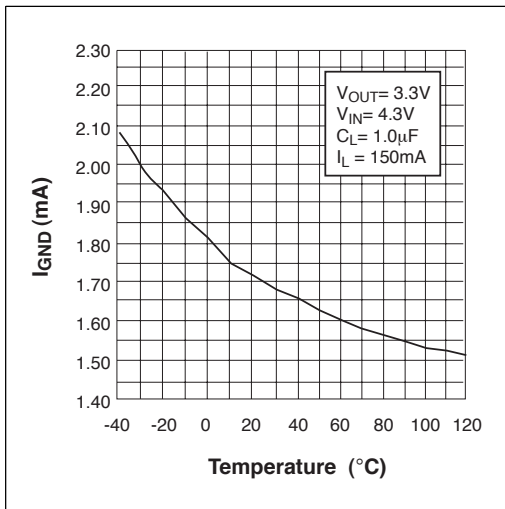

Ground Current in Dropout vs Temperature

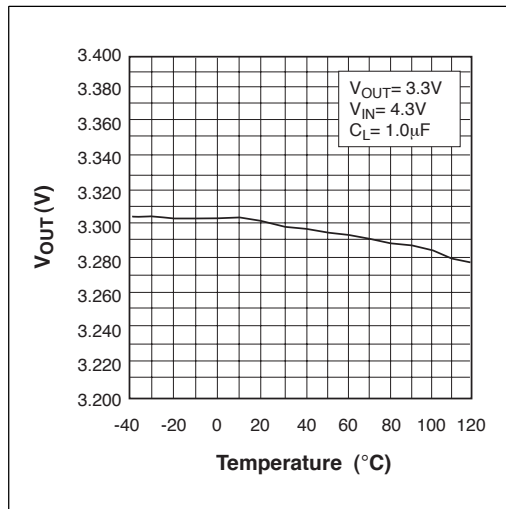

Output Voltage vs Temperature

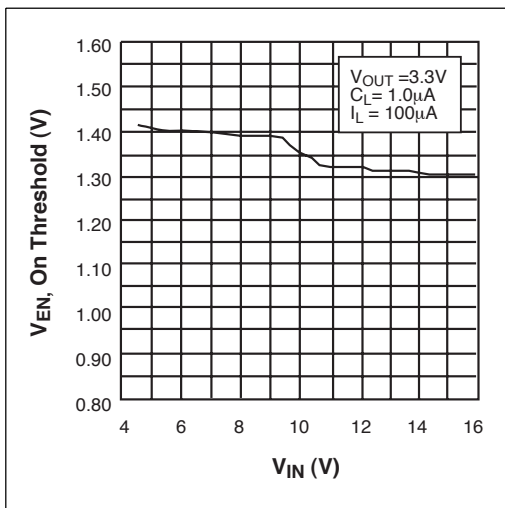

ENABLE Voltage, ON threshold vs Input Voltage

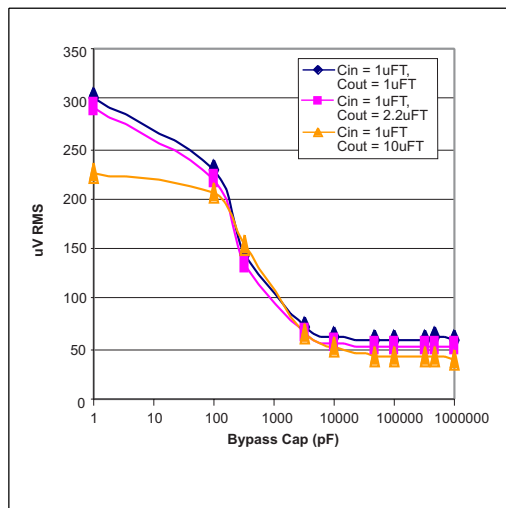

Output Noise vs. Bypass Capacitor Value

APPLICATION INFORMATION

The SPX5205 requires an output capacitor for device stability. Its value depends upon the application circuit. In general, linear regulator stability decreases with higher output currents. In applications where the SPX5205 is putting out less current, a lower output capacitance may be sufficient. For example, a regulator sourcing only 10mA, requires approximately half the capacitance as the same regulator sourcing 150mA.

Bench testing is the best method for determining the proper type and value of the capacitor since the high frequency characteristics of electrolytic capacitors vary widely, depending on type and manufacturer. A high quality 2.2 μ F aluminum electrolytic capacitor works in most application circuits, but the same stability often can be obtained with a 1 μ F tantalum electrolytic.

With the SPX5205 adjustable version, the minimum value of output capacitance is a function of the output voltage. The value decreases with higher output voltages, since closed loop gain is increased.

Typical Applications Circuits

A 10nF capacitor on BYP pin will significantly reduce output noise but it may be left unconnected if the output noise is not a major concern. The SPX5205 start-up speed is inversely pro-

portional to the size of the BYP capacitor. Applications requiring a slow ramp-up of the output voltage should use a larger C_{BYP} . However, if a rapid turn-on is necessary, the BYP capacitor can be omitted.

The SPX5205's internal reference is available through the BYP pin.

The Typical Application Circuit shown on page 1 represents a SPX5205 standard application circuit. The EN (enable) pin is pulled high (>2.0V) to enable the regulator. To disable the regulator, $EN < 0.4V$.

The SPX5205 in Figure 1 illustrates a typical adjustable output voltage configuration. Two resistors (R1 and R2) set the output voltage. The output voltage is calculated using the formula:

$$V_{OUT} = 1.235V \times (1 + R1/R2)$$

R2 must be > 10 k Ω and for best results, R2 should be between 22 k Ω and 47k Ω . A capacitor placed between adjustable and ground will provide improved noise performance.

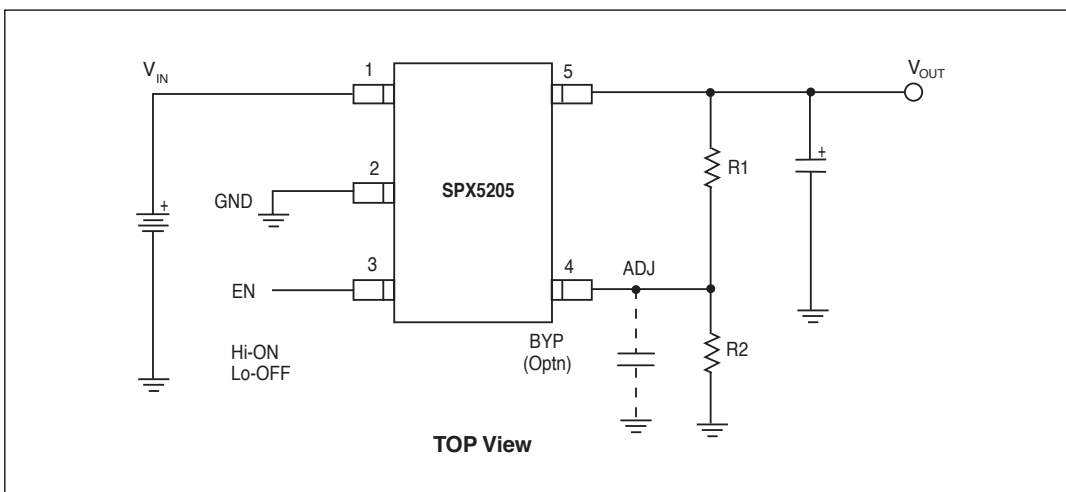
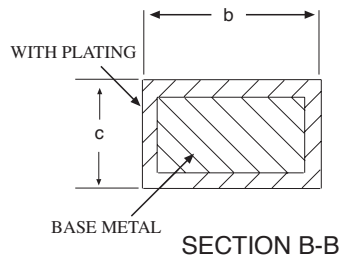
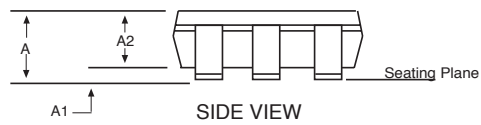
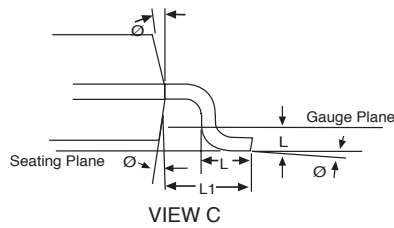
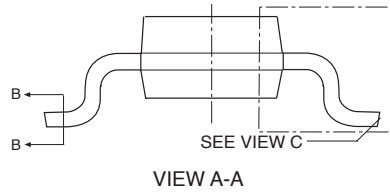
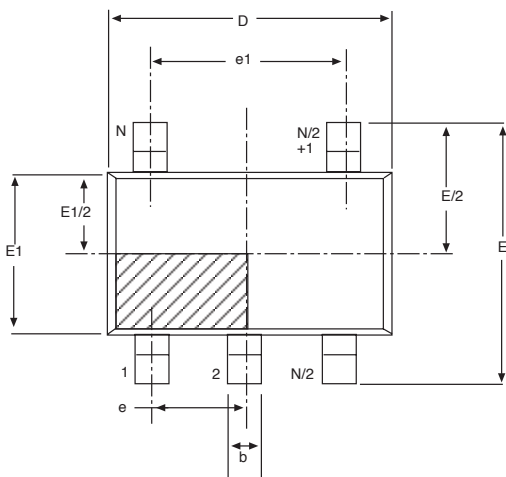

Figure 1. Typical Adjustable Output Voltage.

PACKAGE: 5 PIN SOT-23



| 5 Pin SOT-23 JEDEC MO-178 (AA) Variation | | | |
|--|----------|------|------|
| SYMBOL | MIN | NOM | MAX |
| A | - | - | 1.45 |
| A1 | 0 | - | 0.15 |
| A2 | 0.9 | 1.15 | 1.3 |
| b | 0.3 | - | 0.5 |
| c | 0.08 | - | 0.22 |
| D | 2.90 BSC | | |
| E | 2.80 BSC | | |
| E1 | 1.60 BSC | | |
| e | 0.95 BSC | | |
| e1 | 1.90 BSC | | |
| L | 0.3 | 0.45 | 0.6 |
| L1 | 0.60 REF | | |
| L2 | 0.25 BSC | | |
| Ø | 0° | 4° | 8° |
| ø | 5° | 10° | 15° |

Note: Dimensions in (mm)

ORDERING INFORMATION

| PART NUMBER | TOP MARK | ACC. | OUTPUT VOLTAGE | PACKAGE |
|------------------|----------|------|----------------|--------------|
| SPX5205M5 | H1WW | 1% | Adj | 5 Pin SOT-23 |
| SPX5205M5/TR | H1WW | 1% | Adj | 5 Pin SOT-23 |
| SPX5205M5-1.2 | R12 | 1% | 1.2V | 5 Pin SOT-23 |
| SPX5205M5-1.2/TR | R12 | 1% | 1.2V | 5 Pin SOT-23 |
| SPX5205M5-1.5 | R15 | 1% | 1.5V | 5 Pin SOT-23 |
| SPX5205M5-1.5/TR | R15 | 1% | 1.5V | 5 Pin SOT-23 |
| SPX5205M5-1.8 | R18 | 1% | 1.8V | 5 Pin SOT-23 |
| SPX5205M5-1.8/TR | R18 | 1% | 1.8V | 5 Pin SOT-23 |
| SPX5205M5-2.0 | R20 | 1% | 2.0V | 5 Pin SOT-23 |
| SPX5205M5-2.0/TR | R20 | 1% | 2.0V | 5 Pin SOT-23 |
| SPX5205M5-2.5 | R25 | 1% | 2.5V | 5 Pin SOT-23 |
| SPX5205M5-2.5/TR | R25 | 1% | 2.5V | 5 Pin SOT-23 |
| SPX5205M5-2.8 | R28 | 1% | 2.8V | 5 Pin SOT-23 |
| SPX5205M5-2.8/TR | R28 | 1% | 2.8V | 5 Pin SOT-23 |
| SPX5205M5-3.0 | R30 | 1% | 3.0V | 5 PIN SOT-23 |
| SPX5205M5-3.0/TR | R30 | 1% | 3.0V | 5 PIN SOT-23 |
| SPX5205M5-3.3 | R33 | 1% | 3.3V | 5 Pin SOT-23 |
| SPX5205M5-3.3/TR | R33 | 1% | 3.3V | 5 Pin SOT-23 |
| SPX5205M5-5.0 | R50 | 1% | 5.0V | 5 Pin SOT-23 |
| SPX5205M5-5.0/TR | R50 | 1% | 5.0V | 5 Pin SOT-23 |

Available in lead free packaging. To order add "-L" suffix to part number.

Example: SPX5205M5-5.0/TR = standard; SPX5205M5-5.0-L/TR = lead free

Note that for top markings on small packages, when the bar is added to indicate lead-free parts, it can be mistaken as a "1" or an "l".

/TR = Tape and Reel

Pack quantity is 2,500 for 5pin SOT-23



ANALOG EXCELLENCE

Sipex Corporation

Headquarters and Sales Office

233 South Hillview Drive
Milpitas, CA 95035
TEL: (408) 934-7500
FAX: (408) 935-7600

Sipex Corporation reserves the right to make changes to any products described herein. Sipex does not assume any liability arising out of the application or use of any product or circuit described herein; neither does it convey any license under its patent rights nor the rights of others.