

# Rotary Switches

## 7.4 x 7.4 mm Sealed Mini Rotary DIP Switches (THR) RD81T Series

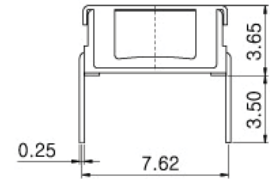

**RD81TH** THT Top Adjust Type Terminals

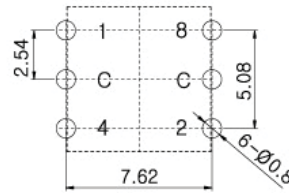
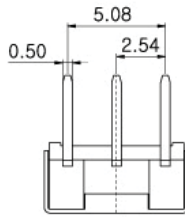
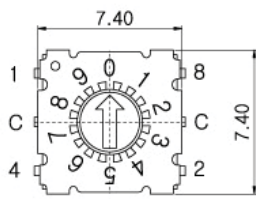
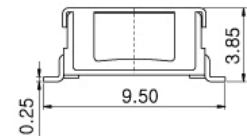
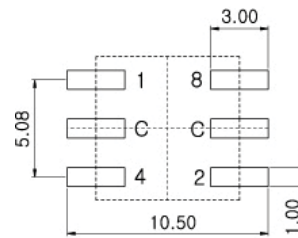
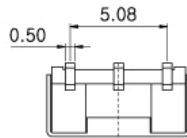
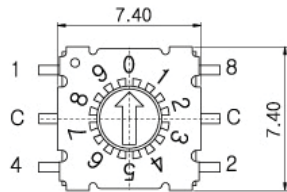

**RD81TS** SMD Top Type Terminals

### SHAFT ROTOR TYPE

### CODE

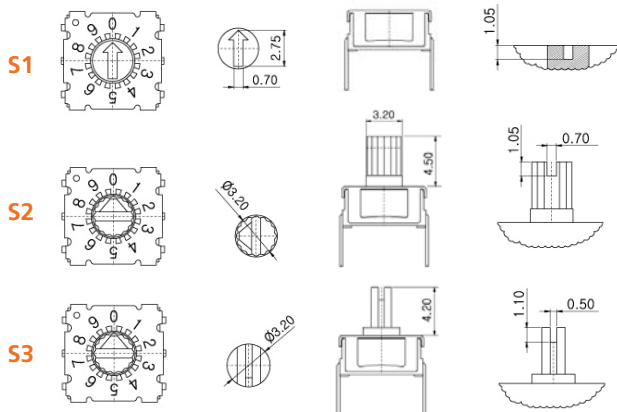

REAL CODE		COMPLEMENT CODE																																																																																																																																																																																																																																																																																																																																																	
<p>(Actuator Color : Red)</p> <table border="1"> <tr><th>10 Position</th><th>C</th><th>1</th><th>2</th><th>4</th><th>8</th></tr> <tr><td>0</td><td></td><td></td><td></td><td></td><td></td></tr> <tr><td>1</td><td></td><td></td><td></td><td></td><td></td></tr> <tr><td>2</td><td></td><td></td><td></td><td></td><td></td></tr> <tr><td>3</td><td></td><td></td><td></td><td></td><td></td></tr> <tr><td>4</td><td></td><td></td><td></td><td></td><td></td></tr> <tr><td>5</td><td></td><td></td><td></td><td></td><td></td></tr> <tr><td>6</td><td></td><td></td><td></td><td></td><td></td></tr> <tr><td>7</td><td></td><td></td><td></td><td></td><td></td></tr> <tr><td>8</td><td></td><td></td><td></td><td></td><td></td></tr> <tr><td>9</td><td></td><td></td><td></td><td></td><td></td></tr> </table>	10 Position	C	1	2	4	8	0						1						2						3						4						5						6						7						8						9						<p>(Actuator Color : Gray)</p> <table border="1"> <tr><th>16 Position</th><th>C</th><th>1</th><th>2</th><th>4</th><th>8</th></tr> <tr><td>0</td><td></td><td></td><td></td><td></td><td></td></tr> <tr><td>1</td><td></td><td></td><td></td><td></td><td></td></tr> <tr><td>2</td><td></td><td></td><td></td><td></td><td></td></tr> <tr><td>3</td><td></td><td></td><td></td><td></td><td></td></tr> <tr><td>4</td><td></td><td></td><td></td><td></td><td></td></tr> <tr><td>5</td><td></td><td></td><td></td><td></td><td></td></tr> <tr><td>6</td><td></td><td></td><td></td><td></td><td></td></tr> <tr><td>7</td><td></td><td></td><td></td><td></td><td></td></tr> <tr><td>8</td><td></td><td></td><td></td><td></td><td></td></tr> <tr><td>9</td><td></td><td></td><td></td><td></td><td></td></tr> <tr><td>10</td><td></td><td></td><td></td><td></td><td></td></tr> <tr><td>11</td><td></td><td></td><td></td><td></td><td></td></tr> <tr><td>12</td><td></td><td></td><td></td><td></td><td></td></tr> <tr><td>13</td><td></td><td></td><td></td><td></td><td></td></tr> <tr><td>14</td><td></td><td></td><td></td><td></td><td></td></tr> <tr><td>15</td><td></td><td></td><td></td><td></td><td></td></tr> </table>	16 Position	C	1	2	4	8	0						1						2						3						4						5						6						7						8						9						10						11						12						13						14						15						<p>(Actuator Color : Orange)</p> <table border="1"> <tr><th>10 Position</th><th>C</th><th>1</th><th>2</th><th>4</th><th>8</th></tr> <tr><td>0</td><td></td><td></td><td></td><td></td><td></td></tr> <tr><td>1</td><td></td><td></td><td></td><td></td><td></td></tr> <tr><td>2</td><td></td><td></td><td></td><td></td><td></td></tr> <tr><td>3</td><td></td><td></td><td></td><td></td><td></td></tr> <tr><td>4</td><td></td><td></td><td></td><td></td><td></td></tr> <tr><td>5</td><td></td><td></td><td></td><td></td><td></td></tr> <tr><td>6</td><td></td><td></td><td></td><td></td><td></td></tr> <tr><td>7</td><td></td><td></td><td></td><td></td><td></td></tr> <tr><td>8</td><td></td><td></td><td></td><td></td><td></td></tr> <tr><td>9</td><td></td><td></td><td></td><td></td><td></td></tr> </table>	10 Position	C	1	2	4	8	0						1						2						3						4						5						6						7						8						9						<p>(Actuator Color : Ivory)</p> <table border="1"> <tr><th>16 Position</th><th>C</th><th>1</th><th>2</th><th>4</th><th>8</th></tr> <tr><td>0</td><td></td><td></td><td></td><td></td><td></td></tr> <tr><td>1</td><td></td><td></td><td></td><td></td><td></td></tr> <tr><td>2</td><td></td><td></td><td></td><td></td><td></td></tr> <tr><td>3</td><td></td><td></td><td></td><td></td><td></td></tr> <tr><td>4</td><td></td><td></td><td></td><td></td><td></td></tr> <tr><td>5</td><td></td><td></td><td></td><td></td><td></td></tr> <tr><td>6</td><td></td><td></td><td></td><td></td><td></td></tr> <tr><td>7</td><td></td><td></td><td></td><td></td><td></td></tr> <tr><td>8</td><td></td><td></td><td></td><td></td><td></td></tr> <tr><td>9</td><td></td><td></td><td></td><td></td><td></td></tr> <tr><td>10</td><td></td><td></td><td></td><td></td><td></td></tr> <tr><td>11</td><td></td><td></td><td></td><td></td><td></td></tr> <tr><td>12</td><td></td><td></td><td></td><td></td><td></td></tr> <tr><td>13</td><td></td><td></td><td></td><td></td><td></td></tr> <tr><td>14</td><td></td><td></td><td></td><td></td><td></td></tr> <tr><td>15</td><td></td><td></td><td></td><td></td><td></td></tr> </table>	16 Position	C	1	2	4	8	0						1						2						3						4						5						6						7						8						9						10						11						12						13						14						15					
10 Position	C	1	2	4	8																																																																																																																																																																																																																																																																																																																																														
0																																																																																																																																																																																																																																																																																																																																																			
1																																																																																																																																																																																																																																																																																																																																																			
2																																																																																																																																																																																																																																																																																																																																																			
3																																																																																																																																																																																																																																																																																																																																																			
4																																																																																																																																																																																																																																																																																																																																																			
5																																																																																																																																																																																																																																																																																																																																																			
6																																																																																																																																																																																																																																																																																																																																																			
7																																																																																																																																																																																																																																																																																																																																																			
8																																																																																																																																																																																																																																																																																																																																																			
9																																																																																																																																																																																																																																																																																																																																																			
16 Position	C	1	2	4	8																																																																																																																																																																																																																																																																																																																																														
0																																																																																																																																																																																																																																																																																																																																																			
1																																																																																																																																																																																																																																																																																																																																																			
2																																																																																																																																																																																																																																																																																																																																																			
3																																																																																																																																																																																																																																																																																																																																																			
4																																																																																																																																																																																																																																																																																																																																																			
5																																																																																																																																																																																																																																																																																																																																																			
6																																																																																																																																																																																																																																																																																																																																																			
7																																																																																																																																																																																																																																																																																																																																																			
8																																																																																																																																																																																																																																																																																																																																																			
9																																																																																																																																																																																																																																																																																																																																																			
10																																																																																																																																																																																																																																																																																																																																																			
11																																																																																																																																																																																																																																																																																																																																																			
12																																																																																																																																																																																																																																																																																																																																																			
13																																																																																																																																																																																																																																																																																																																																																			
14																																																																																																																																																																																																																																																																																																																																																			
15																																																																																																																																																																																																																																																																																																																																																			
10 Position	C	1	2	4	8																																																																																																																																																																																																																																																																																																																																														
0																																																																																																																																																																																																																																																																																																																																																			
1																																																																																																																																																																																																																																																																																																																																																			
2																																																																																																																																																																																																																																																																																																																																																			
3																																																																																																																																																																																																																																																																																																																																																			
4																																																																																																																																																																																																																																																																																																																																																			
5																																																																																																																																																																																																																																																																																																																																																			
6																																																																																																																																																																																																																																																																																																																																																			
7																																																																																																																																																																																																																																																																																																																																																			
8																																																																																																																																																																																																																																																																																																																																																			
9																																																																																																																																																																																																																																																																																																																																																			
16 Position	C	1	2	4	8																																																																																																																																																																																																																																																																																																																																														
0																																																																																																																																																																																																																																																																																																																																																			
1																																																																																																																																																																																																																																																																																																																																																			
2																																																																																																																																																																																																																																																																																																																																																			
3																																																																																																																																																																																																																																																																																																																																																			
4																																																																																																																																																																																																																																																																																																																																																			
5																																																																																																																																																																																																																																																																																																																																																			
6																																																																																																																																																																																																																																																																																																																																																			
7																																																																																																																																																																																																																																																																																																																																																			
8																																																																																																																																																																																																																																																																																																																																																			
9																																																																																																																																																																																																																																																																																																																																																			
10																																																																																																																																																																																																																																																																																																																																																			
11																																																																																																																																																																																																																																																																																																																																																			
12																																																																																																																																																																																																																																																																																																																																																			
13																																																																																																																																																																																																																																																																																																																																																			
14																																																																																																																																																																																																																																																																																																																																																			
15																																																																																																																																																																																																																																																																																																																																																			

### How to order:

RD81T

#### 1 TYPE OF TERMINALS:

- H THT Top Adjust Type
- S SMT Top Type

#### 4 CODE:

- R Real Code
- S Complementary Code

#### 2 ROTOR TYPE (See Above Drawings):

- S1 Shaft Rotor Type 1
- S2 Shaft Rotor Type 2
- S3 Shaft Rotor Type 3

#### 5 PACKAGING TYPE:

- TB Tube
- TR Tape & Reel (RD81TS Only)

#### E NO. OF POSITIONS:

- 10 10 Positions
- 16 16 Positions

### General Specifications:

#### FEATURES

- » Sealing: IP 67(Dust & Waterproof)
- » THR (Thru Hole Reflow solderable)

#### MECHANICAL

- » Life Cycle: 25,000 steps
- » Operating Force: 120±30 gf max.

#### ELECTRICAL

- » Contact Rating: 150mA, 24V (Switching)  
400mA, 24V (None-Switching)
- » Contact Resistance: 80mΩ Max
- » Insulation Resistance: 100MΩ Min

#### SOLDERING PROCESSES

- » Solder Condition: Solder reflow max:10s./260°C  
Solder iron max: 2s./340°C  
Solder bath max: 5s/280°C