

# The RF Line

## High Output Mirror Power Doubler

### 750 MHz CATV Amplifier

**MHW7185CR**

**19.4 dB GAIN**  
**750 MHz**  
**110-CHANNEL**  
**CATV AMPLIFIER**

- Specified for 77 and 110-Channel Performance
- Broadband Power Gain — @ f = 750 MHz  
G<sub>p</sub> = 19.4 dB (Typ)
- Broadband Noise Figure  
NF = 6.2 dB (Typ) @ 750 MHz
- Pin Configuration Mirrors that of MHW7185C
- Typical CTB @ 750 MHz under 110-Channel FLAT Loading = -64 dBc

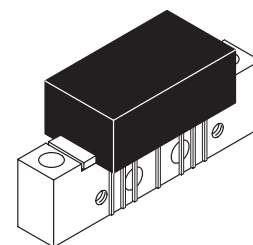

**CASE 714Y-03, STYLE 2**

#### MAXIMUM RATINGS

Rating	Symbol	Value	Unit
RF Voltage Input (Single Tone)	V <sub>in</sub>	+70	dBmV
DC Supply Voltage	V <sub>CC</sub>	+28	Vdc
Operating Case Temperature Range	T <sub>C</sub>	-20 to +100	°C
Storage Temperature Range	T <sub>stg</sub>	-40 to +100	°C

#### ELECTRICAL CHARACTERISTICS (V<sub>CC</sub> = 24 Vdc, T<sub>C</sub> = +30°C, 75 Ω system unless otherwise noted)

Characteristic	Symbol	Min	Typ	Max	Unit
Frequency Range	BW	40	—	750	MHz
Power Gain	G <sub>p</sub>	18.3 19	18.8 19.4	19.3 20	dB
Slope	S	0	.5	1.0	dB
Gain Flatness (40-750 MHz, Peak to Valley)	—	—	0.3	0.6	dB
Return Loss — Input/Output (Z <sub>0</sub> = 75 Ohms)	IRL/ORL	19	—	—	dB
		—	—	0.006	dB/MHz
Composite Second Order					dBc
(V <sub>out</sub> = +44 dBmV/ch., Worst Case)	CSO <sub>110</sub> CSO <sub>77</sub>	— —	-72 -80	-64 -68	
Cross Modulation Distortion @ Ch 2	XMD <sub>110</sub> XMD <sub>77</sub>	— —	-66 -70	-63 -68	dBc
(V <sub>out</sub> = +44 dBmV/ch., FM = 55 MHz)					
Composite Triple Beat	CTB <sub>110</sub> CTB <sub>77</sub>	— —	-64 -71	-62 -69	dBc
(V <sub>out</sub> = +44 dBmV/ch., Worst Case)					
Noise Figure	NF	— — —	5.0 5.3 6.2	6.0 — 7.5	dB
DC Current (V <sub>DC</sub> = 24 V, T <sub>C</sub> = 30°C)	I <sub>DC</sub>	365	400	435	mA

ARCHIVE INFORMATION

ARCHIVE INFORMATION

# PACKAGE DIMENSIONS

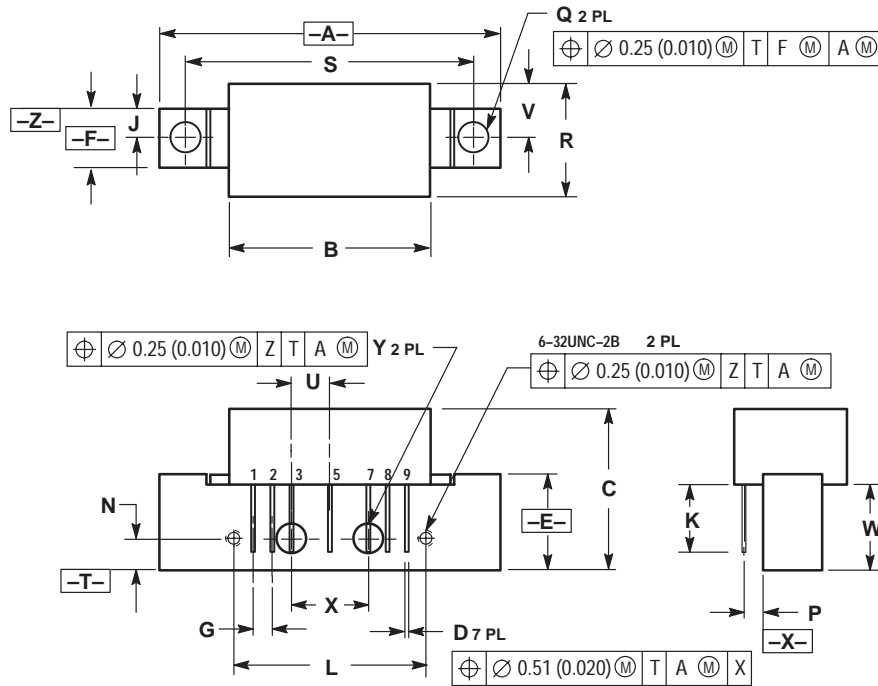

NOTES:  
 1. DIMENSIONING AND TOLERANCING PER ANSI Y14.5M, 1982.  
 2. CONTROLLING DIMENSION: INCH.

DIM	INCHES		MILLIMETERS	
	MIN	MAX	MIN	MAX
A	----	1.775	----	45.08
B	----	1.085	----	27.56
C	----	0.840	----	21.34
D	0.018	0.022	0.46	0.56
E	0.465	0.510	11.81	12.95
F	0.300	0.325	7.62	8.25
G	0.100 BSC		2.54 BSC	
J	0.156 BSC		3.96 BSC	
K	0.315	0.355	8.00	8.50
L	1.00 BSC		25.40 BSC	
N	0.165 BSC		4.19 BSC	
P	0.100 BSC		2.54 BSC	
Q	0.148	0.168	3.76	4.27
R	----	0.600	----	15.24
S	1.500 BSC		38.10 BSC	
U	0.200 BSC		5.08 BSC	
V	----	0.250	----	6.35
W	0.435	0.450	11.05	11.43
X	0.400 BSC		10.16 BSC	
Y	0.152	0.163	3.85	4.15

STYLE 2:  
 PIN 1. RF OUTPUT  
 2. GROUND  
 3. GROUND  
 4. DELETED  
 5. VDC  
 6. DELETED  
 7. GROUND  
 8. GROUND  
 9. RF INPUT

CASE 714Y-03  
 ISSUE D

ARCHIVE INFORMATION

ARCHIVE INFORMATION

Motorola reserves the right to make changes without further notice to any products herein. Motorola makes no warranty, representation or guarantee regarding the suitability of its products for any particular purpose, nor does Motorola assume any liability arising out of the application or use of any product or circuit, and specifically disclaims any and all liability, including without limitation consequential or incidental damages. "Typical" parameters which may be provided in Motorola data sheets and/or specifications can and do vary in different applications and actual performance may vary over time. All operating parameters, including "Typicals" must be validated for each customer application by customer's technical experts. Motorola does not convey any license under its patent rights nor the rights of others. Motorola products are not designed, intended, or authorized for use as components in systems intended for surgical implant into the body, or other applications intended to support or sustain life, or for any other application in which the failure of the Motorola product could create a situation where personal injury or death may occur. Should Buyer purchase or use Motorola products for any such unintended or unauthorized application, Buyer shall indemnify and hold Motorola and its officers, employees, subsidiaries, affiliates, and distributors harmless against all claims, costs, damages, and expenses, and reasonable attorney fees arising out of, directly or indirectly, any claim of personal injury or death associated with such unintended or unauthorized use, even if such claim alleges that Motorola was negligent regarding the design or manufacture of the part. Motorola and are registered trademarks of Motorola, Inc. Motorola, Inc. is an Equal Opportunity/Affirmative Action Employer.

Mfax is a trademark of Motorola, Inc.

### How to reach us:

**USA/EUROPE/Locations Not Listed:** Motorola Literature Distribution;  
 P.O. Box 5405, Denver, Colorado 80217. 1-303-675-2140 or 1-800-441-2447

**JAPAN:** Nippon Motorola Ltd.: SPD, Strategic Planning Office, 141,  
 4-32-1 Nishi-Gotanda, Shagawa-ku, Tokyo, Japan. 03-5487-8488

**Customer Focus Center: 1-800-521-6274**

**Mfax™:** RMFAX0@email.sps.mot.com – TOUCHTONE 1-602-244-6609  
 Motorola Fax Back System – US & Canada ONLY 1-800-774-1848  
 – http://sps.motorola.com/mfax/

**ASIA/PACIFIC:** Motorola Semiconductors H.K. Ltd.; 8B Tai Ping Industrial Park,  
 51 Ting Kok Road, Tai Po, N.T., Hong Kong. 852-26629298

**HOME PAGE:** http://motorola.com/sps/



MHW7185CR/D