

PLEASE CHECK WWW.MOLEX.COM FOR LATEST PART INFORMATION

Part Number: [0510470800](#)
Status: **Active**
Overview: [picoblade](#)
Description: 1.25mm (.049") Pitch PicoBlade™ Wire-to-Wire Plug Housing, 8 Circuits

Documents:

[3D Model](#) [Product Specification PS-51021-009 \(PDF\)](#)
[Drawing \(PDF\)](#) [RoHS Certificate of Compliance \(PDF\)](#)

General

| | |
|----------------|---------------------------|
| Product Family | Crimp Housings |
| Series | 51047 |
| MolexKits | Yes |
| Overview | picoblade |
| Product Name | PicoBlade™ |

Physical

| | |
|-------------------------------|----------------|
| Circuits (maximum) | 8 |
| Color - Resin | Natural |
| Gender | Male |
| Glow-Wire Compliant | No |
| Lock to Mating Part | Yes |
| Material - Resin | Polyester |
| Number of Rows | 1 |
| Packaging Type | Bag |
| Panel Mount | No |
| Pitch - Mating Interface (in) | 0.049 In |
| Pitch - Mating Interface (mm) | 1.25 mm |
| Stackable | No |
| Temperature Range - Operating | -40°C to +85°C |

Material Info

Reference - Drawing Numbers

| | |
|-------------------------|--|
| Packaging Specification | SPK-51047-001 |
| Product Specification | PS-51021-009, RPS-51021-033, RPS-51047-001 |
| Sales Drawing | SD-51047-**00 |

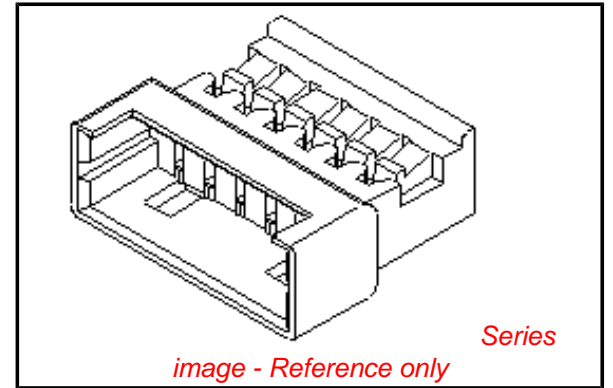

EU RoHS

ELV and RoHS Compliant
REACH SVHC
 Not Reviewed
Halogen-Free Status
 Not Reviewed

China RoHS



Need more information on product environmental compliance?

Email productcompliance@molex.com
 For a multiple part number RoHS Certificate of Compliance, [click here](#)

Please visit the [Contact Us](#) section for any non-product compliance questions.

Search Parts in this Series

[51047Series](#)

Mates With

[51021](#) housing

Use With

[50125](#) Crimp Terminal, [50133](#) Crimp Terminal

DWG. NO. SD-51047-***00

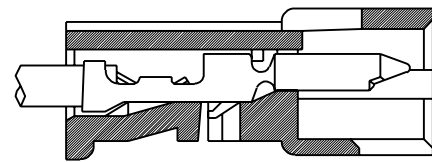
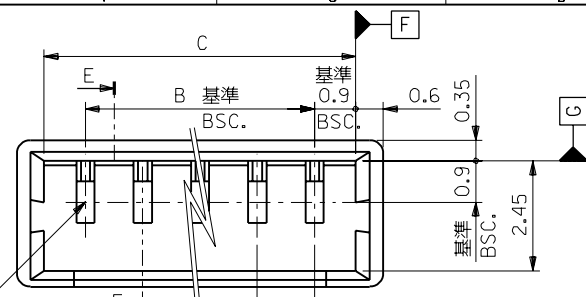

断面E-E
SECT. E-E

注)
NOTE.

- △ 適合ターミナル：50125-8*00,50133-8*00
APPLICABLE TERMINAL:50125-8*00,50133-8*00
- 2. 嵌合相手：51021-***00
MATE WITH:51021-***00
- △ ロック窓は、2、3極は1ヶ、4極以上は2ヶとする。
LOCKING WINDOW:ONE PLACE FOR 2AND3CKT.
AND TWO PLACES FOR MORE THAN 4CKT.

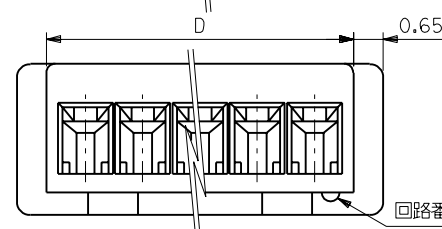
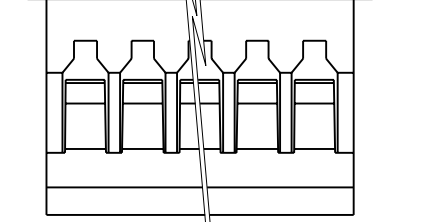
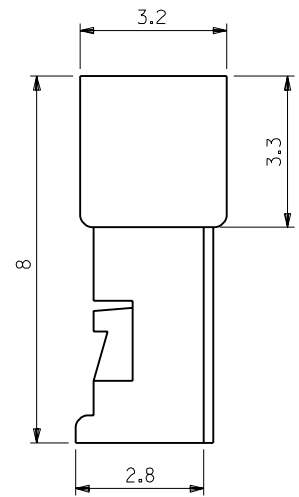
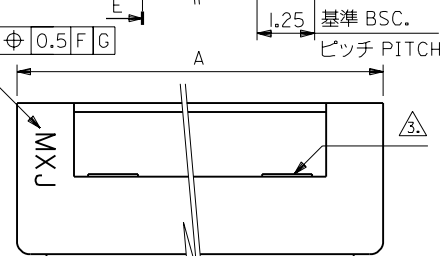

| | | | | | |
|-------|-------|-------|-------|------------|---------|
| 12.95 | 14.25 | 13.05 | 11.25 | 51047-1000 | 10 |
| 11.7 | 13 | 11.8 | 10 | ↑ -0900 | 9 |
| 10.45 | 11.75 | 10.55 | 8.75 | -0800 | 8 |
| 9.2 | 10.5 | 9.3 | 7.5 | -0700 | 7 |
| 7.95 | 9.25 | 8.05 | 6.25 | -0600 | 6 |
| 6.7 | 8 | 6.8 | 5 | -0500 | 5 |
| 5.45 | 6.75 | 5.55 | 3.75 | -0400 | 4 |
| 4.2 | 5.5 | 4.3 | 2.5 | ↓ -0300 | 3 |
| 2.95 | 4.25 | 3.05 | 1.25 | 51047-0200 | 2 |
| D | A | C | B | ENG.NO. | 極数 CKT. |

DO NOT SCALE DRAWING

| | | | | | |
|----------------------------------|----------------------------------|----------------------------------|----------------------------------|---|---|
| EC NO. DRWN: CHK: APPR: | EC NO. DRWN: CHK: APPR: | EC NO. DRWN: CHK: APPR: | EC NO. DRWN: CHK: APPR: | REDRAWN EC NO. JC2000-0629 DRWN: K.KOHAMA 000/3/28 CHK: T.YAMAGUCHI 000/3/30 APPR: M.FUKUSHIMA 000/3/30 | MATERIAL 材料 ポリエステル POLYESTER, UL94V-0 |
| FINISH 仕上げ | FINISH 仕上げ | FINISH 仕上げ | FINISH 仕上げ | FINISH 仕上げ | FINISH 仕上げ |
| WIRE RANGE 適用線径範囲 | WIRE RANGE 適用線径範囲 | WIRE RANGE 適用線径範囲 | WIRE RANGE 適用線径範囲 | WIRE RANGE 適用線径範囲 | WIRE RANGE 適用線径範囲 |
| INS. RANGE 被覆外径 | INS. RANGE 被覆外径 | INS. RANGE 被覆外径 | INS. RANGE 被覆外径 | INS. RANGE 被覆外径 | INS. RANGE 被覆外径 |

| | | | | |
|---|---------------|--|--|-----------------------|
| GENERAL TOLERANCES: (UNLESS SPECIFIED) 一般公差 | SCALE 10:1 | DESIGN UNITS <input checked="" type="checkbox"/> mm <input type="checkbox"/> INCH | THIRD ANGLE PROJECTION <input type="checkbox"/> mm <input type="checkbox"/> INCH <input checked="" type="checkbox"/> mm ONLY | SHT REV |
| 10 UNDER 未満 | +0.2 | DRAWN BY & DATE K.KOHAMA 000/3/28 | TITLE: 1.25 W/W CONN. PLG HSG. | REVISE ON CAD ONLY |
| 10 OVER 以上 | +0.25 | CHECKED BY & DATE T.YAMAGUCHI 007/3/30 | MATERIAL NO. 51047-***00 | SHEET NO. 1 |
| 30 OVER 以上 | +0.3 | APPROVED BY & DATE M.FUKUSHIMA 000/3/30 | DRAWING NO. SD-51047-***00 | SIZE B |
| ANGLE 角度 | +3° | CAD FILENAME S51047.S10 | THIS DRAWING CONTAINS INFORMATION THAT IS PROPRIETARY TO MOLEX INCORPORATED AND SHOULD NOT BE USED WITHOUT WRITTEN PERMISSION. | |

| | |
|--------------------|--------------------|
| MOLEX INCORPORATED | SHEET NO. 1 |
| SIZE B | EN-02J(097) MXJ-54 |

S51047.S10