

CSHD5-40
 CSHD5-60
 CSHD5-100

**SURFACE MOUNT
 SCHOTTKY BARRIER RECTIFIER
 5.0 AMP, 40 THRU 100 VOLTS**

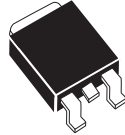

DPAK RECTIFIER CASE

CentralTM Semiconductor Corp.

DESCRIPTION:

The CENTRAL SEMICONDUCTOR 5.0 Amp Surface Mount Silicon Schottky Rectifier is a high quality, well constructed, highly reliable component designed for use in all types of commercial, industrial, entertainment, computer, and automotive applications.

MARKING CODE: FULL PART NUMBER

MAXIMUM RATINGS: ($T_A=25^\circ\text{C}$ unless otherwise noted)

	SYMBOL	CSHD5 <u>-40</u>	CSHD5 <u>-60</u>	CSHD5 <u>-100</u>	UNITS
Peak Repetitive Reverse Voltage	V_{RRM}	40	60	100	V
DC Blocking Voltage	V_R	40	60	100	V
RMS Reverse Voltage	$V_{R(RMS)}$	28	42	71	V
Average Forward Current ($T_L=75^\circ\text{C}$)	I_O		5.0		A
Peak Forward Surge Current (8.3ms)	I_{FSM}		100		A
Operating and Storage					
Junction Temperature	T_J, T_{stg}		-65 to +150		$^\circ\text{C}$
Thermal Resistance	θ_{JL}		5.0		$^\circ\text{C/W}$

ELECTRICAL CHARACTERISTICS: ($T_A=25^\circ\text{C}$ unless otherwise noted)

SYMBOL	TEST CONDITIONS	MIN	TYP	MAX	UNITS
I_R	$V_R=\text{Rated } V_{RRM}$			0.2	mA
I_R	$V_R=\text{Rated } V_{RRM}, T_L=100^\circ\text{C}$			20	mA
V_F	$I_F=5.0\text{A (CSHD5-40)}$			0.55	V
V_F	$I_F=5.0\text{A (CSHD5-60)}$			0.75	V
V_F	$I_F=5.0\text{A (CSHD5-100)}$			0.85	V

**SURFACE MOUNT
SCHOTTKY BARRIER RECTIFIER
5.0 AMP, 40 THRU 100 VOLTS**

DPAK RECTIFIER CASE - MECHANICAL OUTLINE

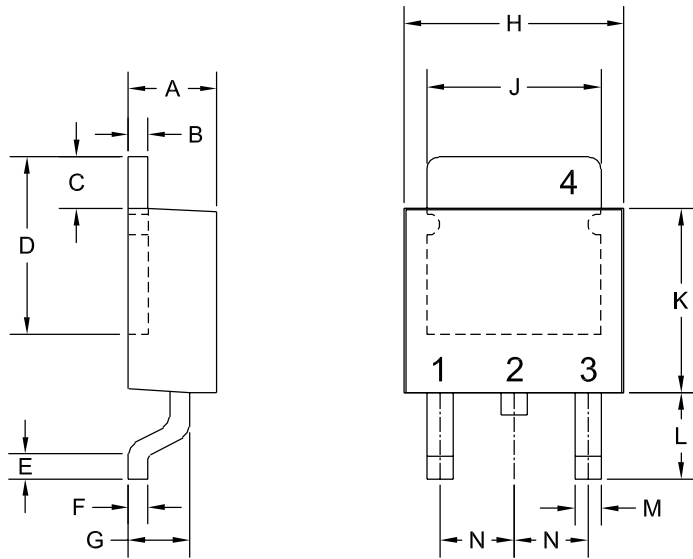

R2

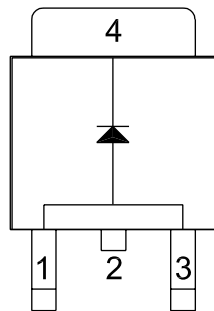

- Lead Code
1) Anode
2) Cathode
3) Anode
4) Cathode

**MARKING CODE:
FULL PART NUMBER**

SYMBOL	INCHES		MILLIMETERS	
	MIN	MAX	MIN	MAX
A	0.083	0.108	2.10	2.75
B	0.016	0.024	0.40	0.60
C	0.063		1.60	
D	0.203	0.219	5.15	5.55
E	0.039		1.00	
F	0.020		0.50	
G	0.051	0.071	1.30	1.80
H	0.248	0.268	6.30	6.80
J	0.197	0.217	5.00	5.50
K	0.209	0.224	5.30	5.70
L	0.090	0.106	2.30	2.70
M	0.012	0.031	0.30	0.80
N	0.091		2.30	

DPAK RECTIFIER (REV: R2)