

Magnetic Transducer (AC)

Washing Label

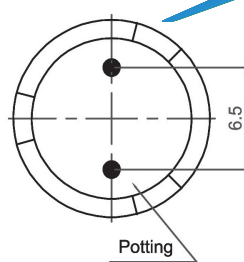
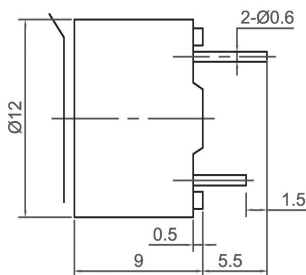
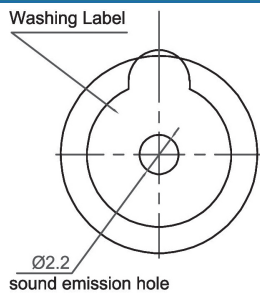

CMT1209

Canopus Part no.	Operating Voltage (V)	Rated Voltage (V)	Max Rated Current (mA)	Coil Resistance (Ω)	Min Sound Output (dBA)	Resonant Frequency (Hz)	Operating Temperature ($^{\circ}$ C)	Housing	Weight (g)
CMT1209A2048NP	1 ~ 2	1.5	70	6.5 \pm 1	75 at 10cm	2048	-20 ~ +60	Noryl	2
CMT1209A2400NP	1 ~ 3	1.5	70	6.5 \pm 1	75 at 10cm	2400	-20 ~ +60	Noryl	2
CMT1209E2048NP	3 ~ 8	5	40	47 \pm 5	85 at 10cm	2048	-40 ~ +85	Noryl	2
CMT1209E2200NP	3 ~ 8	5	40	47 \pm 5	85 at 10cm	2200	-40 ~ +85	Noryl	2
CMT1209E2400NP	3 ~ 8	5	40	47 \pm 5	85 at 10cm	2400	-20 ~ +60	Noryl	2
CMT1209F2200NP	4 ~ 8	6	40	50 \pm 5	85 at 10cm	2200	-40 ~ +85	Noryl	2
CMT1209H2048NP	6 ~ 15	12	40	140 \pm 14	85 at 10cm	2048	-20 ~ +60	Noryl	2
CMT1209H2400NP	6 ~ 15	12	40	140 \pm 14	85 at 10cm	2400	-25 ~ +70	Noryl	2

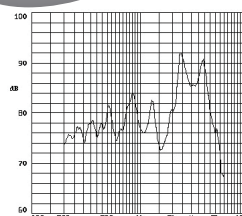

Washing Label

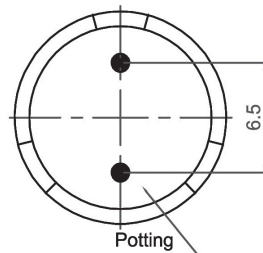
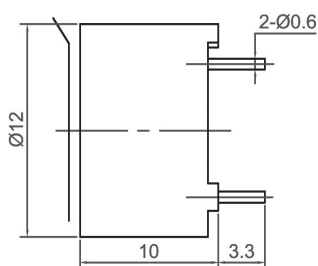
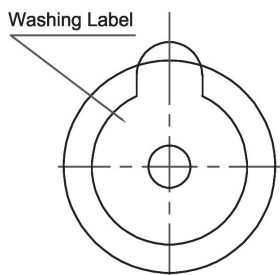

CMT1210

Canopus Part no.	Operating Voltage (V)	Rated Voltage (V)	Max Rated Current (mA)	Coil Resistance (Ω)	Min Sound Output (dBA)	Resonant Frequency (Hz)	Operating Temperature ($^{\circ}$ C)	Housing	Weight (g)
CMT1210A2200TP	0.8 ~ 2.5	1.5	100	3.5 \pm 1	85 at 10cm	2200	-20 ~ +70	PBT	2
CMT1210A2400TP	1 ~ 2	1.5	30	16 \pm 4.5	80 at 10cm	2400	-40 ~ +85	PBT	2
CMT1210A2800TP	1 ~ 3	1.5	30	16 \pm 4.5	85 at 10cm	2800	-20 ~ +70	PBT	2
CMT1210E2400TP	3 ~ 8	5	50	40 \pm 5	85 at 10cm	2400	-40 ~ +85	PBT	2

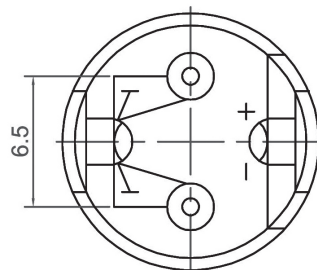
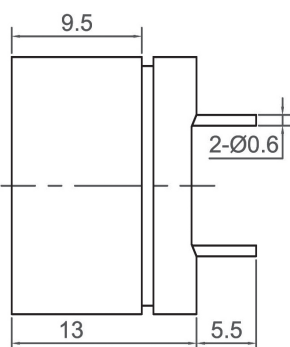
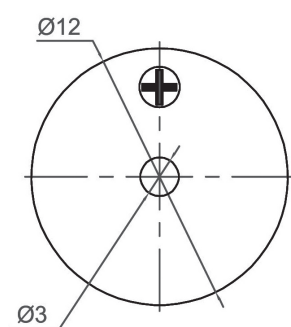
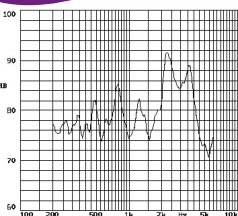

CMT1213

Canopus Part no.	Operating Voltage (V)	Rated Voltage (V)	Max Rated Current (mA)	Coil Resistance (Ω)	Min Sound Output (dBA)	Resonant Frequency (Hz)	Operating Temperature ($^{\circ}$ C)	Housing	Weight (g)
CMT1213A2048NP	1 ~ 2	1.5	30	16 \pm 4.5	80 at 10cm	2048	-20 ~ +60	Noryl	2

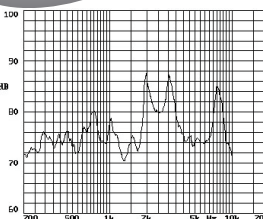

CANOPUS

Your Efficient Supplier
www.canopus.com.hk

TEL.: (852) 2806 2812

Fax: (852) 2652 2216