

PLEASE CHECK WWW.MOLEX.COM FOR LATEST PART INFORMATION

Part Number: [0334822001](#)
Status: **Active**
Overview: [mx150 sealed connector system](#)
Description: 3.50mm (.138") Pitch MX150™ Sealed Male Connector, Dual Row, 20 Circuits, Polarization A, without Connector Position Assurance, Black

Documents:

3D Model	Product Specification PS-33472-000 (PDF)
Application Specification (PDF)	RoHS Certificate of Compliance (PDF)
Drawing (PDF)	

General

Product Family	Crimp Housings
Series	33482
Comments	No Connector Position Assurance (CPA)
More Detailed Tech Information	http://ewcap.uscarteams.org
Overview	mx150 sealed connector system
Product Name	MX150™

Physical

Circuits (maximum)	20
Circuits Detail	20
Color - Resin	Black, Natural
Gender	Male
Glow-Wire Compliant	No
Keying to Mating Part	Yes
Lock to Mating Part	Yes
Material - Resin	Modified Polystyrene Alloy
Number of Rows	2
Packaging Type	Bag
Panel Mount	No
Pitch - Mating Interface (in)	0.138 In
Pitch - Mating Interface (mm)	3.50 mm
Polarized to Mating Part	Yes
Stackable	No
Temperature Range - Operating	-40°C to +125°C

Electrical

Current - Maximum per Contact	22A
-------------------------------	-----

Material Info

Reference - Drawing Numbers

Application Specification	AS-33472-100
Packaging Specification	PK-31300-635
Product Specification	PS-33472-000
Sales Drawing	ES-E1AB-14A485-AA, SD-33482-201



EU RoHS

ELV and RoHS Compliant
REACH SVHC Contains SVHC: No
Halogen-Free Status
Not Reviewed

China RoHS



Need more information on product environmental compliance?

Email productcompliance@molex.com
 For a multiple part number RoHS Certificate of Compliance, [click here](#)

Please visit the [Contact Us](#) section for any non-product compliance questions.

Search Parts in this Series

[33482Series](#)

Mates With

[33472](#) Female Dual Row Sealed Connector

Use With

[33000](#) MX150™ Tin (Sn) Male Terminal,
[33011](#) Gold (Au) Male Terminal

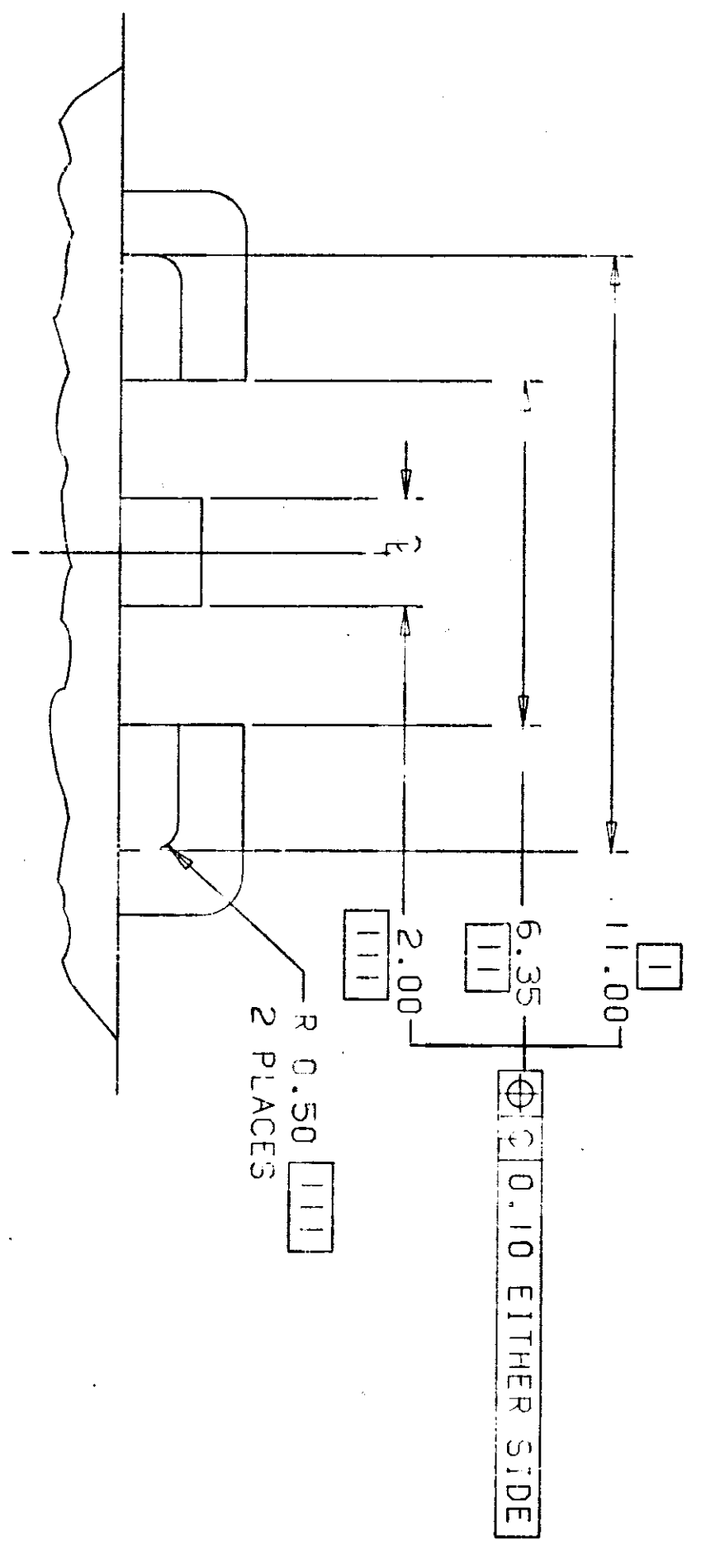
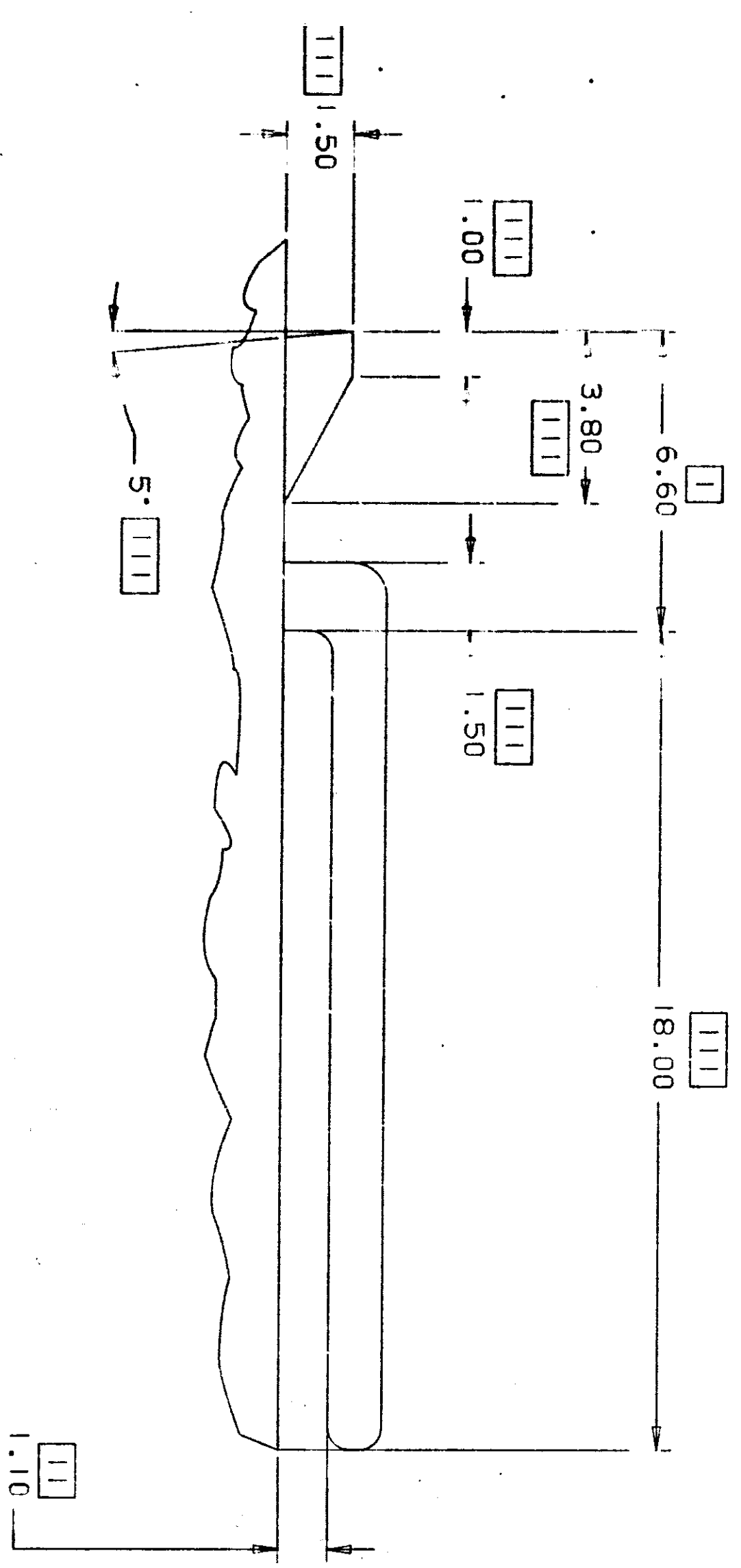
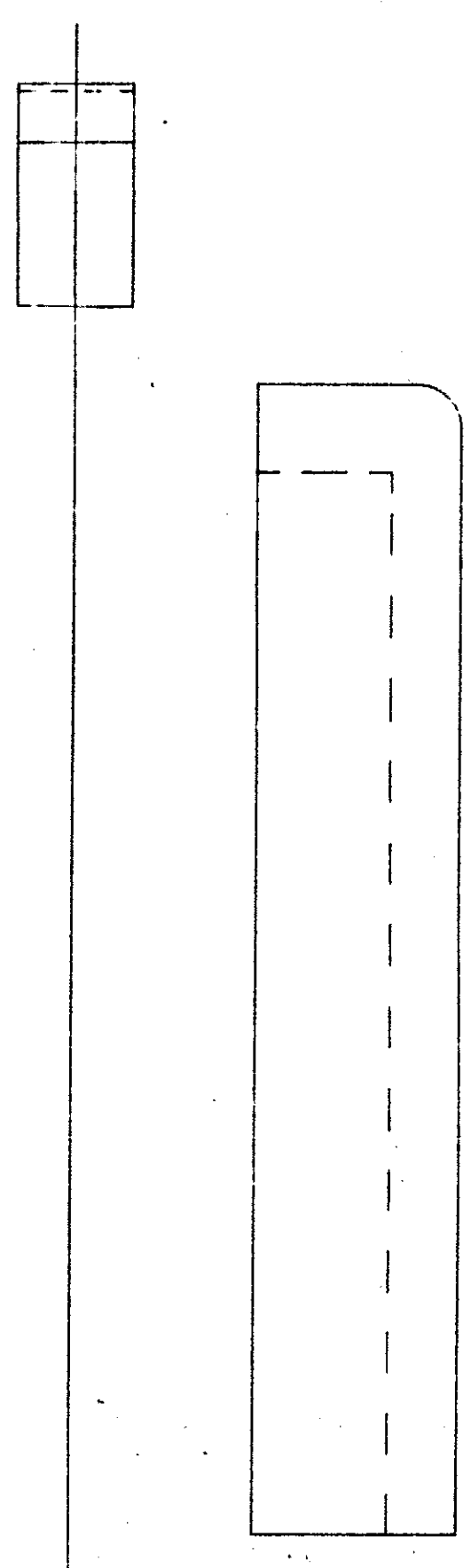

VIEW OF WIRE END OF CONNECTOR

NOTES: UNLESS OTHERWISE SPECIFIED

- GENERAL TOLERANCES:
- ±0.10 ALL TWO PLACE DIMENSIONS
- ±0.3 ALL ONE PLACE DIMENSIONS
- ±1.0° ALL ANGULAR DIMENSIONS
- 0.5° MAXIMUM DRAFT ANGLE
- 0.3 MAXIMUM RADIUS PERMISSIBLE ON ALL EDGES AND FILLETS SHOWN AS SHARP
- ALL RADI: 0.8
- WALL THICKNESS 1.3-1.0

DATE LET	REVISIONS	DR CK APP
11-18-77	RELEASED COMPLETE	
	AKI-6000 # 86	

NO. ES-EIAB-14A485-AA

SPIND PRODUCT ENGINEERING

DATE	CHECKED	SCALE	APPROVED	CODE
11-8-77	CE	1/2N	MA	

UNLESS OTHERWISE SPECIFIED
DIMENSIONS ARE IN MILLIMETRES
MACHINED DIM. 1
ANGULAR DIM. 1

NAME SPECIFICATION - RETAINER - WIRE
CONNECTOR SLEEVE
DATE 11-8-77
MATERIAL
NO. ES-EIAB-14A485-AA

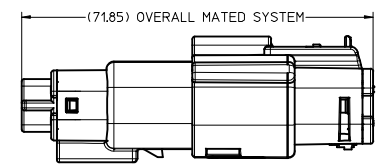

SCALE 1:1

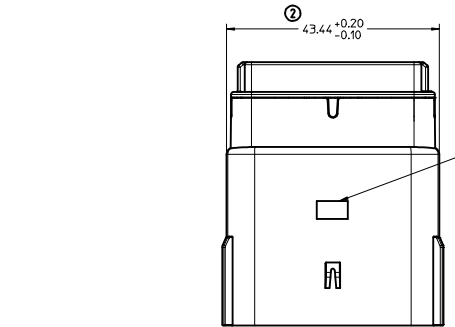
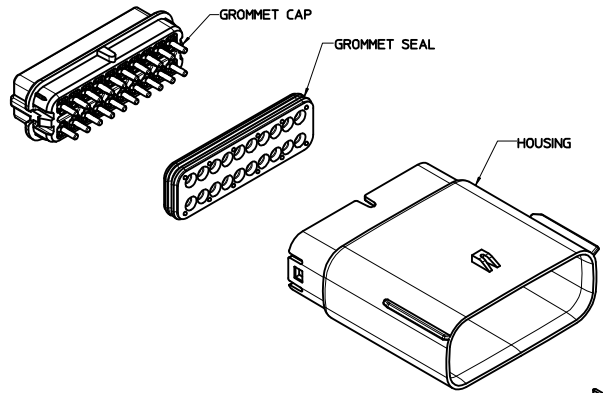

OPTIONAL TRACEABILITY INFORMATION LOCATED IN THIS AREA

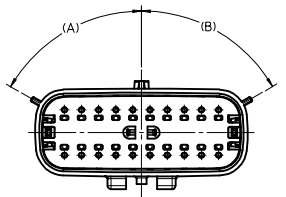
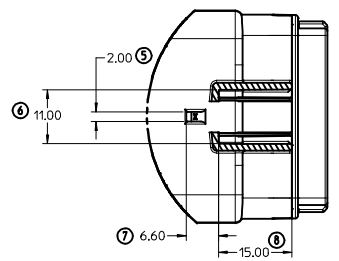
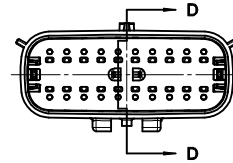
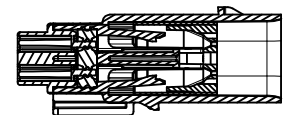
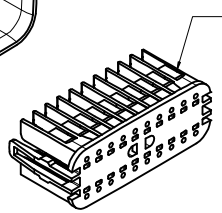
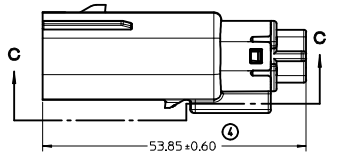
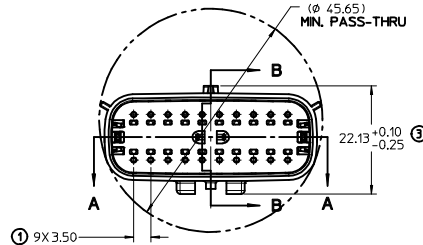
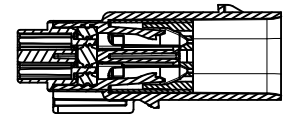
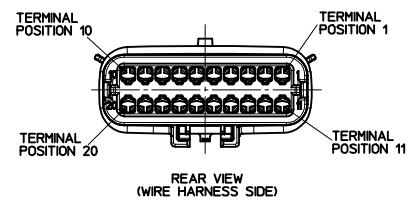
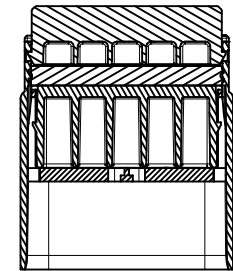

KEYING OPTION
SEE TABLE
SCALE 2:1

NOTES: UNLESS OTHERWISE STATED

- DESIGNED TO MATE WITH RECEPTACLE HOUSING ASSEMBLY SPECIFIED IN MOLEX CHARTED DRAWING SD-33472-201.
- ASSEMBLY SHIPPED WITH BLADE INSERT IN PRE-LOCKED POSITION (SEE SECTION D-D PRE-LOCK). UPON FULL TERMINAL ASSEMBLY EACH BLADE INSERT MUST BE SNAPPED INTO ITS FINAL-LOCK POSITION. FOR TO MOVE INSERT FROM FINAL TO PRE-LOCK POSITION: 75 N MAX.
- FOR BLADE TERMINALS TO BE USED WITH THIS ASSEMBLY. SEE DRAWING SD-33000-001.
- SYSTEM TO BE USED WITH WIRE WITHIN DIAMETER RANGE OF 1.5mm TO 2.5mm.
- MATERIAL: SPS/NYLON BLEND, 20% GLASS FILLED.
- SHALL CONFORM TO PACKAGING SPECIFICATION PK-31300-635.
- SHALL CONFORM TO PRODUCT SPECIFICATION PS-33472-000.
- ASSEMBLY CONFORMS TO SAE/USCAR-2 REV 4 WITH THE FOLLOWING EXCEPTIONS: TERMINAL INSERTION FORCE FOR WIRE SIZE ABOVE 2.5mm NOT EXCEEDING 2.69mm SHALL NOT EXCEED 45 NEWTONS.

REDRAWN IEC NO: UAU2009-0814 DRAWN: THERLUTH 2009/02/20 CHKD: SMITH 2009/02/20 APPR: ANGELLOTTI 2009/02/23 REV DESCRIPTION	QUALITY SYMBOLS ▽=0 ▽=0		GENERAL TOLERANCES (UNLESS SPECIFIED) mm INCH		DIMENSION STYLE MM ONLY		SCALE 2:1		DESIGN UNITS METRIC		THIRD ANGLE PROJECTION	
	4 PLACES ±0.10 3 PLACES ±0.15 2 PLACES ±0.25 1 PLACE ±0.50		ANGULAR ±3°		DRAWN BY DATE DGRIFFI THS 06-17-03		CHECKED BY DATE DGRIFFI THS 06-17-03		TITLE MX150 BLADE CONNECTOR ASSEMBLY 2 ROW SEALED, 20 WAY			
	DRAFT WHERE APPLICABLE MUST REMAIN WITHIN DIMENSIONS		MATERIAL NO. SEE TABLE		APPROVED BY DATE DGRIFFI THS 06-17-03		MOLEX INCORPORATED		DOCUMENT NO. SD-33482-201			
	SIZE D		THIS DRAWING CONTAINS INFORMATION THAT IS PROPRIETARY TO MOLEX INCORPORATED AND SHOULD NOT BE USED WITHOUT WRITTEN PERMISSION		SHEET NO. 1 OF 2							

ASSEMBLY PART NUMBER	COLOR	KEYING OPTION	DIMENSIONS		CAVITY TYPE & STATUS (X = PLUGGED)																			
			A	B	1	2	3	4	5	6	7	8	9	10	11	12	13	14	15	16	17	18	19	20
33482-2001	BLACK	A	60°	60°																				
33482-2002	LT.GRAY	B	25°	60°																				
33482-2003	BROWN	C	60°	25°																				
33482-2004	GREEN	D	25°	25°																				
33482-2005	CUSTOM	TBD																						
33482-2006	BLACK	A	60°	60°																				X
33482-2007	BLACK	A	60°	60°										X										
33482-2008	BLACK	A	60°	60°					X	X	X	X				X	X	X	X					
33482-2009	BLACK	A	60°	60°										X					X					
33482-2010	BLACK	A	60°	60°										X	X	X			X					X
33482-2011	BLACK	A	60°	60°	X	X								X	X	X							X	X
33482-2012	BLACK	A	60°	60°	X	X								X	X	X							X	X
33482-2013	BLACK	A	60°	60°	X	X								X	X	X	X	X					X	X
33482-2014	BLACK	A	60°	60°			X	X	X							X					X			
33482-2015	BLACK	A	60°	60°			X	X	X											X				
33482-2016	BLACK	A	60°	60°		X															X	X	X	X
33482-2017	BLACK	A	60°	60°																	X	X	X	X
33482-2018	BLACK	A	60°	60°										X		X	X	X				X		
33482-2019	BLACK	A	60°	60°			X	X								X				X		X		
33482-2020	BLACK	A	60°	60°			X	X	X							X				X	X	X	X	X
33482-2021	BLACK	A	60°	60°	X	X	X	X	X							X				X	X	X	X	X
33482-2022	BLACK	A	60°	60°			X	X							X					X		X		
33482-2023	BLACK	A	60°	60°										X	X	X				X	X	X		X
33482-2024	BLACK	A	60°	60°												X	X	X						
33482-2025	BLACK	A	60°	60°										X			X			X		X		X

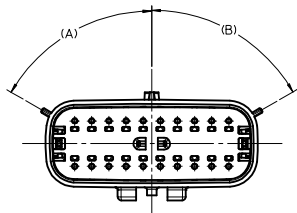

KEYING OPTION
SEE TABLE
SCALE 2:1

ENTER DESCRIPTION IEC NO. UAU2009-0814 DRAWN: THERPETH 2009/02/20 CHKD: SMITH 2009/02/20 APPR: TANIELLOTTI 2009/02/23	QUALITY SYMBOLS ▽=0 ▽=0	GENERAL TOLERANCES (UNLESS SPECIFIED) mm INCH		DIMENSION STYLE MM ONLY	SCALE 2:1	DESIGN UNITS METRIC	THIRD ANGLE PROJECTION
		4 PLACES ± .005 3 PLACES ± .005 2 PLACES ± 0.10 1 PLACE ± 0.3	± .005 ± .005 ± .005 ± .005	DRAWN BY DGRIFFI THS 06-17-03 CHECKED BY DGRIFFI THS 06-17-03 APPROVED BY DGRIFFI THS 06-17-03	DATE DATE DATE	TITLE MX150 BLADE CONNECTOR ASSEMBLY 2 ROW SEALED, 20 WAY	
DRAFT WHERE APPLICABLE MUST REMAIN WITHIN DIMENSIONS		ANGULAR ± 3°		MOLEX INCORPORATED			
				SHEET NO. 2 OF 2		THIS DRAWING CONTAINS INFORMATION THAT IS PROPRIETARY TO MOLEX INCORPORATED AND SHOULD NOT BE USED WITHOUT WRITTEN PERMISSION	