

PLEASE CHECK WWW.MOLEX.COM FOR LATEST PART INFORMATION

Part Number: **0334822003**
Status: **Active**
Overview: mx150 sealed connector system
Description: 3.50mm (.138") Pitch MX150™ Sealed Male Connector, Dual Row, 20 Circuits, Polarization C, without Connector Position Assurance, Gray

Documents:

[3D Model](#)
[Application Specification \(PDF\)](#)
[Drawing \(PDF\)](#)
[Product Specification PS-33472-000 \(PDF\)](#)
[RoHS Certificate of Compliance \(PDF\)](#)

General

Product Family	Crimp Housings
Series	<u>33482</u>
Comments	No Connector Position Assurance (CPA)
More Detailed Tech Information	http://ewcap.uscarteams.org
Overview	<u>mx150 sealed connector system</u>
Product Name	MX150™

Physical

Circuits (maximum)	20
Circuits Detail	20
Color - Resin	Black, Brown, Natural
Gender	Male
Glow-Wire Compliant	No
Keying to Mating Part	Yes
Lock to Mating Part	Yes
Material - Resin	Modified Polystyrene Alloy
Number of Rows	2
Packaging Type	Bag
Panel Mount	No
Pitch - Mating Interface (in)	0.138 In
Pitch - Mating Interface (mm)	3.50 mm
Pitch - Term. Interface (in)	0.138 In
Pitch - Term. Interface (mm)	3.50 mm
Polarized to Mating Part	Yes
Stackable	No
Temperature Range - Operating	-40°C to +125°C

Electrical

Current - Maximum per Contact	22A
-------------------------------	-----

Material Info

Reference - Drawing Numbers

Application Specification	AS-33472-100
Packaging Specification	PK-31300-635
Product Specification	PS-33472-000
Sales Drawing	SD-33482-201



EU RoHS

**ELV and RoHS
Compliant**
**REACH SVHC
Not Reviewed**
**Halogen-Free
Status
Not Reviewed**

China RoHS



**Need more information on product
environmental compliance?**

Email productcompliance@molex.com
For a multiple part number RoHS Certificate of Compliance, [click here](#)

Please visit the [Contact Us](#) section for any non-product compliance questions.

Search Parts in this Series

33482Series

Mates With

33472 Female Dual Row Sealed Connector

Use With

33000 MX150™ Tin (Sn) Male Terminal,
33011 Gold (Au) Male Terminal

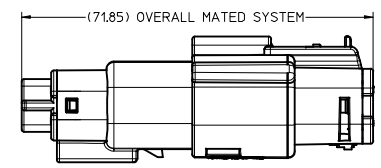

SCALE 1:1

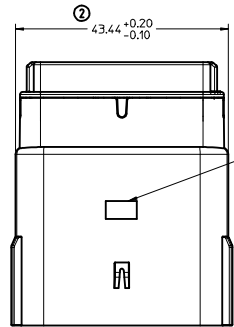
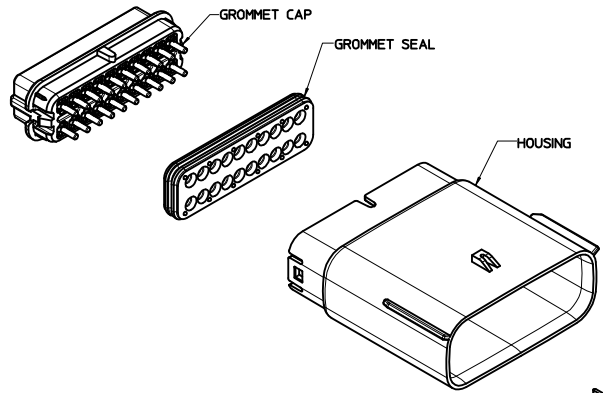

OPTIONAL TRACEABILITY INFORMATION LOCATED IN THIS AREA

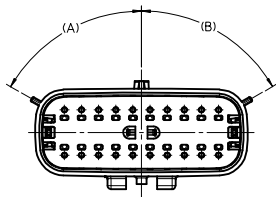
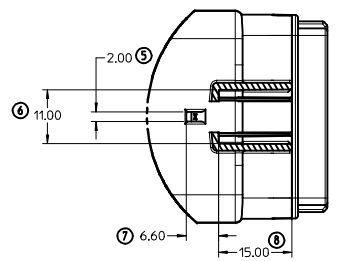
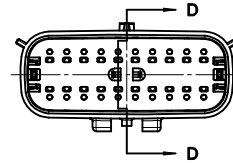
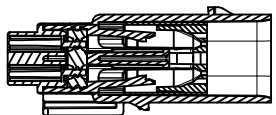
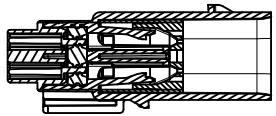
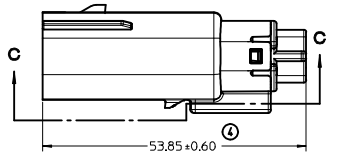
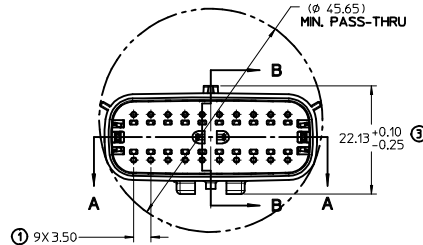
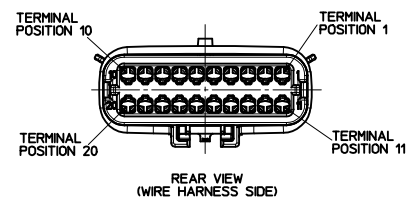
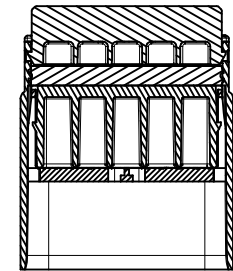

KEYING OPTION
SEE TABLE
SCALE 2:1

NOTES: UNLESS OTHERWISE STATED

- DESIGNED TO MATE WITH RECEPTACLE HOUSING ASSEMBLY SPECIFIED IN MOLEX CHARTED DRAWING SD-33472-201.
- ASSEMBLY SHIPPED WITH BLADE INSERT IN PRE-LOCKED POSITION (SEE SECTION D-D PRE-LOCK). UPON FULL TERMINAL ASSEMBLY EACH BLADE INSERT MUST BE SNAPPED INTO ITS FINAL-LOCK POSITION. FOR TO MOVE INSERT FROM FINAL TO PRE-LOCK POSITION: 75 N MAX.
- FOR BLADE TERMINALS TO BE USED WITH THIS ASSEMBLY. SEE DRAWING SD-33000-001.
- SYSTEM TO BE USED WITH WIRE WITHIN DIAMETER RANGE OF 1.5mm TO 2.5mm.
- MATERIAL: SPS/NYLON BLEND, 20% GLASS FILLED.
- SHALL CONFORM TO PACKAGING SPECIFICATION PK-31300-635.
- SHALL CONFORM TO PRODUCT SPECIFICATION PS-33472-000.
- ASSEMBLY CONFORMS TO SAE/USCAR-2 REV 4 WITH THE FOLLOWING EXCEPTIONS: TERMINAL INSERTION FORCE FOR WIRE SIZE ABOVE 2.5mm NOT EXCEEDING 2.69mm SHALL NOT EXCEED 45 NEWTONS.

REDRAWN IEC NO: UAU2009-0814 DRAWN: THERLUTH 2009/02/20 CHKD: SMITH 2009/02/20 APPR: ANGELLOTTI 2009/02/23 REV DESCRIPTION	QUALITY SYMBOLS ▽=0 ▽=0		GENERAL TOLERANCES (UNLESS SPECIFIED) mm INCH		DIMENSION STYLE MM ONLY		SCALE 2:1		DESIGN UNITS METRIC		THIRD ANGLE PROJECTION	
	4 PLACES ±0.10 3 PLACES ±0.15 2 PLACES ±0.25 1 PLACE ±0.50		ANGULAR ±3°		DRAWN BY DATE DGRIFFI THS 06-17-03		CHECKED BY DATE DGRIFFI THS 06-17-03		TITLE MX150 BLADE CONNECTOR ASSEMBLY 2 ROW SEALED, 20 WAY			
	DRAFT WHERE APPLICABLE MUST REMAIN WITHIN DIMENSIONS		MATERIAL NO. SEE TABLE		APPROVED BY DATE DGRIFFI THS 06-17-03		MOLEX INCORPORATED		DOCUMENT NO. SD-33482-201			
	SIZE D		THIS DRAWING CONTAINS INFORMATION THAT IS PROPRIETARY TO MOLEX INCORPORATED AND SHOULD NOT BE USED WITHOUT WRITTEN PERMISSION		SHEET NO. 1 OF 2							

ASSEMBLY PART NUMBER	COLOR	KEYING OPTION	DIMENSIONS		CAVITY TYPE & STATUS (X = PLUGGED)																			
			A	B	1	2	3	4	5	6	7	8	9	10	11	12	13	14	15	16	17	18	19	20
33482-2001	BLACK	A	60°	60°																				
33482-2002	LT.GRAY	B	25°	60°																				
33482-2003	BROWN	C	60°	25°																				
33482-2004	GREEN	D	25°	25°																				
33482-2005	CUSTOM	TBD																						
33482-2006	BLACK	A	60°	60°																				X
33482-2007	BLACK	A	60°	60°										X										
33482-2008	BLACK	A	60°	60°					X	X	X	X				X	X	X	X					
33482-2009	BLACK	A	60°	60°										X										
33482-2010	BLACK	A	60°	60°										X	X	X								X
33482-2011	BLACK	A	60°	60°	X	X								X	X	X								X
33482-2012	BLACK	A	60°	60°	X	X								X	X	X								X
33482-2013	BLACK	A	60°	60°	X	X								X	X	X	X	X						X
33482-2014	BLACK	A	60°	60°			X	X	X												X			X
33482-2015	BLACK	A	60°	60°			X	X	X												X			X
33482-2016	BLACK	A	60°	60°		X															X	X	X	X
33482-2017	BLACK	A	60°	60°																	X	X	X	X
33482-2018	BLACK	A	60°	60°										X		X	X	X						X
33482-2019	BLACK	A	60°	60°			X	X									X				X			X
33482-2020	BLACK	A	60°	60°			X	X	X								X				X	X	X	X
33482-2021	BLACK	A	60°	60°	X	X	X	X	X								X				X	X	X	X
33482-2022	BLACK	A	60°	60°			X	X								X					X			X
33482-2023	BLACK	A	60°	60°										X	X	X					X	X	X	X
33482-2024	BLACK	A	60°	60°													X	X	X					X
33482-2025	BLACK	A	60°	60°										X			X				X			X

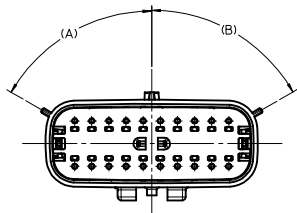

KEYING OPTION
SEE TABLE
SCALE 2:1

ENTER DESCRIPTION IEC NO. UAU2009-0814 DRAWN: THERPURTH 2009/02/20 CHKD: SMITH 2009/02/20 APPR: TANIELLOTTI 2009/02/23	QUALITY SYMBOLS ▽=0 ▽=0	GENERAL TOLERANCES (UNLESS SPECIFIED) mm INCH		DIMENSION STYLE MM ONLY	SCALE 2:1	DESIGN UNITS METRIC	THIRD ANGLE PROJECTION
		4 PLACES ± .005 3 PLACES ± .005 2 PLACES ± 0.10 1 PLACE ± 0.3	± .005 ± .005 ± .005 ± .005	± .005 ± .005 ± .005 ± .005	± .005 ± .005 ± .005 ± .005	DRAWN BY DGRIFFI THS 06-17-03 DATE	CHECKED BY DGRIFFI THS 06-17-03 DATE
DRAFT WHERE APPLICABLE MUST REMAIN WITHIN DIMENSIONS		ANGULAR ± 3°		MOLEX INCORPORATED		DOCUMENT NO. SD-33482-201	
				SHEET NO. 2 OF 2		THIS DRAWING CONTAINS INFORMATION THAT IS PROPRIETARY TO MOLEX INCORPORATED AND SHOULD NOT BE USED WITHOUT WRITTEN PERMISSION	