



# TAI-SAW TECHNOLOGY CO., LTD.

No. 3, Industrial 2nd Rd., Ping-Chen Industrial District,  
Taoyuan, 324, Taiwan, R.O.C.

TEL: 886-3-4690038 FAX: 886-3-4697532

E-mail: [tstsales@mail.taisaw.com](mailto:tstsales@mail.taisaw.com) Web: [www.taisaw.com](http://www.taisaw.com)

## Approval Sheet For Product Specification

Issued Date:

Product Name: SAW Filter 821MHz SMD 3.0×3.0mm

TST Parts No.:TA0330A

Customer Parts No.:\_\_\_\_\_

Company: _____
Division: _____
Approved by : _____
Date: _____

Checked by: \_\_\_\_\_ Elvis Chiu

Approval by: \_\_\_\_\_ Francis Chen

Date: \_\_\_\_\_ 2004/02/24



# TAI-SAW TECHNOLOGY CO., LTD.

No. 3, Industrial 2nd Rd., Ping-Chen Industrial District,  
Taoyuan, 324, Taiwan, R.O.C.

TEL: 886-3-4690038 FAX: 886-3-4697532

E-mail: [tstsales@mail.taisaw.com](mailto:tstsales@mail.taisaw.com) Web: [www.taisaw.com](http://www.taisaw.com)

## SAW Filter 821 MHz

MODEL NO.: TA0330A

REV. NO.:1

### A. MAXIMUM RATING:

1. Input Power Level: 10 dB<sub>m</sub>
2. DC voltage: 3 V
3. Operating Temperature: -25°C to +75°C
4. Storage Temperature: -40°C to +85°C

RoHS Compliant  
 Lead free  
 Lead-free soldering

### B. ELECTRICAL CHARACTERISTICS:

Item		Specification			
		Unit	Min.	Typ.	Max.
Center Frequency	F <sub>c</sub>	MHz	-	821	-
Insertion Loss	816~826 MHz	dB	-	1.9	3.5
Ripple	816~826 MHz	dB	-	0.2	2.0
VSWR	816~826 MHz		-	1.3	2.0
Absolute Attenuation					
	861 ~ 871 MHz	dB	20	37	-
Source impedance	Z <sub>s</sub>	Ω	-	50	-
Load impedance	Z <sub>L</sub>	Ω	-	50	-

Note1. No matching network required for operation at 50 Ω

### C. Frequency Characteristics :

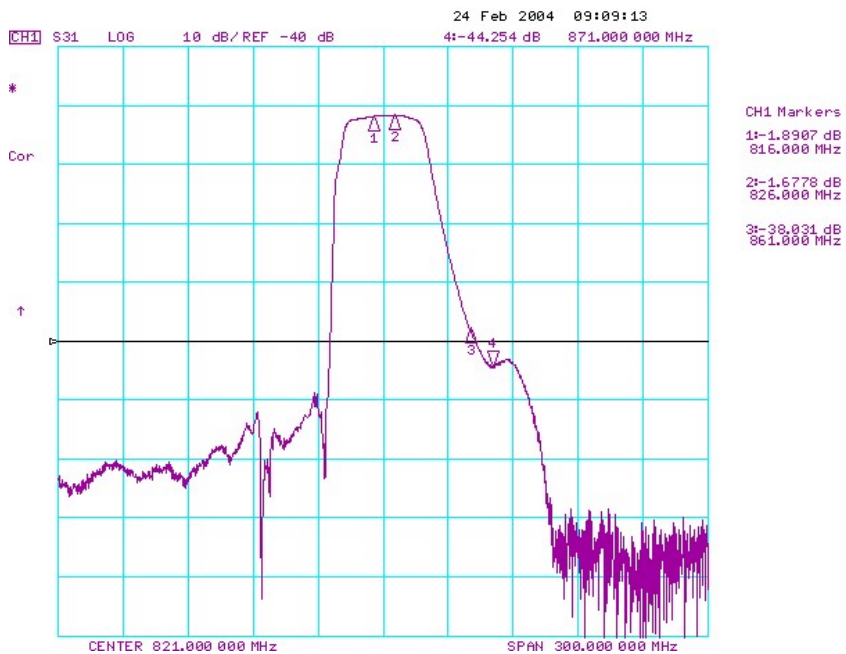
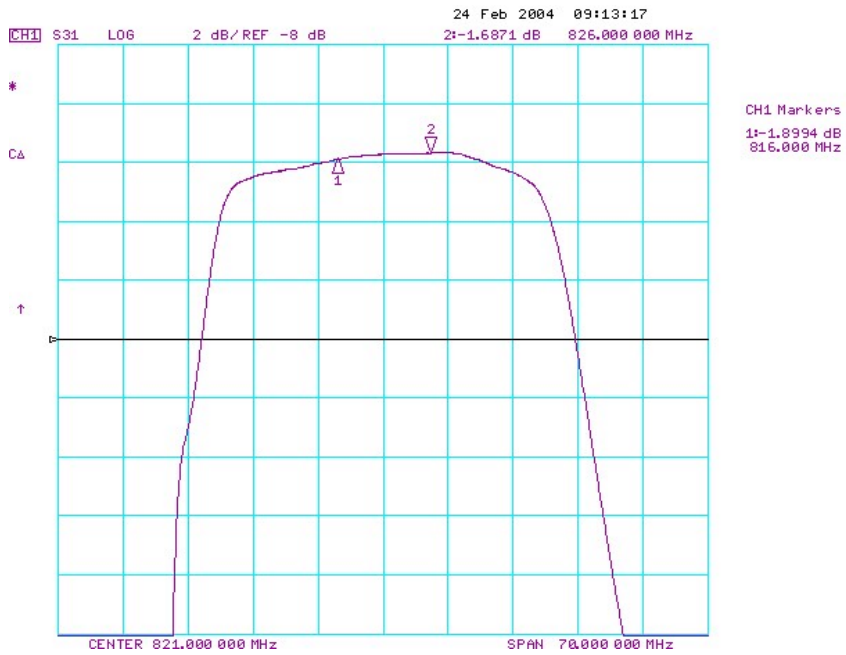

## D.Reflections Functions :

S11:

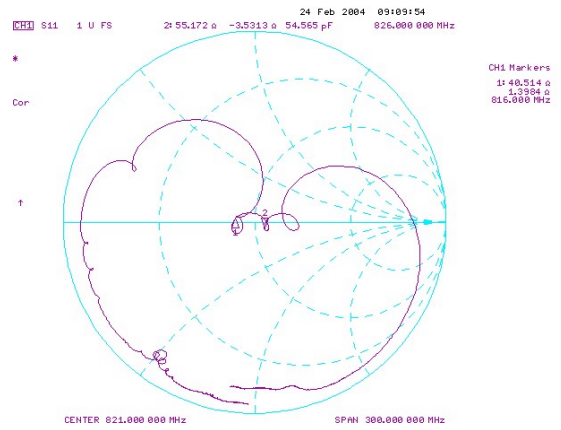

S22:

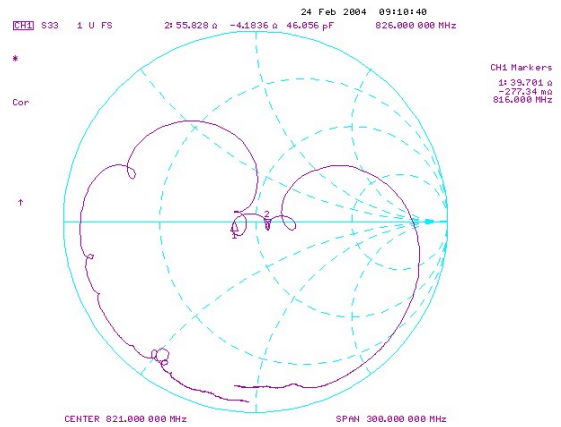

**E. MEASUREMENT CIRCUIT:**

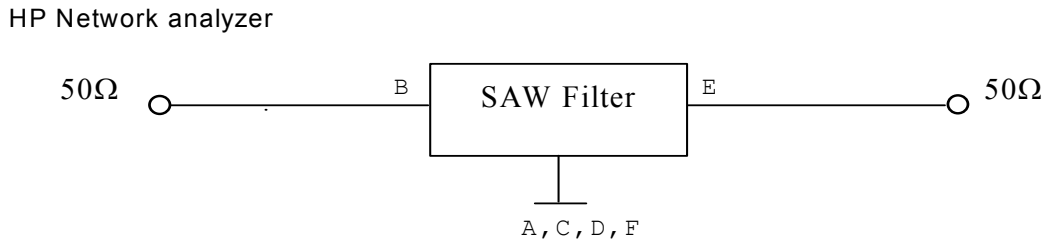

**F. OUTLINE DRAWING:**

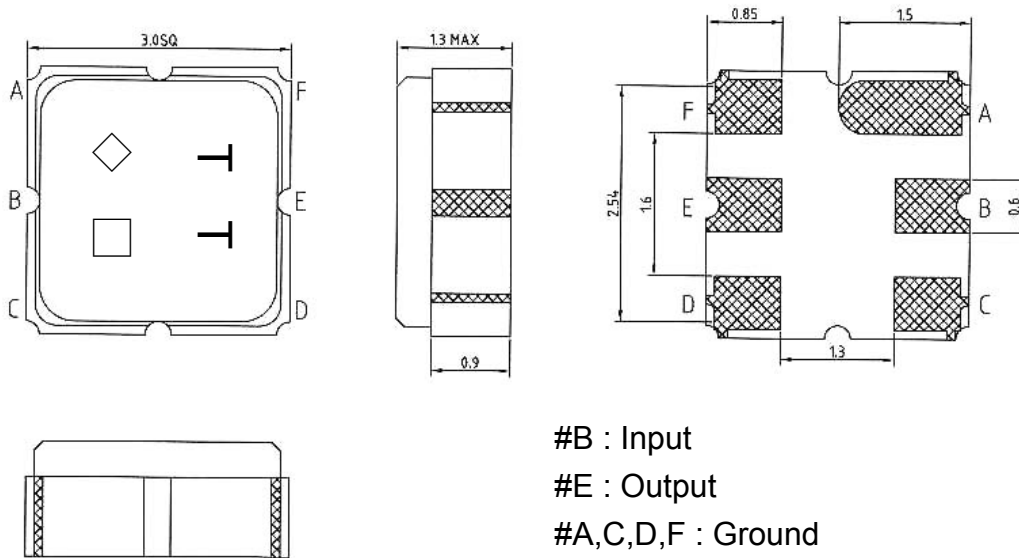

#B : Input  
 #E : Output  
 #A,C,D,F : Ground  
 ◇ : Year Code  
 □ : Date Code  
 Unit: mm

## G. PACKING:

### 1. REEL DIMENSION

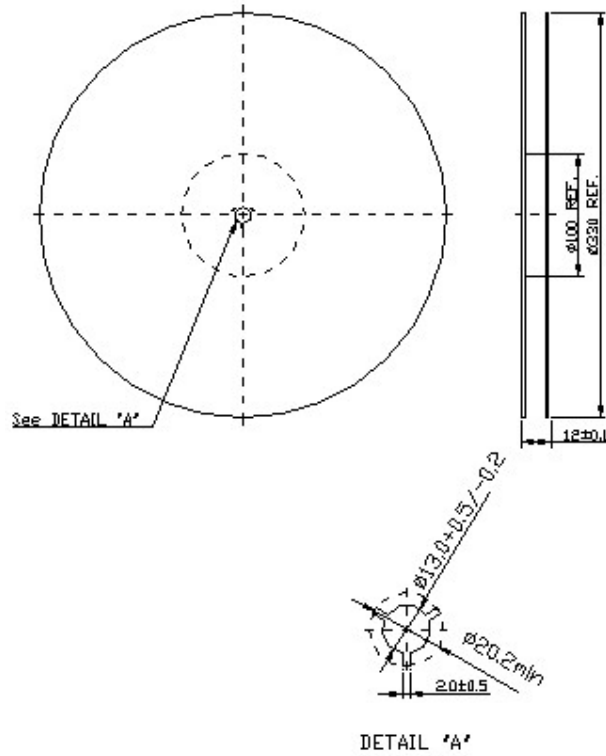

### 2. TAPE DIMENSION

