

## 16-3P-Series Pushbutton Switches



The 16-3P-Series pushbutton switches are single pole and AC rated up to 3 amps. These momentary action switches have a slow-make, slow-break contact mechanism and require only light actuation force (4 oz. - 1 lb.). These switches are typically used in general purpose applications requiring finger actuation.

### Dielectric Strength

UL/CSA: 1000V-live to dead metal parts

### Electrical Life

25,000 cycles

### Mechanical Life

100,000 cycles

### Operating Temperature

32°F to 185°F (0°C to 85°C)

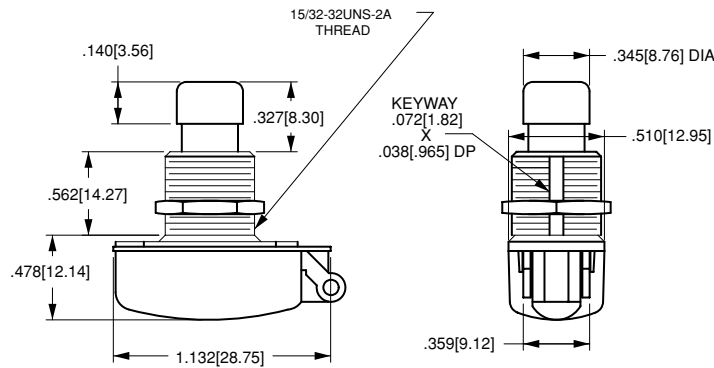

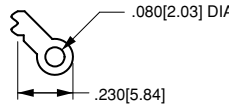
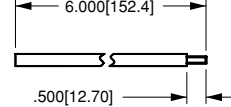
	
SOLDER LUG	INTEGRATED WIRE LEAD (no exposed conductors)
TERMINAL TYPE	

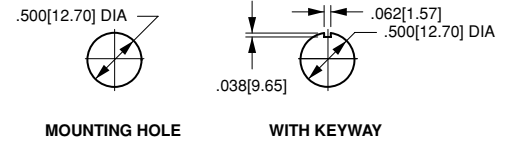

**16-3POFF - 4 - CBL**

<sup>1</sup>  
Base Part Number

<sup>2</sup>  
Bushing

<sup>3</sup>  
Actuator Style

### 1 BASE PART NUMBER: SERIES/POLES/CIRCUITRY/RATING/TERMINATION

#### Single Pole

#### 3A 125VAC

OFF - (ON)

OFF - (ON) with overtravel <sup>1</sup>

ON - OFF

#### 1A 125VAC

ON - ON

ON - ON with overtravel <sup>1</sup>

1 ON - 1 OFF (2 circuit)

1 ON - 1 OFF with overtravel <sup>1</sup> (2 circuit)

#### solder lug

16-3POFF

16-3POFF-OV

16-3PON

116-P

116-P-OV

516-P

516-P-OV

#### wire leads

16-3APOFF

16-3APOFF-OV

16-3APON

116-AP

116-AP-OV

516-AP

516-AP-OV

### 2 BUSHING STYLE

2 .312 length

4 .562 length

### 3 ACTUATOR STYLE<sup>2</sup>

CBL black plastic color cap

CRD red plastic color cap

### NOTES

<sup>1</sup> Overtravel only available with #4 bushing.

<sup>2</sup> When selection 3 is left blank, a standard nickel plated plunger is supplied.

( ) Indicates momentary function.