

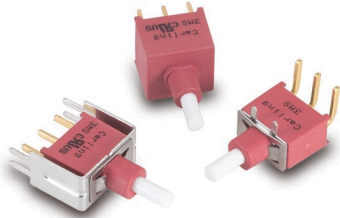

3MN-Series
Snap-Action Miniature Pushbutton Switch

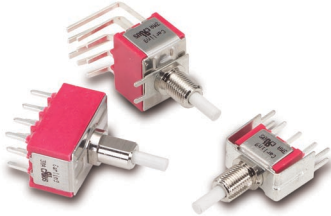

3MS-Series
Sealed Snap-Action Miniature Pushbutton Switch



3MA-Series
Alternate Action Miniature Pushbutton Switch

Specifications

Contact Rating	refer to ordering scheme
Electrical Life	50,000 make & break cycles @ full load
Contact Resistance.	3MN & 3MA-Series: 10 mΩ max. initial @ 2-4 VDC 100mA for both silver & gold plated contacts. 3MS-Series: 50 mΩ max. initial @ 2-4 VDC 100mA for both silver & gold plated contacts.
Insulation Resistance . . .	1000 MΩ min.
Dielectric Strength	1500 Volts RMS @ sea level
Operating Temperature . . .	-30°C to +85°C
Index of Protection	3MS -Series: IP68
Cap Installation Support . .	3MS-Series: 10 lbs. max.
Solder Heat Resistance. . .	MIL-STD-202, Method 210
Actuator Travel25°

Materials

Case	3MN & 3MA-Series: Diallyl phthalate (DAP) (UL 94V-0) 3MS-Series: Glass filled nylon 6/6, flame retardant, heat stabilized (UL 94V-0)
Plunger.	3MN-Series: Thermoplastic polyester, black 3MS & 3MA-Series: Glass filled nylon or glass filled polyester (UL 94V-0)
Bushing	3MN-Series: Brass, nickel plated 3MA-Series: Zinc, nickel plated
Housing.	3MN & 3MA-Series: Stainless Steel
Switch Support Retainer . .	3MS-Series: Stainless Steel
Terminal Seal	Epoxy

3M-Series Optional Cap

To order a cap assembled on a switch, specify the switch number followed by the cap part number and the word "assembled".

Ex: 3MN-SP-7-P2-B6-M6QE-C13ASSEMBLED

To order caps in bulk, specify the Series, followed by the cap. Ex.) 3MN-C13



<p>1 SERIES OR SWITCH CATALOG NUMBER 3MN, 3MS or 3MA</p>	<p>3 CAP COLOR</p> <table border="0" style="width: 100%;"> <tr> <td>1 white</td> <td>5 yellow</td> </tr> <tr> <td>2 black</td> <td>6 green</td> </tr> <tr> <td>3 red</td> <td>7 blue</td> </tr> <tr> <td>4 orange</td> <td></td> </tr> </table> <p><small>1 Black, white & red standard. Other colors available. Consult factory.</small></p>	1 white	5 yellow	2 black	6 green	3 red	7 blue	4 orange	
1 white	5 yellow								
2 black	6 green								
3 red	7 blue								
4 orange									
<p>2 CAP SIZE</p> <table border="0" style="width: 100%;"> <tr> <td>C1 round 7.6mm dia.</td> <td>C5 round 14.5mm dia.</td> </tr> <tr> <td>C2 round 9.35 mm dia.</td> <td>(for 3MA w/ PL bushing)</td> </tr> <tr> <td>C3 square 11.7 x 11.7mm</td> <td>C6 brass chrome plated</td> </tr> <tr> <td>C4 round 5mm dia.</td> <td>(for 3MA w/ PD bushing)</td> </tr> </table>	C1 round 7.6mm dia.	C5 round 14.5mm dia.	C2 round 9.35 mm dia.	(for 3MA w/ PL bushing)	C3 square 11.7 x 11.7mm	C6 brass chrome plated	C4 round 5mm dia.	(for 3MA w/ PD bushing)	
C1 round 7.6mm dia.	C5 round 14.5mm dia.								
C2 round 9.35 mm dia.	(for 3MA w/ PL bushing)								
C3 square 11.7 x 11.7mm	C6 brass chrome plated								
C4 round 5mm dia.	(for 3MA w/ PD bushing)								

**3MN-Series Ordering Scheme
with Square Actuator**

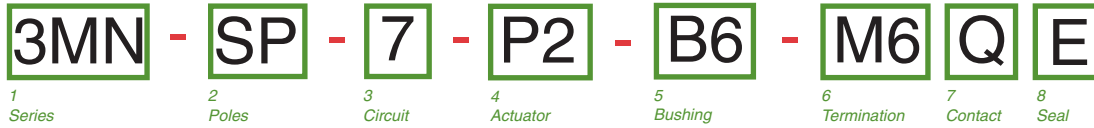
with Plunger Actuator

1 SERIES
3MN Snap-Action Miniature Pushbutton Switch

2 POLES
SP single pole **DP** double pole
3 CIRCUIT

() - momentary

7 ON (ON)
4 ACTUATOR¹
SQUARE ACTUATOR (use with Color Options in Selection 5A & 5B.)

AP1 square with no frame
AP2 square raised above frame
AP3 square flush with frame

PLUNGER ACTUATOR (use with Bushing Options in Selection 5)

P0 2.5mm short plunger(for B6 bushing only)
P1 5.2mm plunger(for bushing B10,B11,B20,B21; 7.5mm for B6)
P2 2.0mm plunger(for bushing B10,B11,B20,B21; 4.2mm for B6)

5A ACTUATOR COLOR & 5B FRAME COLOR^{1,2}

1 white	4 orange	7 blue
2 black	5 yellow	8 brown
3 red	6 green	9 gray

1 Black, white and red are standard. Other colors available, consult factory for details.
 2 Selection 5B is blank if actuator style is AP1 (no frame)

OR

5 BUSHING
B6 Unthreaded (for terminations VS6-VS9 only)
B10 Threaded keyway
B11 Threaded with flat
B20 Unthreaded keyway
B21 Unthreaded with flat

NOTE:

 If ordering optional CAP with bushings B10, B11, B20 or B21, specify actuator P1.
 For CAP with bushing B6, specify actuator P2.
 For CAP options, see ordering scheme on page 35.

6 TERMINATION

M1	Solder Lug
M2	PCB
M5-1	Wire Wrap .750 [19.05]
M5-3	Wire Wrap .425 [10.80]
M6	PC Mount, 90° horizontal
M7	PC Mount, 90° vertical
VS2	PC Mount, U bracket, .620 mounting x .460 high
VS3	PC Mount, U bracket, .620 mounting x .630 high
VS4	PC Mount, U bracket, .750 mounting x .460 high
VS5	PC Mount, U bracket, .750 mounting x .630 high
VS6	PC Mount, U bracket, .460 high (for B6 bushing only)
VS7	PC Mount, U bracket, .630 high (for B6 bushing only)
VS8	PC Mount, U bracket, .460 high (for B6 bushing only)
VS9	PC Mount, U bracket, .630 high (for B6 bushing only)

7 CONTACT

	Material	Terminal Plating	Rating	Approvals
G	silver ¹	gold over silver ³	1A@120VAC or 28VDC	UL, CUL
Q	silver ¹	silver ¹	1A@120VAC or 28VDC	UL, CUL
R	gold ²	gold ²	0.4VA max. @20V max (AC/DC)	

NOTE:

Tin-lead option available with PC type terminations only.
 1 Moveable contact & terminals: copper alloy, silver plate
 2 Moveable contact & terminals: copper alloy with gold plate over nickel plate
 3 Terminals: silver plate with outer layer in gold plating

8 EPOXY SEAL
E epoxy seal

3MS-Series Ordering Scheme

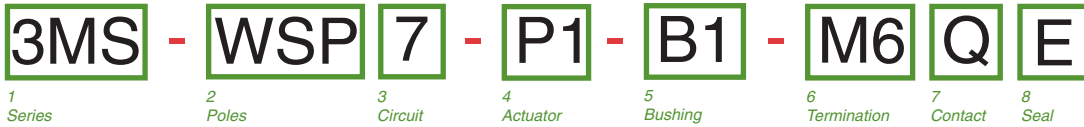

<p>1 SERIES 3MS Sealed Snap-Action Miniature Pushbutton Switch</p> <p>2 POLES WSP single pole WDP double pole</p> <p>3 CIRCUIT () - momentary 7 ON (ON)</p> <p>4 ACTUATOR P1 .173" plunger (for B1 bushing); .276" (for B4 bushing) P2 .220" plunger (for B1 bushing); .327" (for B4 bushing) P3 .087" plunger (for B1 bushing); .193" (for B4 bushing)</p> <p>5 BUSHING B1 Threaded B4 Unthreaded</p>	<p>6 TERMINATION</p> <table border="0" style="width: 100%;"> <tr> <td style="width: 50%; vertical-align: top;"> <p>M1 Solder Lug M2 PCB M6 PC Mount, 90° horizontal M61 Snap-In, 90° horizontal M7 PC Mount, 90° vertical M71 Snap-In, 90° vertical VS2 PC Mount, U bracket, .620 mounting x .460 high</p> </td> <td style="width: 50%; vertical-align: top;"> <p>VS21 Snap-In, U bracket, .620 mounting x .460 high VS3 PC Mount, U bracket, .620 mounting x .630 high VS4 PC Mount, U bracket, .750 mounting x .460 high VS5 PC Mount, U bracket, .750 mounting x .630 high</p> </td> </tr> </table> <p>7 CONTACT</p> <table border="0" style="width: 100%;"> <thead> <tr> <th style="text-align: left;">Material</th> <th style="text-align: left;">Terminal Plating</th> <th style="text-align: left;">Rating</th> <th style="text-align: left;">Approvals</th> </tr> </thead> <tbody> <tr> <td>G silver¹</td> <td>gold over silver³</td> <td>1A @ 120VAC or 28VDC</td> <td>UL, CUL IP68</td> </tr> <tr> <td>Q silver¹</td> <td>silver¹</td> <td>1A @ 120VAC or 28VDC</td> <td>UL, CUL IP68</td> </tr> <tr> <td>R gold²</td> <td>gold²</td> <td>0.4VA max. @ 20V max (AC/DC)</td> <td>IP68</td> </tr> </tbody> </table> <p>NOTE: Tin-lead option available with PC type terminations only. 1 Moveable contact & terminals: copper alloy, silver plate 2 Moveable contact & terminals: copper alloy with gold plate over nickel plate 3 Terminals: silver plate with outer layer in gold plating</p> <p>7 EPOXY SEAL E epoxy seal</p>	<p>M1 Solder Lug M2 PCB M6 PC Mount, 90° horizontal M61 Snap-In, 90° horizontal M7 PC Mount, 90° vertical M71 Snap-In, 90° vertical VS2 PC Mount, U bracket, .620 mounting x .460 high</p>	<p>VS21 Snap-In, U bracket, .620 mounting x .460 high VS3 PC Mount, U bracket, .620 mounting x .630 high VS4 PC Mount, U bracket, .750 mounting x .460 high VS5 PC Mount, U bracket, .750 mounting x .630 high</p>	Material	Terminal Plating	Rating	Approvals	G silver ¹	gold over silver ³	1A @ 120VAC or 28VDC	UL, CUL IP68	Q silver ¹	silver ¹	1A @ 120VAC or 28VDC	UL, CUL IP68	R gold ²	gold ²	0.4VA max. @ 20V max (AC/DC)	IP68
<p>M1 Solder Lug M2 PCB M6 PC Mount, 90° horizontal M61 Snap-In, 90° horizontal M7 PC Mount, 90° vertical M71 Snap-In, 90° vertical VS2 PC Mount, U bracket, .620 mounting x .460 high</p>	<p>VS21 Snap-In, U bracket, .620 mounting x .460 high VS3 PC Mount, U bracket, .620 mounting x .630 high VS4 PC Mount, U bracket, .750 mounting x .460 high VS5 PC Mount, U bracket, .750 mounting x .630 high</p>																		
Material	Terminal Plating	Rating	Approvals																
G silver ¹	gold over silver ³	1A @ 120VAC or 28VDC	UL, CUL IP68																
Q silver ¹	silver ¹	1A @ 120VAC or 28VDC	UL, CUL IP68																
R gold ²	gold ²	0.4VA max. @ 20V max (AC/DC)	IP68																

3MA-Series Ordering Scheme

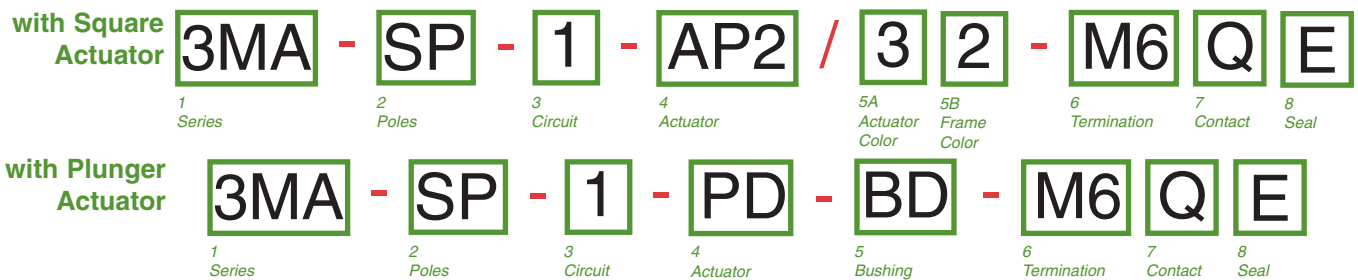

<p>1 SERIES 3MA Alternate-Action Miniature Pushbutton Switch</p> <p>2 POLES SP single pole DP double pole 3P three pole 4P four pole</p> <p>3 CIRCUIT () - momentary <i>Switching Position:</i> 1 ON 2-3, 5-6, 8-9, 11-12 OPEN NONE 2-1, 5-4, 8-7, 11-10 ON (ON) 2 ON NONE (ON)</p> <p>4 ACTUATOR SQUARE ACTUATOR (use with Color Options in Selection 5A & 5B.) AP1 square with no frame AP2 square raised above frame PLUNGER ACTUATOR (use with Bushing Options in Selection 5) PA .118 dia. x .299" plunger length PI .118 dia. x .244" plunger length PL .118 dia. x .327" plunger length PC .315" dia. brass chrome plated plunger (for BD bushing only) PD .242" dia. brass chrome plated plunger (for BD bushing only)</p> <p>5A ACTUATOR COLOR & 5B FRAME COLOR^{1,2} 1 white 4 orange 7 blue 2 black 5 yellow 8 brown 3 red 6 green 9 gray</p> <p>1 Black, red and white are standard. Other colors available, consult factory for details. 2 Selection 5B is blank if actuator style AP1 (no frame) OR</p> <p>5 BUSHING BD Big bushing for PC, PD actuator 15/32" B10 Threaded 1/4 - 40 B20 Unthreaded B21 Unthreaded with flat</p> <p>NOTE: For CAP options, see ordering scheme on page 35.</p>	<p>6 TERMINATION</p> <table border="0" style="width: 100%;"> <tr> <td style="width: 50%; vertical-align: top;"> <p>M1 Solder Lug M2 PCB M5-1 Wire Wrap .750 [19.05] M5-2 Wire Wrap .964 [24.48] M5-3 Wire Wrap .425 [10.80] M5-4 Wire Wrap 1.062 [26.87] M6 PC Mount, 90° horizontal M7 PC Mount, 90° vertical</p> </td> <td style="width: 50%; vertical-align: top;"> <p>VS2 PC Mount, U bracket, .620 mounting x .460 high VS3 PC Mount, U bracket, .620 mounting x .630 high VS4 PC Mount, U bracket, .750 mounting x .460 high VS5 PC Mount, U bracket, .750 mounting x .630 high</p> </td> </tr> </table> <p>7 CONTACT</p> <table border="0" style="width: 100%;"> <thead> <tr> <th style="text-align: left;">Material</th> <th style="text-align: left;">Terminal Plating</th> <th style="text-align: left;">Rating</th> <th style="text-align: left;">Approvals</th> </tr> </thead> <tbody> <tr> <td>G silver¹</td> <td>gold over silver³</td> <td>6A @ 125VAC or 28VDC, 3A @ 250VAC</td> <td>UL, CUL</td> </tr> <tr> <td>K gold²</td> <td>tin-lead⁴</td> <td>6A @ 125VAC or 28VDC, 3A @ 250VAC</td> <td>UL, CUL</td> </tr> <tr> <td>P silver¹</td> <td>tin-lead⁴</td> <td>6A @ 125VAC or 28VDC, 3A @ 250VAC</td> <td>UL, CUL</td> </tr> <tr> <td>Q silver¹</td> <td>silver¹</td> <td>6A @ 125VAC or 28VDC, 3A @ 250VAC</td> <td>UL, CUL</td> </tr> <tr> <td>R gold²</td> <td>gold²</td> <td>0.4VA max. @ 20V max (AC/DC)</td> <td></td> </tr> </tbody> </table> <p>NOTE: Tin-lead option available with PC type terminations only. 1 Moveable contact & terminals: copper alloy, silver plate 2 Moveable contact & terminals: copper alloy with gold plate over nickel plate 3 Terminals: silver plate with outer layer in gold plating 4 Outer terminals: copper alloy with tin-lead over nickel plate</p> <p>8 EPOXY SEAL E epoxy seal</p>	<p>M1 Solder Lug M2 PCB M5-1 Wire Wrap .750 [19.05] M5-2 Wire Wrap .964 [24.48] M5-3 Wire Wrap .425 [10.80] M5-4 Wire Wrap 1.062 [26.87] M6 PC Mount, 90° horizontal M7 PC Mount, 90° vertical</p>	<p>VS2 PC Mount, U bracket, .620 mounting x .460 high VS3 PC Mount, U bracket, .620 mounting x .630 high VS4 PC Mount, U bracket, .750 mounting x .460 high VS5 PC Mount, U bracket, .750 mounting x .630 high</p>	Material	Terminal Plating	Rating	Approvals	G silver ¹	gold over silver ³	6A @ 125VAC or 28VDC, 3A @ 250VAC	UL, CUL	K gold ²	tin-lead ⁴	6A @ 125VAC or 28VDC, 3A @ 250VAC	UL, CUL	P silver ¹	tin-lead ⁴	6A @ 125VAC or 28VDC, 3A @ 250VAC	UL, CUL	Q silver ¹	silver ¹	6A @ 125VAC or 28VDC, 3A @ 250VAC	UL, CUL	R gold ²	gold ²	0.4VA max. @ 20V max (AC/DC)	
<p>M1 Solder Lug M2 PCB M5-1 Wire Wrap .750 [19.05] M5-2 Wire Wrap .964 [24.48] M5-3 Wire Wrap .425 [10.80] M5-4 Wire Wrap 1.062 [26.87] M6 PC Mount, 90° horizontal M7 PC Mount, 90° vertical</p>	<p>VS2 PC Mount, U bracket, .620 mounting x .460 high VS3 PC Mount, U bracket, .620 mounting x .630 high VS4 PC Mount, U bracket, .750 mounting x .460 high VS5 PC Mount, U bracket, .750 mounting x .630 high</p>																										
Material	Terminal Plating	Rating	Approvals																								
G silver ¹	gold over silver ³	6A @ 125VAC or 28VDC, 3A @ 250VAC	UL, CUL																								
K gold ²	tin-lead ⁴	6A @ 125VAC or 28VDC, 3A @ 250VAC	UL, CUL																								
P silver ¹	tin-lead ⁴	6A @ 125VAC or 28VDC, 3A @ 250VAC	UL, CUL																								
Q silver ¹	silver ¹	6A @ 125VAC or 28VDC, 3A @ 250VAC	UL, CUL																								
R gold ²	gold ²	0.4VA max. @ 20V max (AC/DC)																									

3MN-Series Dimensional Specifications: in. [mm]

PLUNGER

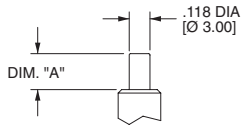

OPTION CODE	DIM. "A"
P0	.000 [0.00]
P1	.205 [5.20]
P2	.079 [2.00]

FOR B10,B11,B20,B21 ONLY

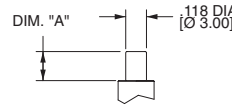

OPTION CODE	DIM. "A"
P0	.098 [2.50]
P1	.295 [7.50]
P2	.165 [4.20]

FOR B6 ONLY

ACTUATOR

AP1

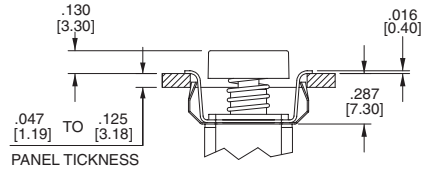
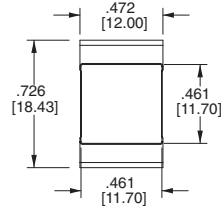

PANEL MOUNTING

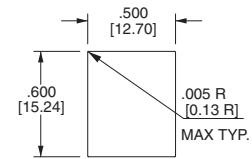

AP2

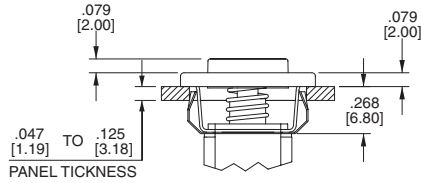
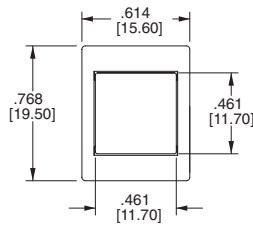

PANEL MOUNTING

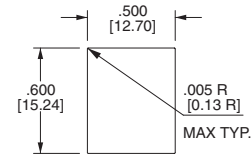

AP3

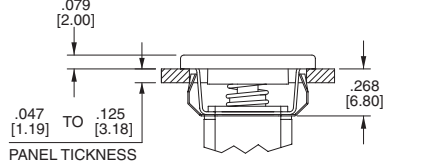
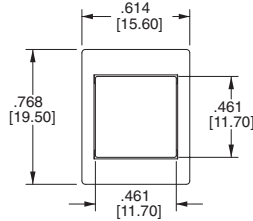

BUSHING

B10
STANDARD KEYWAY
THREADED SHOWN

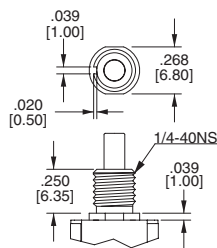

B20
STANDARD KEYWAY
NON-THREADED

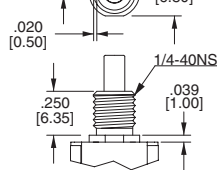

B11
THREADED SHOWN
WITH FLAT

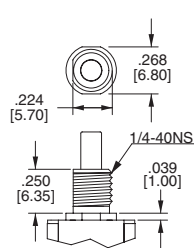

B21
NON-THREADED
WITH FLAT

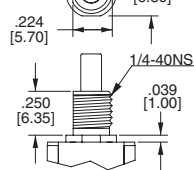

B6
NON-THREADED
(FOR TERMINATION
OPTIONS VS6-VS9 ONLY)

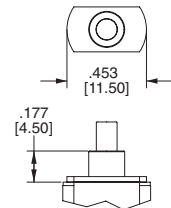

CAP

C1

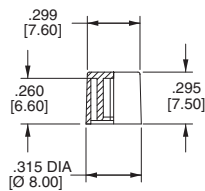

C2

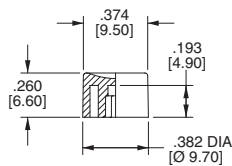

C3

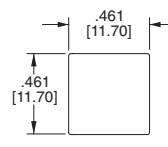

C4

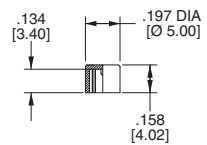

3MN-Series Dimensional Specifications: in. [mm]

TERMINATION

M1

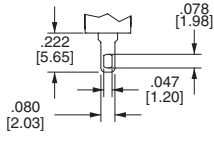

THK .030 [0.75]

M2

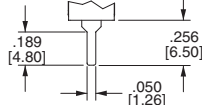

THK .030 [0.75]

M5

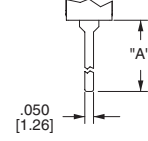

THK .030 [0.75]

OPTION CODE	DIM. "A"
M5-1	.750 [19.05]
M5-3	.425 [10.80]

SINGLE POLE

DOUBLE POLE

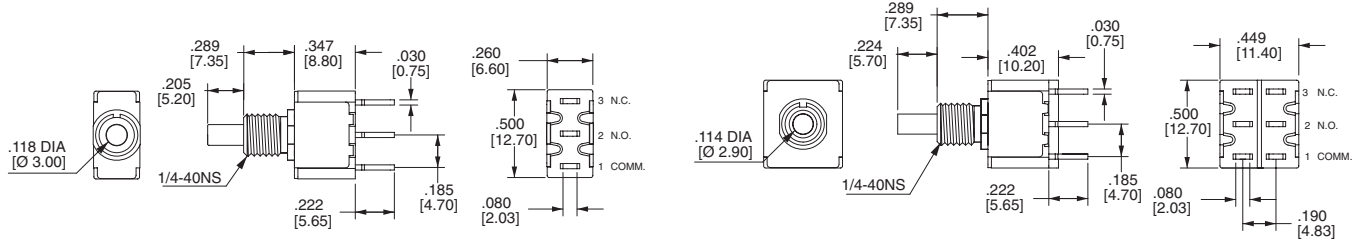

M6

SINGLE POLE

PC MOUNTING

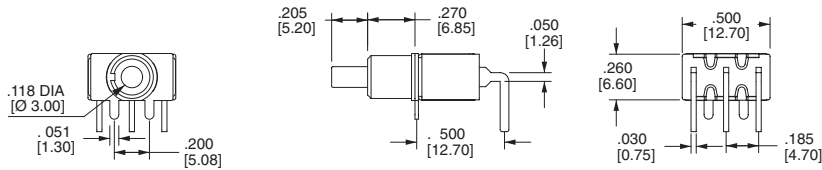

DOUBLE POLE

PC MOUNTING

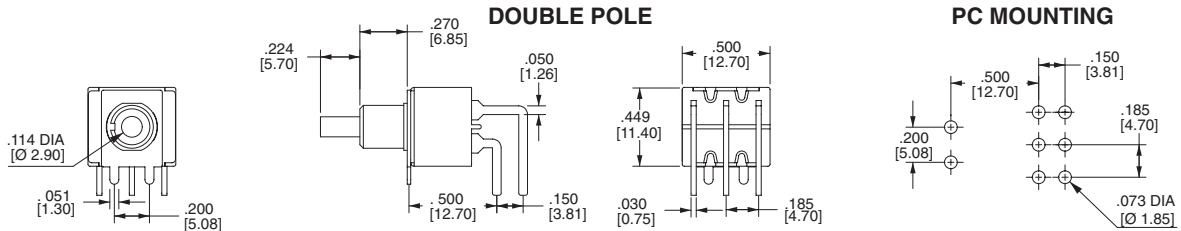

M7

SINGLE POLE

PC MOUNTING

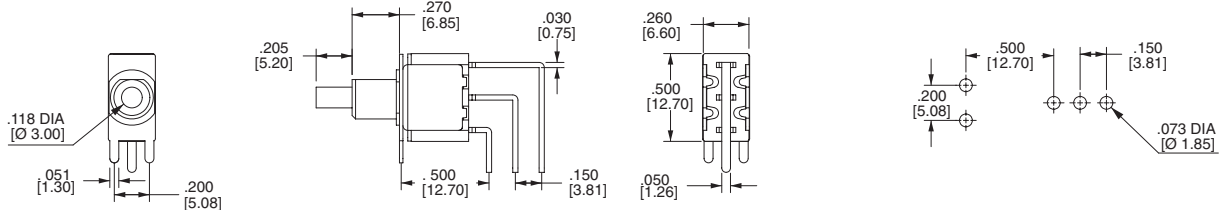

DOUBLE POLE

PC MOUNTING

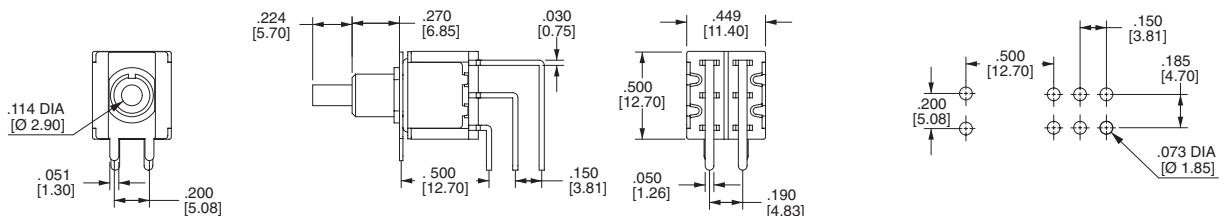

3MN-Series Dimensional Specifications: in. [mm]
TERMINATION
SINGLE POLE

OPTION CODE	DIM. "A"
VS2	.460 [11.68]
VS3	.630 [16.00]
VS7	[16.00]

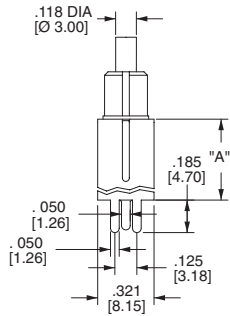
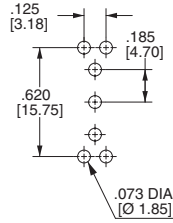
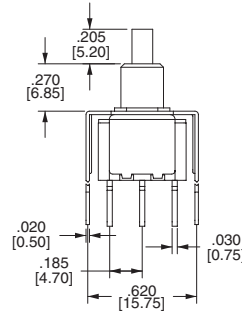
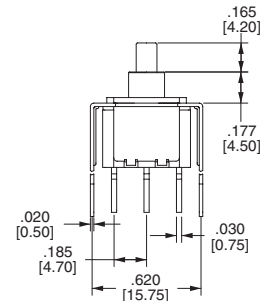
PC MOUNTING

VS2-VS3

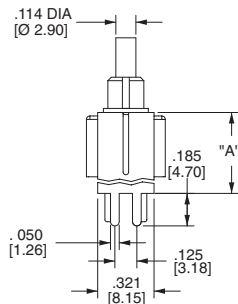
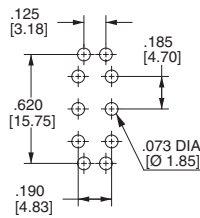
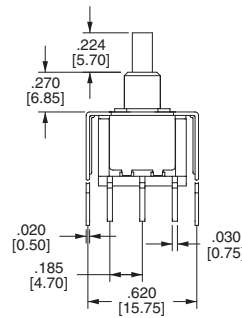
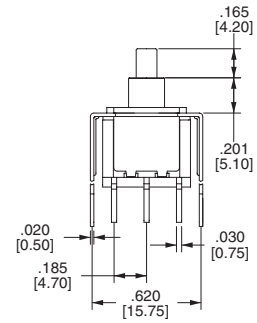
**VS6-VS7
(For B6 Bushing Only)**

DOUBLE POLE

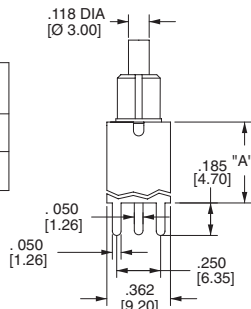
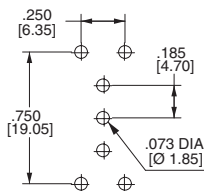
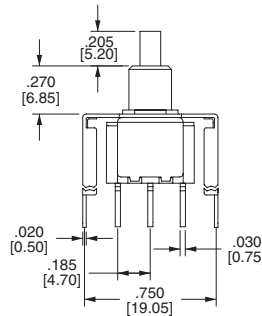
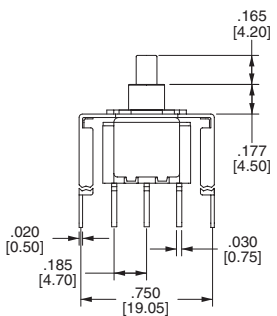
OPTION CODE	DIM. "A"
VS2	.460 [11.68]
VS6	[11.68]
VS3	.630 [16.00]
VS7	[16.00]

PC MOUNTING

VS2-VS3

**VS6-VS7
(For B6 Bushing Only)**

SINGLE POLE

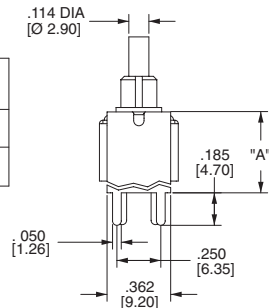
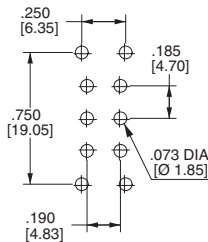
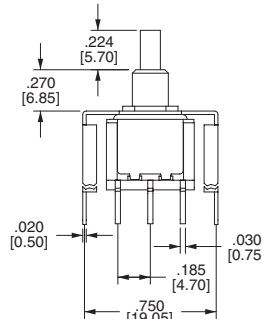
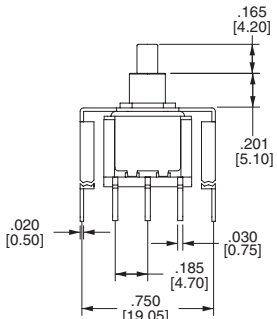
OPTION CODE	DIM. "A"
VS4	.460 [11.68]
VS8	[11.68]
VS5	.630 [16.00]
VS9	[16.00]

PC MOUNTING

VS4-VS5

**VS8-VS9
(For B6 Bushing Only)**

DOUBLE POLE

OPTION CODE	DIM. "A"
VS4	.460 [11.68]
VS8	[11.68]
VS5	.630 [16.00]
VS9	[16.00]

PC MOUNTING

VS4-VS5

**VS8-VS9
(For B6 Bushing Only)**

3MS-Series Dimensional Specifications: in. [mm]

PLUNGER

	<table border="1"> <thead> <tr> <th>OPTION CODE</th> <th>DIM. "A"</th> </tr> </thead> <tbody> <tr> <td>P1</td> <td>.173 [4.40]</td> </tr> <tr> <td>P2</td> <td>.220 [5.60]</td> </tr> <tr> <td>P3</td> <td>.087 [2.20]</td> </tr> </tbody> </table>	OPTION CODE	DIM. "A"	P1	.173 [4.40]	P2	.220 [5.60]	P3	.087 [2.20]		<table border="1"> <thead> <tr> <th>OPTION CODE</th> <th>DIM. "A"</th> </tr> </thead> <tbody> <tr> <td>P1</td> <td>.276 [7.00]</td> </tr> <tr> <td>P2</td> <td>.327 [8.30]</td> </tr> <tr> <td>P3</td> <td>.193 [4.90]</td> </tr> </tbody> </table>	OPTION CODE	DIM. "A"	P1	.276 [7.00]	P2	.327 [8.30]	P3	.193 [4.90]
OPTION CODE	DIM. "A"																		
P1	.173 [4.40]																		
P2	.220 [5.60]																		
P3	.087 [2.20]																		
OPTION CODE	DIM. "A"																		
P1	.276 [7.00]																		
P2	.327 [8.30]																		
P3	.193 [4.90]																		
FOR B1 BUSHING		FOR B4 BUSHING																	

BUSHING

B1 	B4
---------------	---------------

TERMINATION

M1 	M2
THK .030 [0.75]	THK .030 [0.75]

SINGLE POLE 	DOUBLE POLE
------------------------	------------------------

M6

	SINGLE POLE 		PC MOUNTING
	DOUBLE POLE 		PC MOUNTING

3MS-Series Dimensional Specifications: in. [mm]

TERMINATION

M7

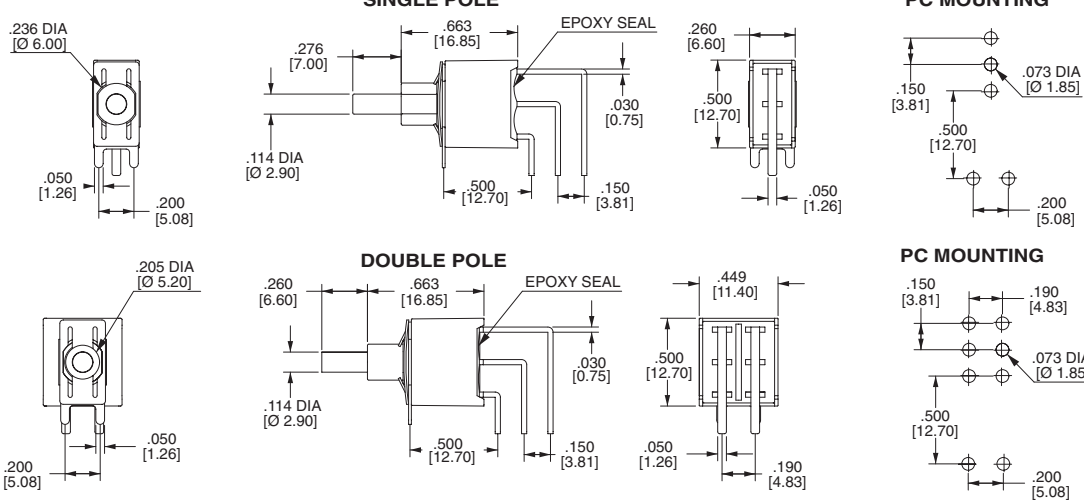

VS2-VS3

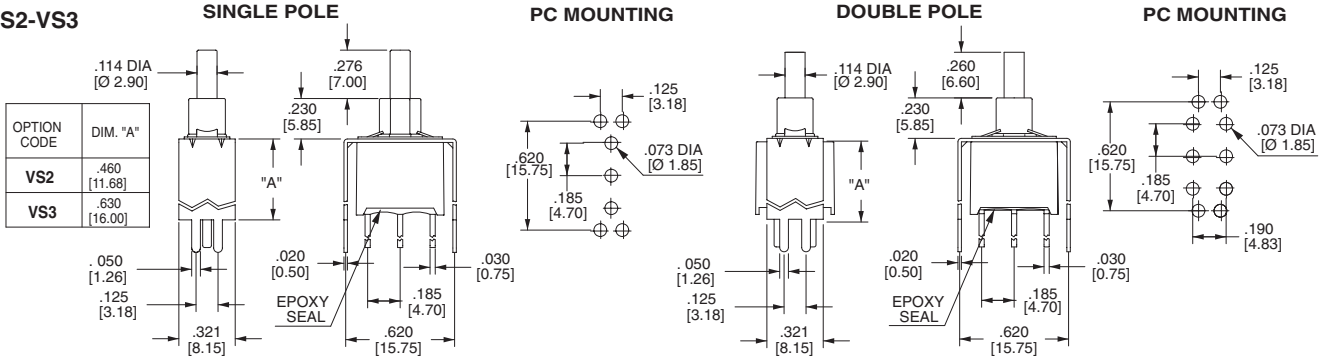

VS4-VS5

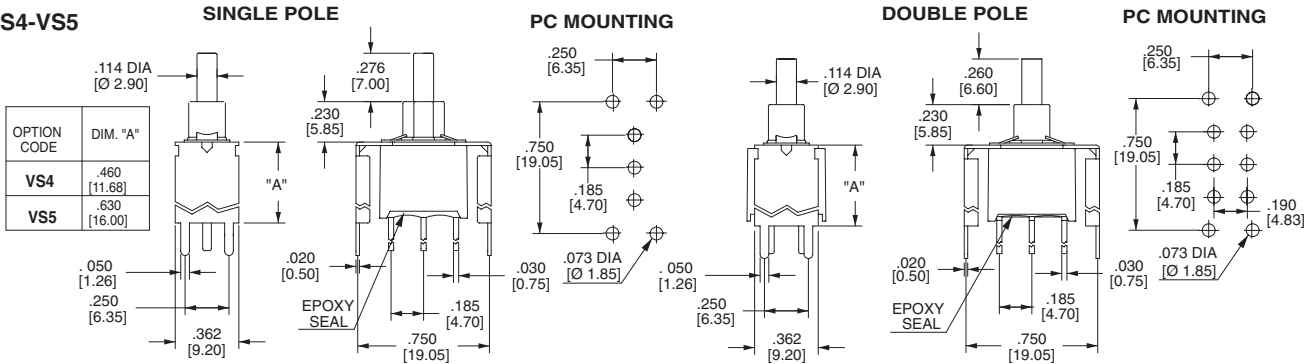

SNAP-IN TERMINATION OPTIONS

M61



M71

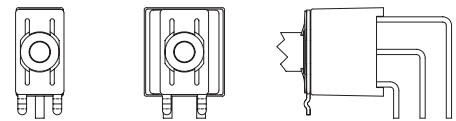

VS21, VS31

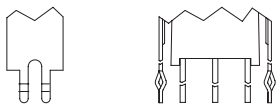

VS41, VS51

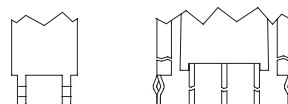

M61, M71, VS21, VS31, VS41, VS51 have the same P.C. mounting but with snap-in bracket.

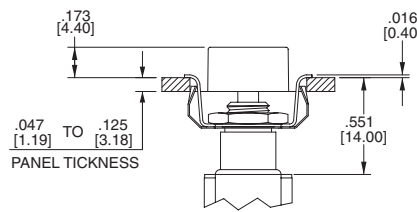
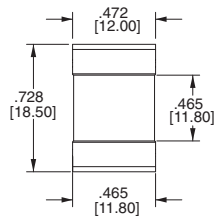
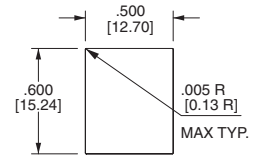
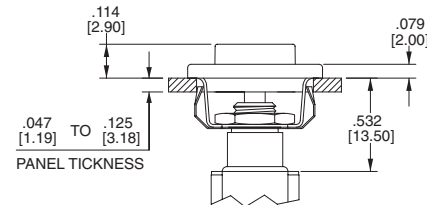
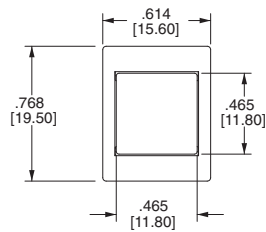
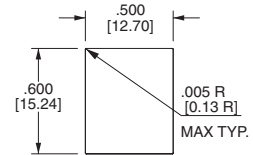
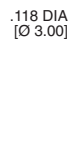
3MA-Series Dimensional Specifications: in. [mm]
ACTUATOR
AP1

PANEL MOUNTING

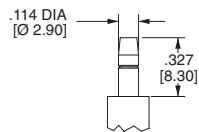
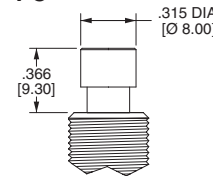
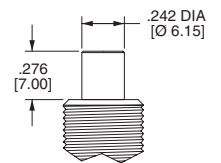
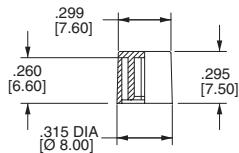
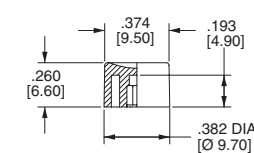
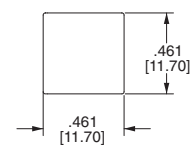
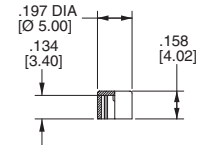
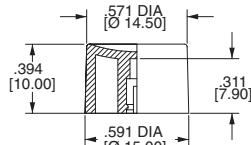
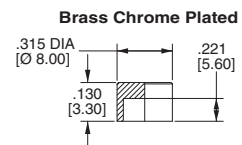
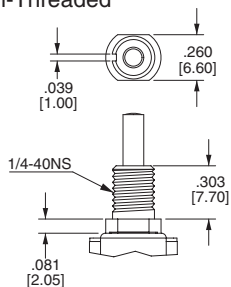
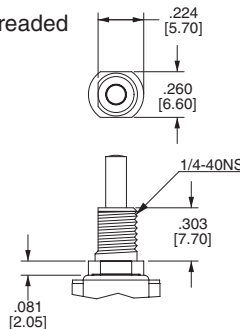
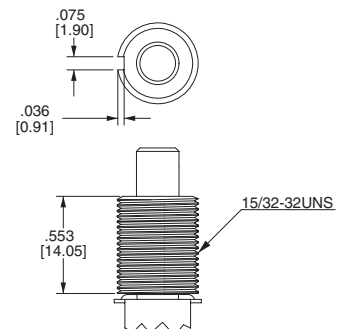
AP2

PANEL MOUNTING

PLUNGER
PA,PI

OPTION CODE	DIM. "A"
PA	.299 [7.60]
PI	.244 [6.20]

PL

PC

Brass Chrome Plated
PD

PC, PD Plunger must fit with BD bushing
CAP
C1

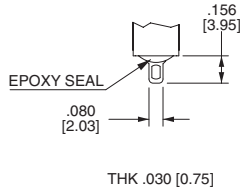
C2

C3

C4

C5

For PL Bushing Only
C6

For PD Bushing Only
BUSHING
**B10 Threaded
B20 Non-Threaded**

B21 Non-Threaded

BD

3MA-Series Dimensional Specifications: in. [mm]

TERMINATION

M1



M2

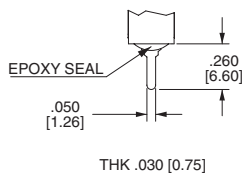

M5

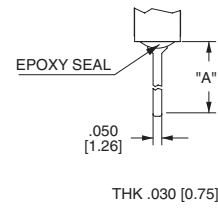

OPTION CODE	DIM. "A"
M5-1	.750 [19.05]
M5-2	.964 [24.48]
M5-3	.425 [10.80]
M5-4	1.062 [26.97]

SINGLE POLE

DOUBLE POLE

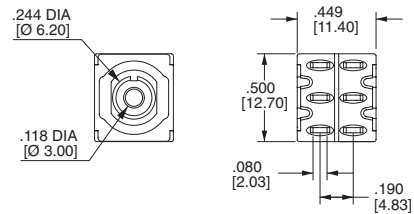
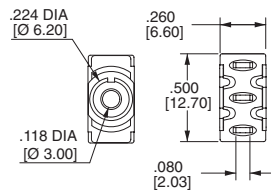
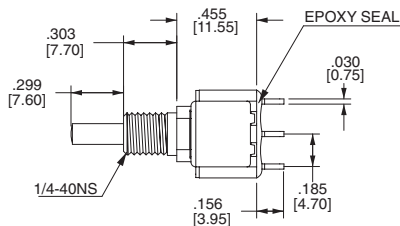

3 POLE

4 POLE

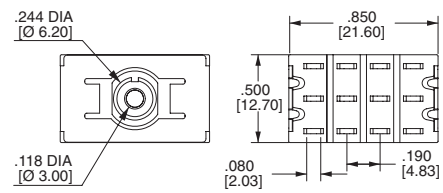
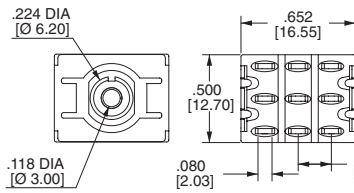
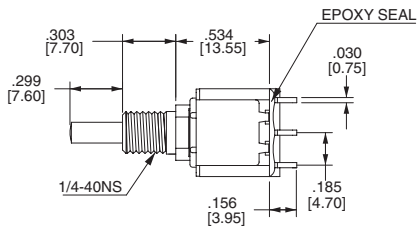

M6

SINGLE POLE

PC MOUNTING

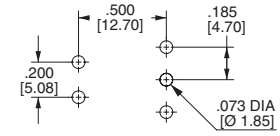
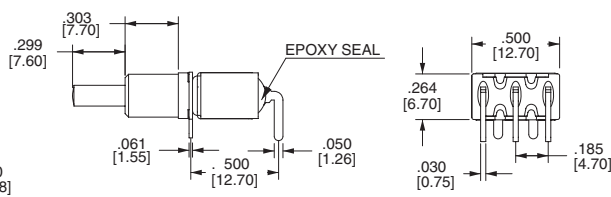
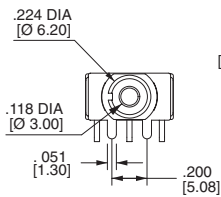

DOUBLE POLE

PC MOUNTING

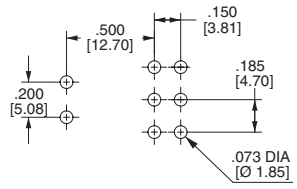
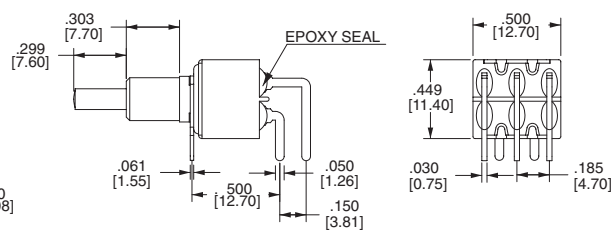
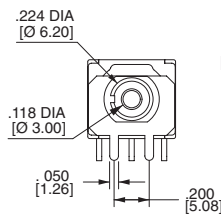

3MA-Series Dimensional Specifications: in. [mm]

TERMINATION

M7

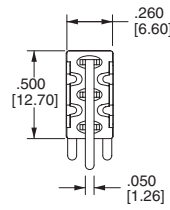
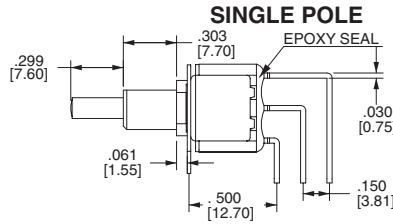
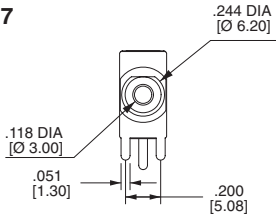

PC MOUNTING

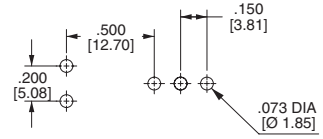

DOUBLE POLE

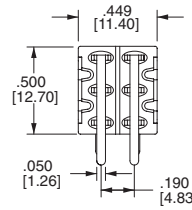
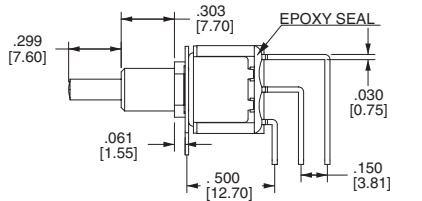
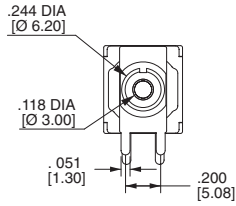

PC MOUNTING

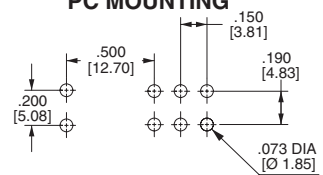

THREE POLE

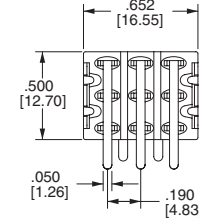
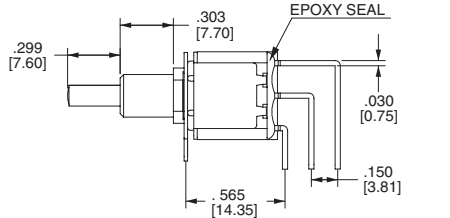
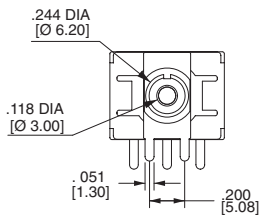

PC MOUNTING

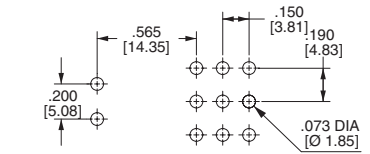

FOUR POLE

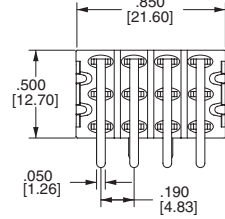
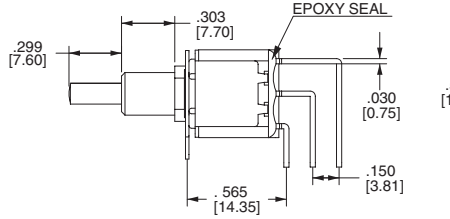
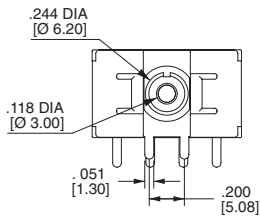

PC MOUNTING

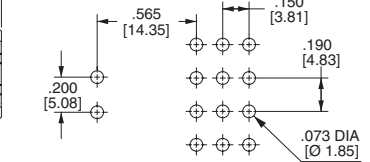

VS2-VS3

OPTION CODE	DIM. "A"
VS2	.460 [11.68]
VS3	.630 [16.00]

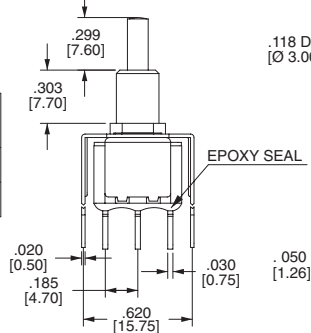

SINGLE POLE

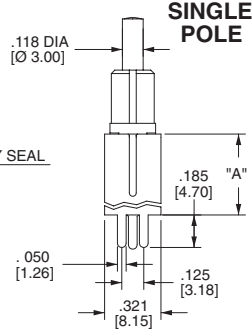

PC MOUNTING

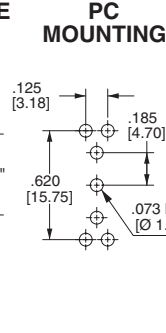

DOUBLE POLE

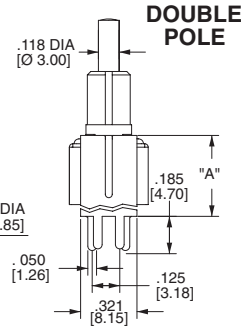

PC MOUNTING

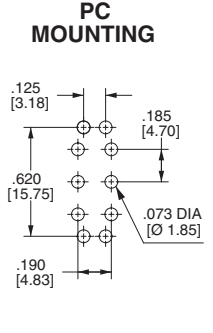

VS4-VS5

OPTION CODE	DIM. "A"
VS4	.460 [11.68]
VS5	.630 [16.00]

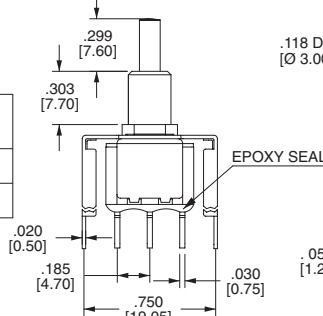

SINGLE POLE

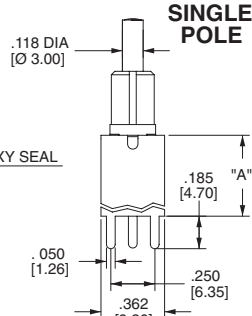

PC MOUNTING

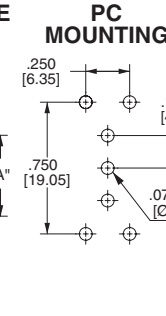

DOUBLE POLE

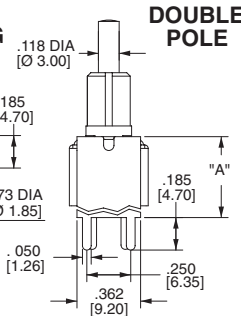

PC MOUNTING

