

CORDSETS International

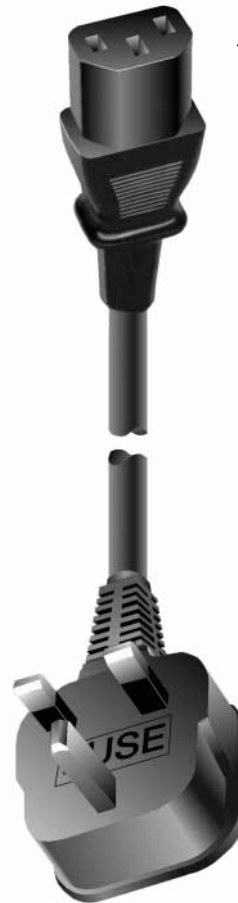

For "cold" connections 70° C, Protection Class I
Standards: EN 60320; IEC 320 / C13



North America

Standards: UL 817,
CSA 22.2-21 and 182.3



Japan

Standard: JIS 8303



Continental Europe

Standard: CEE 7 / VII

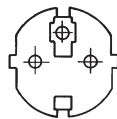

United Kingdom, Hongkong, Malaysia, Singapore;

Standards:
BS 1363A; BS 4491

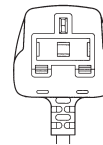

Italy

Standard: CEI 23-16 / VII



- Cord type: SJT
- Conductor: 3 x 18 AWG
- Strand: 41 / 0.16 mm
- Length: 8 feet
- Overall Dia.: 7.80 mm
- Rated 10 amps/125 volts
- Color: black

- Cord type: HVCTF3G0.75
- Conductor: 3 x 0.75 mm²
- Strand: 30 / 0.18 mm
- Length: 2.00 meters
- Overall Dia.: 7 mm
- Rated 7 amps/125 volts
- Color: black

- Cord type: HO5VV-F3G1.0
- Conductor: 3 x 1.00 mm²
- Length: 2.50 meters
- Overall Dia.: 7.20 mm
- Rated 10 amps/250 volts
- Color: black

- Cord type: HO5VV-F3G1.0
- Conductor: 3 x 1.00 mm²
- Length: 2.50 meters
- Overall Dia.: 7.20 mm
- Rated 10 amps/250 volts
- Includes 13 amp fuse
- Color: black

- Cord type: HO5VV-F3G1.0
- Conductor: 3 x 1.00 mm²
- Length: 2.50 meters
- Overall Dia.: 7.20 mm
- Rated 10 amps/250volts
- Color: black

Order Numbers

4300.0901

4300.0902

4300.0903

4300.0904

4300.0905

CORDSETS International



For "cold" connections 70° C, Protection class I
Standards: EN 60320; IEC 320 / C13



Switzerland
Standard: SEV 1011

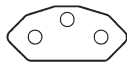

**Australia
New Zealand**
Standards: AS 3112-1990,
AS 3109 C13



N. American Jumper
Standards: UL 817, CSA
C22.2-21 and 182.3,
IEC 320-2-2

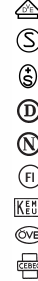

International Jumper
Standards: EN 60320 C14,
IEC 320-2-2



Medical Grade
Standards: NEMA 5-15P



Medical caution labels
available on request

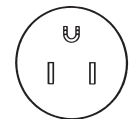

- Cord type: HO5VV-F3G1.0
- Conductor: 3 x 1.00 mm²
- Length: 2.50 meters
- Overall Dia.: 7.10 mm
- Rated 10 amps/250 volts
- Color: black

- Cord type: HO5VV - F3G1.0 (4300.0907); 3ASL/1003G1.0 (4300.0908)
- Conductor: 3 x 1.00 mm²
- Length: 2.50 meters
- Overall Dia.: 7.20 mm
- Rated 10 amps/250 volts
- Color: black

- Cord type: SJT
- Conductor: 3 x 18 AWG
- Strand: 41 / 0.16 mm
- Length: 1.00 meters
- Overall Dia.: 7.80 mm
- Rated 10 amps/125V
- Color: black

- Cord type: HO5VV-F3G1.0
- Conductor: 3 x 1.00 mm²
- Strand: 32 / 0.20 mm
- Length: 1.00 meter
- Overall Dia.: 7.10 mm
- Rated 10 amps/250 volts
- Color: black

- Cord type: SJT
- Conductor: 3 x 18 AWG
- Strand: 41 / 0.16 mm
- Length: 10 feet
- Overall Dia.: 7.80 mm
- Rated 10 amps/125, 250 volts; 15A/125 volts
- Color: clear

Order Numbers

4300.0906

4300.0907 (acc. to EANSW)
4300.0908 (acc. to QEC)

4300.0909

4300.0910

4300.0920

Cordsets

Miniature, Low Current (2.5A/250V)

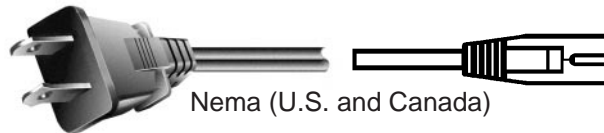
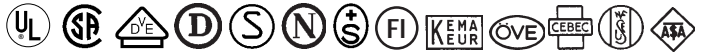

Ordering example for cordsets:

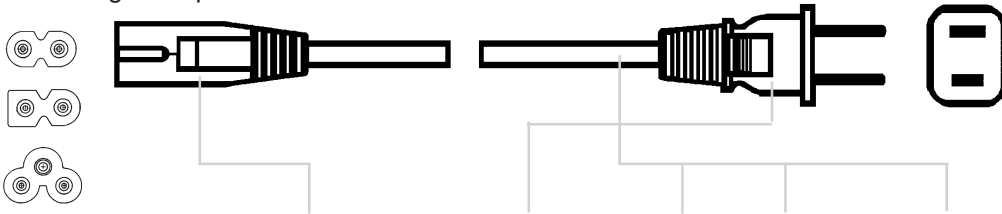

For CMF low current inlet / switch, see page 31

Order Numbers

Cordset	Equipment End	Destination End	Cordage	Color	Length of Cable (standard) *	Rated Current	Approvals
CS01.0221.150	C7 plug (non-polarized) mates to C8 connector	Nema 1-15P	standard SPT2	Black	1500mm	7A/125V	UL #E55943SP CSA #LR035162
CS02.0221.150	C7 plug (polarized) mates to C8 connector	Nema 1-15P	standard AWG18	Black	1500mm	2.5A/250V	UL #E55943SP, CSA #LR035162 (destination end)
CS01.0121.150	C7 plug (non-polarized) mates to C8 connector	Europlug CEE 7/16	H03VVH2-F	Black	1500mm	2.5A/250V	VDE, SEV, Semko, KEMA, NEMKO, OVE, CEBC, DEMKO, SETI, UTE, IMQ
CS01.0421.150	C7 plug (non-polarized) mates to C8 connector	United Kingdom BS 1363	H03VVH2-F	Black	1500mm	2.5A/250V	ASTA (United Kingdom)
CS03.0421.150	C5 plug (polarized) mates to connector C6	United Kingdom BS 1363	H03VV-F	Black	1500mm	2.5A/250V	ASTA (United Kingdom)
CS03.0521.150	C5 plug (polarized) mates to connector C6	Schuko Plug CEE 7/7	H03VV-F	Black	1500mm	2.5A/250V	VDE, Semko, NEMKO, OVE, CEBC, SETI, UTE, KEMA
CS03.0621.150	C5 plug (polarized) mates to connector C6	North America NEMA 5-15P(U.S.)	standard SPT2	Black	1500mm	2.5A/250V	UL, CSA

*Other cable lengths available. Contact Schurter, Inc. for minimums and lead-times.

PLUG MATES 4300

Rewireable - North America **Replaced by 4795/4796**



4300.0922 replaced by 4796.0000

NEW

20 Amp

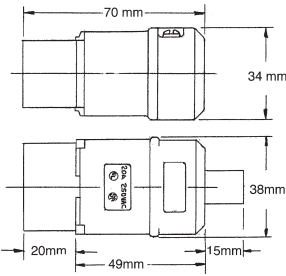

4300.0922 (mates with C19 outlet)

- For "cold" connections 70°C, Protection Class I
- AC inlet plug for high currents, with straight cable entry
- For North American cordage 16/3 SJ to 12/3 SJ (.325 to .475" dia.), or International (HAR Cord) 3x1.5mm² to 3x2.5mm² (8 to 12mm dia.)
- Disassemble plug for cable connection
- Housing: thermoplastic; prongs and terminals: brass
- For mating ac outlet see 6653, page 18

UL listing	20A/250V	File # E96454
CSA certification	20A/250V	File #LR702825
TUV	pending	



4300.0921 replaced by 4795.0000

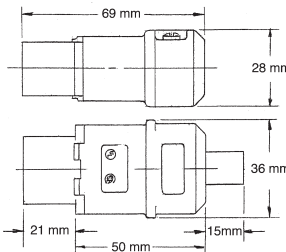

4300.0921 (mates with C20 inlet)

- For "cold" connections 65°C, Protection Class I
- AC outlet plug for high currents, with straight cable entry
- For North American cordage 16/3 SJ to 12/3 SJ (.275 to .475" dia.), or International (HAR Cord) 3x1.5mm² to 3x2.5mm² (8 to 12mm dia.)
- Disassemble plug for cable connection
- Housing: thermoplastic; prongs and terminals: brass
- For mating ac inlet/filter see C20F, page 53
- For mating ac inlet see 6153, page 18

UL listing	20A/250V	File # E96454
CSA certification	20A/250V	File #LR702825
TUV	pending	



Standards: IEC 320/C19 (outlet), /C20 (inlet)

CORDSETS



NEW

20 Amp



0888.0220/0222

NEW

Medical

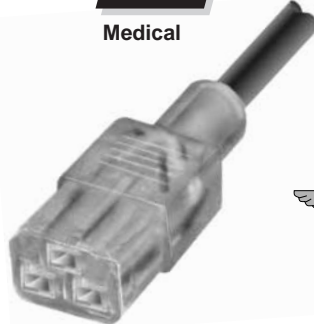

0888.0221

- PVC plastic molding, SJT cordage
- Medical caution labels available on request
- For mating ac inlet/filter see C20F, page 53.
- For mating ac inlet see 6153, page 18

0888.0220 (mates with C20 inlet)

- North American cordset, with Nema 5-15P plug end
 - SJT cordage (3x14 AWG), black, 8 foot length
- | | | |
|-------------------|------------|---|
| UL listing | 15A/125V * | File #E191239 |
| CSA certification | 15A/125V * | File #LR702497 * Nema 5-15P max. rating |



0888.0221 Medical Grade (mates with C20 inlet)

- Medical grade, North American cordset with Nema 5-15P plug end
 - SJT cordage (3x14 AWG), grey cord, 10 foot length
 - Transparent connector and plug ends, with "green dot" marking
- | | | |
|-------------------|------------|--|
| UL listing | 15A/125V * | File #E147323 |
| CSA certification | 15A/125V * | File #LR77840 * Nema 5-15P max. rating |

0888.0222 (mates with C20 inlet)

- North American cordset, with Nema 6-20P plug end
 - SJT cordage (3x12 AWG), black, 8' 2" length
- c-UL listing, 20A/ 250V, File #E147323



Standards: IEC 320/C19 (outlet end)



Standards: Nema 5-15P (plug end)



Standards: Nema 6-20P (plug end)

CORD RETAINING CLAMP

prevents loosening or accidental removal of plug



NEW

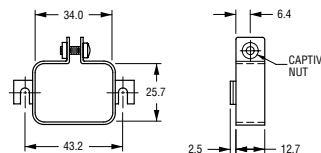

0888.0019

For rewireable plug mate 4300.0921

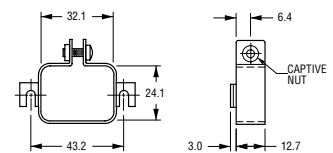

0888.0020

For cordsets shown above