

20 STERN AVE.  
 SPRINGFIELD, NEW JERSEY 07081  
 U.S.A.

TELEPHONE: (973) 376-2922  
 (212) 227-6000  
 • FAX: (973) 376-8960

PARAMETERS

1N990A  
 REF/REG DIODE, 250MW (P(D) ≤ 400MW

Description: Ref/Reg Diode, 250mW (P(D) ≤ 400mW

Manufacturer.....  
 Mil/High-Rel? (Y/N).....  
 Nom. Ref. Volt..... 160  
 Test Current..... 800u  
 Tol. (%)..... 10  
 PD Max. (W)..... 400m  
 Dyn. Zmax (j)..... 1.7k  
 Temp Coef pp/10k.....  
 Oper. Temp (xC) Max..... 175  
 Pkg Style..... DO-204AA  
 Surface Mounted (Y/N)..... N

**DO77**

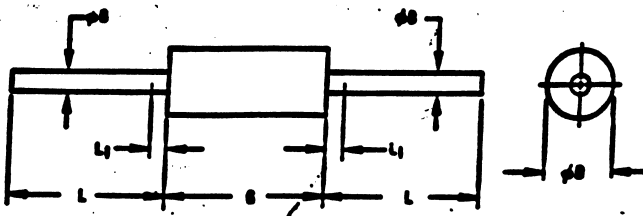

MILLIMETER DIMENSIONS ARE DERIVED FROM ORIGINAL INCH DIMENSIONS

SYMBOL	INCHES		MILLIMETERS		NOTES
	MIN.	MAX.	MIN.	MAX.	
ØD	.018	.022	0.458	0.558	-
ØD	.005	.107	2.16	2.71	1
G	.238	.300	5.85	7.62	1
L	1.000	-	25.40	-	-
L1	-	.050	-	1.27	2

NOTES:

1. PACKAGE CONTOUR OPTIONAL WITHIN CYLINDER OF DIAMETER ØD AND LENGTH G. SLUGS, IF ANY, SHALL BE INCLUDED WITHIN THIS CYLINDER BUT SHALL NOT BE SUBJECT TO THE MINIMUM LIMIT OF ØD.
2. LEAD DIAMETER NOT CONTROLLED IN THIS ZONE TO ALLOW FOR FLASH, LEAD FINISH BUILD-UP, AND MINOR IRREGULARITIES OTHER THAN SLUGS.

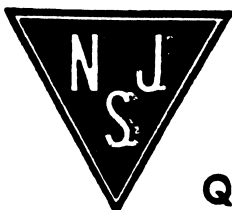

Quality Semi-Conductors