



Copyright FCI.

REQUIREMENTS

Technical characteristics:

Shell: steel tin/Zinc Cr3 plated
 Insulators: self-extinguishing thermoplastic, ULClass94V0
 Contacts size 20, brass, gold on mating end, bright tin on termination end over nickel on entire contact
 Cycles :500 for plating 6
 Cycles :200 for plating 4
 Nuts: brass, tin/Zinc Cr3 plated

Electrical characteristics:

max. current rating: 5A
 Test voltage: 1000V
 Rated voltage: 300V
 Contact resistance: $\leq 15\text{m}\Omega$
 Shell resistance: $\leq 5\text{m}\Omega$
 Insulation resistance: $> 5000\text{M}\Omega$

Climatic characteristics:

Operating temperature range: -55°C +125°C

Dimensions:

in accordance with MIL-C-24308

| SHELL | A ± 0.38 | B ± 0.12 | E ± 0.10 | D ± 0.25 | 0.07 | G ± 0.25 | PART NUMBER |
|-------|--------------|--------------|--------------|--------------|-------|--------------|----------------|
| 09 | 30.81 | 24.99 | 16.96 | 16.79 | 10.96 | 5.90 | D09P13A*PX00** |
| 15 | 39.14 | 33.32 | 25.18 | 25.12 | 19.18 | 5.90 | D15P13A*PX00** |
| 25 | 53.03 | 47.04 | 39.12 | 38.84 | 33.12 | 5.70 | D25P13A*PX00** |
| 37 | 69.32 | 63.50 | 55.68 | 55.30 | 49.68 | 5.70 | D37P13A*PX00** |

Part Number & Date Code Printing

$\phi 3.10 \pm 0.1$

LF FOR LEAD FREE

Plating: 4 --> flash AU
 Plating: 6 --> 0.76 μ AU

FOR ROHS DETAILS REFER DWG. NO: C01-8646-0000

European Views

| rev | ecn no | dr | date |
|-----|----------|----|------------|
| C | 105-0124 | JS | 2005/07/27 |
| D | 106-0074 | SK | 2006/06/08 |
| - | - | - | - |
| - | - | - | - |
| - | - | - | - |
| - | - | - | - |

| | | | | | |
|---|-------------|-----------------------|-----------------------------------|-------------------------|--------------|
| www.fciconnect.com | | surface ISO 1302 ✓ | tolerance std ISO 406 ISO 1101 | projection | mm |
| TOLERANCES UNLESS OTHERWISE SPECIFIED | | | | | |
| Dr | JOHN SLEEBA | 1994/08/02 | ANGULAR | 0.X | ± 0.1 |
| Eng | GEORGE VJ | 1994/08/02 | LINEAR | 0.XX | ± 0.1 |
| Chr | GEORGE VJ | 2005/07/27 | 0.XX* $\pm 1^*$ | 0.XXX | ± 0.1 |
| Appr | KVSD | 2005/07/27 | Product family | | D-SUB |
| title MALE CONNECT.DELTA D RIGHT ANGLED WITH NUTS | | | | dwg no C01-8646-0284 | Rev. D |
| catalog no DELTA-D | | | | CUSTOMER | sheet 1 of 1 |

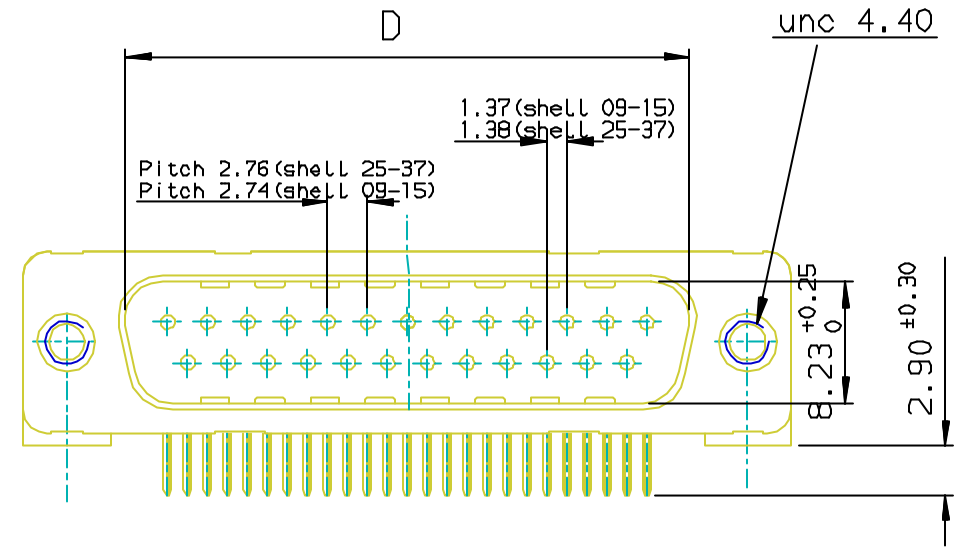
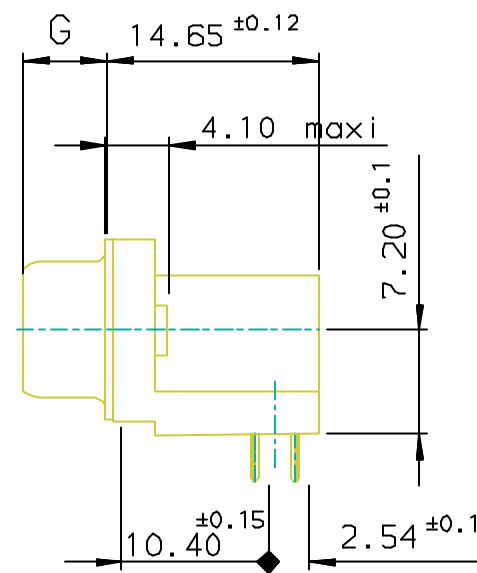
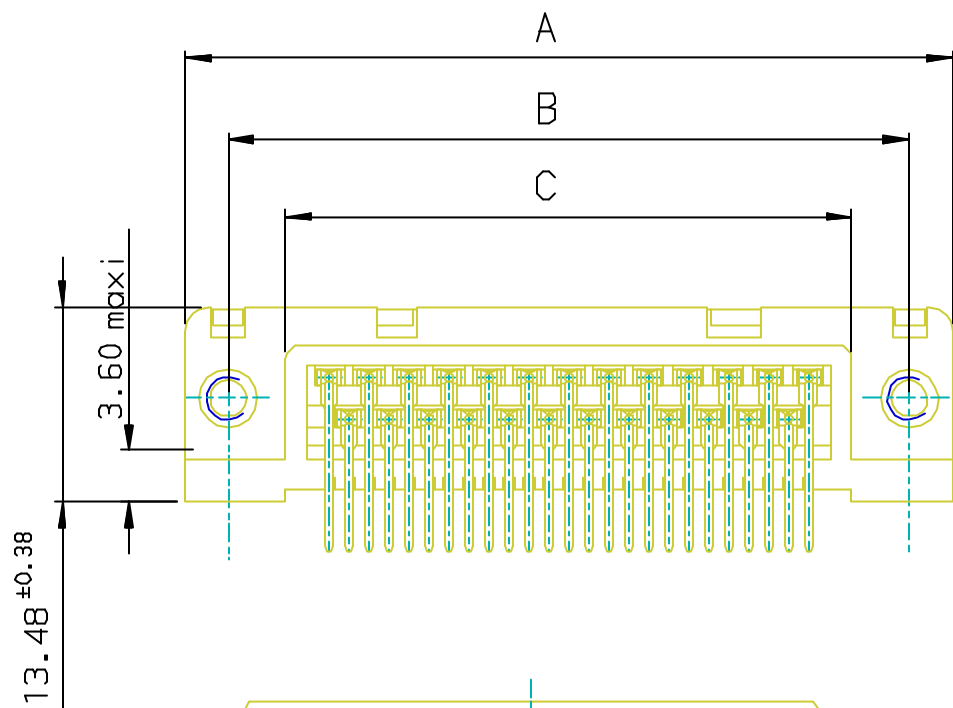

PC card drilling dimensions(after plating)
 (thickness 1.60±0.20mm)

