

TITLE

TRANSFORMER,



1000 PARKERS LAKE ROAD
WAYZATA, MN 55391
(952) 475-1173

AGENCY APPROVAL:

N/A

PART NUMBER

37509

REV A

PAGE 1 END

SPECIFICATIONS

Designed to meet UL 1950/IEC-950 Requirements
WORKING VOLTAGE 250 VRMS,SUPPLEMENTARY INSULATION

- INDUCTANCE: @ 0.1 VRMS, 10 kHz
10-7-9-6 = 418 TO 462 μH (440± 5%)
 - LEAKAGE INDUCTANCE: @ 0.1 VRMS, 100 kHz
10-7-9-6(1-4-2-5 SHORTED) = 10 μH MAX
 - TURNS RATIO: 10-7 : 9-6 : 1-4 : 2-5 = 2 : 2 : 1 : 1 ± 1%
 - DC RESISTANCE: OHMS MAX
1-4 = 0.44 2-5 = 0.44
10-7 = 0.86 9-6 = 0.99
 - DIELECTRIC STRENGTH: 1500 VAC ,1 minute
(1875 Vdc 1 second minimum automatic test
2 second minimum manual test)
10-7-9-6 to 1-4-2-5 & All windings to core
- TESTS 6 - 10 $R_s = 100$ OHMS, $R_L = 25$ OHMS
 LINE = 10-7-9-6 CHIP = 1-2-3-4
- LONGITUDINAL BALANCE: @ 30 kHz to 1.1 MHz
V 1 = 0dBm, Ground = 5
V 2 = 50dB MIN
 - FREQUENCY RESPONSE: 100 kHz TO 1.1 MHz = ± 0.5 db
 - RETURN LOSS: >13 dB @ 120 kHz
 > 9 dB @ 1.1 MHz
 - INSERTION LOSS: 1.0 dB MAX @ 772 kHz,
 - HARMONIC DISTORTION: V1 = 12 Vp-p (4.3 VRMS)
V2 = -80dB MAX @ 30kHz
V2 = -90dB MAX @ 100kHz

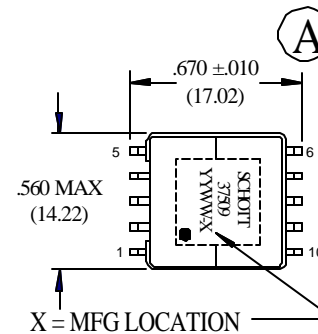

REF. PWB LAYOUT

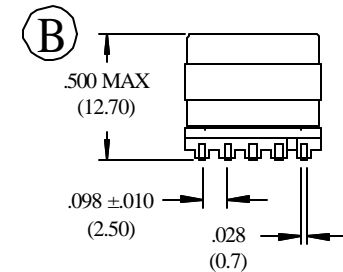
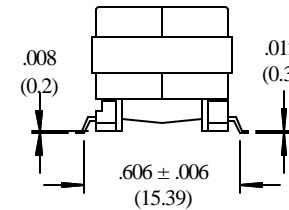
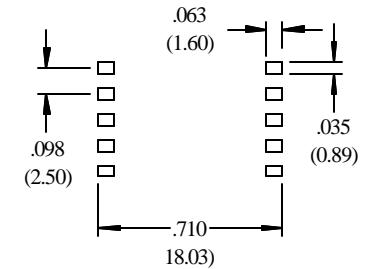

NOTE:
COPLANARITY < .004 (0.10)

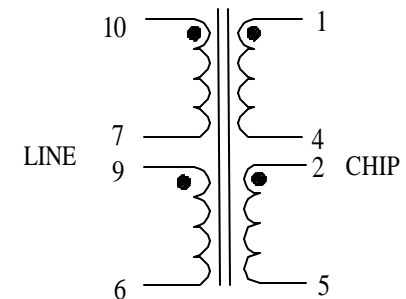

inch
(mm)

TOLERANCES UNLESS OTHERWISE NOTED	2 PLACE	3 PLACE	ANGLE
	± .02	.005	± °