

PART NO.	CURRENT RATING	BODY COLOR	RATED VOLTAGE
0293525.MXJ	25 A	LIGHT BROWN	32 V
0293530.MXJ	30 A	LIGHT GREEN	32 V

ELECTRICAL CHARACTERISTICS TEST

% OF RATED CURRENT	CLEARING TIME 25A - 30A	
	MIN.	MAX.
110 %	-	-
150 %	-	-
200 %	5 SEC.	70 SEC.
300 %	-	6 SEC.
400 %	-	3 SEC.

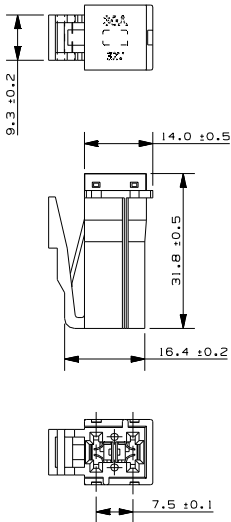
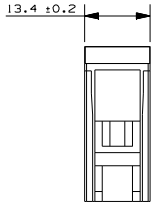

METRIC
ASSEMBLY

PART NO.	CURRENT RATING	BODY COLOR	RATED VOLTAGE
0293545.MXJ	45 A	RED	32 V
0293565.MXJ	65 A	BLACK	32 V
0293575.MXJ	75 A	GRAY	32 V

ELECTRICAL CHARACTERISTICS TEST

% OF RATED CURRENT	CLEARING TIME 45A - 75A	
	MIN.	MAX.
110 %	14,400 SEC.	-
150 %	100 SEC.	-
200 %	2 SEC.	60 SEC.
300 %	-	5 SEC.
400 %	-	2 SEC.

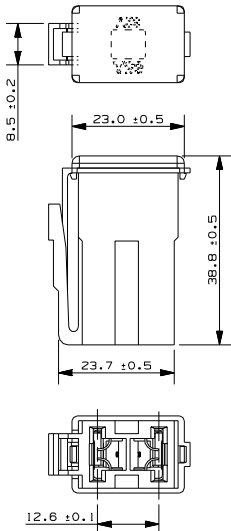
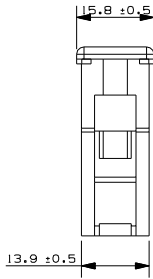

NO	COMPONENT NO	DESCRIPTION	QTY/M	U/M
BILL OF MATERIAL				
UNLESS OTHERWISE SPECIFIED, DIMENSIONS ARE IN MILLIMETERS. DIMENSIONS IN BRACKETS [] ARE INCHES UNLESS OTHERWISE SPECIFIED, DIMENSIONS DO NOT INCLUDE PLATING.				
©	DENOTES CRITICAL CHARACTERISTICS.			
CPK	DENOTES CPK DIMENSIONS. -MINIMUM CPK VALUE			
(ST)	DENOTES A CHARACTERISTIC THAT PROVIDES AN INDICATION OF PROCESS PERFORMANCE. PROCEDURE FOR MEASUREMENT AND TRACKING TO BE DEFINED IN LITTELFUSE INSPECTION INSTRUCTIONS			
CP	DENOTES CP DIMENSIONS. -MINIMUM CP VALUE MUST BE WITHIN THE DIMENSIONAL LIMITATIONS SHOWN ON DRAWING AND INITIALLY LOCATED TO ALLOW FOR MAXIMUM TOOL LIFE			

COPIES TO		MATERIAL SPEC	
1	9	FINISH	1:1
2	10	SCALE	1:1
3	11	DATE	08/13/10
4	12	DRW	RLD
5	13	CHK	SUPER DR
6	14	DATE	
7	15	APPD	FINISH GOOD WT
8	16		GRAMS/PIECE
9	17		
18	18		

LTR	DATE	REVISION	CHK	APD
A	8/13/10	ERN NO. 500618 INITIAL RELEASE	RLD	

TOLERANCES UNLESS OTHERWISE SPECIFIED (REF. ISO 2768-PM)	0.5 - 1.0	1.0 - 3.0	3.0 - 5.0	5.0 - 12.0	12.0 - 40.0
DIMENSION	±0.10	±0.15	±0.20	±0.25	±0.30
ANGLE	±0.10	±0.15	±0.20	±0.25	±0.30
PROJECTION	±0.10	±0.15	±0.20	±0.25	±0.30

TITLE: FUSE - PAL 293 ATP 32V
SLOW BLOW

REVISION DRWG. NO. 0293500.MXJ
SERIES A

LITTELFUSE
LIPA CITY, BATANGAS, PHILIPPINES