

**PLEASE CHECK WWW.MOLEX.COM FOR LATEST PART INFORMATION**

**Part Number:** [0009626125](#)  
**Status:** **Active**  
**Description:** 3.96mm (.156") Pitch KK® PC Board Connector, Top Entry, Nylon Connector, 5.0µm (200µ") Tin (Sn), 12 Circuits

**Documents:**

[3D Model](#) [Product Specification PS-08-50 \(PDF\)](#)  
[Drawing \(PDF\)](#) [RoHS Certificate of Compliance \(PDF\)](#)

**Agency Certification**

UL E29179

**General**

Product Family PCB Receptacles  
 Series [2145](#)  
 Application Board-to-Board  
 Product Name KK®

**Physical**

Circuits (Loaded) 12  
 Color - Resin Natural  
 Flammability 94V-2  
 Glow-Wire Compliant No  
 Keying to Mating Part Yes  
 Lock to Mating Part Yes  
 Material - Metal Phosphor Bronze  
 Material - Plating Mating Tin  
 Material - Plating Termination Tin  
 Material - Resin Nylon  
 Number of Rows 1  
 Orientation Vertical  
 PC Tail Length (in) 0.120 In  
 PC Tail Length (mm) 3.05 mm  
 PCB Locator No  
 PCB Retention None  
 PCB Thickness Recommended (in) 0.062 In  
 PCB Thickness Recommended (mm) 1.60 mm  
 Packaging Type Bag  
 Pitch - Mating Interface (in) 0.156 In  
 Pitch - Mating Interface (mm) 3.96 mm  
 Plating min: Mating (µin) 200  
 Plating min: Mating (µm) 5  
 Plating min: Termination (µin) 200  
 Plating min: Termination (µm) 5  
 Polarized to PCB No  
 Temperature Range - Operating 0°C to +75°C  
 Termination Interface: Style Through Hole

**Electrical**

Current - Maximum per Contact 5A  
 Voltage - Maximum 250V

**Solder Process Data**

Duration at Max. Process Temperature (seconds) 5  
 Lead-free Process Capability Wave Capable (TH only)  
 Max. Cycles at Max. Process Temperature 1  
 Process Temperature max. C 235

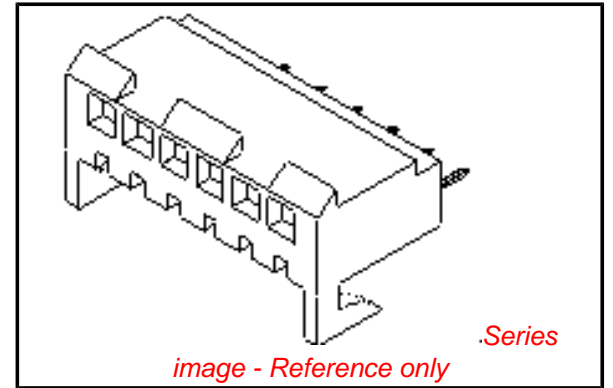

**EU RoHS**

**ELV and RoHS Compliant**  
**REACH SVHC Contains SVHC: No**  
**Halogen-Free Status**

**China RoHS**



**Not Reviewed**

**Need more information on product environmental compliance?**

Email [productcompliance@molex.com](mailto:productcompliance@molex.com)  
 For a multiple part number RoHS Certificate of Compliance, [click here](#)

Please visit the [Contact Us](#) section for any non-product compliance questions.

**Search Parts in this Series**  
[2145Series](#)

**Material Info**

Old Part Number

A-2145-CA12B-102

**Reference - Drawing Numbers**

Product Specification

PS-08-50

Sales Drawing

SDA-2145-002

This document was generated on 04/14/2010

**PLEASE CHECK [WWW.MOLEX.COM](http://WWW.MOLEX.COM) FOR LATEST PART INFORMATION**

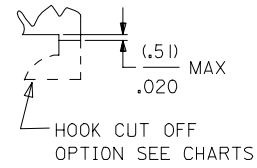
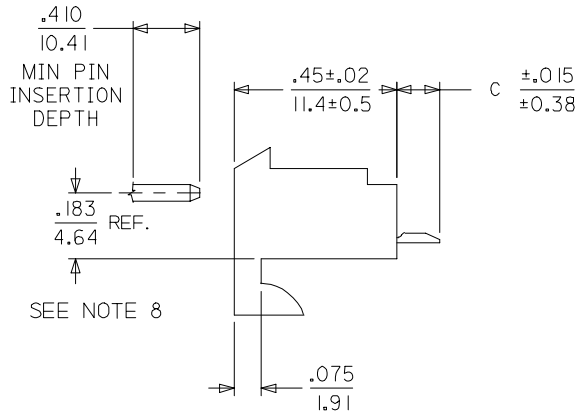

- NOTES:
- HOUSING MATERIAL: NYLON, UL 94V-2
  - FINISH:
    - (909) = OVERALL HOT TIN DIP: .000100/0.00254 MIN.
    - (501) = OVERALL GOLD: .000020/0.00051 MIN.
    - OVERALL NICKLE UNDERPLATE: .000030/0.00076 MIN.
    - (102) = OVERALL TIN: .000200/0.00508 MIN.
    - OVERALL COPPER UNDERPLATE: .000100/0.00254 MIN.
    - (208) = SELECT GOLD: .000015/0.00038 MIN.
    - SELECT TIN: .000100/0.00254 MIN.
    - OVERALL NICKEL UNDERPLATE: .000050/0.00127 MIN.
  - PRODUCT SPECIFICATION: PS-08-50
  - PACKAGING INFO: SEE CHARTS
  - SOLDERABILITY SPECIFICATION: SMES-152
  - RIGHT ANGLE OPTIONS SEE DRAWING SDA-2145-001
  - BOTTOM ENTRY OPTIONS SEE DRAWING SDA-2145-003
  - .183/4.64 DIMENSION IS BOTTOM OF HOUSING TO CENTER OF MATING PIN AND DOES NOT REFLECT CENTER OF CONNECTOR HOUSING WINDOW DIMENSION.
  - THIS PART CONFORMS TO CLASS B REQUIREMENTS OF COSMETIC SPECIFICATION PS-45499-002.

| CKT | A     |       | B          |            |
|-----|-------|-------|------------|------------|
|     |       |       |            |            |
| 02  | .308  | 7.82  | .156±.005  | 3.96±0.13  |
| 03  | .464  | 11.79 | .312±.005  | 7.92±0.13  |
| 04  | .620  | 15.75 | .468±.005  | 11.89±0.13 |
| 05  | .776  | 19.71 | .624±.005  | 15.85±0.13 |
| 06  | .932  | 23.67 | .780±.005  | 19.81±0.13 |
| 07  | 1.088 | 27.64 | .936±.010  | 23.77±0.25 |
| 08  | 1.244 | 31.60 | 1.092±.010 | 27.74±0.25 |
| 09  | 1.400 | 35.56 | 1.248±.010 | 31.70±0.25 |
| 10  | 1.556 | 39.52 | 1.404±.010 | 35.66±0.25 |
| 11  | 1.712 | 43.48 | 1.560±.010 | 39.62±0.25 |
| 12  | 1.868 | 47.45 | 1.716±.010 | 43.59±0.25 |
| 13  | 2.024 | 51.41 | 1.872±.010 | 47.55±0.25 |
| 14  | 2.180 | 55.37 | 2.028±.014 | 51.51±0.36 |
| 15  | 2.336 | 59.33 | 2.184±.014 | 55.47±0.36 |

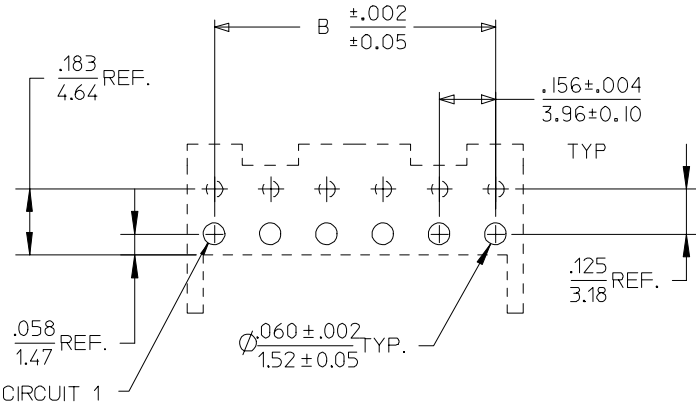

PCB LAYOUT: COMPONENT SIDE  
RECOMMENDED PCB THICKNESS: .062/1.57

|      |      |
|------|------|
| 2-4  | Y1   |
| 1    | Y4   |
| SHT. | REV. |

|  |                    |   |  |   |  |                     |           |                   |                        |
|--|--------------------|---|--|---|--|---------------------|-----------|-------------------|------------------------|
| UPDATE PCB VIEW<br>EC NO: UCP2007-2776<br>DRWN:PRIDDER 2007/05/02<br>CHKD:ADERR 2007/05/03<br>APPR:FSMITH 2007/05/07<br>Y4 | DESCRIPTION<br>REV | QUALITY SYMBOLS<br>▽=0<br>▽=0   | GENERAL TOLERANCES (UNLESS SPECIFIED)                |   | DIMENSION STYLE IN/MM                                |                     | SCALE --- | DESIGN UNITS INCH | THIRD ANGLE PROJECTION |
|  |                    | 4 PLACES ± --- ± ---<br>3 PLACES ± --- ±.010<br>2 PLACES ±0.25 ±.014<br>1 PLACE ±0.36 ± --- | mm INCH  | DRAWN BY DATE<br>SAMIEC 2003/01/16      | TITLE<br>KK 156 HOUSING ASSY<br>PC TAIL<br>TOP ENTRY |                     |           |                   |                        |
|  |                    | ANGULAR ±1/2°   | DRAFT WHERE APPLICABLE MUST REMAIN WITHIN DIMENSIONS | CHECKED BY DATE<br>SAMIEC 2003/01/16    | MOLEX MOLEX INCORPORATED                             |                     |           |                   |                        |
|  |                    | MATERIAL NO.<br>SEE CHART   | SIZE A   | APPROVED BY DATE<br>MARGULIS 2003/01/16 | DOCUMENT NO.<br>SDA-2145-002                         | SHEET NO.<br>1 OF 4 |           |                   |                        |



# KK 156 PCB ASSY 2-15 CKT

## 2145 TOP ENTRY SERIES

CATALOG PRODUCTS

|                |              |                     |              |                     |
|----------------|--------------|---------------------|--------------|---------------------|
| <b>OPTIONS</b> | RAMPS        | YES                 | RAMPS        | YES                 |
|                | HOOKS:       | YES                 | HOOKS:       | YES                 |
|                | COLOR:       | WHITE               | COLOR:       | WHITE               |
|                | MOLD VOID:   | NONE                | MOLD VOID:   | NONE                |
|                | TERM MATL:   | PHOS BRONZE         | TERM MATL:   | PHOS BRONZE         |
|                | CONTACT:     | STANDARD            | CONTACT:     | STANDARD            |
|                | PC TAIL (C): | .120 / 3.05         | PC TAIL (C): | .120 / 3.05         |
|                | PLT CODE:    | 102 – TIN           | PLT CODE:    | 208 – 15 GOLD       |
|                | TERM VOID:   | NONE                | TERM VOID:   | NONE                |
|                | PACKAGING:   | TRAY<br>PK-2145-001 | PACKAGING:   | TRAY<br>PK-2145-001 |
|                |              |                     |              |                     |
| <b>Ckt</b>     | Material No  |                     | Material No  |                     |
| 2              | 09-62-6025   |                     | 09-62-4029   |                     |
| 3              | 09-62-6035   |                     | 09-62-4039   |                     |
| 4              | 09-62-6045   |                     | 09-62-4049   |                     |
| 5              | 09-62-6055   |                     | 09-62-4059   |                     |
| 6              | 09-62-6065   |                     | 09-62-4069   |                     |
| 7              | 09-62-6075   |                     | 09-62-4079   |                     |
| 8              | 09-62-6085   |                     | 09-62-4089   |                     |
| 9              | 09-62-6095   |                     | 09-62-4099   |                     |
| 10             | 09-62-6105   |                     | 09-62-4109   |                     |
| 11             | 09-62-6115   |                     | 09-62-4119   |                     |
| 12             | 09-62-6125   |                     | 09-62-4129   |                     |
| 13             | 09-62-6135   |                     | 09-62-4139   |                     |
| 14             | 09-62-6145   |                     | 09-62-4149   |                     |
| 15             | 09-62-6155   |                     | 09-62-4159   |                     |

|  |  |   |                                      |
|--|--|---|--------------------------------------|
| <b>REV:</b><br><br><b>Y1</b>                   | <b>ADDA-2145-FANA501</b><br><b>UCP2005-0149</b><br><b>7/20/2004 SCHAFFER</b> | <b>TITLE:</b><br><br><b>KK 156 PCB ASSY</b><br><b>2145 TOP ENTRY SERIES</b> | <b>SHEET No.</b><br><br><b>- 2 -</b> |
| <b>DOCUMENT NUMBER:</b><br><b>SDA-2145-002</b> |  | <b>CREATED / REVISED BY:</b><br><b>SAMIEC</b>                               | <b>CHECKED BY:</b><br><b>SAMIEC</b>  |
|  |  | <b>APPROVED BY:</b><br><b>MARGULIS</b>                                      |                                      |



# KK 156 PCB ASSY 2-15 CKT

## 2145 TOP ENTRY SERIES

CUSTOM PRODUCTS

| OPTIONS | RAMPS        | YES                 | RAMPS        | YES                 | RAMPS        | YES                 | RAMPS        | YES                 |
|---------|--------------|---------------------|--------------|---------------------|--------------|---------------------|--------------|---------------------|
|         | HOOKS:       | YES                 | HOOKS:       | YES                 | HOOKS:       | CUT OFF             | HOOKS:       | YES                 |
|         | COLOR:       | WHITE               | COLOR:       | WHITE               | COLOR:       | WHITE               | COLOR:       | WHITE               |
|         | MOLD VOID:   | NONE                | MOLD VOID:   | NONE                | MOLD VOID:   | NONE                | MOLD VOID:   | NONE                |
|         | TERM MATL:   | BRASS               | TERM MATL:   | BRASS               | TERM MATL:   | BRASS               | TERM MATL:   | BRASS               |
|         | CONTACT:     | STANDARD            | CONTACT:     | STANDARD            | CONTACT:     | STANDARD            | CONTACT:     | STANDARD            |
|         | PC TAIL (C): | .120 / 3.05         | PC TAIL (C): | .189 / 4.80         | PC TAIL (C): | .120 / 3.05         | PC TAIL (C): | .120 / 3.05         |
|         | PLT CODE:    | 102 – TIN           | PLT CODE:    | P909 – TIN          | PLT CODE:    | P909 – TIN          | PLT CODE:    | P909 – TIN          |
|         | TERM VOID:   | NONE                | TERM VOID:   | NONE                | TERM VOID:   | NONE                | TERM VOID:   | NONE                |
|         | PACKAGING:   | TRAY<br>PK-2145-001 | PACKAGING:   | TRAY<br>PK-2145-001 | PACKAGING:   | TRAY<br>PK-2145-001 | PACKAGING:   | TRAY<br>PK-2145-001 |
| Ckt     | Material No  |                     | Material No  |                     | Material No  |                     | Material No  |                     |
| 2       | 09-52-1023   |                     | 09-52-1029   |                     |              |                     | 09-52-3023   |                     |
| 3       | 09-52-1033   |                     | 09-52-1039   |                     | 09-52-3034   |                     | 09-52-3033   |                     |
| 4       | 09-52-1043   |                     | 09-52-1049   |                     | 09-52-3044   |                     | 09-52-3043   |                     |
| 5       | 09-52-1053   |                     | 09-52-1059   |                     | 09-52-3054   |                     | 09-52-3053   |                     |
| 6       | 09-52-1063   |                     | 09-52-1069   |                     | 09-52-3064   |                     | 09-52-3063   |                     |
| 7       | 09-52-1073   |                     | 09-52-1079   |                     |              |                     | 09-52-3073   |                     |
| 8       | 09-52-1083   |                     | 09-52-1089   |                     | 09-52-3089   |                     | 09-52-3083   |                     |
| 9       | 09-52-1093   |                     | 09-52-1099   |                     | 09-52-3094   |                     | 09-52-3093   |                     |
| 10      | 09-52-1103   |                     | 09-52-1109   |                     |              |                     | 09-52-3103   |                     |
| 11      | 09-52-1113   |                     | 09-52-1119   |                     |              |                     | 09-52-3113   |                     |
| 12      | 09-52-1123   |                     | 09-52-1129   |                     |              |                     | 09-52-3123   |                     |
| 13      | 09-52-1133   |                     | 09-52-1139   |                     |              |                     | 09-52-3133   |                     |
| 14      | 09-52-1143   |                     | 09-52-1149   |                     |              |                     | 09-52-3143   |                     |
| 15      | 09-52-1153   |                     | 09-52-1159   |                     |              |                     | 09-52-3153   |                     |

|                     |   |   |                 |
|---------------------|---|---|-----------------|
| REV:                | <b>ADDA-2145-FANA501</b><br><b>UCP2005-0149</b><br>7/20/2004 SCHAFFER | TITLE:  | SHEET No.       |
| <b>Y1</b>           |   | <h1 style="margin: 0;">KK 156 PCB ASSY</h1> <h2 style="margin: 0;">2145 TOP ENTRY SERIES</h2> | <b>- 3 -</b>    |
| DOCUMENT NUMBER:    | CREATED / REVISED BY:   | CHECKED BY:   | APPROVED BY:    |
| <b>SDA-2145-002</b> | <b>SAMIEC</b>   | <b>SAMIEC</b>   | <b>MARGULIS</b> |



# KK 156 PCB ASSY 2-15 CKT

## 2145 TOP ENTRY SERIES

CUSTOM PRODUCTS

| OPTIONS | RAMPS        | NO                  | RAMPS        | YES                 | RAMPS        | YES                 | RAMPS        | YES                 |
|---------|--------------|---------------------|--------------|---------------------|--------------|---------------------|--------------|---------------------|
|         | HOOKS:       | CUT OFF             | HOOKS:       | YES                 | HOOKS:       | YES                 | HOOKS:       | CUT OFF             |
|         | COLOR:       | WHITE               | COLOR:       | WHITE               | COLOR:       | WHITE               | COLOR:       | WHITE               |
|         | MOLD VOID:   | NONE                | MOLD VOID:   | NONE                | MOLD VOID:   | NONE                | MOLD VOID:   | NONE                |
|         | TERM MATL:   | BRASS               | TERM MATL:   | BRASS               | TERM MATL:   | PHOS BRONZE         | TERM MATL:   | BRASS               |
|         | CONTACT:     | STANDARD            | CONTACT:     | STANDARD            | CONTACT:     | STANDARD            | CONTACT:     | STANDARD            |
|         | PC TAIL (C): | .120 / 3.05         | PC TAIL (C): | .120 / 3.05         | PC TAIL (C): | .120 / 3.05         | PC TAIL (C): | .120 / 3.05         |
|         | PLT CODE:    | P909 – TIN          | PLT CODE:    | 208 – 15 GOLD       | PLT CODE:    | P909 – TIN          | PLT CODE:    | 501-20 GOLD         |
|         | TERM VOID:   | NONE                | TERM VOID:   | NONE                | TERM VOID:   | NONE                | TERM VOID:   | NONE                |
|         | PACKAGING:   | TRAY<br>PK-2145-001 | PACKAGING:   | TRAY<br>PK-2145-001 | PACKAGING:   | TRAY<br>PK-2145-001 | PACKAGING:   | TRAY<br>PK-2145-001 |
| Ckt     | Material No  |                     | Material No  |                     | Material No  |                     | Material No  |                     |
| 2       | 09-52-1025   |                     | 09-62-3023   |                     | 09-52-2029   |                     |              |                     |
| 3       | 09-52-1035   |                     | 09-62-3033   |                     | 09-52-2039   |                     |              |                     |
| 4       | 09-52-1045   |                     | 09-62-3043   |                     | 09-52-2049   |                     |              |                     |
| 5       | 09-52-1055   |                     | 09-62-3053   |                     | 09-52-2059   |                     |              |                     |
| 6       | 09-52-1065   |                     | 09-62-3063   |                     | 09-52-2069   |                     | 50-29-1694   |                     |
| 7       | 09-52-1075   |                     | 09-62-3073   |                     | 09-52-2079   |                     |              |                     |
| 8       | 09-52-1085   |                     | 09-62-3083   |                     | 09-52-2089   |                     |              |                     |
| 9       | 09-52-1095   |                     | 09-62-3093   |                     | 09-52-2099   |                     |              |                     |
| 10      | 09-52-1105   |                     | 09-62-3103   |                     | 09-52-2109   |                     |              |                     |
| 11      | 09-52-1115   |                     | 09-62-3113   |                     | 09-52-2119   |                     |              |                     |
| 12      | 09-52-1125   |                     | 09-62-3123   |                     | 09-52-2129   |                     |              |                     |
| 13      | 09-52-1135   |                     | 09-62-3133   |                     | 09-52-2139   |                     |              |                     |
| 14      | 09-52-1145   |                     | 09-62-3143   |                     | 09-52-2149   |                     |              |                     |
| 15      | 09-52-1155   |                     | 09-62-3153   |                     | 09-52-2159   |                     |              |                     |

|  |  |   |                                      |
|--|--|---|--------------------------------------|
| <b>REV:</b><br><br><b>Y1</b>                   | <b>ADDA-2145-FANA501</b><br><b>UCP2005-0149</b><br><b>7/20/2004 SCHAFFER</b> | <b>TITLE:</b><br><br><b>KK 156 PCB ASSY</b><br><b>2145 TOP ENTRY SERIES</b> | <b>SHEET No.</b><br><br><b>- 4 -</b> |
| <b>DOCUMENT NUMBER:</b><br><b>SDA-2145-002</b> |  | <b>CREATED / REVISED BY:</b><br><b>SAMIEC</b>                               | <b>CHECKED BY:</b><br><b>SAMIEC</b>  |
|  |  | <b>APPROVED BY:</b><br><b>MARGULIS</b>                                      |                                      |