

PLEASE CHECK WWW.MOLEX.COM FOR LATEST PART INFORMATION

Part Number: [0879770051](#)

Status: **Active**

Description: 1.00mm (.039") Pitch Fully Buffered DIMM Socket, Vertical, Press-Fit, 240 Circuits, 1.8V Center Voltage Key, with Plastic Locating Peg and Press-Fit Metal Pins, with Off-White Latches, 0.76µm (30µ") Gold (Au) Plating, Lead-free

Documents:

[3D Model](#)

[Product Specification PS-87977-001 \(PDF\)](#)

[Drawing \(PDF\)](#)

[RoHS Certificate of Compliance \(PDF\)](#)

Agency Certification

CSA LR19980
UL E29179

General

Product Family Memory Module Sockets
Series [87977](#)
Comments Latches in Off-White ColorSolder Tail Length at 3.15mm (.124)
Component Type Memory Module
JEDEC Outline MO-256
Product Name FB DIMM

Physical

Circuits (Loaded) 240
Color - Resin Black, Natural
Durability (mating cycles max) 25
Entry Angle Vertical (Top Entry)
Flammability 94V-0
Keying to Mating Part Yes
Material - Metal Phosphor Bronze
Material - Plating Mating Gold
Material - Plating Termination Tin
Material - Resin High Temperature Thermoplastic
PC Tail Length (in) 0.124 In
PC Tail Length (mm) 3.15 mm
PCB Locator Yes
PCB Retention Yes
PCB Thickness Recommended (in) 0.130 In
PCB Thickness Recommended (mm) 3.30 mm
Packaging Type Tray
Pitch - Mating Interface (in) 0.039 In
Pitch - Mating Interface (mm) 1.00 mm
Plating min: Mating (µin) 30
Plating min: Mating (µm) 0.76
Plating min: Termination (µin) 15.2
Plating min: Termination (µm) 0.38
Temperature Range - Operating -10°C to +85°C
Termination Interface: Style Through Hole - Compliant Pin

Electrical

Current - Maximum per Contact 1A
Voltage - Maximum 30V
Voltage Key 1.8V, Center

Material Info

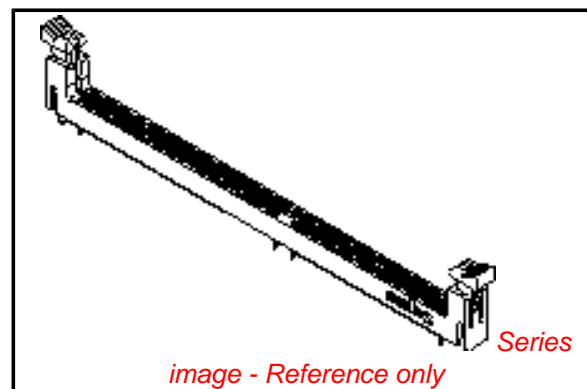

image - Reference only

EU RoHS

ELV and RoHS Compliant
REACH SVHC Contains SVHC: No
Halogen-Free Status

China RoHS



Need more information on product environmental compliance?

Email productcompliance@molex.com
For a multiple part number RoHS Certificate of Compliance, [click here](#)

Please visit the [Contact Us](#) section for any non-product compliance questions.

Search Parts in this Series

[87977Series](#)

Mates With

JEDEC MO-256 modules

Reference - Drawing Numbers

Product Specification
Sales Drawing

PS-87977-001
SD-87977-020

This document was generated on 06/08/2010

PLEASE CHECK WWW.MOLEX.COM FOR LATEST PART INFORMATION

10 9 8 7 6 5 4 3 2 1

F

E

D

C

B

A

F

E

D

C

B

A

NOTES:

1. MATERIALS
 HOUSING - HIGH TEMP. NYLON, GLASS FILLED, UL 94V-0, BLACK
 EJECTOR - HIGH TEMP. NYLON, GLASS FILLED, UL 94V-0, NATURAL
 BASE PLATE - HIGH TEMP. NYLON, GLASS FILLED, UL 94V-0
 TERMINAL - COPPER ALLOY
2. PLATING - SEE TABLE IN SHEET 5.
3. CARD SLOT ACCEPTS 1.27±0.10 MM MODULE THICKNESS.
 (MEASURED OVER P.C. PADS)
4. RECOMMENDED MODULE LAYOUT SHALL BE AS PER JEDEC MO-14-066.
5. REFER TO PRODUCT SPEC. PS-87977-030 FOR PERFORMANCE SPECIFICATIONS.
6. PRODUCT SHALL BE PACKED IN TRAY.
7. PRODUCT SHALL HAVE DATE CODE STAMPED ON SIDE OF HOUSING.
8. PRODUCT IS SUITABLE FOR WAVE SOLDERING ONLY.
9. KEEP OUT AREA IS THE AREA WHERE THE CONNECTOR IS MOUNTED ONTO THE PCB WHICH DOES NOT INCLUDE THE LATCH.
10. REFER TO CRITICAL JEDEC INFORMATION FOR SOCKET OUTLINE PER S0-001.
11. DIMM MODULE SEATING PLANE FROM TOP OF PCB.
12. CONTACT MOLEX FOR AVAILABILITY OF PRODUCT OPTIONS.

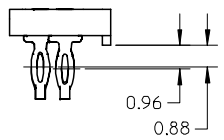
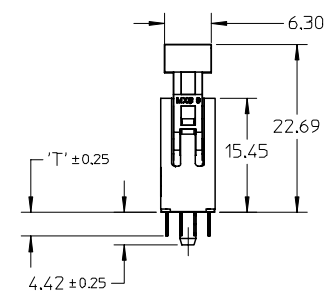
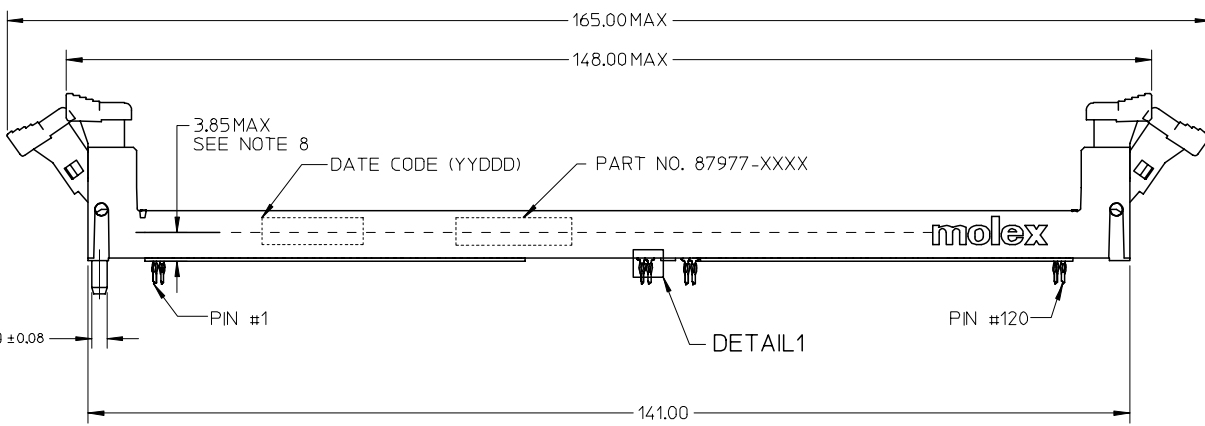
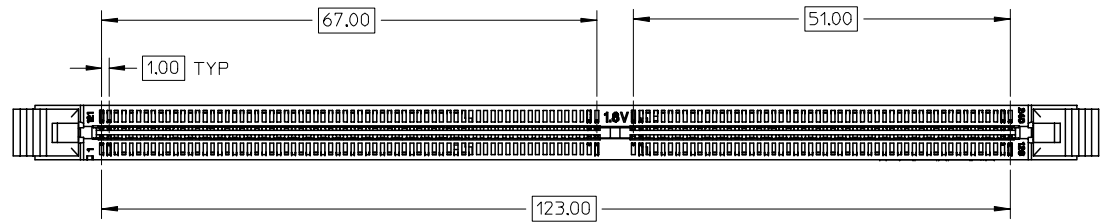

DETAIL 1

EC NO: S2006-0241	2005/09/01	2005/09/01	2005/09/02
DRWN: CCTEH	CHKD: SRRAMESH	APPR: GGLEE	
REV	DESCRIPTION	QUALITY SYMBOLS	
A		▽=0 ∇=0	

GENERAL TOLERANCES (UNLESS SPECIFIED)	
	mm INCH
4 PLACES	± --- ± ---
3 PLACES	± --- ± ---
2 PLACES	± 0.20 ± ---
1 PLACE	± --- ± ---
ANGULAR ± 5 °	
DRAFT WHERE APPLICABLE MUST REMAIN WITHIN DIMENSIONS	

DIMENSION STYLE		SCALE	DESIGN UNITS	THIRD ANGLE PROJECTION
MM ONLY		NTS	METRIC	
DRAWN BY	DATE	TITLE		
CCTEH	2005/01/10	SALES DRAWING		
CHECKED BY	DATE	DDR FB DIMM 1.00MM PITCH		
SRRAMESH	2005/08/30	240 CKTS VERT. PRESS-FIT		
APPROVED BY	DATE	MOLEX INCORPORATED		
GGLEE	2005/08/30			
MATERIAL NO.	DOCUMENT NO.	SHEET NO.		
	SD-87977-020	1 OF 5		
SIZE	THIS DRAWING CONTAINS INFORMATION THAT IS PROPRIETARY TO MOLEX INCORPORATED AND SHOULD NOT BE USED WITHOUT WRITTEN PERMISSION			
A3				

9 8 7 6 5 4 3 2 1

10 9 8 7 6 5 4 3 2 1

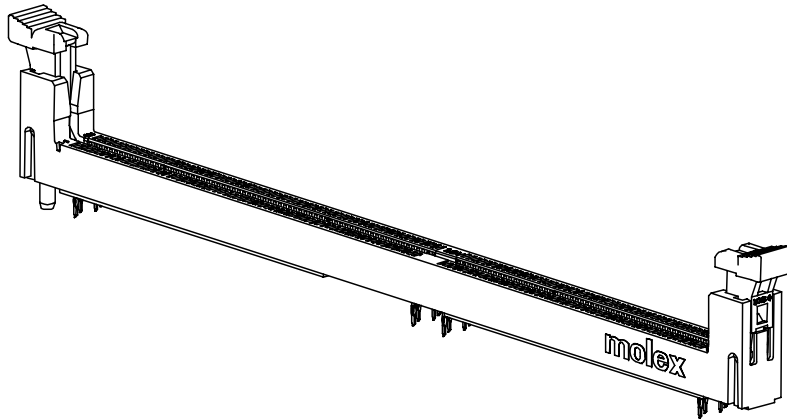
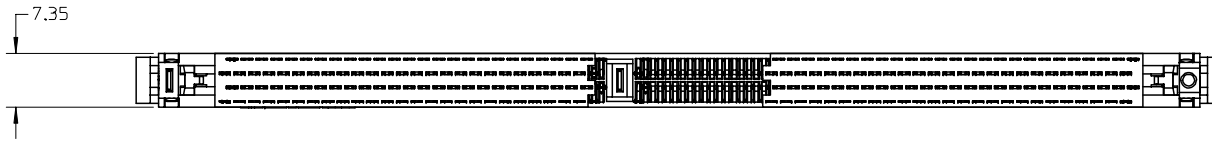

F

E

D

C

B

A

F

E

D

C

B

A

EC NO: S2006-0241 DRWN: CCTEH 2005/09/01 CHKD: SRRAMESH 2005/09/01 APPR: GGLEE 2005/09/02	QUALITY SYMBOLS ▽=0 ▽=0	GENERAL TOLERANCES (UNLESS SPECIFIED)		DIMENSION STYLE MM ONLY		SCALE NTS	DESIGN UNITS METRIC	THIRD ANGLE PROJECTION		
			mm	INCH	DRAWN BY CCTEH	DATE 2005/01/10	TITLE SALES DRAWING DDR FB DIMM 1.00MM PITCH 240 CKTS VERT. PRESS-FIT			
		4 PLACES	± ---	± ---	CHECKED BY SRRAMESH	DATE 2005/08/30				
		3 PLACES	± ---	± ---	APPROVED BY GGLEE		DATE 2005/08/30	MOLEX INCORPORATED		
2 PLACES	± 0.20	± ---	MATERIAL NO.		DOCUMENT NO.	SHEET NO.				
1 PLACE	± ---	± ---	DRAFT WHERE APPLICABLE MUST REMAIN WITHIN DIMENSIONS		SEE TABLE	2 OF 5				
		ANGULAR ± 5 °				THIS DRAWING CONTAINS INFORMATION THAT IS PROPRIETARY TO MOLEX INCORPORATED AND SHOULD NOT BE USED WITHOUT WRITTEN PERMISSION				

9 8 7 6 5 4 3 2 1

RECOMMENDED MODULE LAYOUT
(VARIATION AB, AS PER JEDEC MO-256A)

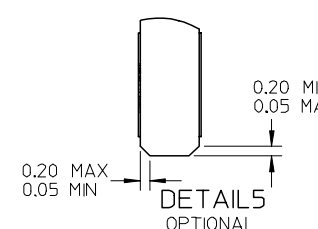
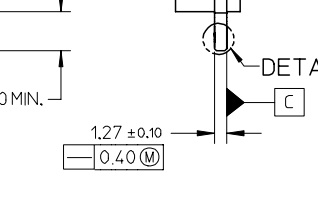
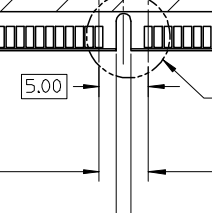
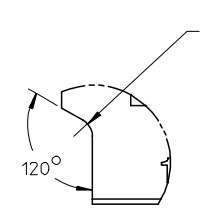
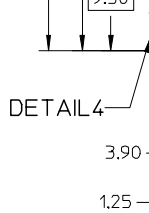
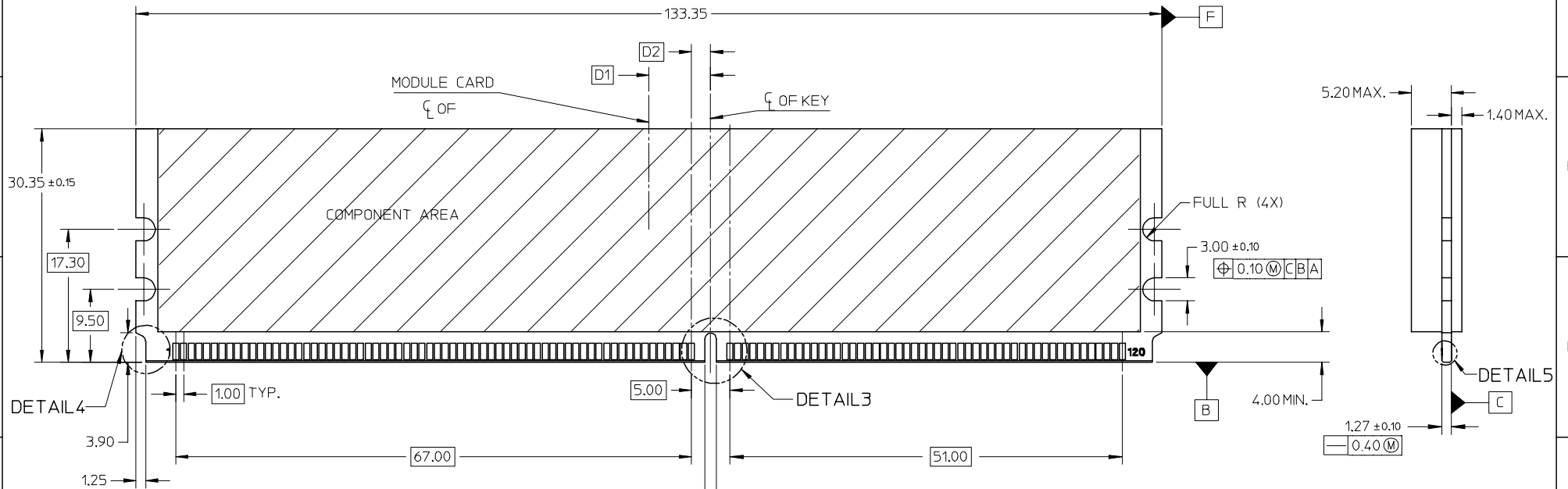

KEY LOCATION	VOLTAGE	DIM 'D2'	DIM 'D1'
CENTER	1.8V	2.50	8.00

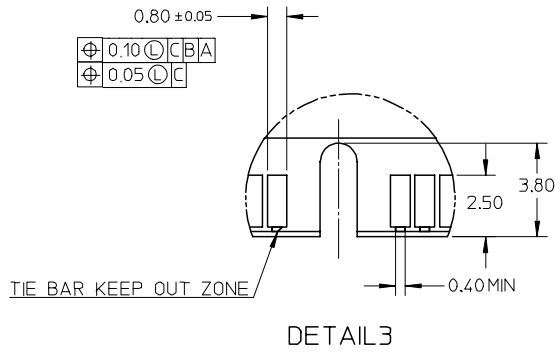

EC NO: S2006-0241	2005/09/01	QUALITY SYMBOLS
DRWN: CTEH	2005/09/01	▽=0
CHKD: SRRAMESH	2005/09/01	▽=0
APPR: GGLEE	2005/09/02	
REV	DESCRIPTION	
A		

GENERAL TOLERANCES (UNLESS SPECIFIED)	
	mm
4 PLACES	± 0.20
3 PLACES	± 0.25
2 PLACES	± 0.30
1 PLACE	± 0.40
ANGULAR ± 5°	
DRAFT WHERE APPLICABLE MUST REMAIN WITHIN DIMENSIONS	

DIMENSION STYLE	
MM ONLY	
DRAWN BY	DATE
CTEH	2005/01/10
CHECKED BY	DATE
SRRAMESH	2005/08/30
APPROVED BY	DATE
GGLEE	2005/08/30
MATERIAL NO.	
SEE TABLE	
SIZE	A3

SCALE	NTS	DESIGN UNITS	METRIC	THIRD ANGLE PROJECTION
SALES DRAWING				
DDR FB DIMM 1.00MM PITCH				
240 CKTS VERT. PRESS-FIT				
MOLEX INCORPORATED				
DOCUMENT NO.			SHEET NO.	
SD-87977-020			3 OF 5	
THIS DRAWING CONTAINS INFORMATION THAT IS PROPRIETARY TO MOLEX INCORPORATED AND SHOULD NOT BE USED WITHOUT WRITTEN PERMISSION				

10 9 8 7 6 5 4 3 2 1

F

F

RECOMMENDED PCB HOLE PATTERN
SEE TABLE IN SHEET 5 FOR
RECOMMENDED PCB THICKNESS

E

E

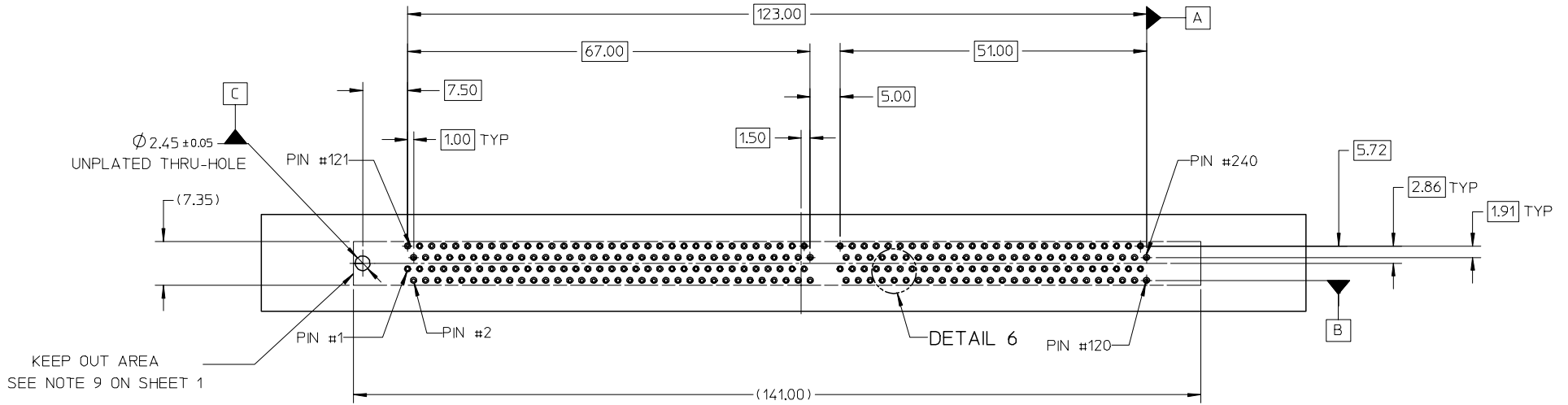

D

D

C

C

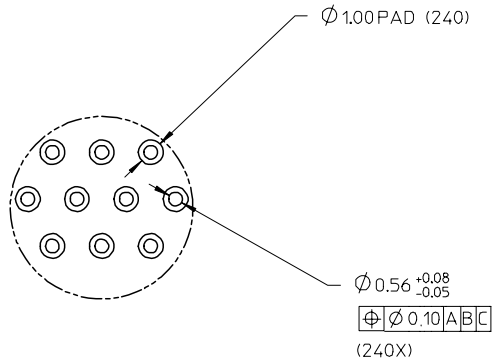

DETAIL 6

B

B

A

A

EC NO: S2006-0241 DRWN: CTEH 2005/09/01 CHKD: SRRAMESH 2005/09/01 APPR: GGLEE 2005/09/02	QUALITY SYMBOLS	GENERAL TOLERANCES (UNLESS SPECIFIED)	DIMENSION STYLE MM ONLY	SCALE NTS	DESIGN UNITS METRIC	THIRD ANGLE PROJECTION															
	$\nabla = 0$ $\nabla C = 0$	<table border="1"> <thead> <tr> <th></th> <th>mm</th> <th>INCH</th> </tr> </thead> <tbody> <tr> <td>4 PLACES</td> <td>± ---</td> <td>± ---</td> </tr> <tr> <td>3 PLACES</td> <td>± ---</td> <td>± ---</td> </tr> <tr> <td>2 PLACES</td> <td>± 0.20</td> <td>± ---</td> </tr> <tr> <td>1 PLACE</td> <td>± ---</td> <td>± ---</td> </tr> </tbody> </table>		mm	INCH	4 PLACES	± ---	± ---	3 PLACES	± ---	± ---	2 PLACES	± 0.20	± ---	1 PLACE	± ---	± ---	DRAWN BY: CTEH DATE: 2005/01/10 CHECKED BY: SRRAMESH DATE: 2005/08/30 APPROVED BY: GGLEE DATE: 2005/08/30	TITLE: SALES DRAWING DDR FB DIMM 1.00MM PITCH 240 CKTS VERT. PRESS-FIT		
		mm	INCH																		
	4 PLACES	± ---	± ---																		
3 PLACES	± ---	± ---																			
2 PLACES	± 0.20	± ---																			
1 PLACE	± ---	± ---																			
	ANGULAR ± 5 °	MATERIAL NO.	MOLEX INCORPORATED DOCUMENT NO. SD-87977-020																		
	DRAFT WHERE APPLICABLE MUST REMAIN WITHIN DIMENSIONS	SIZE A3	SEE TABLE THIS DRAWING CONTAINS INFORMATION THAT IS PROPRIETARY TO MOLEX INCORPORATED AND SHOULD NOT BE USED WITHOUT WRITTEN PERMISSION																		

10 9 8 7 6 5 4 3 2 1

PART NO.	KEY POS.	DIM 'T'	RECOMEMDED PCB THICKNESS	PLATING OPTION	LATCH COLOR
87977-0021	CENTER (1.8V)	3.15	3.30	0.38uM / 15 uIN MIN. GOLD ON CONTACT, 1.52uM/ 60uIN MIN. PURE TIN ON SOLDERTAILS, 1.27uM/ 50uIN MIN. NICKEL UNDERPLATE	NATURAL
87977-0051				0.76uM / 30 uIN MIN. GOLD ON CONTACT, 1.52uM/ 60uIN MIN. PURE TIN ON SOLDERTAILS, 1.27uM/ 50uIN MIN. NICKEL UNDERPLATE	
87977-9001				0.38uM / 15 uIN MIN. GOLD ON CONTACT, 1.52uM/ 60uIN MIN. TIN ON SOLDERTAILS, 1.27uM/ 50uIN MIN. NICKEL UNDERPLATE	BLACK

F
E
D
C
B
A

F
E
D
C
B
A

EC NO: S2006-0241 2005/09/01 DRWN: CTEH 2005/09/01 CHKD: SRRAMESH 2005/09/02 APPR: GGLEE	DESCRIPTION REV	QUALITY SYMBOLS ▽=0 ▽=0	GENERAL TOLERANCES (UNLESS SPECIFIED)		DIMENSION STYLE MM ONLY		SCALE NTS	DESIGN UNITS METRIC	THIRD ANGLE PROJECTION	
			4 PLACES ± --- ± --- 3 PLACES ± --- ± --- 2 PLACES ± 0.20 ± --- 1 PLACE ± --- ± --- ANGULAR ± 5 °	mm INCH	DRAWN BY CTEH DATE 2005/01/10	CHECKED BY SRRAMESH DATE 2005/08/30	TITLE SALES DRAWING DDR FB DIMM 1.00MM PITCH 240 CKTS VERT. PRESS-FIT		MOLEX INCORPORATED	
DRAFT WHERE APPLICABLE MUST REMAIN WITHIN DIMENSIONS			SEE TABLE		MATERIAL NO. SD-87977-020		DOCUMENT NO.		THIS DRAWING CONTAINS INFORMATION THAT IS PROPRIETARY TO MOLEX INCORPORATED AND SHOULD NOT BE USED WITHOUT WRITTEN PERMISSION	

9 8 7 6 5 4 3 2 1