

PLEASE CHECK WWW.MOLEX.COM FOR LATEST PART INFORMATION

Part Number: [0887419100](#)
Status: **Active**
Description: MicroCross™ DVI Digital Visual Interface, Shielded I/O Adapter, DVI-I-Analog/Digital Receptacle to VGA Plug

Documents:

[Drawing \(PDF\)](#)

[RoHS Certificate of Compliance \(PDF\)](#)

General

| | |
|----------------|---|
| Product Family | I/O Connectors |
| Series | 88744 |
| Application | Wire-to-Board |
| Comments | DVI-I-Analog/Digital Receptacle to VGA Plug |
| Component Type | Adapter |
| Product Name | MicroCross™DVI |
| Type | N/A |

Physical

| | |
|--------------------------------|--------------------------------|
| Circuits (Loaded) | 29 |
| Circuits (maximum) | 29 |
| Color - Resin | Natural |
| Durability (mating cycles max) | 100 |
| Lock to Mating Part | Yes |
| Material - Metal | Phosphor Bronze, Steel |
| Material - Plating Mating | Gold |
| Material - Plating Termination | Tin |
| Material - Resin | High Temperature Thermoplastic |
| Orientation | Vertical |
| PCB Retention | Yes |
| Packaging Type | Bag |
| Panel Mount | No |
| Pitch - Mating Interface (in) | 0.075 In, 0.100 In |
| Pitch - Mating Interface (mm) | 1.90 mm, 2.54 mm |
| Plating min: Mating (µin) | 2, 30 |
| Plating min: Mating (µm) | 0.05, 0.75 |
| Plating min: Termination (µin) | 100, 150 |
| Plating min: Termination (µm) | 2.5, 3.75 |
| Polarized to Mating Part | Yes |
| Surface Mount Compatible (SMC) | N/A |
| Temperature Range - Operating | -20°C to +85°C |
| Termination Interface: Style | Through Hole |
| Wire Size AWG | N/A |

Electrical

| | |
|-------------------------------|-----|
| Current - Maximum per Contact | 3A |
| Shielded | Yes |
| Voltage - Maximum | 40V |

Material Info

Reference - Drawing Numbers

| | |
|-----------------------|---------------|
| Product Specification | RPS-88741-001 |
| Sales Drawing | SD-88741-012 |

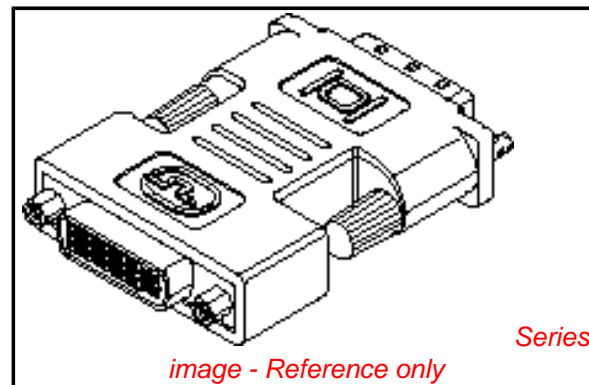

EU RoHS

**ELV and RoHS
Compliant**
REACH SVHC
 Not Reviewed
**Halogen-Free
Status**
 Not Reviewed

China RoHS



**Need more information on product
environmental compliance?**

Email productcompliance@molex.com
 For a multiple part number RoHS Certificate of Compliance, [click here](#)

Please visit the [Contact Us](#) section for any non-product compliance questions.

Search Parts in this Series

88744Series

Mates With

74320 receptacles

PLEASE CHECK WWW.MOLEX.COM FOR LATEST PART INFORMATION

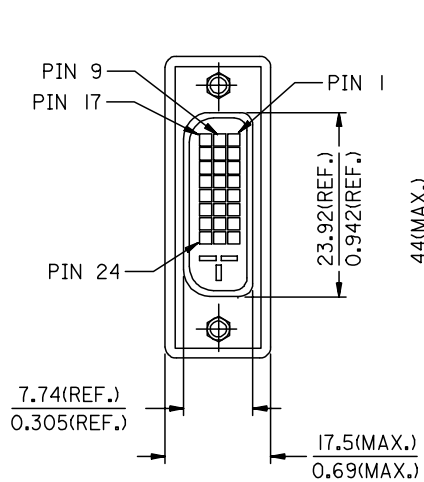

DVI-D(F)

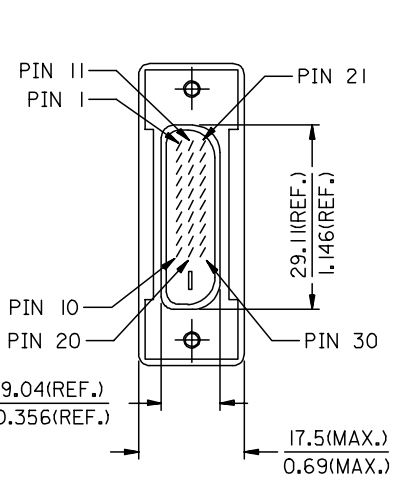
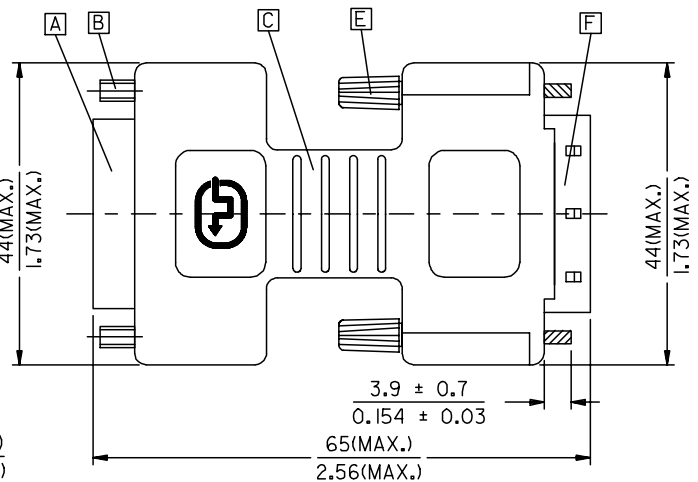

P&D-D(M)

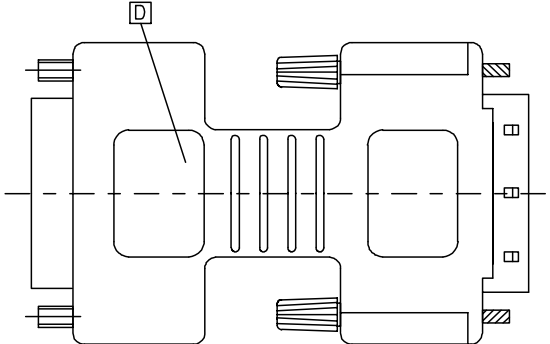

BACK SIDE

| | |
|--------------------|------------|
| ENTER DESCRIPTION | 2006/03/09 |
| EC NO: DG2006-0186 | 2006/03/09 |
| DRWN:PDAI | 2006/03/10 |
| CHKD: | |
| APPR:TKAN | |
| DESCRIPTION | |
| REV | |

| | |
|-----------------|--|
| QUALITY SYMBOLS | |
| ▽=0 | |
| ∇=0 | |

| | |
|--|-------|
| GENERAL TOLERANCES (UNLESS SPECIFIED) | |
| | mm |
| | INCH |
| 4 PLACES | ± --- |
| 3 PLACES | ± --- |
| 2 PLACES | ± --- |
| 1 PLACE | ± --- |
| ANGULAR ± ---° | |
| DRAFT WHERE APPLICABLE MUST REMAIN WITHIN DIMENSIONS | |

| | |
|-----------------|------------|
| DIMENSION STYLE | |
| MM/IN | |
| DRAWN BY | DATE |
| PDAI | 2006/03/07 |
| CHECKED BY | DATE |
| ZXDENG | 2006/03/07 |
| APPROVED BY | DATE |
| BORON | 2006/03/07 |
| MATERIAL NO. | |
| 88741-9200 | |
| SIZE | |
| A 4 | |

| | | |
|---|--------------|------------------------|
| SCALE | DESIGN UNITS | THIRD ANGLE PROJECTION |
| --- | METRIC | |
| TITLE | | |
| DVI_D(F)-P&D(M) ADAPTER | | |
| MOLEX MOLEX INCORPORATED | | |
| MATERIAL NO. | DOCUMENT NO. | SHEET NO. |
| 88741-9200 | SD-88741-013 | 1 OF 2 |
| THIS DRAWING CONTAINS INFORMATION THAT IS PROPRIETARY TO MOLEX INCORPORATED AND SHOULD NOT BE USED WITHOUT WRITTEN PERMISSION | | |

NOTE:1. PLASTIC COVER: SNOW WHITE UL GRADE ABS.
 2. DVI CONNCEOTOR SPECIFICATION
 2.1 REFER TO PRODUCT SPEC. PS74320-0001.
 2.2 CONTACT PLATING: AU FLASH.
 3. ELECTRICAL PERFORMANCE
 3.1 INSULATION RESISANCE: 20 M Ohms MIn
 3.2 DIELECTRIC STRENGTH: 300V DC FOR 10 MILLISECONDS.
 4. ADAPTOR SPECIFICATION
 4.1 REFER TO PRODUCT SPEC. PS88741-8800.
 5. THIS PRODUCT MUST MEET MX RoHS COMPLIANCE.

7. MATERIAL LIST

| | |
|------|---|
| F | P&D CONNECTOR ASSY 674850009 |
| E | ADAPTER SCREW 887806003 |
| D | DVI(F) TO P&D(M) ADAPTER BOTTOM COVER 887899308 |
| C | DVI(F) TO P&D(M) ADAPTER TOP COVER 887899301 |
| B | DVI_D FEMALE SCREW 887806066 |
| A | DVI_D FEMALE CONNECTOR 743207000 |
| ITEM | DESCRIPTION |

6. CONNECTION DIAGRAM

| SHIELD | SHIEDL | GROUND |
|----------|----------|------------------------|
| PIN 24 | PIN 15 | TMDS CLOCK- |
| PIN 23 | PIN 14 | TMDS CLOCK+ |
| PIN 22 | PIN 7 | TMDS CLOCK SHIELD |
| PIN 19 | PIN 23 | TMDS DATA 0 SHIELD |
| PIN 18 | PIN 21 | TMDS DATA 0+ |
| PIN 17 | PIN 22 | TMDS DATA 0- |
| PIN 16 | PIN 8 | HOT PLUG DETECT |
| PIN 15 | PIN 25 | GROUND(+5V & HV SYNC.) |
| PIN 14 | PIN 28 | POWER +5V |
| PIN 11 | PIN 13 | TMDS DATA 1 SHIELD |
| PIN 10 | PIN 11 | TMDS DATA 1+ |
| PIN 9 | PIN 12 | TMDS DATA 1- |
| PIN 7 | PIN 26 | DDC DATA |
| PIN 6 | PIN 27 | DDC CLOCK |
| PIN 3 | PIN 3 | TMDS DATA 2 SHIELD |
| PIN 2 | PIN 1 | TMDS DATA 2+ |
| PIN 1 | PIN 2 | TMDS DATA 2- |
| DVI-D(F) | P&D-D(M) | CABLE FUNCTION |

| | | | | | | | | |
|--|---------------------|---------------------------------------|------------|---|--------------------------|--------------|---------------------------|--|
| ENTER DESCRIPTION EC NO: DG2006-0186 DRWN:PDAI CHKD: APPR:TKAN 2006/03/09 2006/03/09 2006/03/10 | QUALITY SYMBOLS | GENERAL TOLERANCES (UNLESS SPECIFIED) | | DIMENSION STYLE | SCALE | DESIGN UNITS | THIRD ANGLE PROJECTION | |
| | | | | MM/IN | --- | METRIC | | |
| | | 4 PLACES | ± --- | ± --- | DRAWN BY | DATE | TITLE | |
| | | 3 PLACES | ± --- | ± --- | PDAI | 2006/03/07 | DVI_D(F)-P&D_D(M) ADAPTER | |
| 2 PLACES | ± --- | ± --- | CHECKED BY | DATE | | | | |
| 1 PLACE | ± --- | ± --- | ZXDENG | 2006/03/07 | | | | |
| ANGULAR ± ---° | | APPROVED BY | | DATE | MOLEX MOLEX INCORPORATED | | | |
| | | BORON | | 2006/03/07 | | | | |
| DRAFT WHERE APPLICABLE MUST REMAIN WITHIN DIMENSIONS | | MATERIAL NO. | | DOCUMENT NO. | SHEET NO. | | | |
| | | 88741-9200 | | SD-88741-013 | 2 OF 2 | | | |
| | | SIZE | | THIS DRAWING CONTAINS INFORMATION THAT IS PROPRIETARY TO MOLEX INCORPORATED AND SHOULD NOT BE USED WITHOUT WRITTEN PERMISSION | | | | |
| | | A 4 | | | | | | |