

Cable mount high power insert male (m) Hochstromkabelstecker (m)

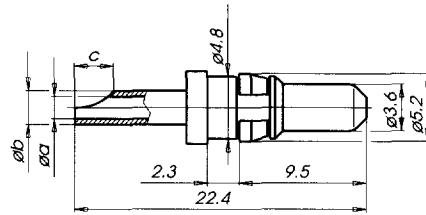

| Part No. Best.-Nr. | Current Nennstrom |
|-----------------------|--------------------------------------|
| 096.24.1115.40 1 | 10 A: a = 1,85, b = 2,55, c = 3,0 mm |
| 097.24.1115.40 1 | 20 A: a = 2,80, b = 3,70, c = 4,0 mm |
| 098.24.1115.40 1 | 40 A: a = 4,40, b = 5,60, c = 5,2 mm |



Solder version

Lötversion

Plating/Oberflächenausführung
1 = Au
Other Platings on request
Andere Oberflächen auf Anfrage

pcb mount high power angle insert male (m) Hochstromanbauwinkelstecker (m)

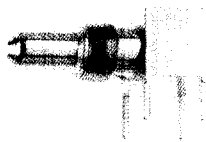

| Part No. Best.-Nr. | Current Nennstrom |
|-----------------------|----------------------|
| 192.24.1025.40 1 | 40 A |

Montagebohrungen
Mounting Detail

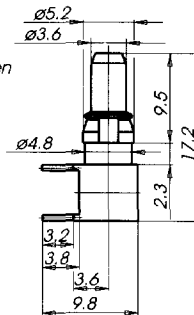
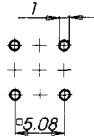

Plating/Oberflächenausführung
1 = Au
Other Platings on request
Andere Oberflächen auf Anfrage

pcb mount high power angle insert male (m) Hochstromanbauwinkelstecker (m)

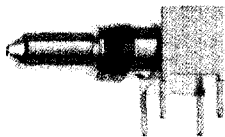

| Part No. Best.-Nr. | Current Nennstrom |
|-----------------------|----------------------|
| 185.24.1025.40 1 | 10 A |

Montagebohrungen
Mounting Detail

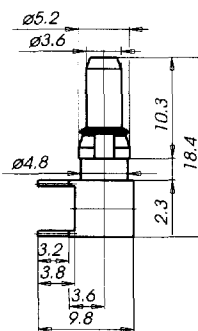
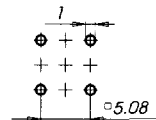

Plating/Oberflächenausführung
1 = Au
Other Platings on request
Andere Oberflächen auf Anfrage

Cable mount high power insert female (f) Hochstromkabelbuchse (f)



| Part No. Best.-Nr. | Current Nennstrom |
|-----------------------|--------------------------------------|
| 093.24.2115.40 1 | 10 A: a = 1,85, b = 2,55, c = 3,0 mm |
| 094.24.2115.40 1 | 20 A: a = 2,80, b = 3,70, c = 4,0 mm |
| 095.24.2115.40 1 | 40 A: a = 4,80, b = 5,60, c = 5,2 mm |

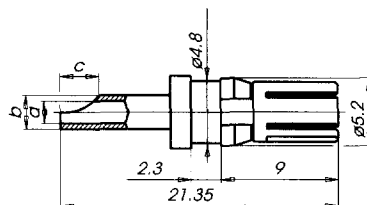

Solder version

Lötversion

Plating/Oberflächenausführung
1 = Au
Other Platings on request
Andere Oberflächen auf Anfrage