

**No. 6048**

**C14**

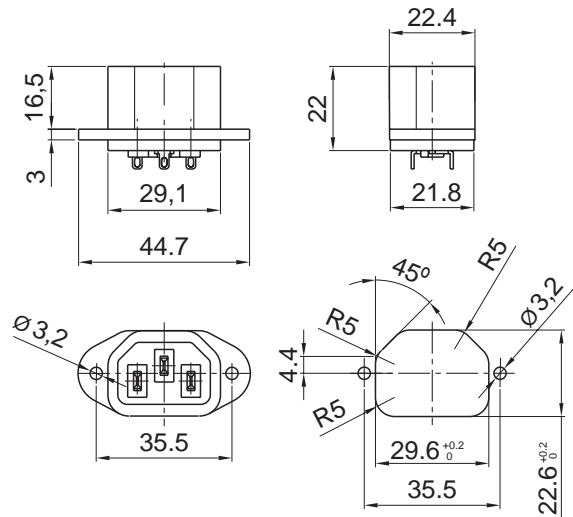

Montageausbruch  
panel cutout

Geräteschutzklasse I / equipment class I  
IEC 60320-1 / EN 60320-1 / VDE 0625-1



**C14**



10A/250Vac



15A/250Vac



10A/250Vac



15A/250Vac

**socket:**  
Polyamide PA6 – UL94V-0  
**terminals:**  
copper alloy, tin-plated  
or nickel-plated

**Socket:**  
Polyamid PA6 – UL94V-0  
**Anschlüsse:**  
Kupferlegierung, verzinkt  
oder vernickelt

Gängiger Artikel/selling article

**6 0 4 8 - X - 2 2 2 0 - A - 2**

