

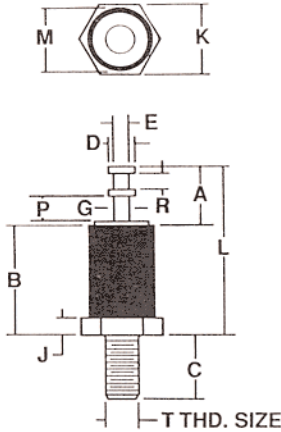

EMC® Product "DTS" Series



Plating:

- 14: 400µ" Tin terminal, 200µ" Cadmium Chromate base/eyelet
- 4: 30µ" Gold terminal, 200µ" Cadmium Chromate base/eyelet
- 17: 400µ" Tin terminal, 200µ" Nickel base/eyelet
- 52: 400µ" Tin terminal, 200µ" Cadmium Chromate base/eyelet

Material:

Terminal: Brass, 1/2-hard, QQ-B-626
 Base/Eyelet: Brass, 1/2-hard, QQ-B-626
 Insulator: Diallyl Phthalate, MIL-M-14F Type SDG

Type 93

Type 93 Continued On Next Page →

Type	EMC Part #	Flash-over Volt.	A	B	C	D	E	G	J	K	L	M	P	R	T
93	4024-14-1	12000	.219 (5.56)	.594 (15.09)	.219 (5.56)	.093 (2.36)	.050 (1.27)	.050 (1.27)	.062 (1.57)	.250 (6.35)	.813 (20.65)	.232 (5.89)	.089 (2.26)	.052 (1.32)	8-32
93	2567-14-1	12000	.219 (5.56)	.594 (15.09)	.375 (9.53)	.093 (2.36)	.050 (1.27)	.050 (1.27)	.062 (1.57)	.250 (6.35)	.813 (20.65)	.232 (5.89)	.089 (2.26)	.052 (1.32)	6-32
93	3104-14-1	12000	.250 (6.35)	.594 (15.09)	.219 (5.56)	.093 (2.36)	.045 (1.14)	.045 (1.14)	.062 (1.57)	.250 (6.35)	.843 (21.41)	.232 (5.89)	.107 (2.72)	.063 (1.60)	6-32
93	3252-14-1	12000	.250 (6.35)	.594 (15.09)	.219 (5.56)	.093 (2.36)	.045 (1.14)	.045 (1.14)	.062 (1.57)	.250 (6.35)	.843 (21.41)	.232 (5.89)	.107 (2.72)	.063 (1.60)	4-40
93	3254-14-1	12000	.250 (6.35)	.594 (15.09)	.219 (5.56)	.093 (2.36)	.045 (1.14)	.045 (1.14)	.062 (1.57)	.250 (6.35)	.843 (21.41)	.232 (5.89)	.107 (2.72)	.063 (1.60)	6-32
93	4677-14-1	12000	.344 (8.74)	.594 (15.09)	.219 (5.56)	.140 (3.56)	.062 (1.57)	.078 (1.98)	.062 (1.57)	.250 (6.35)	.938 (23.83)	.232 (5.89)	.158 (4.01)	.097 (2.46)	4-40
93	2570-14-1	12000	.344 (8.74)	.594 (15.09)	.250 (6.35)	.140 (3.56)	.062 (1.57)	.078 (1.98)	.062 (1.57)	.250 (6.35)	.938 (23.83)	.232 (5.89)	.158 (4.01)	.097 (2.46)	6-32
93	2571-14-1	12000	.344 (8.74)	.594 (15.09)	.375 (9.53)	.140 (3.56)	.062 (1.57)	.078 (1.98)	.062 (1.57)	.250 (6.35)	.938 (23.83)	.232 (5.89)	.158 (4.01)	.097 (2.46)	6-32
93	4564-14-1	10000	.344 (8.74)	.531 (13.49)	.219 (5.56)	.140 (3.56)	.062 (1.57)	.078 (1.98)	.062 (1.57)	.250 (6.35)	.875 (22.23)	.232 (5.89)	.158 (4.01)	.097 (2.46)	6-32
93	3251-14-1	10000	.250 (6.35)	.531 (13.49)	.219 (5.56)	.093 (2.36)	.050 (1.27)	.075 (1.91)	.062 (1.57)	.250 (6.35)	.719 (18.26)	.232 (5.89)	.107 (2.72)	.063 (1.60)	4-40
93	3253-14-1	10000	.250 (6.35)	.531 (13.49)	.219 (5.56)	.093 (2.36)	.050 (1.27)	.075 (1.91)	.062 (1.57)	.250 (6.35)	.719 (18.26)	.232 (5.89)	.107 (2.72)	.063 (1.60)	6-32
93	3092-14-1	10000	.328 (8.33)	.531 (13.49)	.219 (5.56)	.188 (4.78)	.110 (2.79)	.125 (3.18)	.062 (1.57)	.250 (6.35)	.859 (21.81)	.232 (5.89)	.138 (3.51)	.090 (2.29)	4-40
93	3249-14-1	9000	.250 (6.35)	.500 (12.70)	.219 (5.56)	.093 (2.36)	.050 (1.27)	.050 (1.27)	.062 (1.57)	.250 (6.35)	.750 (19.05)	.232 (5.89)	.107 (2.72)	.063 (1.60)	4-40
93	3250-14-1	9000	.250 (6.35)	.500 (12.70)	.219 (5.56)	.093 (2.36)	.050 (1.27)	.050 (1.27)	.062 (1.57)	.250 (6.35)	.750 (19.05)	.232 (5.89)	.107 (2.72)	.063 (1.60)	6-32
93	3244-14-1	9000	.344 (8.74)	.500 (12.70)	.219 (5.56)	.140 (3.56)	.062 (1.57)	.078 (1.98)	.062 (1.57)	.250 (6.35)	.843 (21.41)	.232 (5.89)	.158 (4.01)	.097 (2.46)	4-40
93	3245-14-1	9000	.344 (8.74)	.500 (12.70)	.219 (5.56)	.140 (3.56)	.062 (1.57)	.078 (1.98)	.062 (1.57)	.250 (6.35)	.843 (21.41)	.232 (5.89)	.158 (4.01)	.097 (2.46)	6-32
93	2720-14-1	8200	.156 (3.96)	.390 (9.91)	.125 (3.18)	.072 (1.83)	.050 (1.27)	.050 (1.27)	.046 (1.17)	.156 (3.96)	.547 (13.89)	.146 (3.71)	.055 (1.40)	.046 (1.17)	2-56
93	2721-14-1	8200	.156 (3.96)	.390 (9.91)	.188 (4.78)	.072 (1.83)	.050 (1.27)	.050 (1.27)	.046 (1.17)	.156 (3.96)	.547 (13.89)	.146 (3.71)	.055 (1.40)	.046 (1.17)	2-56
93	2168-14-1	8200	.156 (3.96)	.390 (9.91)	.219 (5.56)	.072 (1.83)	.050 (1.27)	.050 (1.27)	.046 (1.17)	.156 (3.96)	.547 (13.89)	.146 (3.71)	.055 (1.40)	.046 (1.17)	2-56

inch
(mm)

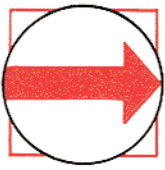

EMC® Product "DTS" Series

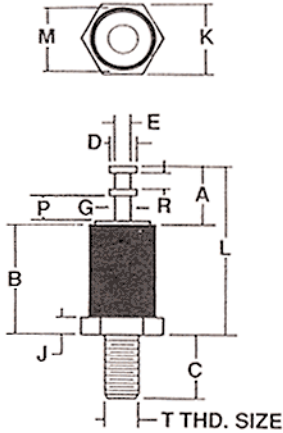

Plating:

- 14: 400µ" Tin terminal, 200µ" Cadmium Chromate base/eyelet
- 4: 30µ" Gold terminal, 200µ" Cadmium Chromate base/eyelet
- 17: 400µ" Tin terminal, 200µ" Nickel base/eyelet
- 52: 400µ" Tin terminal, 200µ" Cadmium Chromate base/eyelet

Material:

Terminal: Brass, 1/2-hard, QQ-B-626
 Base/Eyelet: Brass, 1/2-hard, QQ-B-626
 Insulator: Diallyl Phthalate, MIL-M-14F Type SDG

Type 93

Type	EMC Part #	Flash-over Volt.	A	B	C	D	E	G	J	K	L	M	P	R	T
93	2722-14-1	8200	.156 (3.96)	.390 (9.91)	.250 (6.35)	.072 (1.83)	.050 (1.27)	.050 (1.27)	.046 (1.17)	.156 (3.96)	.547 (13.89)	.146 (3.71)	.055 (1.40)	.046 (1.17)	2-56
93	3115-14-1	8200	.313 (7.95)	.390 (9.91)	.219 (5.56)	.072 (1.83)	.050 (1.27)	.050 (1.27)	.046 (1.17)	.156 (3.96)	.703 (17.86)	.146 (3.71)	.184 (4.67)	.073 (1.85)	2-56
93	2569-14-1	8000	.344 (8.74)	.375 (9.53)	.375 (9.53)	.140 (3.56)	.062 (1.57)	.078 (1.98)	.062 (1.57)	.250 (6.35)	.719 (18.26)	.232 (5.89)	.158 (4.01)	.097 (2.46)	6-32
93	2055-14-1	8000	.344 (8.74)	.375 (9.53)	.219 (5.56)	.140 (3.56)	.062 (1.57)	.078 (1.98)	.062 (1.57)	.250 (6.35)	.719 (18.26)	.232 (5.89)	.158 (4.01)	.097 (2.46)	6-32
93	2049-14-1	8000	.344 (8.74)	.375 (9.53)	.219 (5.56)	.140 (3.56)	.062 (1.57)	.078 (1.98)	.062 (1.57)	.250 (6.35)	.719 (18.26)	.232 (5.89)	.158 (4.01)	.097 (2.46)	4-40
93	2376-14-1	8000	.250 (6.35)	.375 (9.53)	.219 (5.56)	.125 (3.18)	.062 (1.57)	.062 (1.57)	.062 (1.57)	.250 (6.35)	.625 (15.88)	.232 (5.89)	.102 (2.59)	.078 (1.98)	4-40
93	2385-14-1	8000	.219 (5.56)	.375 (9.53)	.219 (5.56)	.093 (2.36)	.050 (1.27)	.050 (1.27)	.062 (1.57)	.250 (6.35)	.594 (15.09)	.232 (5.89)	.089 (2.26)	.052 (1.32)	6-32
93	2444-14-1	8000	.219 (5.56)	.375 (9.53)	.219 (5.56)	.093 (2.36)	.050 (1.27)	.050 (1.27)	.062 (1.57)	.250 (6.35)	.594 (15.09)	.232 (5.89)	.089 (2.26)	.052 (1.32)	4-40
93	5130-14-1	8000	.219 (5.56)	.375 (9.53)	.188 (4.78)	.093 (2.36)	.050 (1.27)	.050 (1.27)	.062 (1.57)	.250 (6.35)	.594 (15.09)	.232 (5.89)	.089 (2.26)	.052 (1.32)	4-40
93	2565-14-1	8000	.219 (5.56)	.375 (9.53)	.375 (9.53)	.093 (2.36)	.050 (1.27)	.050 (1.27)	.062 (1.57)	.250 (6.35)	.594 (15.09)	.232 (5.89)	.089 (2.26)	.052 (1.32)	6-32
93	2902-14-1	8000	.250 (6.35)	.375 (9.53)	.219 (5.56)	.093 (2.36)	.050 (1.27)	.075 (1.91)	.062 (1.57)	.250 (6.35)	.625 (15.88)	.232 (5.89)	.107 (2.72)	.063 (1.60)	6-32
93	2984-14-1	6000	.219 (5.56)	.234 (5.94)	.219 (5.56)	.093 (2.36)	.050 (1.27)	.050 (1.27)	.046 (1.17)	.156 (3.96)	.453 (11.51)	.146 (3.71)	.089 (2.26)	.052 (1.32)	2-56
93	2719-14-1	6000	.156 (3.96)	.234 (5.94)	.250 (6.35)	.072 (1.83)	.050 (1.27)	.050 (1.27)	.046 (1.17)	.156 (3.96)	.391 (9.93)	.146 (3.71)	.055 (1.40)	.046 (1.17)	2-56
93	2162-14-1	6000	.156 (3.96)	.234 (5.94)	.219 (5.56)	.072 (1.83)	.050 (1.27)	.050 (1.27)	.046 (1.17)	.156 (3.96)	.391 (9.93)	.146 (3.71)	.055 (1.40)	.046 (1.17)	2-56
93	2522-14-1	6000	.156 (3.96)	.234 (5.94)	.125 (3.18)	.072 (1.83)	.050 (1.27)	.050 (1.27)	.046 (1.17)	.156 (3.96)	.391 (9.93)	.146 (3.71)	.055 (1.40)	.046 (1.17)	2-56
93	2150-14-1	6000	.156 (3.96)	.234 (5.94)	.156 (3.96)	.072 (1.83)	.050 (1.27)	.050 (1.27)	.046 (1.17)	.156 (3.96)	.390 (9.91)	.146 (3.71)	.055 (1.40)	.046 (1.17)	2-56
93	2718-14-1	6000	.156 (3.96)	.234 (5.94)	.188 (4.78)	.072 (1.83)	.050 (1.27)	.050 (1.27)	.046 (1.17)	.156 (3.96)	.390 (9.91)	.146 (3.71)	.055 (1.40)	.046 (1.17)	2-56
93	3113-14-1	6000	.313 (7.95)	.234 (5.94)	.219 (5.56)	.083 (2.11)	.050 (1.27)	.050 (1.27)	.046 (1.17)	.156 (3.96)	.547 (13.89)	.146 (3.71)	.055 (1.40)	.046 (1.17)	2-56

inch
(mm)