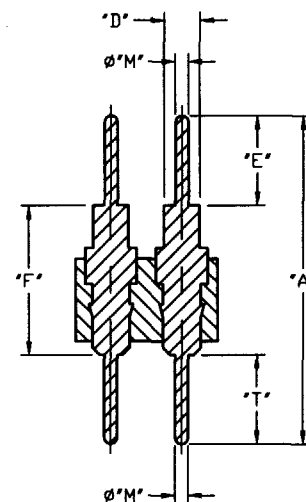
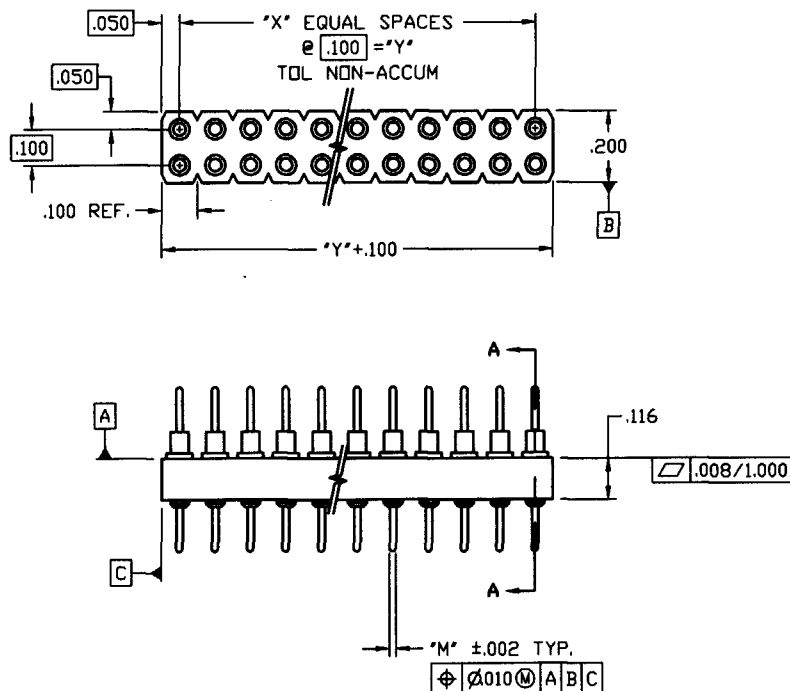

TABLE 2 CONTACTS

[XXX]S	*A* DIM.	*D* DIM.	*E* DIM.	*F* DIM.	*M* DIM.	*T* DIM.	PLATING	PCB HOLE
862	.585	.050	.125	.335	Ø.018	.125	10u" GOLD OVER 100u" MIN. NICKEL	.022±.003
858	.585	.050	.125	.335	Ø.018	.125	200u" TIN/LEAD OVER 100u" MIN. NICKEL	.022±.003
861	.460	.050	.125	.210	Ø.018	.125	10u" GOLD OVER 100u" MIN. NICKEL	.022±.003

TABLE 1

PART NUMBER	DIMENSION		NO. OF POSITIONS
	*Y*	*X*	
SST-2 X [D] - [XXX]S			
01	0	0	2
02	.100	1	4
03	.200	2	6
04	.300	3	8
05	.400	4	10
06	.500	5	12
07	.600	6	14
08	.700	7	16
09	.800	8	18
10	.900	9	20
11	1.000	10	22
12	1.100	11	24
13	1.200	12	26
14	1.300	13	28
15	1.400	14	30
16	1.500	15	32
17	1.600	16	34
18	1.700	17	36
19	1.800	18	38
20	1.900	19	40
21	2.000	20	42
22	2.100	21	44
23	2.200	22	46
24	2.300	23	48
25	2.400	24	50
26	2.500	25	52
27	2.600	26	54
28	2.700	27	56
29	2.800	28	58
30	2.900	29	60
31	3.000	30	62
32	3.100	31	64

SECTION A-A  
SCALE 4:1

## NOTES:

- NUMBER OF CONTACTS PER ROW (01 TO 32).
- INSULATOR MATERIAL:  
GLASS REINFORCED POLYPHENYLENE SULFIDE (PPS)  
RATED UL 94V-0, COLOR BLACK.
- CONTACT MATERIAL:  
OUTER SHELL: BRASS ALLOY 360, 1/2 HARD PER QQ-B-626.
- CONTACT PLATING:  
TIN/LEAD PER MIL-P-81728 TYPE 1,  
NICKEL PER QQ-N-290.  
GOLD PER MIL-G-45204, TYPE 1, GRADE C.

mat'l. code				tolerances unless otherwise specified		CUSTOMER COPY
ltr	ecn no	dr	date	linear	angular	
A	V00765	DLW	3/10/00	.XX ±.01	.XXX ±.005	projection
				.XXX ±.0020	0° ±2°	
				dr	D. WOLFORD 3/10/00	INCH
				enr	A. VASBINDER 3/10/00	
				chr	A. VASBINDER 3/10/00	scale
				appd	A. VASBINDER 3/10/00	
sheet index	revision sheet	A	1			2:1

PART NUMBER (SEE TABLES)  
SST-2 X [D] - [XXX]S

		<b>DOUBLE ROW SIP HEADERS</b>	
product family	SIP	code	-
size	dwg no	sheet	1 of 1
A	58904		

cage code  
22526