

VOLTAGE CONTROLLED OSCILLATORS SURFACE MOUNT - LOW COST FOR WIRELESS APPLICATIONS

Features

- Exceptional phase noise
- Surface Mount package
- 3 V power supply available

Electrical characteristics

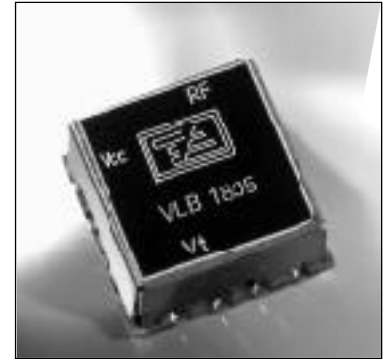

| MODEL N° | FREQ. RANGE (MHz) | POWER OUTPUT (dBm) typ. | TUNING VOLTAGE (V) | PHASE NOISE @ 10 KHz (dBc/Hz) | PHASE NOISE @ 100 KHz (dBc/Hc) | PHASE NOISE @ 800 KHz (dBc/Hz) | 2nd HARM-ONIC (dBc) | POWER SUPPLY (V/mA) | PACKAGE |
|----------|-------------------|-------------------------|--------------------|-------------------------------|--------------------------------|--------------------------------|---------------------|---------------------|---------|
| VLA195 | 195-220 | 8 | 1 to 14 | -110 | -130 | | -8 | 12 / 20 | SM1 |
| VLA255 | 255-320 | 0 | 1 to 9 | -100 | -120 | | -10 | 8 / 20 | SM1 |
| VLA335 | 335-385 | 0 | 0 to 10 | -85 | -105 | | -20 | 5 / 25 | SM1 |
| VLA360 | 360-440 | 5 | 1 to 5 | -100 | -120 | | -10 | 5 / 25 | SM1 |
| VLA390 | 380-400 | 0 | 0 to 5 | -117 | -137 | | -12 | 5 / 15 | SM1 |
| VLA380 | 380-430 | 0 | 0 to 5 | -112 | -132 | | -12 | 5 / 15 | SM1 |
| VLA408 | 408-470 | 2 | 1 to 8 | -100 | -120 | | -10 | 8 / 25 | SM1 |
| VLA445 | 445-495 | 0 | 0 to 10 | -85 | -105 | | -20 | 5 / 25 | SM1 |
| VLA809 | 809-845 | 5 | 0.5 to 5 | -115 | -135 | -154 | -12 | 5 / 25 | SM1 |
| VLA900 | 900-1000 | 5 | 0.5 to 5 | -88 | -108 | | -12 | 5 / 25 | SM1 |
| VLA925 | 925-960 | 3 | 1.5 to 6.5 | -115 | -135 | -154 | -12 | 5 / 25 | SM1 |
| VLA950 | 950-986 | 3 | 1 to 6 | -115 | -135 | -154 | -12 | 5 / 25 | SM1 |
| CR960 | 960 ± 10 | 2 | 1 to 4.5 | -105 | -125 | | -10 | 4.5 / 15 | SM1 |
| VLA1250 | 1250-1350 | 3 | 1 to 8 | -100 | -120 | | -12 | 8 / 25 | SM1 |
| VLA1450 | 1450-1550 | 3 | 1 to 8 | -105 | -125 | -145 | -12 | 5 / 25 | SM1 |
| VLA1500 | 1500-1650 | 1 | 1 to 8 | -97 | -117 | -137 | -12 | 8 / 16 | SM1 |
| VLA1511 | 1511-1586 | 4 | 1 to 8 | -105 | -125 | -145 | -12 | 5 / 25 | SM1 |
| VLA1594 | 1594-1669 | 3 | 1 to 6.5 | -105 | -125 | -145 | -15 | 5 / 25 | SM1 |
| VLA1750 | 1750-1900 | 1 | 1 to 8 | -97 | -117 | -137 | -12 | 8 / 16 | SM1 |
| VLW1800 | 1800-2700 | 1 | 0 to 19 | -85 | -105 | | -8 | 12 / 25 | SM1 |
| CR1877 | 1877 ± 10 | -2 | 0 to 10 | -100 | -120 | | -10 | 5 / 10 | SM1 |
| VLA2430 | 2430-2470 | 2 | 0 to 12 | -95 | -115 | | -12 | 8 / 20 | SM1 |
| VLA2650 | 2650-2850 | 2 | 0 to 12 | -90 | -110 | | -12 | 8 / 20 | SM1 |
| VL2-240 | 240-400 | 3 | 1 to 15 | -105 | -125 | | -10 | 12 / 12 | SM2 |
| VL2-681 | 681-716 | 0 | 1 to 8 | -115 | -135 | -154 | -15 | 8 / 20 | SM2 |
| VL2-746 | 746-785 | 0 | 1 to 8 | -115 | -135 | -154 | -15 | 8 / 20 | SM2 |
| VL2-820 | 820-880 | 3 | 1.5 to 8 | -100 | -120 | | -12 | 9 / 30 | SM2 |
| VL2-880 | 880-915 | 6 | 1 to 8 | -100 | -120 | | -12 | 8 / 40 | SM2 |
| VL2-960 | 960-1600 | 11 | 1 to 14 | -95 | -115 | | -10 | 4 / 45 | SM2 |
| VL2-990 | 990-1050 | 3 | 1.5 to 8 | -100 | -120 | | -12 | 9 / 30 | SM2 |
| VL2-1079 | 1079-1114 | 5 | 1 to 8 | -110 | -130 | -154 | -10 | 5 / 40 | SM2 |
| VL2-1100 | 1100-1160 | 3 | 1.5 to 8 | -100 | -120 | | -12 | 9 / 30 | SM2 |
| VL2-1170 | 1170-1230 | 4 | 1 to 8 | -110 | -130 | | -15 | 8 / 20 | SM2 |
| VL2-1450 | 1450-1850 | 11 | 1 to 12 | -95 | -115 | | -12 | 12 / 25 | SM2 |
| VL2-1480 | 1480-1600 | 8 | 2 to 10 | -98 | -118 | | -15 | 12 / 30 | SM2 |
| VL2-1615 | 1615-1715 | 8 | 2 to 10 | -98 | -118 | | -15 | 12 / 30 | SM2 |
| VL2-1800 | 1800-2300 | 11 | 1 to 13 | -95 | -115 | | -12 | 12 / 25 | SM2 |
| VL2-2200 | 2200-2600 | 10 | 1 to 13 | -95 | -115 | | -12 | 12 / 25 | SM2 |

VOLTAGE CONTROLLED OSCILLATORS

Surface mount - Low cost



Applications

- Base stations

Other packages available,

Pin configuration

| Case | RF out | V tune | VCC | Case Ground |
|------|--------|--------|-----|-------------|
| SM1 | P1 | P2 | P3 | - |
| SM2 | P1 | P2 | P3 | - |

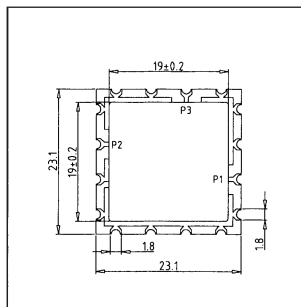

SM2

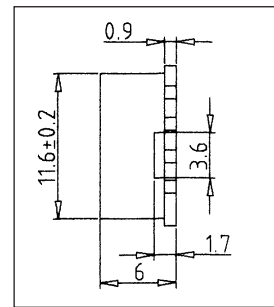

SM1

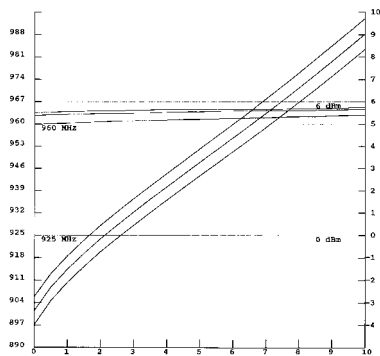

VLA925

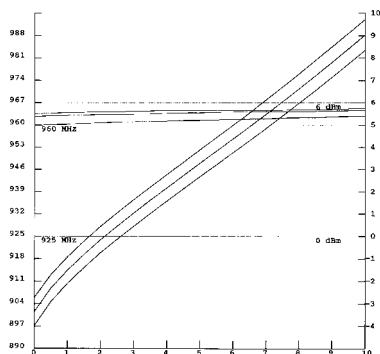
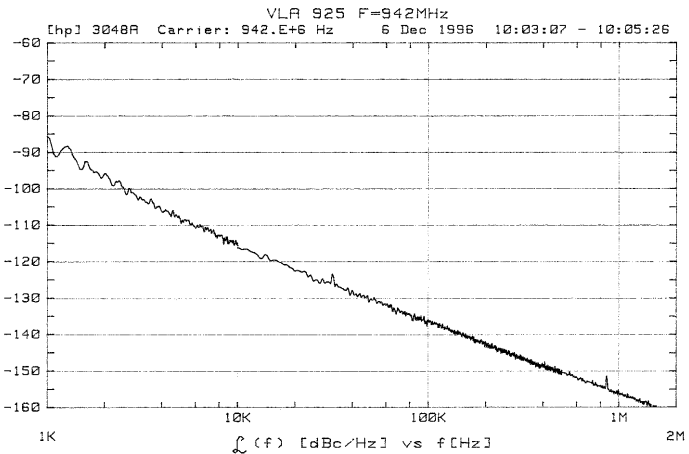

VLA1904

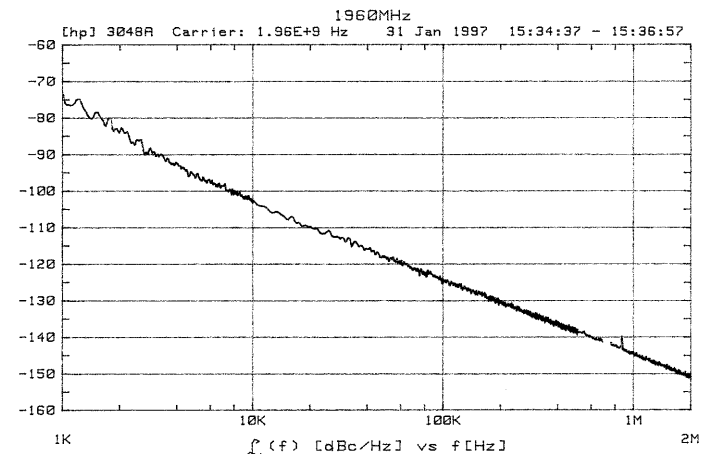

SALES OFFICES

WEB SITE: <http://www.tekelec-temex.com>