

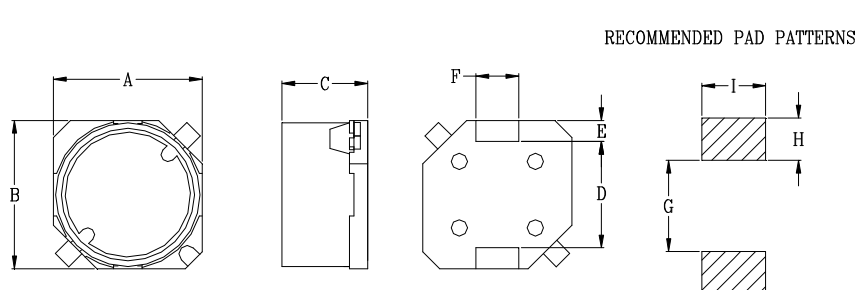

DELTA P/N : SIWC73 Series

Mechanical dimensions



RECOMMENDED PAD PATTERNS

Dimensions (Unit : mm)

A	7.6 MAX
B	7.6 MAX
C	3.5 MAX
D	5.3
E	1.0
F	2.0
G	4.4
H	2.0
I	3.0

Electrical Characteristics @25°C 100KHz, 0.1V

Delta P/N	L ¹ (uH)	DCR (mΩ) MAX	I _{rated} ² (A dc)
SIWC73-1R0	1.0	19	3.12
SIWC73-1R5	1.5	23	2.85
SIWC73-2R2	2.2	28	2.66
SIWC73-3R3	3.3	35	2.26
SIWC73-4R7	4.7	43	1.96
SIWC73-6R8	6.8	55	1.76
SIWC73-100	10	80	1.34
SIWC73-120	12	90	1.23
SIWC73-150	15	120	1.09
SIWC73-180	18	130	0.99
SIWC73-220	22	150	0.90
SIWC73-270	27	210	0.81
SIWC73-330	33	250	0.72
SIWC73-390	39	310	0.67
SIWC73-470	47	350	0.60
SIWC73-560	56	430	0.55
SIWC73-680	68	520	0.50
SIWC73-820	82	600	0.46
SIWC73-101	100	790	0.41

1. Tolerance of inductance : ± 20%
2. I_{rated} is the DC current which cause the inductance drop 10% typical of it's nominal inductance without current and the surface temperature of the part increase less than 45 °C.
3. Operating temperature: -40°C to 105°C (Self-temperature rise included).