

REVISIONS			
REV.	DESCRIPTION	DATE	BY
A	ECO 21555	9/2/2008	DKN
B	ECO 25670 (CHG SHORTER BODY)	5/4/2012	YP

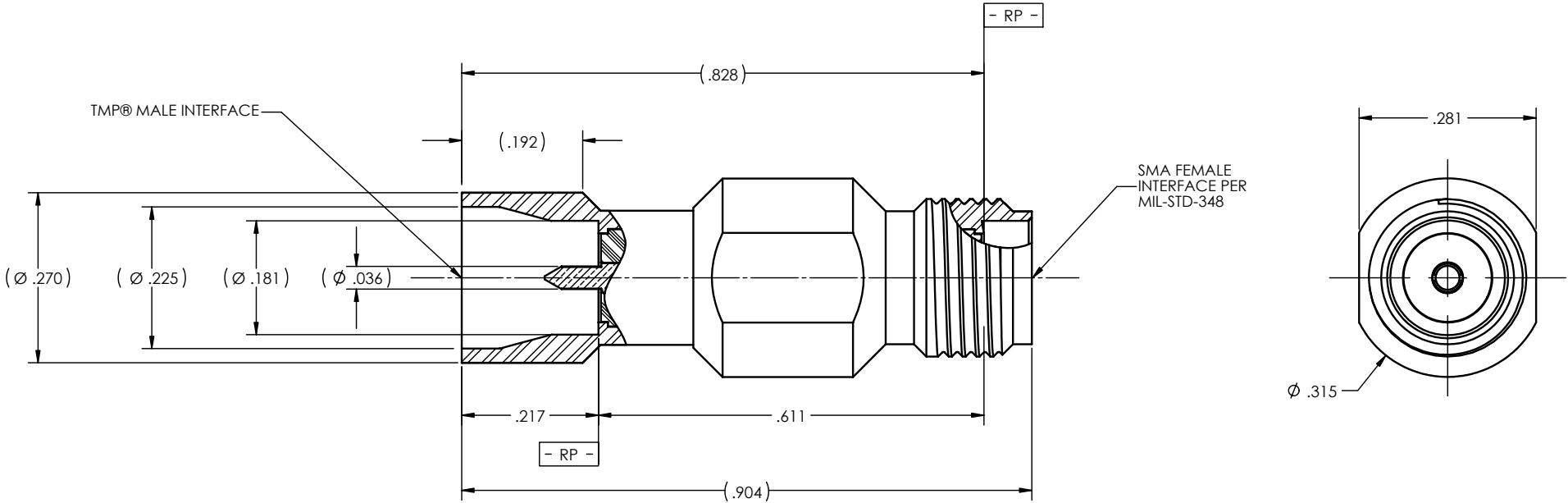
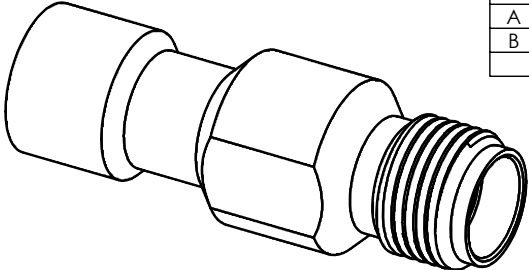

TMP® is a registered trademark of Carlisle IT.

MATERIAL(S):	ELECTRICAL(S):	MECHANICAL(S):	ENVIRONMENTAL(S):
Body: 303 SST per ASTM A-582 Center Conductor: BeCu Alloy per ASTM B-196 Dielectric: PTFE Teflon per ASTM D-1710	Impedance: 50 Ohms Nominal Frequency Range: DC to 18.0 GHz	Interface Dimensions: SMA interface per MIL-STD-348 TMA® Male Interface	Temperature Range: -65°C to +165°C

FINISH(ES):	APPLICABLE CARLISLE IT DOCUMENTS			TOLERANCES AND NOTES		MATERIAL		SPECIFICATION		PROCUREMENT	
	WORK STANDARD	PROD INSTRUC	ASSY INSTRUC	EXCEPT AS NOTED	DIMENSIONS ARE IN INCHES.	APPROVAL INITIALS	DATE	CARLISLE		Interconnect Technologies	
Center Conductor: Gold plate per ASTM B-488 over Nickel underplate per SAE AMS-QQ-N-290 Body: Passivate per ASTM A-967	NA	NA	NA	1. MACHINE FINISH $\sqrt{RMS}$	LINEAR $XX \pm .015$ ANGULAR $\pm 1/2^\circ$	DKN	09.02.08	Interconnect Technologies		Cerritos, CA 90703	
				2. BREAK ALL SHARP EDGES .003 MAX.	FRACTION $\pm 1/32$			TITLE		TMP® MALE TO SMA FEMALE STRAIGHT ADAPTER	
				3. MACHINED FILLETS .005 MAX.	4. MACHINED SURFACES SQUARE TO RESPECTIVE AXIS WITHIN .005 INCHES PER INCH.			SCALE	SUB-DIRECTORY/	SHEET	OF
				5. MACHINED DIAMETERS CONCENTRIC WITHIN .002 T.I.R.	6. DIMENSIONS TO BE MET BEFORE PLATING.	DESIGN ENGR	PVC	12.05.08	8:1	OL/	1
				7. CHAMFER ALL THREADS 45°.	8. THREADS PER H-28	MFG. ENGR	PC	05.08.12	SIZE	CAGE CODE	DRAWING NO.
				9. REMOVE FRAVED EDGES ON TEFLON.	10. REMOVE ALL BURRS.	ECO APPRV	DNG	05.07.12	C	30990	MP544-1CCSF
											REV. B