

MCP3M

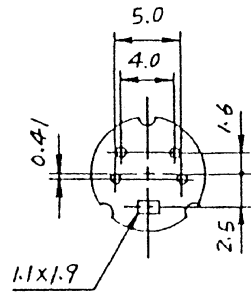

MCP4M

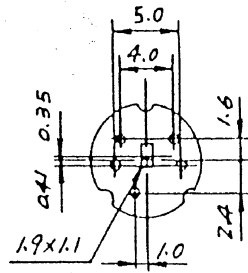

MCP5M

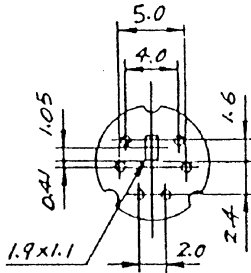

MCP6M

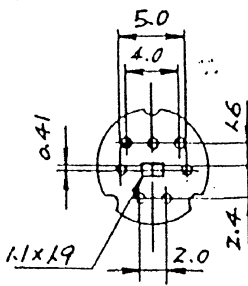

MCP7M

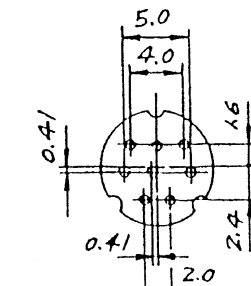

MCP8M

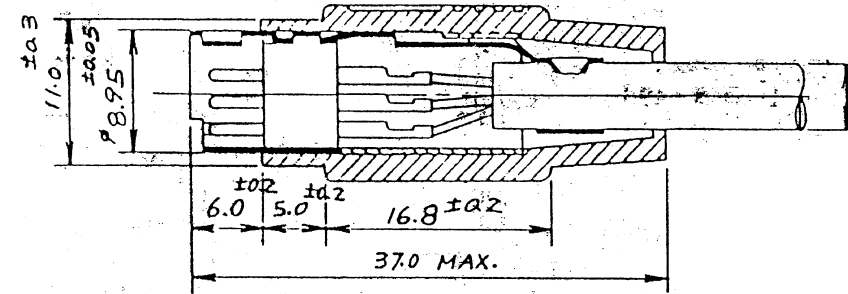
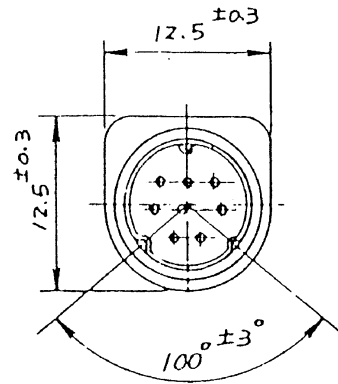

ELECTRICAL SPECIFICATIONS:

RATING: 100 VAC 1 AMP MAX.

OR 12 VDC 2 AMPS MAX.

INSULATION RESISTANCE: 50 MEGOHMS

MIN. AT 250 VDC

DIELECTRIC STRENGTH: 250 VAC FOR

1 MINUTE

NOTE: ALL DIMENSIONS ARE IN MILLIMETERS

7	CABLE		
6	CONTACT TERMINAL	*	PBR-H 0.2 t
5	CAP	1	PVC 35P
4	COVER B	1	BSR-H 0.4 t NICKEL PLATED
3	COVER A	1	BSR-H 0.4 t NICKEL PLATED
2	CONTACT PIN	*	BRASS BAR SILVER PLATED
1	BODY	1	PBT + 15% GF UL 94V-0
P/N	PART NAME	NO REQ	MATERIAL & SPEC.

PREH ELECTRONICS

TITLE MINIATURE CIRCULAR CONNECTORS

ASSEMBLY TYPE STRAIGHT PLUGS

DWN CHKD APPVD DWG NO.

12/29/60