

1.37 for size 09 and 15  
1.38 for size 25 and 37

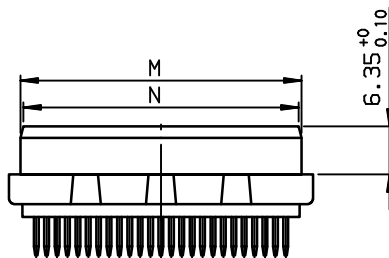
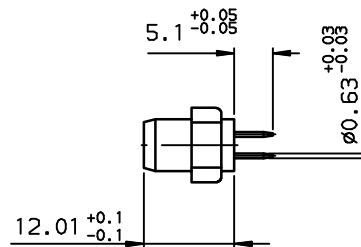

ELECTRICAL DATA

-Current at AMB. 4A  
-I max 7.5A  
-Contact resistance <math>\leq 7.3\text{ma}</math>  
-Insulation resistance >5000Ma  
-TEST VOLTAGE contact/contact >1000V  
contact/ground >1200V

MECHANICAL DATA

-Contact force >=0.20N  
-Retention force >=40N  
-Insertion force according to DIN41652 Part 2  
-Withdrawal force according to DIN41652 Part 2  
-Mechanical endurance ;200

-Material insulator glass filled thermoplastic UL94V0  
-Material contacts Socket; phosphor bronze  
-Finish on contact area 0.4µ gold over nickel  
-Finish on termination end bright tin-lead over nickel  
-Solderability according to DIN 41640 Part 70, test 12a  
according to DIN41640 Part 14, test 6c,50g  
-Schock according to DIN41640 Part 15, test 6d,20g  
-Vibration 10 t0 2000Hz;discontinuity<1µs

ENVIRONMENTAL DATA

-Climatic category -55°/125°/21

Dimensions are in millimeters

Shell size	Number of contacts	H <sup>+0</sup> <sub>-0.15</sub>	I <sup>+0</sup> <sub>-0.10</sub>	K <sup>±0.05</sup>	L <sup>+0.12</sup> <sub>-0</sub>	M <sup>±0.10</sup>	N <sup>+0</sup> <sub>-0.20</sub>	PART NUMBER
E	09	18.36	16.00	9.88	6.88	15.24	14.53	DEM09S300NSP220
A	15	26.69	24.43	9.88	6.88	23.67	22.86	DAM15S300NSP220
B	25	40.43	38.22	9.88	6.88	37.29	36.57	DBM25S300NSP220
C	37	56.89	54.43	9.88	6.88	53.74	53.03	DCM37S300NSP220



Copyright FCI.

European Views

www.fciconnect.com		surface ISO 1302 ✓	tolerance std ISO 406 ISO 1101	projection mm
TOLERANCES UNLESS OTHERWISE SPECIFIED				
Dr	JOUBERT	1998/09/29	ANGULAR	LINEAR
Eng	PESSON	1998/09/29	0.X	±0.1
Chr	LEGARE	1998/09/29	0.XX	±0.1
Appr	LEGARE	1998/09/29	0.XXX	±0.1
Product family			D-SUB	Spec ref -
title SOCKETS CONNECTORS D SUBMINIATURE WITHOUT SHELL.		part no C01-8637-1514		Rev. B
catalog no		CUSTOMER sheet 1 of 1		

rev	ecn no	dr	date
A	-	JOU	1998/09/29
B	LS06-0097	LGO	2006/07/28
-	-	-	-
-	-	-	-
-	-	-	-
-	-	-	-