

1.37 for size 09 and 15
1.38 for size 25 and 37

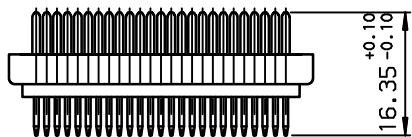
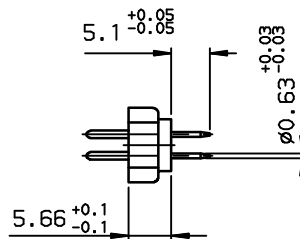

ELECTRICAL DATA

-Current at AMB. 4A
-I max 7.5A
-Contact resistance $\leq 7.3\text{ma}$
-Insulation resistance >5000Ma
-TEST VOLTAGE
 contact/contact >1000V
 contact/ground >1200V

MECHANICAL DATA

-Contact force >0.20N
-Retention force >40N
-Insertion force according to DIN41652 Part 2
-Withdrawal force according to DIN41652 Part 2
-Mechanical endurance ;200

-Material insulator glass filled thermoplastic UL94V0
-Material contacts Pin: brass
-Finish on contact area 0.4µ gold over nickel
-Finish on termination end bright tin-lead over nickel
-Solderability according to DIN 41640 Part 70, test 12a
-Schock according to DIN41640 Part 14, test 6c,50g
-Vibration according to DIN41640 Part 15, test 6d,20g
10 t0 2000Hz;discontinuity<1µs

ENVIRONMENTAL DATA

-Climatic category -55°/125°/21

Dimensions are in millimeters

Shell size	Number of contacts	G ⁺⁰ / _{-0.15}	H ⁺⁰ / _{-0.10}	I ±0.05	J ^{+0.12} / ₋₀	-	-	PART NUMBER
E	09	18.36	16.00	9.88	6.88	-	-	DEM09P300NSP220
A	15	26.69	24.43	9.88	6.88	-	-	DAM15P300NSP220
B	25	40.43	38.22	9.88	6.88	-	-	DBM25P300NSP220
C	37	56.89	54.43	9.88	6.88	-	-	DCM37P300NSP220

European Views

www.fciconnect.com		surface ISO 1302 <input checked="" type="checkbox"/>	tolerance std ISO 406 ISO 1101	projection 	mm
TOLERANCES UNLESS OTHERWISE SPECIFIED					
Dr	JOUBERT	1998/09/29	ANGULAR	0.X ±0.1	size A3
Eng	PESSON	1998/09/29	LINEAR	0.XX ±0.1	Scale 1.5
Chr	LEGARE	1998/09/29	0.XX* ±2*	0.XXX ±0.1	ECN L506-0097
Appr	LEGARE	1998/09/29	Product family	D-SUB	Spec ref -
		title MALE CONNECTORS D SUBMINIATURE WITHOUT SHELL.		Rev. B	
catalog no		-		C01-8637-1515	
				CUSTOMER sheet 1 of 1	

rev	ecn no	dr	date
A	-	JOU	1998/09/29
B	L506-0097	LGO	2006/07/28
-	-	-	-
-	-	-	-
-	-	-	-
-	-	-	-



Copyright FCI.