

# FREE PLUG

# SERIES PRC05

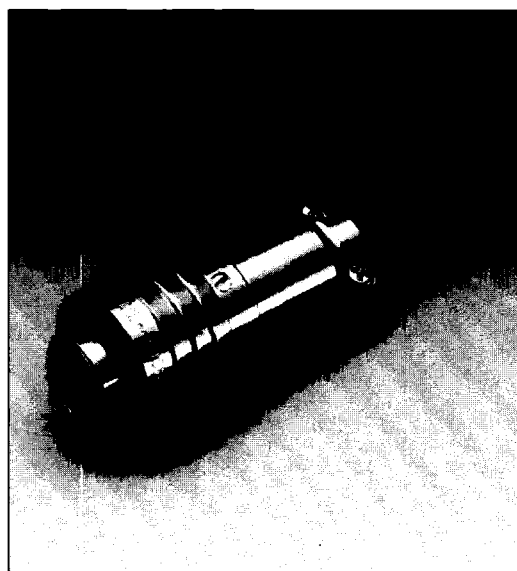
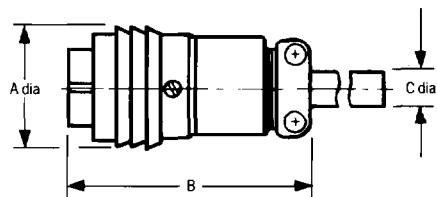

No. of Contacts	Part Number	Dimensions (mm)			Weight (gram)
		A	B	C	
2	PRC05-P2M	13.5	32.0	5.2	13.3
3	PRC05-P3M	13.5	32.0	5.2	13.4
5	PRC05-P5M	13.5	32.0	5.2	13.4
6	PRC05-P6M	16.7	34.0	6.2	21.9
8	PRC05-P8M	16.7	34.0	6.2	22.1
12	PRC05-P12M	21.0	39.0	11.0	36.0

No. of Contacts	2	3	5	6	8	12
Current rating	2A	2A	2A	2A	2A	2A
Voltage rating (AC. V rms)	300V	300V	150V	300V	200V	300V
Withstand voltage (AC. V. rms)	900V	900V	500V	900V	700V	900V
Contact resistance	3V DC 1A 8mΩ max.					
Insulation resistance	500V DC 1,000mΩ min.					
Temperature range	-25°C to +85°C					
Materials: Shell	Brass, nickel plated					
Plug contact	Brass, gold plated					
Socket contact	Copper alloy, gold plated					
Insulation	Synthetic resin					
Conductor Wire	A.W.G.	24 AWG max				
	Square (mm <sup>2</sup> )	0.3 max.				
	Wire diameter (mm)	0.8 max.				

# BULKHEAD SOCKET

# SERIES PRC05

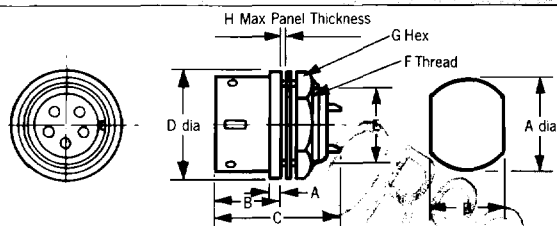

No. of Contacts	AØ	B
2-3-5	9.2	8.4
6-8	12.2	11.2
12	16.2	14.7

No. of Contacts	Part Number	Dimensions (mm)									Weight (gram)
		A	B	C	D	E	F	G	H		
2	PRC05-R2F	2.0	9.5	17.8	13.0	8.2	9.0	14.0	2.0	6.9	
3	PRC05-R3F	2.0	9.5	17.8	13.0	8.2	9.0	11.0	2.0	7.0	
5	PRC05-R5F	2.0	9.5	17.8	13.0	8.2	9.0	11.0	2.0	7.3	
6	PRC05-R6F	2.0	9.5	17.8	16.0	11.0	12.0	14.0	2.0	10.2	
8	PRC05-R8F	2.0	9.5	17.8	16.0	11.0	12.0	14.0	2.0	10.4	
12	PRC05-R12F	2.0	9.5	17.8	20.0	14.5	16.0	20.0	1.6	16.5	

