

NOTES:

- 1.DISPLAY TYPE STN or FSTN
- 2.VIEWING DIRECTION: 6:00 or 12:00
- 3.POLARIZER MODE: TRANSMISSIVE or TRANSFLECTIVE
- 4.OPERATING TEMP.: NORMAL or WIDE
- 5.STORAGE TEMP.: NORMAL or WIDE
- 6.DRIVE VOLTAGE(VDD): 5.0V
- 7.DRIVERS: S6B2086X01-TORA
- 8.LCD OPERATING VOLTAGE:12.0V VEE=-7.0V
- 9.LCD DRIVE METHOD: DUTY=1/64 BIAS=1/9
- 10.ALL UNMARKED TOLERANCES:±0.2
- 11.BACKLIGHT TYPE: LED(4.2V DC,YELLOW-GREEN)
- 12.BEZEL IS TO BE PAINTED BLACK
- 13.LIMITING RESISTOR FOR BACKLIGHT VALUE: 2.0ohm,1W
- 14.TEMPERATURE COMPENSATION CIRCUIT ON PCB

1	D1
2	FLM
3	M
4	CL1
5	CL2
6	NC
7	VDD
8	VSS
9	VEE
10	NC

DETAIL A:

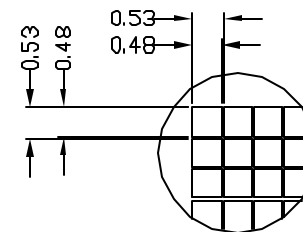

TIAN-MA MICROELECTRONICS CO.

22/F., HANGDU Building, Shennan Road, Central, Shenzhen, China

DRAWN BY:	TITLE: TM24064N series	
CHECKED BY:	DWG NO: G-3	
APPROVED BY:	DWG NAME: TM24064N G-3	SHEET NO: 0F
CONFIRMED BY:		